

INSTRUCTION MANUAL

MODEL #BP00288

**BACK-PAK HEPA
VACUUM**



-----WARNING-----

All Nikro Industries Inc. products that have rated efficiencies of 99.97% @ 0.3 microns and 99.99% @ 0.3 microns, have H.E.P.A. filters that have been individually tested to meet these minimum efficiencies.

Although all the filters have been pre-tested, the possibility of leaks or filter failure due to handling, transportation, punctures, loaded filters, moisture, wear and tear, etc., does exist.

Therefore, when using this equipment in highly sensitive areas or where any release of particles above and beyond the minimum efficiencies would be detrimental and harmful to humans, plants or property; it is strongly recommended that the units be individually tested prior to their use.

This is to assure that they are maintaining the efficiency levels, which they were designed to filter out.

FAILURE TO DO SO COULD RESULT IN SERIOUS HARM TO HUMAN LIFE, PLANT LIFE AND/OR PROPERTY.

OPERATING INSTRUCTIONS

Inspection

Thoroughly inspect your machine for any shipping damage. Your machine has already been thoroughly tested at the Nikro Industries manufacturing plant prior to shipping.

Electrical Specification

This machine is designed to operate on a 15 amp. 115V., 60 hz., AC circuit. A deviance of this could cause serious damage to the unit.

Grounding Instructions

This machine is equipped with a grounding type cord and three prong plug. Make sure that the plug is connected to an outlet with three receptacles designed for use with the three prong plug. (See Illustration) Never use an adapter with machine.

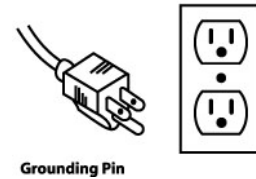

Maintenance

Lubrication of this motor is not required as it is equipped with sealed bearings.

Always keep the air cooling intake screen free, not allowing any restriction of airflow. Airflow restriction will overheat and damage the motor.

To prolong the life of the H.E.P.A. filter, empty, clean, and replace bags and filters regularly as described in the following sections.

SAFETY INSTRUCTIONS

Read all safety instructions before using!

1. Electrical shock could occur if used outdoors or on wet surfaces.
2. Always store machine indoors in a dry area. If machine is dropped in water or left in rain, it should be serviced by an authorized service technician prior to plugging the unit in.
3. Prior to plugging in machine, always inspect cord for cuts and exposed wires. If these problems are found, return the machine to an authorized service technician..
4. Never use the cord as a handle, or pull the machine by using the cord.
5. Never unplug this machine or any other electrical appliance by pulling on the cord.
6. Do not wrap the cord around the dome. Wrapping the cord around the dome will restrict the motor from exhausting properly and will result in overheating and damaging the motor.
7. Keep hair, fingers, and other objects away from all moving parts and openings on this machine.
8. This vacuum cleaner should never be used in explosion-hazardous areas or to pick up combustible or flammable liquids such as gasoline, etc.
9. Never leave the machine unattended when plugged in or running.
10. Always have the switch in the OFF position before unplugging the unit.
11. Do not operate this machine with any of the openings blocked; always keep these areas free of lint and dust or any other particles that could reduce the airflow.
12. Never operate or plug in this machine or any other electrical appliance with wet hands or when standing in water.
13. This machine should never be operated without the proper filters installed in the manner described in the following pages of this manual.
14. This machine should never be serviced by anyone other than an authorized technician.
15. Use only original NIKRO replacement parts and attachments.

TANK AND FILTER PREPARATION

1. Place the paper collection bag into the bottom of tank. Pull the cardboard/rubber collar over the down tube, sliding it over the rib on the down tube. Gently pull apart the accordion-like pleats so that the bag is open.
2. Take the non-clinging dacron filter bag and pull the elastic band up over the H.E.P.A. filter, and let the elastic band rest securely on the H.E.P.A filter.
3. Place the lid assembly onto the tank and snap the latches into place.

FILTER MAINTENANCE AND REPLACEMENT INSTRUCTIONS

Warning: When a loss of vacuum power is detected, the vacuum should be turned off immediately. Continued use of the machine could result in severe damage to motor and/or H.E.P.A filter. This loss of vacuum power could be caused by one of the following:

- a) The paper collection bag may be full and needs to be replaced.
- b) The hose or down tube may be clogged and needs to be cleared.
- c) The dacron filter bag may be clogged and needs to be cleaned.
- d) The H.E.P .A. filter may be clogged and needs to be replaced.

To prolong the life of the H.E.P .A. filter and motor, the paper collection bag should be changed when it is either half full or when 7 pounds of debris is collected.

PROCEDURES FOR REMOVING CONTAMINATED FILTERS

Caution: When removing contaminated filters or using this machine, you should always wear gloves and a respirator approved for use with the particular contaminant you are working with.

FILTER REMOVAL PROCEDURES

1. Turn off and unplug machine.
2. Slowly and carefully lift one side of the lid assembly from the tank. Holding the lid with one hand, reach under the lid and gently tap all around the dacron filter bag, allowing any loose dust particles to drop into the tank.
3. Carefully lift the lid assembly off the tank. With a damp rag, wipe underside of the lid assembly. Set it aside and dispose of rag properly. **Note:** Never set the lid down on the H.E.P.A filter.
4. Take the collar of the paper collection bag and carefully slide it down and off the down tube.
5. Carefully remove the collection bag from the tank and dispose of properly.
6. Take a damp rag and wipe down the inside of the tank. Dispose of the contaminated rag properly.
7. All hazardous waste must be disposed of properly. Never put contaminated debris in a regular trash container. All debris must be placed in a plastic bag or container labeled "Hazardous Materials", and should be removed by a licensed waste hauler.

CONSULT PROPER AUTHORITIES FOR REGULATIONS REGARDING DISPOSAL.

PROCEDURE FOR CHANGING THE HEPA FILTER

- (1) The precautionary steps described in this manual should be used when changing the HEPA filter.
- (2) NOTE: You must follow Local and 1 or Federal guide lines when working with contaminated filters.
- (3) Remove the eight (8) bolts holding the HEPA filter to the lid assembly, using a Phillips screw driver and an 11/32" wrench.
- (4) Carefully remove the HEPA filter, being careful not to create any airborne dust.
- (5) This filter cannot be cleaned, and should be disposed of in an appropriate manner.
- (6) Re-install the new HEPA filter using #8 screws, nuts, lock washers, and flat washers.

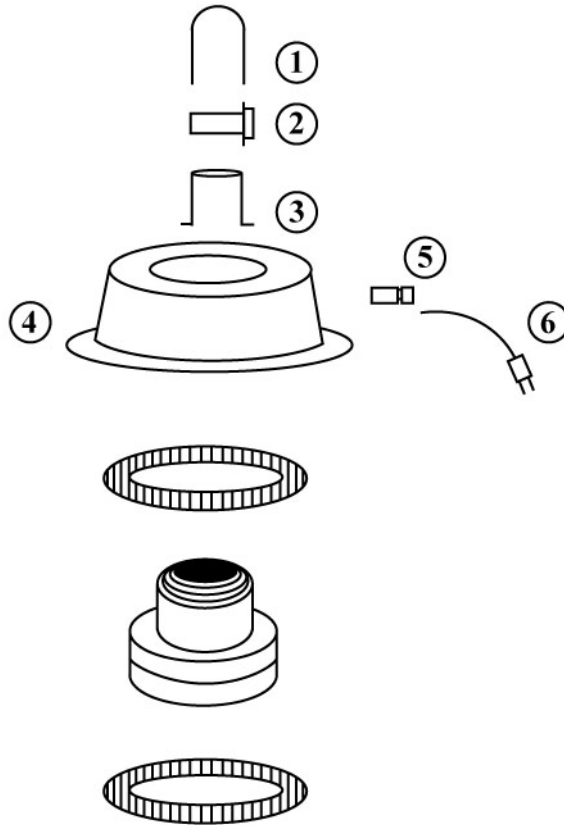

REFERENCE	PART NO.	DESCRIPTION	QTY. REQ.
1	860181	DIFFUSER	1
2	860809	DIFFUSER CLAMP	1
3	860179	DIFFUSER EXHAUST TUBE	1
4	520368	MOTOR DOME	1
5	520013	CORD STRAIN RELIEF	1
6	861307	CORD W/ INLINE SWITCH	1
7	520329	UPPER MOTOR GASKET	1
8	520003T	MOTOR	1
9	520329	LOWER MOTOR GASKET	1
10	520465	(INLINE CORD SWITCH)	1

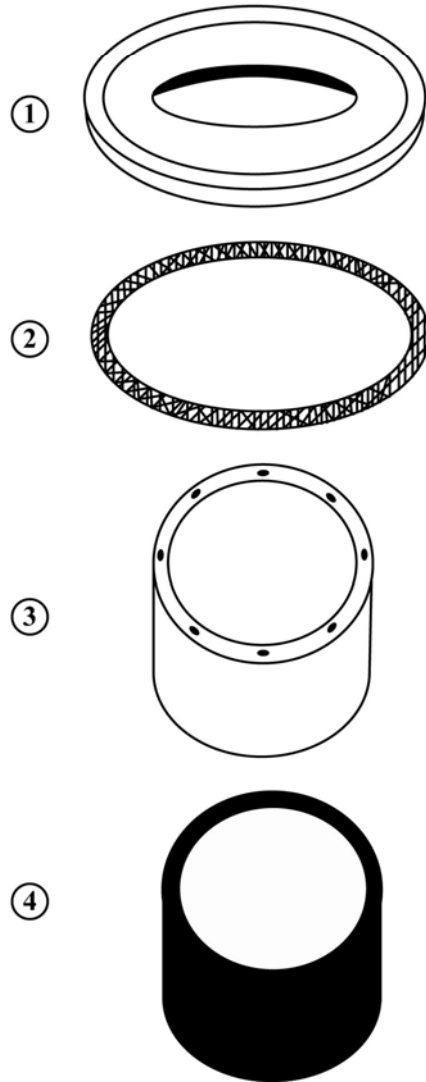

REFERENCE	PART NO.	DESCRIPTION	QTY. REQ.
1	520371	LID	1
2	520018	LID GASKET	1
3	861969	HEPA FILTER	1
4	862006	IPACTION FILTER	1

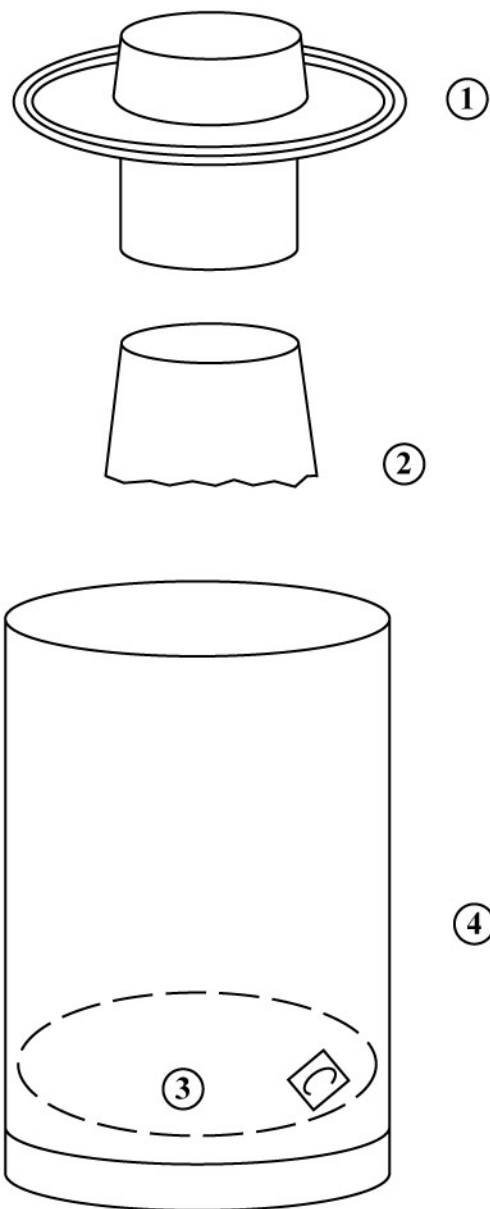

REFERENCE	PART NO.	DESCRIPTION	QTY. REQ.
1	540008	MOTOR AND LID ASSY.	1
2	520037	DACRON FILTER BAG	1
3	520033	COLLECTION BAG	1
4	520372	TANK	1

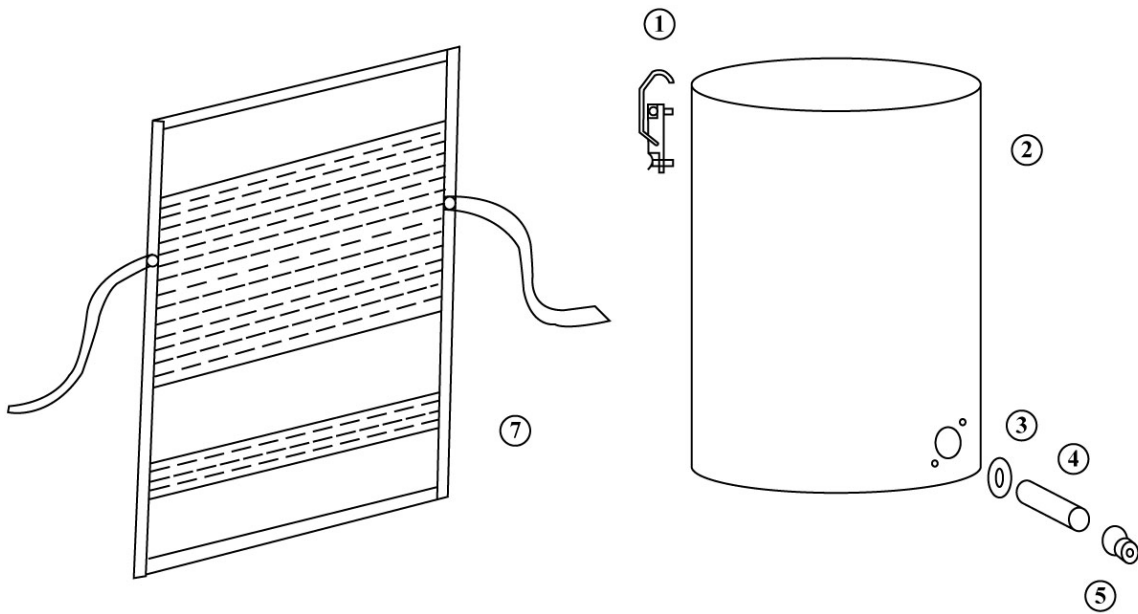

REFERENCE	PART NO.	DESCRIPTION	QTY. REQ.
1	520019	LID LATCH	3
2	520372	TANK	1
3	520216	INTAKE GASKET	1
4	520118	INTAKE TUBE	1
5	520220	INTAKE	1
6	520217	INTAKE KNOB	1
7	540009	HARNESS ASSEMBLY	1
	861159	HARNESS CORD CLIP	1
		(NO SHOWN)	
	540007	TANK ASSY. W/HARNESS	
		(COMPLETE)	
	861158	TANK ASSY. COMPLETE	
		(LESS HARNESS)	

**TOOL KIT & REPLACEMENT PARTS FOR BPOO288
BACKPACK**

<u>PART NO.</u>	<u>DESCRIPTION</u>	<u>QTY. REQ.</u>
520456	1 ½" X 7" CRUST PROOF HOSE ASSY.	1
520112	1 ½" X 3" ROUND DUST BRUSH	1
520457	1 ½" X 5" UTILITY TOOL	1
860930	1 ¼" X 20" PLASTIC WAND	2
520111	1 ¼" X 9" CREVICE TOOL	1
860940	PLASTIC BRUSH ADAPTER	1
520523	3" REPLACEMENT BRISTLE FOR #520112 DUST BRUSH	

WARRANTY

Nikro equipment is warranted for 2 years from the date delivered to the original purchaser. Parts, which become defective due to faulty workmanship or materials during normal use in these years will be repaired or exchanged at no charge if returned and approved by an authorized Nikro service center. The freight shall be at the expense of the customer.

This warranty does not apply to normal wear and tear, neglect, misuse, or incorrect installation. If any other replacement parts, filters or attachments are used other than original Nikro parts, this warranty will become void.

This warranty does not apply to hoses, switches, lights, sensors, or breaks in cords. All motors are subject to manufacturer's warranty. Contact Nikro Industries for assistance with these items.

Nikro disclaims responsibility for loss of production, profits, or any other costs that may indirectly occur due to the failure of this product.

NIKRO
INDUSTRIES, INC.