

Beacon 1 Shower Head System

Contents:

- 1) Shower Flange
- 2) Shower Nipple
- 3) Diverter Valve
- 4) Coupling
- 5) High Rise Shower Arm
- 6) Hose
- 7) 98% Flow Control Shut Off
- 8) Handheld Shower Head
- 9) Rain Shower Head
- 10) Shower Bracket Holder
- 11) Roll of Thread sealing Tape (not shown)

Use a Cloth Rag Over Finished Items to Protect Fittings.
When Using Pliers. Use Smooth Jaw Plier or Wrench.
You Don't Want to Mar the Fittings!

Wrap Tape Clockwise Four Times Around Threads on Item (2) (Shower Nipple) Both Ends.
Screw into Wall Fitting and Tighten.

Screw on Diverter Valve (3) to Shower Nipple (2)
Screw on (4) Coupling onto Diverter (3) Use Washers to Seal.

Attach Hose (6) to Diverter (3) and to (7) 98% Flow Control.
Make Sure Rubber Hose Washers and Thread Sealing Tape Are Used.

Screw on High Rise Shower Arm (5) to (4) Coupling.
Handheld (7) into 98% Flow Control. Attach Handheld Shower Head.
Wrap Tape Around Threads For Times (5) Attach Rain Shower Head (9).

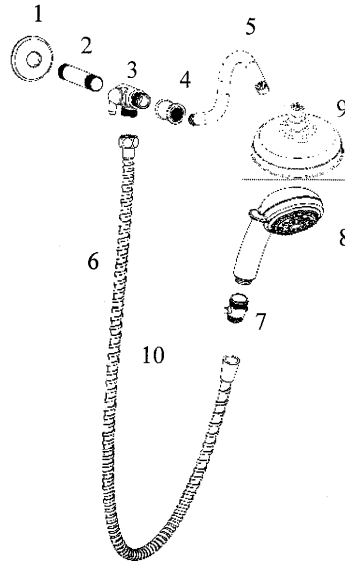

Suction Cup Bracket (10)

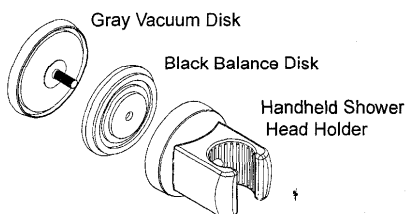

If Your Tiles or Wall are Smooth, use the Suction Cup Bracket.

Place the Gray Rubber Vacuum Disk on Your Wall. Place Black Balance Disk Over Vacuum Disk Screw. Press In and turn Clockwise to Tighten Firmly, Until the Handheld Shower Head Holder is Snud.

Screw Mount Bracket (10)

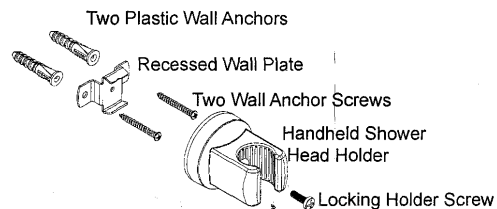

Place Recessed Wall Plate Horizontally on Wall at a Suitable Height and Mark Screw Holes. Drill 15/64" Holes for Hollow Wall Board. Insert the Plastic Wall Anchors and Tap In Flush to Wall. Screw on Recessed Plate with Screws. Attach Hand Held Shower Holder Over Recessed Wall Plate. Use Locking Holder Screw Through Hand Held Shower Bracket to Hold in Place.