



# Instruction Manual

## Olde New Orleans Block Ice Shaver

Model No. 1087DC



**GOLD MEDAL® PRODUCTS CO.**

10700 Medallion Drive, Cincinnati, Ohio 45241-4807 USA



## SAFETY PRECAUTIONS

	<div><b>⚠ DANGER</b></div> <p>Machine must be properly grounded to prevent electrical shock to personnel. Failure to do so could result in serious injury, or death. Do NOT immerse any part of this equipment in water. Do NOT use excessive water when cleaning. Keep cord and plug off the ground and away from moisture. Always unplug the equipment before cleaning or servicing.</p> <p>008GEND1112</p>
	<div><b>⚠ DANGER</b></div> <p>Improper installation, adjustment, alteration, service or maintenance can cause property damage, injury or death. Any alterations to this equipment will void the warranty and may cause a dangerous condition. NEVER make alterations to this equipment. Read the Installation, Operating, and Maintenance Instructions thoroughly before installing, servicing, or operating this equipment. Make sure all machine switches are in the OFF position before plugging the equipment into the receptacle.</p> <p>014GEND1112</p>
	<div><b>⚠ WARNING</b></div> <p>NEVER put your fingers into the shaver body (the goose-neck, ice chute, or hopper). Serious injury may occur.</p> <p>017SW0413</p>
	<div><b>⚠ WARNING</b></div> <p>ALWAYS wear safety glasses when servicing this equipment.</p> <p>010GENW1112</p>
	<div><b>⚠ CAUTION</b></div> <p>Do NOT allow direct contact of this equipment by the public when used in food service locations. Only personnel trained and experienced in the equipment operation may operate this equipment. Carefully read all instructions before operation.</p> <p>012GENC1112</p>
	<div><b>⚠ CAUTION</b></div> <p>This machine is NOT to be operated by minors.</p> <p>007GENC0413</p>

**NOTE:** Improvements are always being made to Gold Medal's equipment. This information may not be the latest available for your purposes. It is critical that you call Gold Medal's Technical Service Department at 1-800-543-0862 for any questions about your machine operations, replacement parts, or any service questions. *(Gold Medal Products Co. does not assume any liability for injury due to careless handling and/or reckless operation of this equipment.)*

# INSTALLATION INSTRUCTIONS

## Inspection of Shipment

After unpacking, check thoroughly for any damage which may have occurred in transit. Claims should be filed immediately with the transportation company. The warranty does not cover damage that occurs in transit, or damage caused by abuse, or consequential damage due to the operation of this machine, since it is beyond our control.

## Setup

Your Olde New Orleans Block Shaver has been fully assembled and tested at the factory.

Be sure unit is on a table that is sturdy and can withstand accidental dripping of water and ice.

## Accessories Included with Your Machine



## Special Features

1. Model #1087DC uses block ice approximately 5" x 5" x 12" long.
2. Snow texture can be adjusted easily with varying the feed pressure applied to pusher lever arm.
3. Cutter Head is equipped with three blades for rapid shaving.
4. Safety switch is installed to prevent operation of cutter head while shaver door is in an open position.
5. Circuit Breaker Reset Switch in the event that a motor overheats.



---

## Electrical Requirements

The following power supply must be provided:

**1087DC:** 12 Volts DC

Customer must supply 12 volt battery for proper machine operation.

Make sure to follow all safety precautions provided by the battery manufacturer.

## Before You Connect Power to the Machine

1. Make sure all machine switches are in the OFF position before connecting to the battery.
2. Cables must be attached to the proper polarity. Black is "+" positive; white is "-" negative.

**Note:** If poles are reversed machine will not shave ice.

3. Install the unit in a level position.

# OPERATING INSTRUCTIONS

## Controls and Their Functions

**POWER SWITCH** – Turns on the power to the shaver motor.

**DOOR SWITCH** – A safety precaution which prevents machine operation when door is open.

**CIRCUIT BREAKER** – Protects the motor from overheating (locked rotor/mechanical failure to start). Manual Reset, push black button to reset.

**TOP HAND WHEEL** – Applies pressure to the block ice loaded into the machine.

**PRESSURE LEVER** – Pressure applied on this lever determines the fineness or coarseness of the shaved ice.

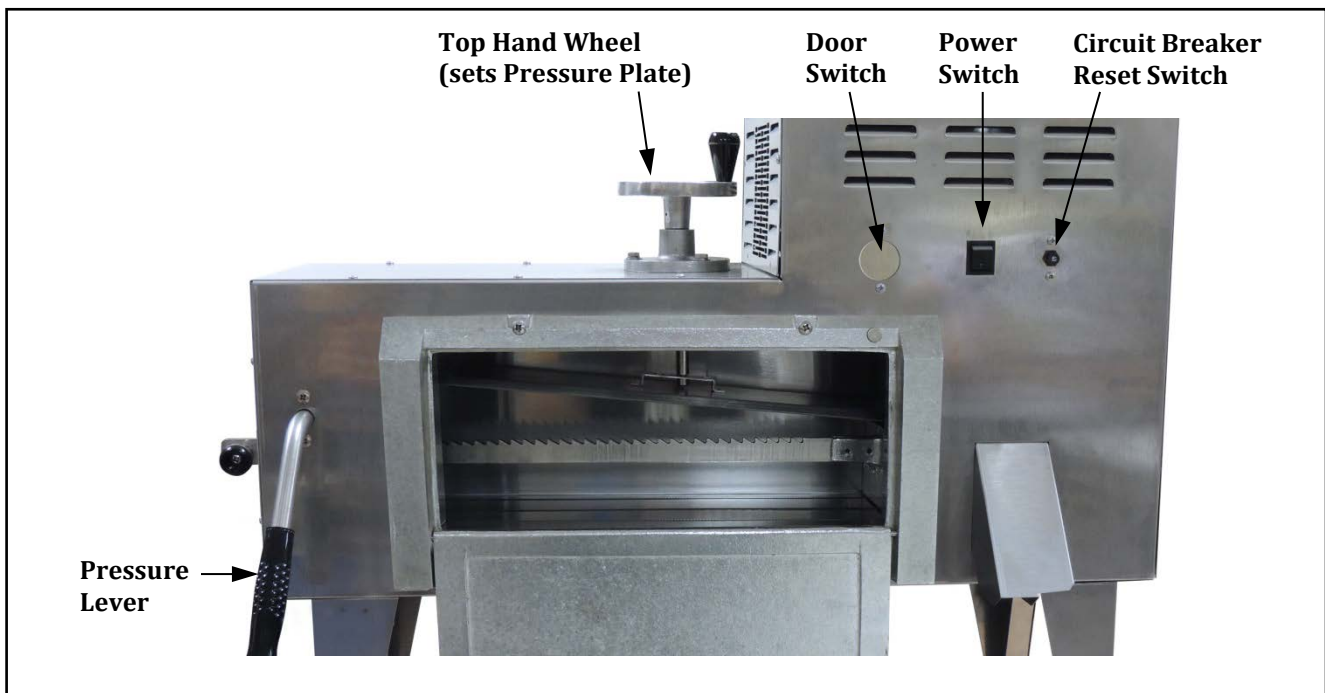

## Using Your Machine

1. Allow ice to soften before use. When properly softened, ice will appear clear and not frosted.
2. Lower cover door and load ice block. Set pressure plate by turning the top hand wheel (failure to set pressure plate causes excessive load on driveline). After pressure is set close the door.  
**NOTE:** The machine will not to operate if the door is open.
3. Place ice pan directly below ice chute and engage power switch. With left hand on pressure lever, force ice into shaver head. The amount of pressure applied at this point will determine the fineness or coarseness of the shaved ice.

The last inch or so of the block of ice being shaved will typically break apart.



## CARE AND CLEANING

1. Disconnect the machine from the power source and clean it after use.
2. Do not leave water in the pans overnight.
3. Clean the stainless steel covers with stainless steel cleaner. Gold Medal Products Company's Watchdog Stainless Steel Polish (P/N 2088) is recommended.
4. Make sure to clean all of the pans in order to sanitize them before each use.
5. The cabinetry should be cleaned both inside and out with hot soapy water (use a non-toxic cleaner).
6. Dry all surfaces with a soft cloth to avoid scratching.

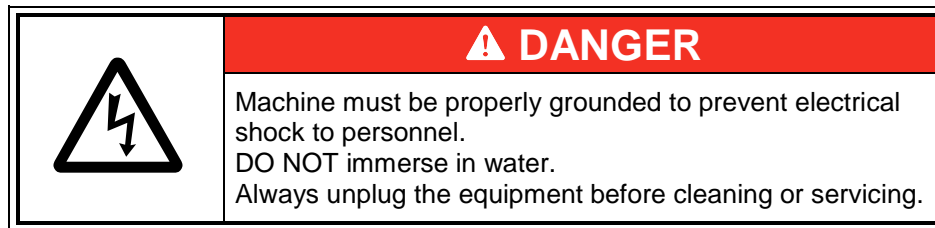

Good sanitation practice demands that all food preparation equipment be cleaned regularly. A clean looking, well-kept machine is one of the best ways of advertising your product.

## TROUBLESHOOTING

### Machine Does Not Operate When the Power Switch is Engaged

Check that door is closed; machine will not operate if the door is open.

### Block Ice Will Not feed into the Unit

Check the ratchet orientation; ratchet must be positioned inward (as shown below) for the block ice to feed properly.

Ratchet should be  
positioned inward.





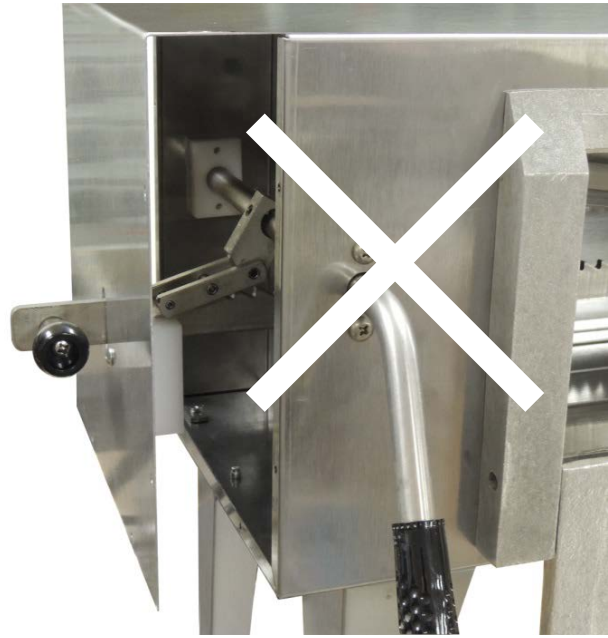

**Correct Ratchet Position**



**Incorrect Ratchet Position**



# MAINTENANCE INSTRUCTIONS

	<div data-bbox="558 296 1278 359"><b>⚠ DANGER</b></div> <p>Improper installation, adjustment, alteration, service, or maintenance can cause property damage, injury or death. Read the installation, Operating, and Maintenance Instructions thoroughly before installing or servicing this equipment.</p>
	<div data-bbox="558 569 1278 632"><b>⚠ DANGER</b></div> <p>Do Not immerse the equipment in water. Unplug your machine before servicing.</p>
	<div data-bbox="558 783 1278 846"><b>⚠ WARNING</b></div> <p>Adequate eye protection must be used when servicing this equipment to prevent eye injury.</p>
	<div data-bbox="558 984 1278 1047"><b>⚠ CAUTION</b></div> <p>THE FOLLOWING SECTIONS OF THIS MANUAL ARE INTENDED ONLY FOR QUALIFIED SERVICE PERSONNEL WHO ARE FAMILIAR WITH ELECTRICAL EQUIPMENT. THESE ARE NOT INTENDED FOR THE OPERATOR.</p>



## INSTALLING NEW SHAVER BLADES

Inspect your equipment before replacing the blades. Use a flashlight to examine the blades in the shaver body. If the blades appear to be nicked or bent, they should be replaced.

Follow this procedure:

1. Disconnect the main power supply cord from the battery.
2. Remove the belt guard cover by removing the (16) 8-32 screws.
3. Remove the drive belt from the drive motor and cutter head; first loosen the Belt Tensioner using a 9/16" box wrench, then use a large screw driver to wedge and rotate the belt out of the pulley groove.
4. Remove the (4) 1/4-20 bolts securing the cutter into place. The cutter head can now be removed.
5. Remove 8" diameter pulley by loosening (but do not remove) 5/16-18 set screw, and pull the pulley from the cutter head shaft.

**DO NOT lose the shaft key; this must be reset into place when reassembling the cutter head.**

6. Remove the snap ring from the shaft using a snap ring pliers, and remove thrust washer(s) if present. Set these aside for reuse when reassembling the cutter head.
7. The cutter head housing can now be pulled from the cutter head shaft.
8. See Blade Set Diagram below for blade set information.
9. Reassemble in reverse order.

**Set top of blade flush with height gage, as shown below:**

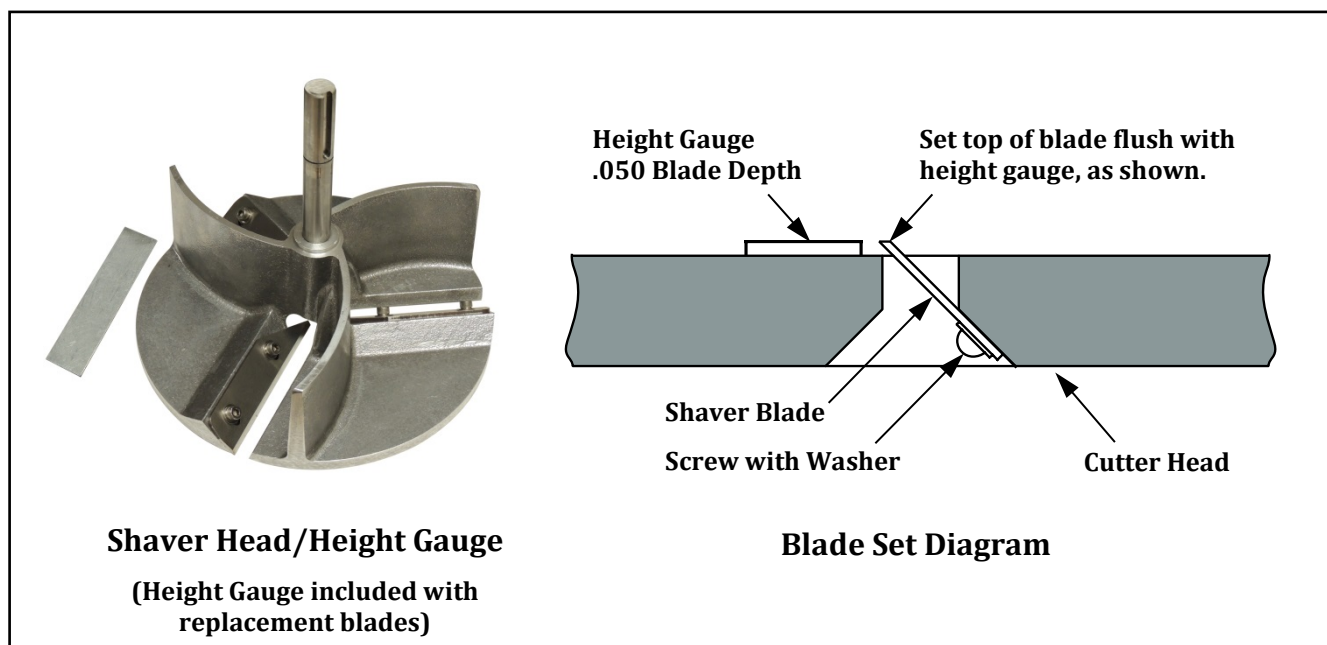



## ORDERING SPARE PARTS

1. Identify the needed part by checking it against the photos, illustrations, and/or parts list.
2. When ordering, please include part number, part name, and quantity needed.
3. Please include your model number, serial number, and date of manufacture (located on the machine nameplate) with your order.
4. Address all parts orders to:

Parts Department  
Gold Medal Products Co.  
10700 Medallion Drive  
Cincinnati, Ohio 45241-4807

Or, place orders by phone or online:

Phone: (800) 543-0862  
(513) 769-7676  
Fax: (800) 542-1496  
(513) 769-8500  
E-mail: [info@gmpopcorn.com](mailto:info@gmpopcorn.com)  
Web Page: [gmpopcorn.com](http://gmpopcorn.com)



Cabinet Exterior

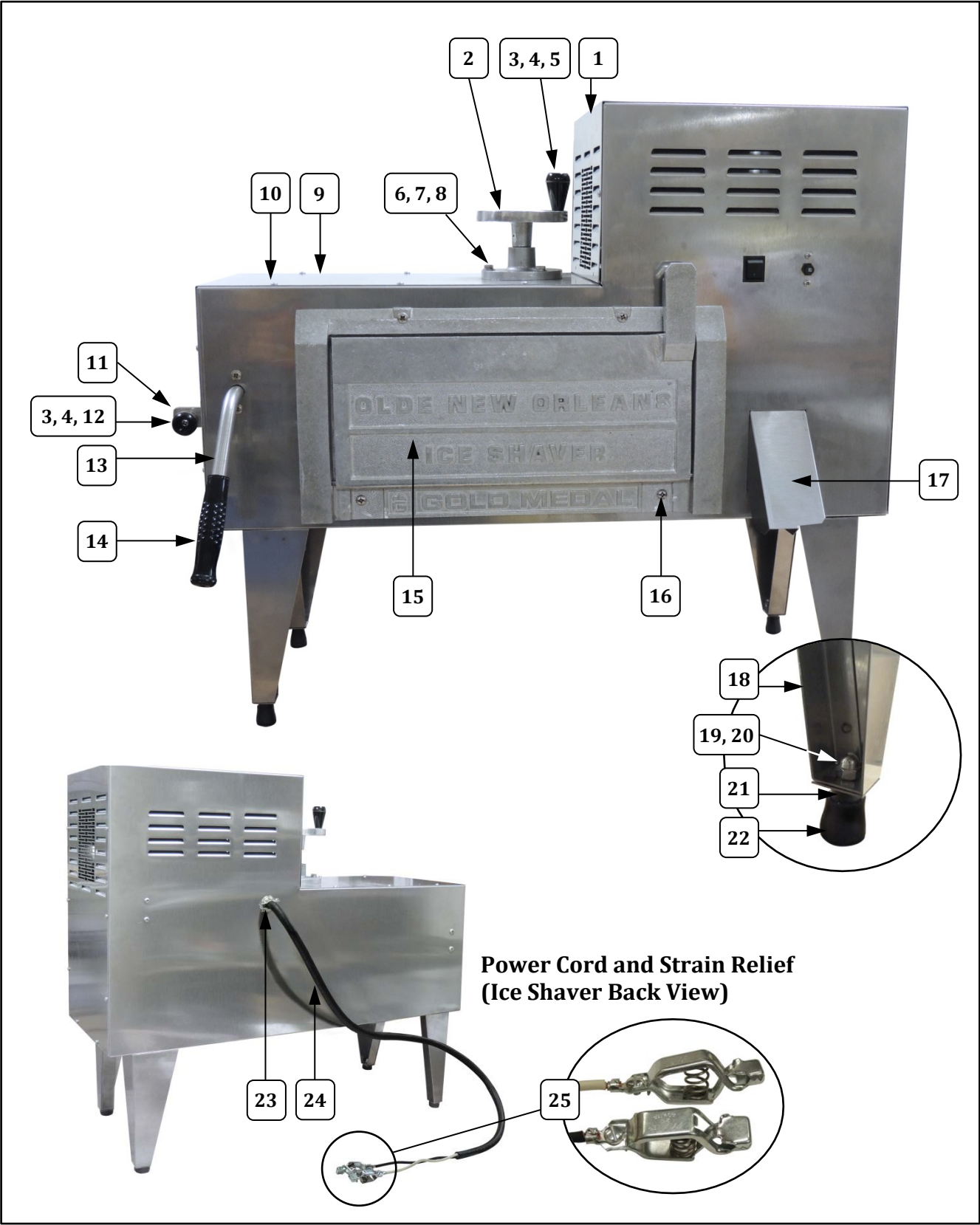



## Cabinet Exterior – Parts List

Item	Part Description	Qty.	Part No.
			1087DC
1	RH COVER PLATE 1087NS	1	42267
2	HANDWHEEL ASSEMBLY 1087 (complete Handwheel Assy - includes knob)	1	12240
3	KNOB HANDWHEEL	1	12368
4	1/4-20 X 2 PAN HD PH M/S	1	12384
5	TUBE HANDWHEEL PIVOT	1	12369
6	1/4-20 X 3/4 HEX CAP 18-8	3	12515
7	1/4 SPRING LOCK WASHER	3	12707
8	FLAT WASHER 1/4 STAINLESS	3	87261
9	LH COVER WELDMENT 1087NS	1	42103
10	8-32 X 1/2 PH PAN T/S	28	87245
11	ICE PUSHER ASSEMBLY 1087	1	12568
12	1/4-20 HEX NUT (holds Ice Pusher Knob)	1	12706
13	FEED LEVER	1	12564
14	GRIP FOR .625 SHAFT	1	12561
15	DOOR ASSEMBLY	1	12534
16	1/4-20 X 1 1/4 PH PAN MS	4	51030
17	ICE CHUTE WELDMENT 1087NS	1	42426
18	LEG WELDMENT 1087NS	2	42502
19	1/4-20 LOCKING ACORN NUT	4	40786
20	1/4-20X3/4 SOCKET HD BOLT	4	12431
21	GLIDE FOOT .781 LENGTH	4	42514
22	CRUTCH TIP BLACK 70 DURO	4	49123
23	STRAIN RELIEF T&B #3303	1	89017
24	POWER CORD ASSY 1087DC	1	101053
25	CLIP ON BATTERY CONNECTION	2	73112

## Unit Controls - Switches

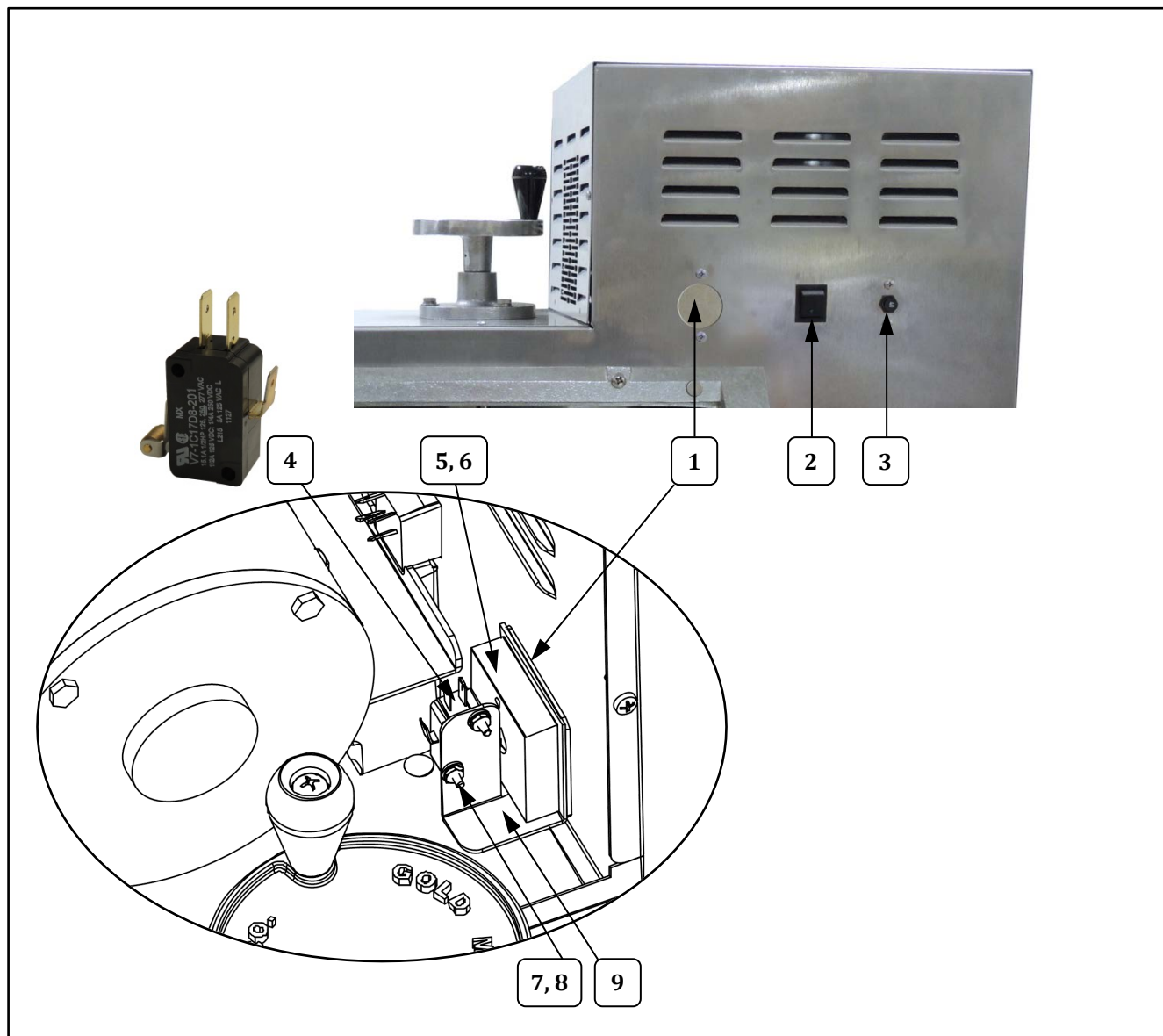

Item	Part Description	Qty.	Part No. 1087DC
1	SAFETY SWITCH MAGNET COVER	1	42574
2	SWITCH, ROCKER DPST	1	55395
3	CIRCUIT BREAKER	1	22037
4	DOOR SAFETY SWITCH	1	12116
5	MAGNET MTG BLOCK	1	42573
6	MAGNET 1/2IN OD X 1/2IN T	1	12078
7	4-40 X 3/4 PH PAN 18-8 MS	2	12186
8	4-40 HX HD NUT STAINLESS	2	12386
9	SAFETY SWITCH MOUNTING BRACKET	1	42522



Cabinet Interior

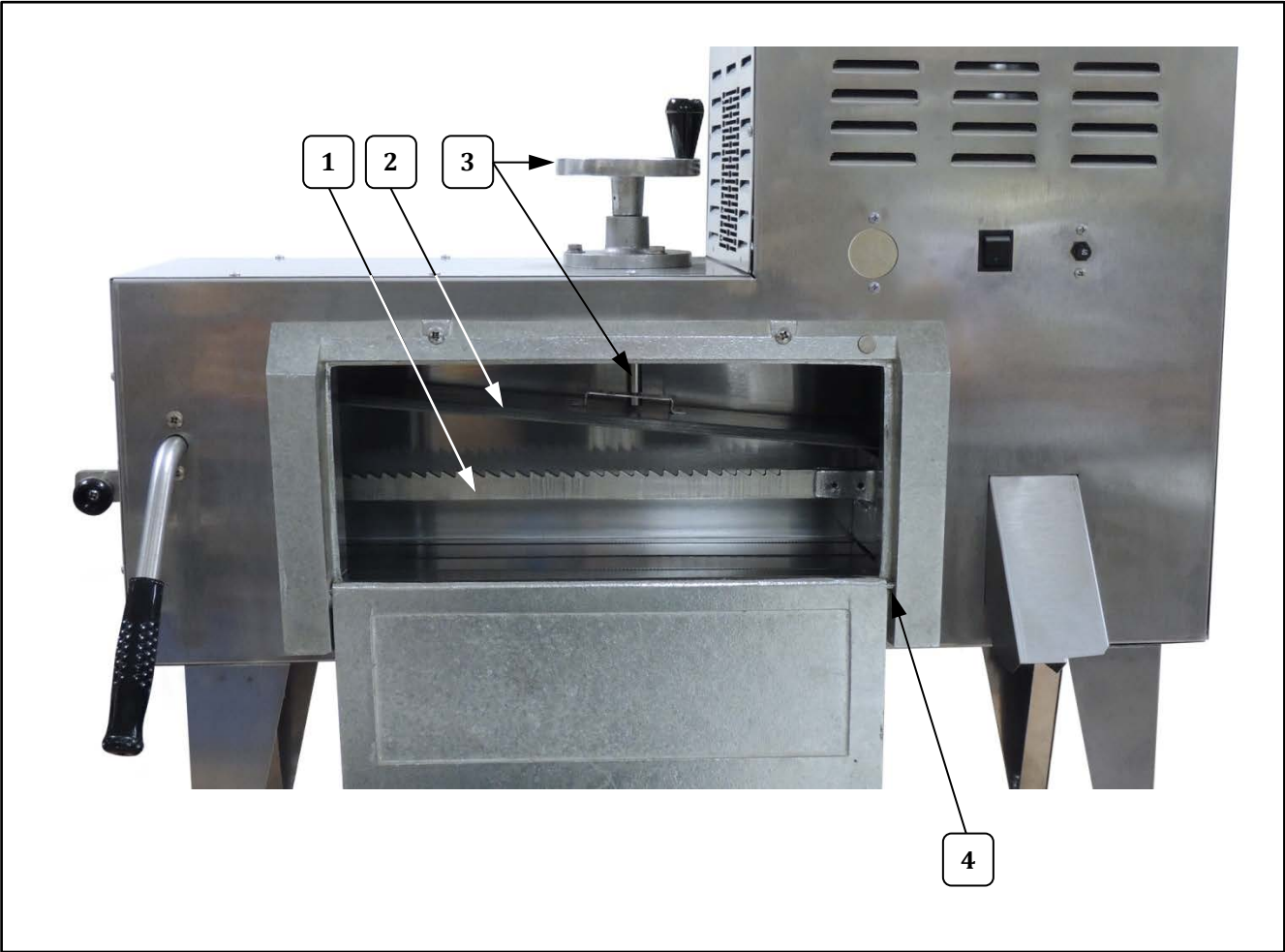

Item	Part Description	Qty.	Part No.
			1087DC
1	ICE PUSHER ASSEMBLY 1087	1	12568
2	ICE RETAINER WLDMNT	1	12299
3	HANDWHEEL ASSEMBLY	1	12240
4	1/4 X 5/8 SHLDER BOLT SS	2	12693

## Cabinet Interior – Ratchet End

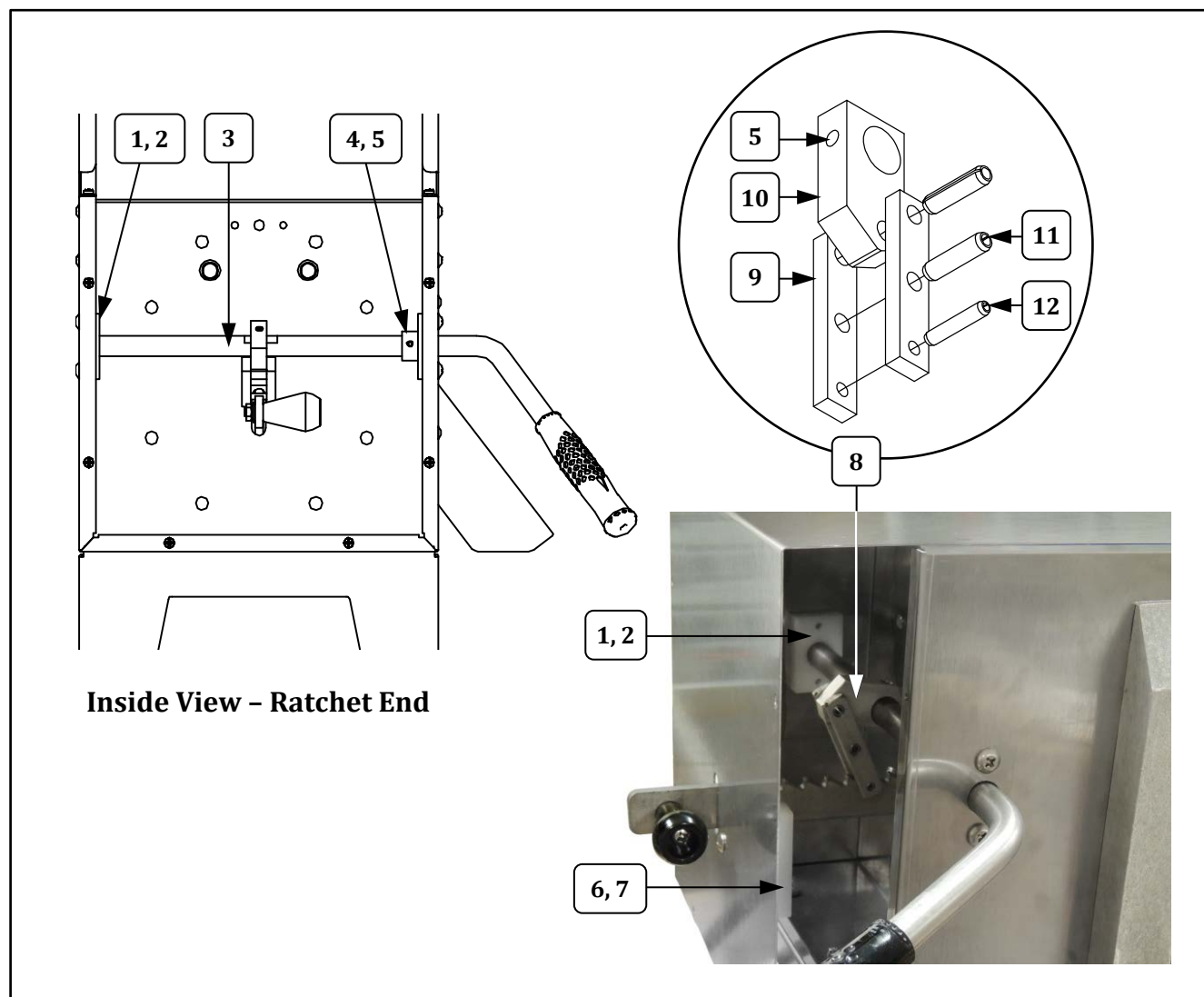

Item	Part Description	Qty.	Part No.
			1087DC
1	FEED LEVER SUPPORT	2	12562
2	12-14 X 1/2 TYPE-B SMS (screw for Feed Lever Support)	4	42937
3	FEED LEVER	1	12564
4	SET COLLAR .625" SHAFT	1	12566
5	SET SCREW 1/4-20 X 3/16	2	47751
6	RATCHET RAIL SUPPORT	1	12259
7	10 X 1/2 TYPE B SMS (screw for Ratchet Rail Support)	2	42828
8	RATCHET ASSEMBLY	1	12422
9	RATCHET MECH PART B 1087	2	12256
10	RATCHET MECH PART A 1087	1	12563
11	SPRING PIN 1/4 X 1	2	12462
12	SPRING PIN 3/16 X 1	1	12460





Cabinet Interior – Motor View

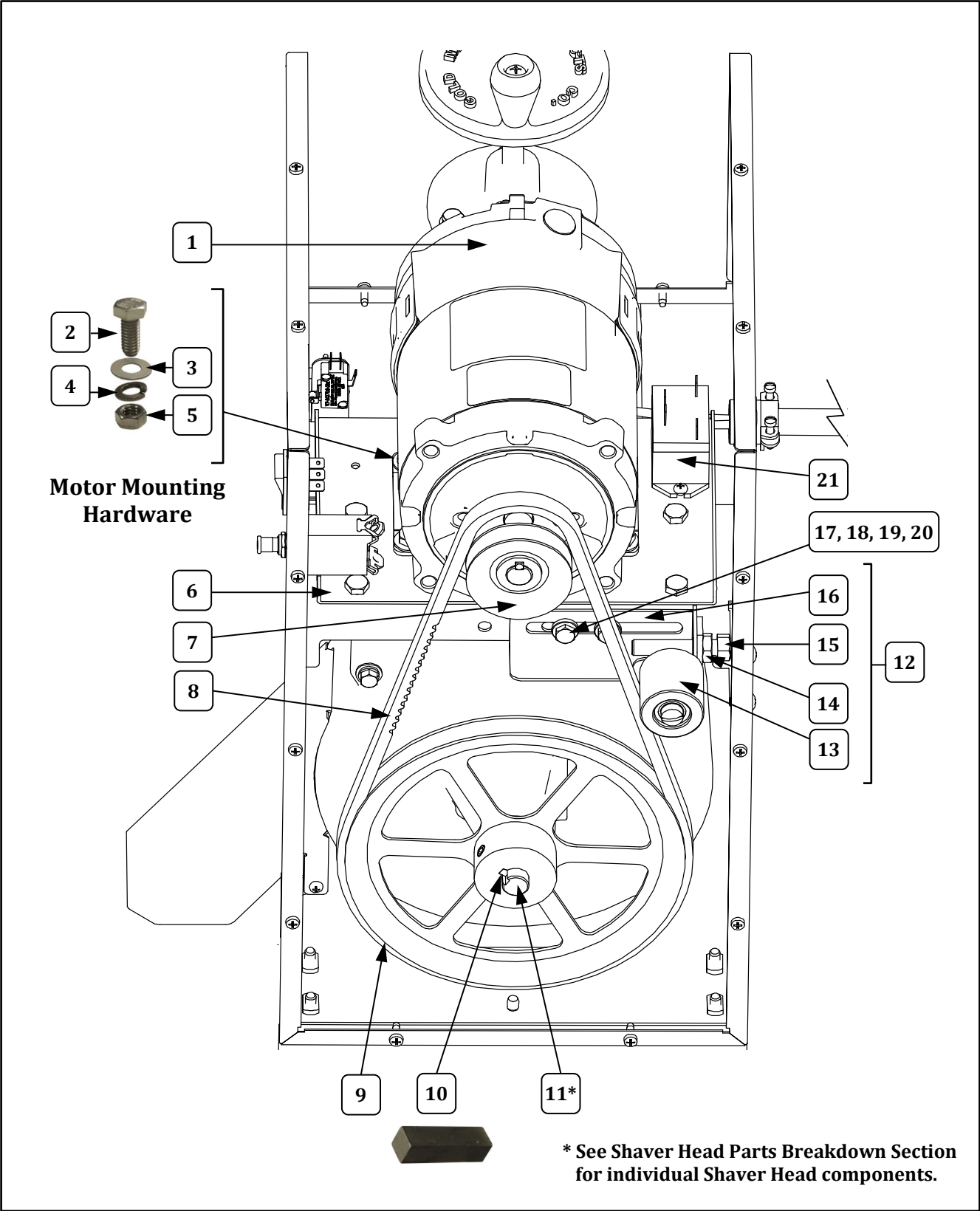





## Cabinet Interior – Motor – Parts List

Item	Part Description	Qty.	Part No.
			1087DC
1	12V DC MOTOR	1	22041
2	5/16-18 x 3/4 HEAD HEAD	4	12582
3	5/16 FLAT WASHER, 18-8	4	12184
4	5/16 SPRING LOCK WASHER	4	12705
5	5/16-18 STAINLESS HEX NUT	4	38388
6	MOTOR PLATE 1087DC	1	101051
7	2.5" PULLEY .625 BORE	1	12228
8	AX33 DRIVE BELT	1	42513
9	8" PULLEY .625 BORE W/KEY	1	12246
10	KEY .187 X .187 X 3/4	1	12509
11	* SHAVER HEAD ASSY 1087NS	1	41146
12	BELT TENSIONER ASSEMBLY	1	42503
13	IDLER TENSIONER PULLEY ASSEMBLY	1	42509
14	3/8-16 HEX NUT	1	46000
15	3/8-16 X 2 HEX HD BOLT	1	12470
16	BELT TENSIONER WELDMENT	1	42244
17	1/4-20 X 3/4 HEX CAP 18-8	2	12515
18	BELT TNSR GUIDE 1087NS (Spacer)	2	42603
19	1/4 SPRING LOCK WASHER	2	12707
20	1/4-20 HEX NUT, S.S.	2	12706
21	RELAY SPST 30A 12VDC	1	55432



# Shaver Head Assembly

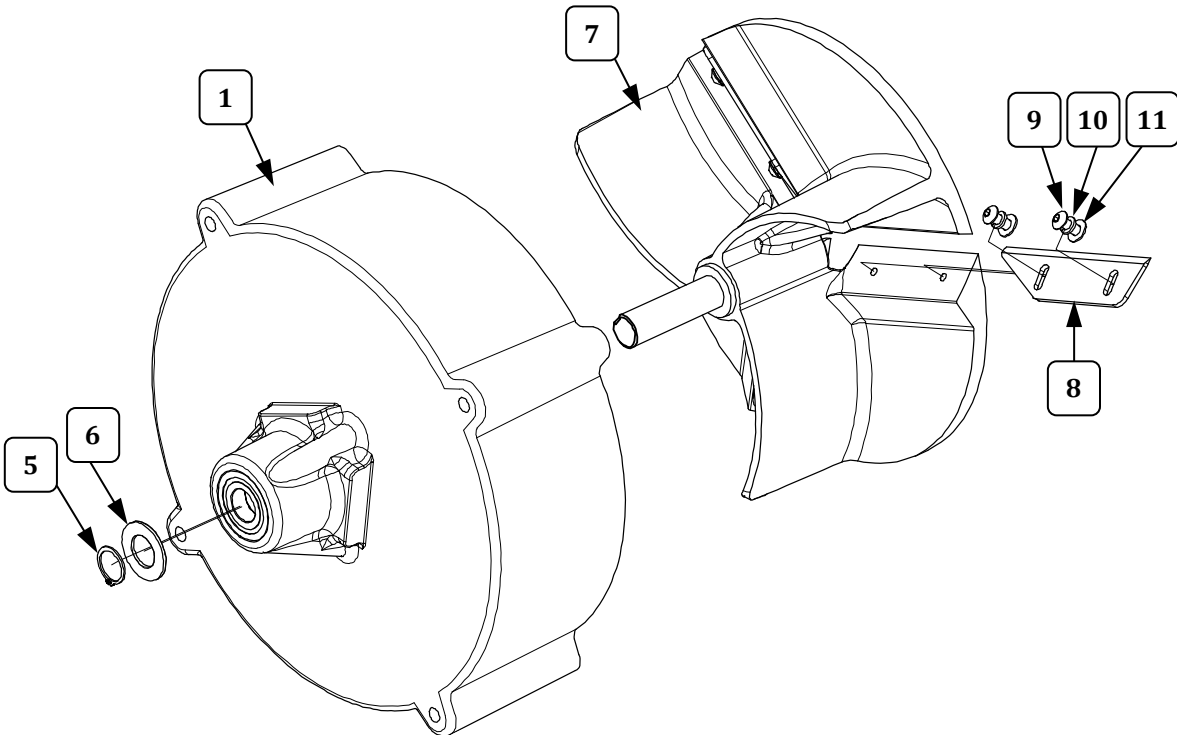
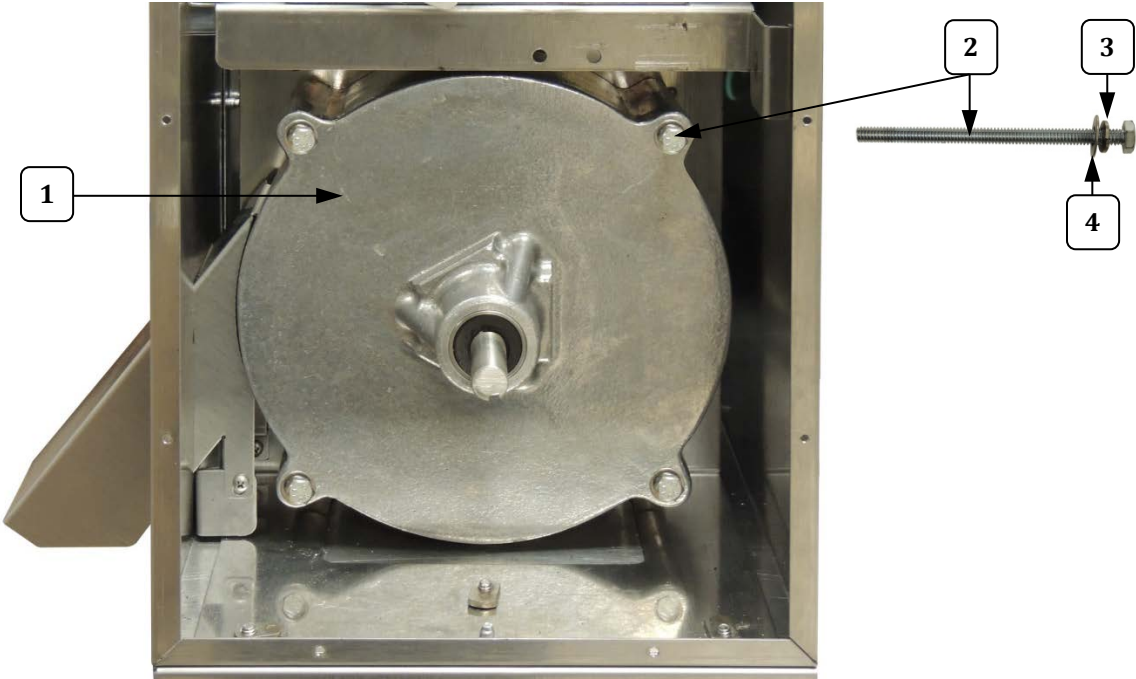

## Cabinet Interior – Motor – Parts List

Item	Part Description	Qty.	Part No. 1087DC
1	IMPELLER HOUSING ASSEMBLY	1	41110
2	HEX HD BOLT 1/4-20 X 4	4	42530
3	1/4 SPRING LOCK WASHER	4	12707
4	FLAT WASHER 1/4 STAINLESS	4	87261
5	EXTERNAL SNAP RING	1	12497
6	THRUST WASHER SET F 5/8 IN SHF	1	39029
7	SHAVER HEAD ASSEMBLY	1	41146
8	SHAVER BLADE 1087NS (3 required for each shaver head. All replacement blades include a Height Gauge.)	3	41310
9	10-24 X 1/2 CAP SCREW	6	12467
10	#10 S.S. MED LOCK WASHER	6	12493
11	#10 FLAT WASHER ST. STL	6	12178

## Accessories



Item	Part Description	Qty.	Part No. 1087DC
1	DRAIN PAN W/FITTING	1	12464
2	DRAIN HOSE 3/8 ID 1/16 W	3 ft.	22034
3	HOSE CLAMP W/SCREW	1	41163
4	ICE PAN	1	29004
5	BLOCK ICE MOLD	1	1487
6	ICE PICK	1	22020
7	8 OZ SNO-KONE® DIPPER	1	1068



# WIRING DIAGRAM

Model No. 1087DC

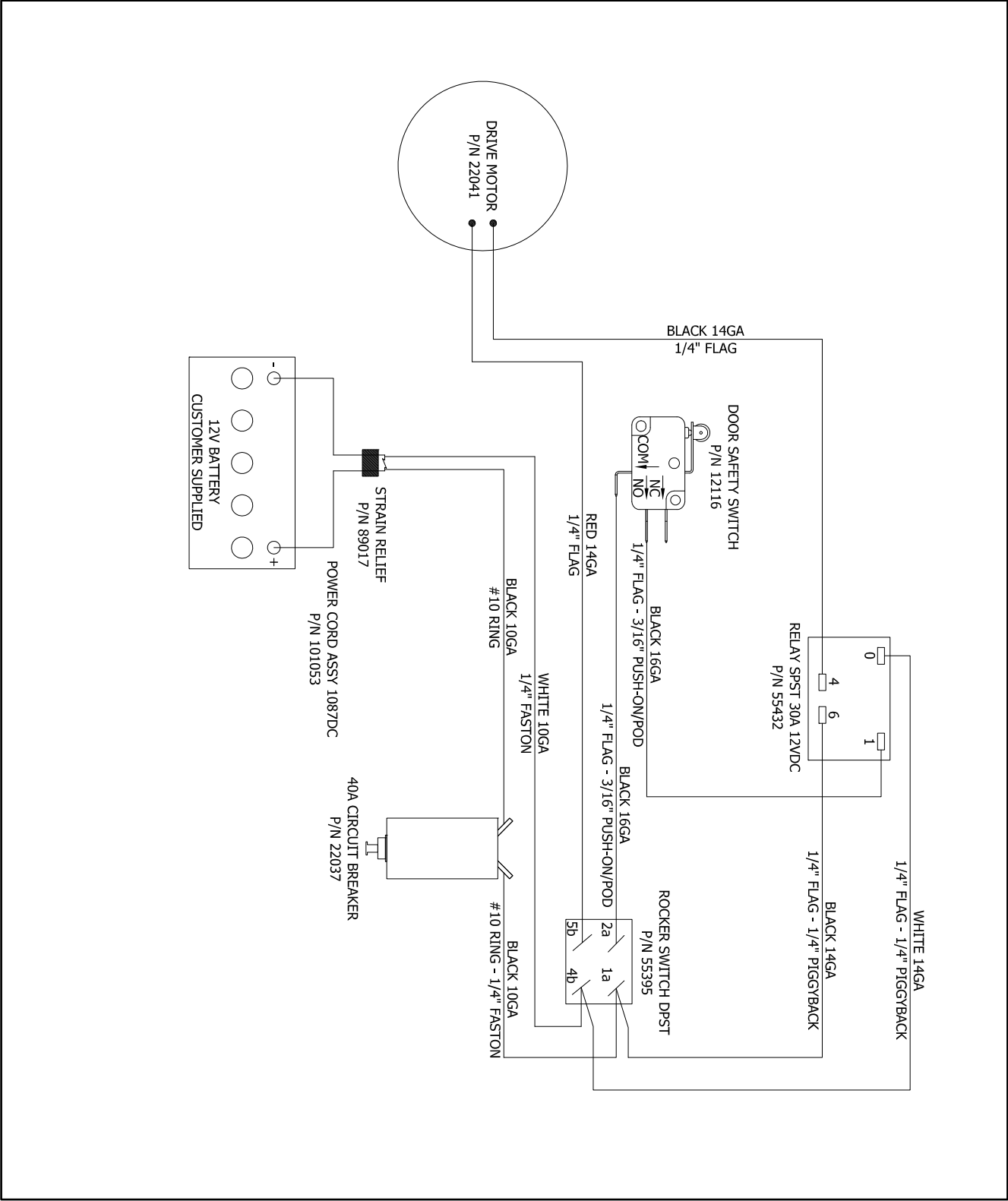



## WARRANTY

Gold Medal Products Co. warrants to the original purchaser each item of its manufacture to be free of defects in workmanship and material under normal use and service. Gold Medal Products Co.'s obligation under this warranty is limited solely to repairing or replacing parts, f.o.b. Cincinnati, Ohio, which in its judgment are defective in workmanship or material and which are returned, freight prepaid, to its Cincinnati, Ohio factory or other designated point. Except for "Perishable Parts" on specific machines, the above warranty applies for a period of two (2) years from the date of original sale to the original purchaser of equipment when recommended operating instructions and maintenance procedures have been followed. These are packed with the machine. Parts warranty is two (2) years, labor is six (6) months.

THIS WARRANTY IS IN LIEU OF ALL OTHER WARRANTIES EXPRESSED OR IMPLIED, AND OF ALL OTHER OBLIGATIONS OR LIABILITIES ON OUR PART, INCLUDING THE IMPLIED WARRANTY OF MERCHANTABILITY. THERE ARE NO WARRANTIES WHICH EXTEND BEYOND THE DESCRIPTION ON THE FACE HEREOF. In no event shall Gold Medal Products Co. be liable for special, incidental or consequential damages. No claim under this warranty will be honored if the equipment covered has been misused, neglected, damaged in transit, or has been tampered with or changed in any way. No claim under this warranty shall be honored in the event that components in the unit at the time of the claim were not supplied or approved by Gold Medal Products Co. This warranty is effective only when electrical items have been properly attached to city utility lines only at proper voltages. This warranty is not transferable without the written consent of Gold Medal Products Co.

The term "Original Purchaser" as used in this warranty shall be deemed to mean that person, firm, association, or corporation who was billed by the GOLD MEDAL PRODUCTS CO., or their authorized distributor for the equipment.

THIS WARRANTY HAS NO EFFECT AND IS VOID UNLESS THE ORIGINAL PURCHASER FIRST CALLS GOLD MEDAL PRODUCTS CO. AT 1-800-543-0862 TO DISCUSS WITH OUR SERVICE REPRESENTATIVE THE EQUIPMENT PROBLEM, AND, IF NECESSARY, FOR INSTRUCTIONS CONCERNING THE REPAIR OR REPLACEMENT OF PARTS.

*NOTE: This equipment is manufactured and sold for commercial use only.*



**GOLD MEDAL<sup>®</sup> PRODUCTS CO.**

10700 Medallion Drive, Cincinnati, Ohio 45241-4807 USA

[gmpopcorn.com](http://gmpopcorn.com)

Phone: (800) 543-0862      Fax: (800) 542-1496  
(513) 769-7676              (513) 769-8500