

Maintenance (Refer to the sketches on the next page)

1. Cautions

- ① MEDO blowers are OILLESS. Never lubricate them. ⚠
- ② All blowers have already been precisely adjusted. Never disassemble them. ⚠
(Do not try to loosen the Hex. Bolts on the Endcap)

2. Replacement of Filter Element

- ① Be sure to unplug the blower before starting the replacement work. ⚠
- ② Loosen the Bind Screw ① and remove the Filter Cover ④.
- ③ Remove the Filter Element(s) ⑤ from the Upper Case ⑥ and replace it with new One(s). At the same time, clean the air inlet of the Filter Cover ④ and the Upper Case ⑥.
- ④ Assemble the Filter Cover ④ with the Filter Cover Gasket ③ securely positioned.
- ⑤ Mount the Filter Cover ④ on to the Upper Case ⑥, then tighten with the Bind Screw(s) ①.
- ⑥ **Filter Element replacement Period**
It is recommended that the Filter Element(s) is cleaned or replaced with a new one(s) depending on the extent of its deterioration as determined by the atmospheric conditions around the application. The filter element(s) should be checked every three months.

3. Replacement of Piston Set Assembly

- ① Be sure to unplug the blower before starting the maintenance work. ⚠
- ② Remove the Upper Case ⑥, loosen all the Hex. Bolts ⑨ on the Headcover ⑩ and remove it. In case it is hard to remove the Headcover ⑩ insert a flat head screwdriver into the slot(s) at the edge of the Headcover ⑩ and twist the screwdriver gently to open.
- ③ Take out the Piston Set Assembly(s).
- ④ Replace all Piston Set Assemblies, Gasket A ⑪ and Gasket B ⑫ with new ones.
Be sure to keep the Teflon Seal of the Piston ⑬ away from any dust, swarf, water, oil or grease. Try not to touch the Teflon Seal of the Piston ⑬ with your fingers.
- ⑤ Insert the Piston Set Assembly(s) into the Pump Body, then fasten the Headcover ⑩ with the Hex. Bolts ⑨. Tighten the Hex. Bolts ⑨ evenly and alternately then gradually tighten them fully.
- ⑥ Before putting the Upper Case ⑥ back, start the blower and check if there is any air leakage around the Headcover ⑩ or the Nozzle Seal(s) ⑭ by briefly blocking the air outlet. If there is an air leakage around the Headcover ⑩, re-position Gasket A ⑪ and Gasket B ⑫ then re-fasten the Hex Bolts ⑨. If there is an air leakage around the Nozzle Seal(s) ⑭ check if the nozzle seal is properly positioned on the airtank and press the pump body down to allow the outlet port of the Headcover to catch the Nozzle Seal(s) correctly.
- ⑦ Put the Upper Case ⑥ back after installing Gasket C ⑧ on the Bottom Case properly. Fasten the Bind Screws/Torx Screws ⑦ evenly and alternately.
- ⑧ **Piston Set Assembly replacement period**
It is suggested that the Piston Set Assembly is replaced every 12 to 24 months depending on the extent of the blower's pressure and airflow deterioration. There is a groove on each Teflon Seal of the Piston indicating the degree of wear. If one or both grooves are worn away, replacement of the Piston Set Assembly is recommended.

Piston

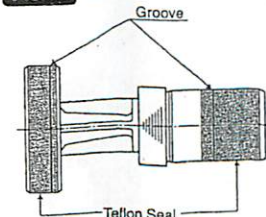

Piston cross-sectional view

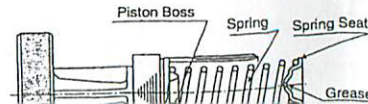

Cautions

- Fix the spring into the piston by rotating it clockwise.
- Check that grease is present on the convex face of the spring seat.
(If no grease is present, please contact your supplier)
- Never use standard grease as it may cause a malfunction.

LA-28B/LA-45B

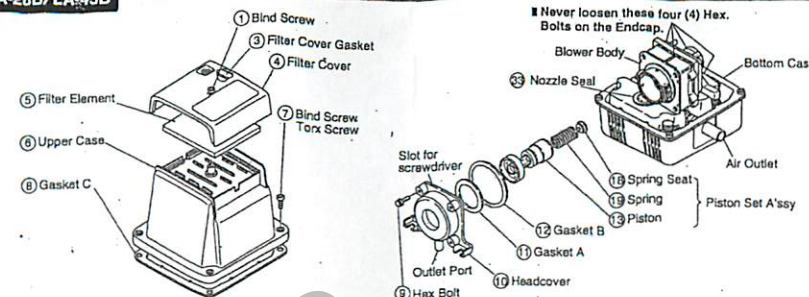

LA-60A/LA-80A

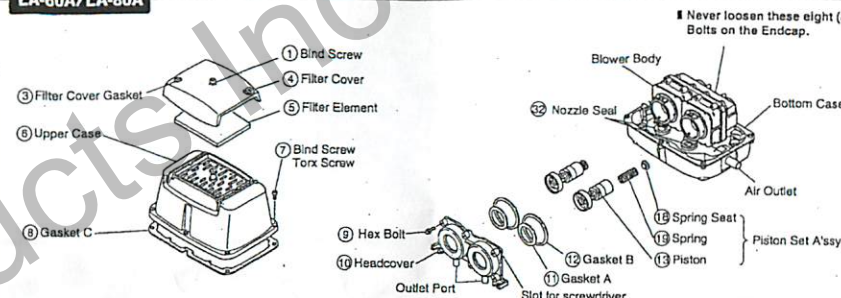

LA-60B/LA-80B

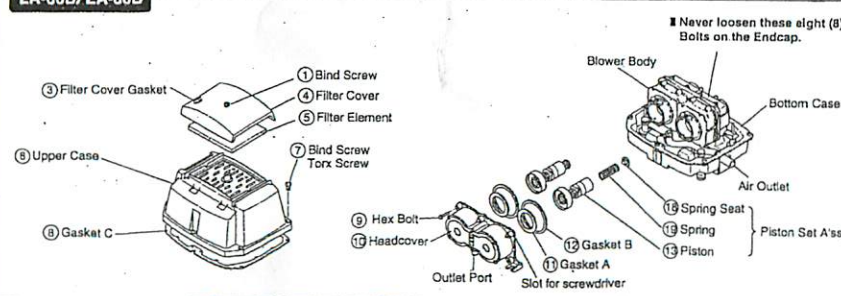

LA-100/LA-120

