

# AMI SERIES

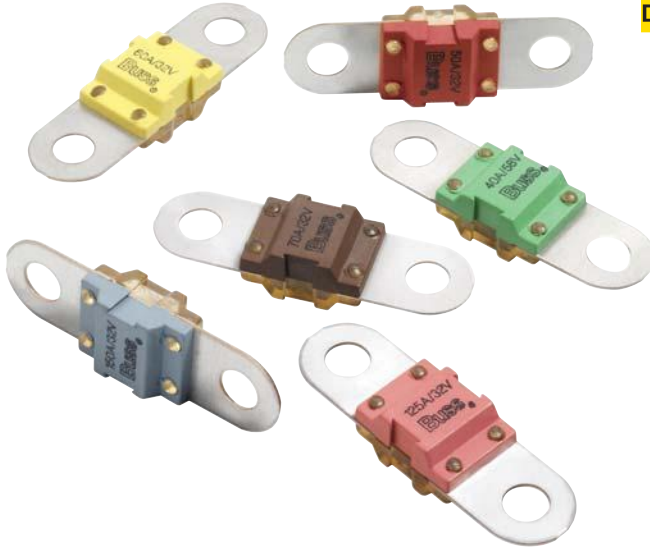

## DIMENSIONS (Dims. shown are for reference only. Consult factory for latest prints)

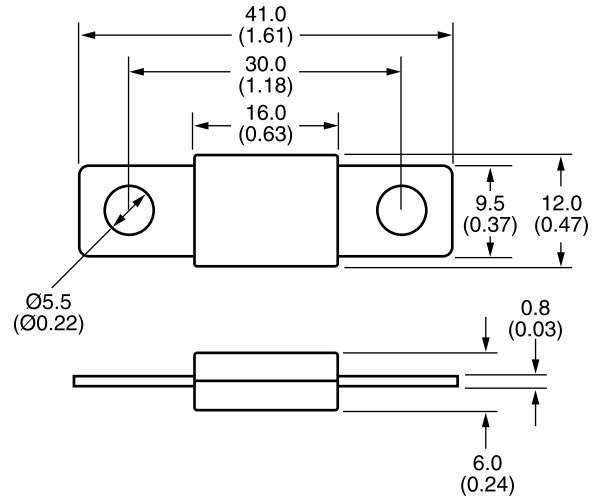

## BOLT IN AUTOMOTIVE FUSES

### SPECIFICATIONS:

**Applications:** Power distribution protection for automotive systems. Consult factory for available fuse-holders.

**Current Rating:** 30-150A.

**Voltage Rating:** 32VDC.\*

**Interrupt Rating:** 2000A @ 32VDC.

**Housing Material:** UL-Rated 94V-0 thermoplastic.

**Terminal Material:** Tin-plated brass.

**Mounting:** Max torque of 35in-lb (4Nm).

**Marking:** Color-coded housings for each amperage.

\*Consult factory for higher voltage fuses.

### TIME-CURRENT SPECIFICATIONS

% of Rating	Opening Time	
	Minimum	Maximum
100	100 hrs	
110	4 hrs	
150	90 s	3600 s
200	5 s	100 s
300	0.3 s	10 s
500	0.1 s	1 s

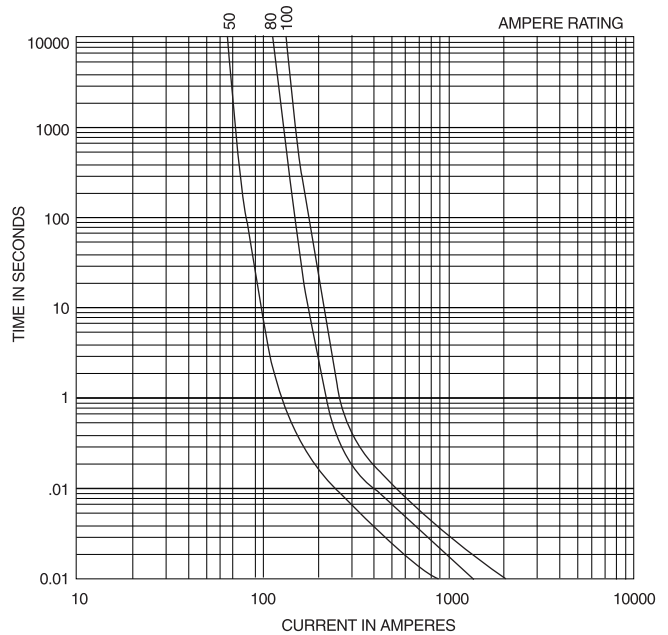

### PART NUMBERING SYSTEM

#### Series

**B** **K** / **A** **M** **I** - **□** **□** **□**

#### Rating

- 030 - 30 amps (orange)
- 040 - 40 amps (lt. green)
- 050 - 50 amps (red)
- 060 - 60 amps (yellow)
- 070 - 70 amps (brown)
- 080 - 80 amps (white)
- 100 - 100 amps (blue)
- 125 - 125 amps (pink)
- 150 - 150 amps (gray)