



Spectrum DF



CR123A BATTERIES



18650 RECHARGEABLE

In certain operational settings, a specific color output is desirable. Red retains night vision and provides emergency signaling. Green provides a longer run time. Blue allows low light identification, highlights bodily fluids and cuts through fog. A strobe can be used for signaling or as a force multiplier. The Spectrum DF is designed for these specific activities. The multicolor Spectrum is essentially six lights in one. It provides variable outputs from two power sources.

The Spectrum DF is a four color output Dual Fuel light that may run on either two CR123A Lithium primary cells or one 18650 Lithium-ion rechargeable battery. The Spectrum is packaged with two ASP primary batteries. The light may be recharged by purchasing an optional ASP Dual Fuel Charge Kit.

Rotating the bezel of the Spectrum reveals a gray selector button. This button rotates through the secondary light outputs (Red, Green, Blue, 15 lumen White, Strobe). Closing the bezel locks in the selected option. Activation of the Spectrum is simple and intuitive. The rear mounted switch button has a universal orientation. Press the button once to activate the high setting of the Spectrum. Press the button twice (Double Tap) to activate the pre-selected secondary output.

The body of the Spectrum has a unique foamed vinyl grip. A replaceable pocket clip positions the light lens down.

A micro USB charge port, charge indicator and battery capacity meter can also be found by rotating the bezel. When using the optional 18650 rechargeable battery, the capacity meter shows green at >50%, yellow at 20-50% and red at <20% battery capacity. The charge indicator flashes red when charging and turns solid green when fully charged. The 18650 battery may be charged in the light using the charge port under the bezel or by connecting directly to the charge port in the cell.

The Spectrum DF. A mission specific light built to the standards of ASP.

- Dual Fuel CR123A or 18650
- Optional Red, Green, Blue, 15 Lumen White, Strobe
- Type III Hardcoat Anodizing
- Foamed Vinyl Grip
- Intermittent · Locked · Constant Switch



Spectrum DF . . . Simply Brilliant



The Spectrum DF can also be powered by one 18650 battery.

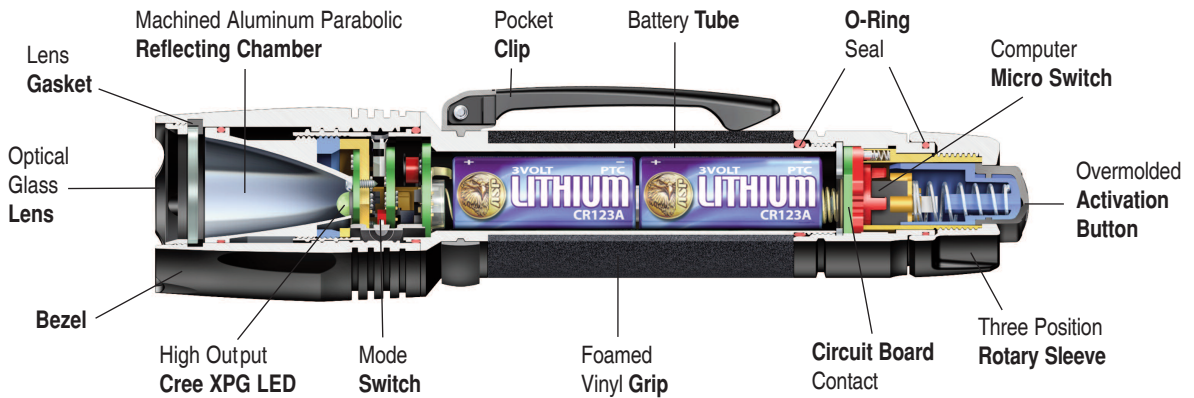

Background

- Designed to professional law enforcement standards
- Aerospace aluminum construction
- Precision machined
- No sharp edges
- O-ring sealed for maximum water resistance
- Distinct profile
- Dual Fuel

Specifications

Length	6.26"	159 mm
Diameter	1.42"	36 mm
Weight	6.5 ounces	184 grams
	(with batteries)	

CR123A

System	6 volt
High Output	300 lumens (ANSI Standard)
High Run Time	1 hour
Second Output	

Programmable

Red	60 lumens	7 hours 30 min
Blue	15 lumens	3 hours 45 min
Green	90 lumens	3 hours 45 min
15 Lumen White	15 lumens	18 hours
Strobe	245 lumens	4 hours

18650

System	3.7 volt
High Output	250 lumens (ANSI Standard)
High Run Time	1 hour
Second Output	

Programmable

Red	40 lumens	11 hours 30 min
Blue	15 lumens	13 hours
Green	70 lumens	9 hours 30 min
15 Lumen White	15 lumens	43 hours
Strobe	230 lumens	4 hours 15 min

Body

- 6061 T6 high strength aluminum
- Matte black finish
- Type III hardcoat anodized
- Coated threads for durability
- Exterior and interior scratch and corrosion protection
- Foamed vinyl grip

Pocket Clip

- Detachable

Power Cell

- Proprietary
- Rechargeable
- 18650 Lithium-ion
- 3.7 volt
- 2600 mAh
- Integral micro USB charge port
- PTC protected
- PCM protected
- Overcharge protection
- Fast discharge protection
- Short circuit protection
- Leak proof
- Vibration resistant
- Ten year shelf life
- Link case

Charge System

- Micro USB
- Flashing red charging
- Solid green fully charged

Charging Accessories

- Wall Charger
- Car Charger
- Blue power indicator
- Retractable cord
- Reversible plugs

Battery Capacity Meter

- Senses remaining power
- Press activation button
- Green > 50%
- Yellow 20% - 50%
- Red < 20%

Power Cell Tube

- Foamed vinyl grip
- O-ring sealed

Locking Switch

- Back mounted
- Quick and positive switch location under stress
- O-ring sealed activation button
- Locked (center)
- Constant on/off switch activation (right)
- Intermittent switch activation (left)
- O-ring sealed switch cover
- PC board positive circuit contact
- Sensitive and quiet switch activation
- Computer micro switch controlled
- Self-cleaning (no carbon buildup)
- Fail safe (backup) switch circuits
- Replaceable modular switch assemblies
- O-ring sealed connection to the light body

Reflector Assembly

- Parabolic
- Extremely durable
- Computer calculated ray traces
- Long distance penetrating beam
- Room illuminating halo
- Tempered optical glass lens
- Gasket sealed

LED Assembly

- Cree XML-C LED
- Proprietary heat management
- Custom driver
- Smart chip technology
- Gasket sealed

Belt Case

- Injection molded
- TLC Tactical Light Case

Travel Case

- Ballistic Weave
- Zippered

Warranty

- Limited Lifetime



TLC Tactical Light Cases protect and securely retain the Spectrum.

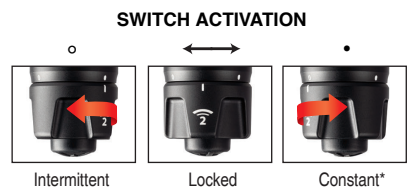

NOTE: Use only ASP 18650 Lithium-ion rechargeable batteries with Spectrum DF lights.

