

Specifications

Out of the Box

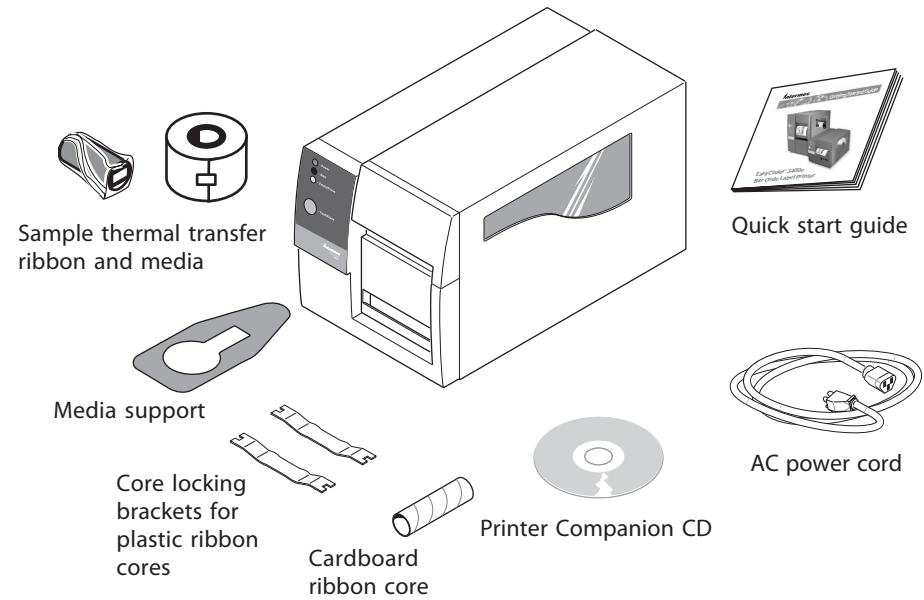

Note: Make sure that you remove all packing material from the printer before you proceed.

Note: If you are using plastic ribbon cores, you need to install the core locking brackets for the plastic ribbon cores. For help, see the printer user's manual.

Electrical Requirements

Input Voltage: ~100, 120, or 230 V ±10%
Frequency: 47-63 Hz

Environment

Operating: 4°C to 40°C (40°F to 104°F)

Storage: 0°C to 70°C (32°F to 120°F)

Humidity: 10% to 90% noncondensing

Options and Accessories

EasyLAN Wireless: This option lets the printer communicate either wirelessly with a PC using an 802.11b radio card or with other devices through an access point.

EasyLAN 10/12 Ethernet adapter: This accessory allows you to share available printer resources through an Ethernet network.

Media Accessories

The self-strip option is a factory-installed accessory. The cutter can be factory- or field-installed.

Connecting the Printer

You can connect your printer to a PC, a local area network, an AS/400 (or other midrange system), or a mainframe. This section explains how to connect the printer to your PC. You can connect the printer to either a serial (COM) port or a parallel port on your PC. You must provide the correct cables to connect the printer. Use the following table to determine the correct Intermec cable for your application.

For Connecting To	Use Intermec Cable
PC serial port	IBM PC, 25-pin printer to 9-pin, null modem (P/N 048693) IBM PC, 25-pin printer to 25-pin, null modem (P/N 048668)
PC parallel port	Parallel port cable (P/N 590124)

Contact your local Intermec representative for ordering assistance.

- 1 Turn the On/Off switch to the off (O) position.
- 2 Plug the appropriate connector into the serial (A) or parallel (B) communications port.

Plug the other end of the cable into a serial or parallel port on your PC.

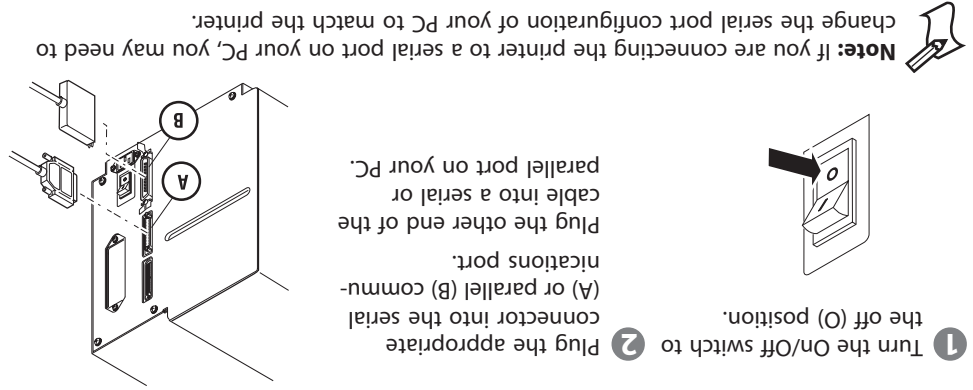

More Information

For more information on using these printers, please see:

- *EasyCoder® 3400e Bar Code Label Printer User's Manual* (P/N 071881)
- *EasyCoder® 4420/4440 Bar Code Label Printer User's Manual* (P/N 066392)
- Intermec web site at www.intermec.com

EasyCoder 3400e, 4420, 4440 Bar Code Label Printer Quick Start Guide



072004-003

Intermec

Technologies Corporation
6001 36th Avenue West
Everett, WA 98203
U.S.A.

www.intermec.com

© 2003 Intermec Technologies Corp.
All Rights Reserved

On the CD

Congratulations on your purchase of the EasyCoder 3400e, 4420, or 4440 Bar Code Label Printer. These printers combine performance, economic value, and ease of use. Your printer is equipped with the Printer Companion CD, a sample roll of media, and a sample roll of thermal transfer ribbon.

The Printer Companion CD contains technical documentation, information about Intermec media supplies, and software. This overview will help you get the most from your printer:

PrintSet™ PrintSet is a Microsoft® Windows™-based configuration utility that lets you set print speed and media sensitivity for optimum print quality. You can also use PrintSet to download additional fonts or graphics and install new flash-based firmware.

InterDriver™ InterDriver is a sophisticated Windows printer driver that is compatible with Windows 95, 98, ME, NT v4.0, 2000, and XP.

ActiveX® Controls ActiveX Controls insert bar codes into Microsoft application programs printed with InterDriver.

LabelShop® START LabelShop START is a basic Windows-based design and print software package.

Quick Start Guide



**EasyCoder® 3400e, 4420, 4440
Bar Code Label Printer**

