

EasyDL

TotalFreedom Plug-In

Honeywell's EasyDL™ software plug-in parses bar code data found on government-issued identification card for applications involving age verification or automatic electronic form population.



Powered by Honeywell's TotalFreedom™ open-system architecture, EasyDL eliminates the need for host system software to process the encoded information contained within 1D and 2D bar codes on documents such as military issued IDs, driver's licenses and driver's permits.

EasyDL can be pre-installed on select Honeywell imaging products or purchased as a standalone upgrade. After installing the plug-in, a simple programming sequence enables you to transmit up to 24 data fields in any order you choose. Separate fields by selecting one of six available delimiters.

When you enhance a Honeywell imager with EasyDL, you've just taken an important step toward protecting your company and increasing efficiency.

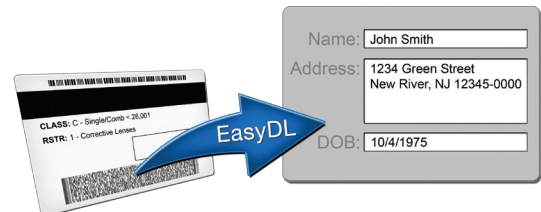
For more information on EasyDL, please visit www.honeywellaidc.com



Compatible with the following products:	
	Genesis™ 7580
	Vuquest™ 4980
	Focus® 1690
	FocusBT® 1633
	IS4920

Features

- **Reduces Transaction Time by 95%:** It takes the average person approximately 45 seconds to manually enter license data. EasyDL achieves the same result in the 2 seconds it takes to scan a license's bar code
- **Eliminates Data Entry Error:** The average person makes one error for every 20 words typed—EasyDL eliminates these costly errors by automatically populating electronic forms
- **Reduces Liability:** EasyDL takes the guesswork out of age verification, reducing the likelihood of selling age-restricted products to under age purchasers
- **Achieves Regulatory Compliance:** Comply with HIPAA patient confidentiality regulations and other state and federal regulations regarding the acquisition of personal information by configuring EasyDL to parse bar code data and remove sensitive information from being transmitted to the host system

EasyDL in Action

Use EasyDL in a wide variety of industries such as retail, healthcare and financial services to quickly and accurately populate an assortment of forms including:

- Employment applications
- Bank account applications
- Patient admittance forms
- Registration forms
- Loyalty program/membership applications
- Credit applications

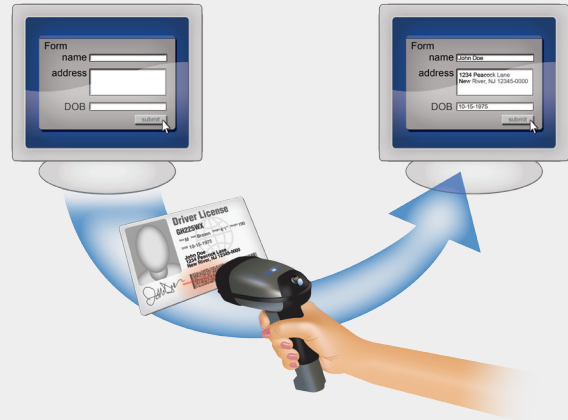

Automatically populate electronic forms in a single scan

Supported IDs

United States	AK	IA	MO	PA
Driver's Licenses	AL	ID	MS	RI
	AR	IL	MT	SC
	AZ	IN	NC*	SD
	CO	KY	ND	TN
	CT	KS	NE	UT
	DC	LA	NH	VA
	DE	MA	NJ	VT
	FL	MD	NV	WA
	GA	ME	NY	WI
	HI	MN	OK	WV
			OR	WY

Government Issued IDs US Military ID*
Common Access Card (CAC)

Canadian Provincial NB
Driver's Licenses QC

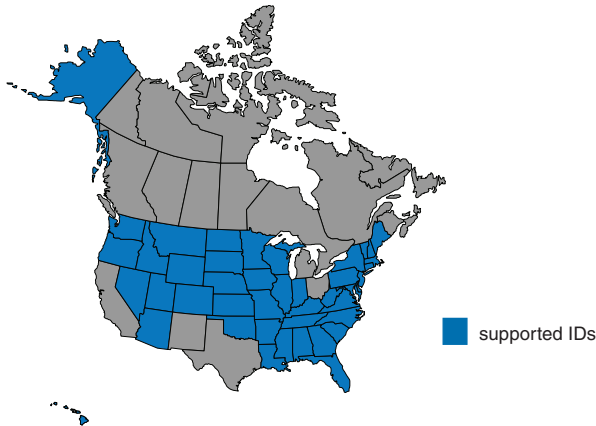

Formatting Options

Typical Data Fields	First Name	Weight
	Middle Name	Eye Color
	Last Name	Hair Color
	Date of Birth [†]	Sex
	ID Expiration Date [†]	Customer ID
	ID Issued Date [†]	ID Number
	Address	Class
	Address1	Restriction
	City	Endorsements
	State	IIN
	Postal Code	Duplicates
	Height	Organ Donor

[†] Date fields can be transmitted as MM/DD/YYYY, MMDDYYYY, MM/DD/YY, MM-DD-YY, MMDDYY or MM-DD-YYYY.

Field Delimiters Comma, Tab, Carriage Return, Dollar Sign, Carrot, Semi-colon

*Variations exist within different ID formats that some versions may contain encrypted data that cannot be processed by EasyDL. These codes, when read, could negatively impact system performance if the unit is not configured to ignore these codes.

For more information:

www.honeywellaidc.com

Honeywell Scanning & Mobility

9680 Old Bailes Road

Fort Mill, SC 29707

800.582.4263

www.honeywell.com

Honeywell