



Visite la página TRAXXAS.com/manuals para descargar el instrucciones en su idioma.
Auf TRAXXAS.com/manuals können Sie anleitung in Ihrer Sprache downloaden.

Big Bore Shock Kit Instructions

Installation Note: The Big Bore Shock Kits come with two plastic parts trees with extra pre-load spacers, shock pistons, and upper shock bushings. The plastic shock bushings are required to be used with the aluminum Big Bore shocks for smooth operation.

Fill the Shocks with Oil

Unscrew the shock cap from the top of the shock. Fill the shock with silicone shock oil up to the top of the shock body. Slowly move the piston up and down (always keeping it submerged in oil) to release the air bubbles. Let the shock sit for a few minutes to allow any remaining air bubbles to surface.

1. Remove the stock shocks. Retain all hardware.
2. Install the lower Big Bore shock ends into the desired shock location on the suspension arms and secure the shocks with the retained hardware. **Note:** Reuse of stock hollow ball may be necessary in some applications.
3. Insert a plastic shock bushing (from the included plastic parts tree) into each of the Big Bore shock caps.
4. Insert a screw through each shock bushing and secure each shock to the front and rear shock towers.

Vehicle	Front shock	Rear shock
Bandit	Long (2660)	XX-long (2662)
Rustler	Long (2660)	XX-long (2662)
Stampede	Long (2660)	XX-long (2662)
Stampede 4x4	Long (2660)	XX-long (2662)
Slash	Long (2660)	XX-long (2662)
Slash 4x4	Long (2660)	XX-long (2662)

Covers Part #2658, #2659, #2660, #2661, #2662

- 2658 (short Big Bore shocks)
- 2659 (medium Big Bore shocks)
- 2660 (long Big Bore shocks)
- 2661 (X-long Big Bore shocks)
- 2662 (XX-long Big Bore shocks)

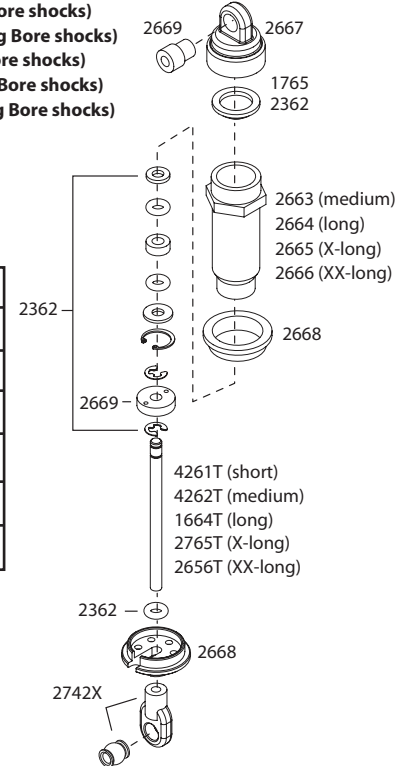

If you have questions or need
technical assistance, call Traxxas at

1-888-TRAXXAS

(1-888-872-9927) (U.S. residents only)

TRAXXAS.COM

Traxxas, 1100 Klein Road, Plano, TX 75074, Phone: 972-265-8000, Fax: 972-265-8011, e-mail: support@Traxxas.com

Rev 130128-R00