

Code Setting Guide

COMPASS HANDHELD GPS CONNECTOR

GPS TRACKING & TRAINING SYSTEM

PATHFINDER2 Series GPS receiver: PR20U, PM20U
COMPASS HANDHELD GPS CONNECTOR: PT21U

Dogtra Customer Service

12322 Monarch Street, Garden Grove, CA 92841

(888) 811-9111

repair@dogtra.com

Mon - Fri, 8:00 AM to 4:30 PM (PST)

© 2025 Dogtra. All rights reserved.

Visit [Gun Dog Supply.com](http://GunDogSupply.com)
Order a Dogtra Pathfinder2 Mini Compass
See other Dogtra products

ver.1



PROTECT YOUR SCREEN



Remove the vinyl film from the LCD screen of the COMPASS HANDHELD GPS CONNECTOR, then apply the provided screen protector to prevent scratches or damage.

PF2 PAIR YOUR COMPASS HANDHELD GPS CONNECTOR WITH THE PF2 APP

Download the app using the QR code, and follow these steps to pair the app with your handheld device:



App Store



Google Play

Bluetooth® 5.0 required

01



Turn on the **COMPASS HANDHELD GPS CONNECTOR**. Launch the **PF2 App** on your phone — ensure Bluetooth is turned on and keep both devices close together.

02



In the app, go to the Menu tab and tap **“Connection Failed with GPS Connector.”**

03



On the pairing screen, select **“PF2 COMPASS HANDHELD”** and press **Next**.

04



Follow the on-screen instructions to complete the pairing process.

NOTE: The COMPASS HANDHELD GPS CONNECTOR can be used as a standalone device after the initial setup. You can reconnect it to the app anytime to change settings.

HOW TO PAIR A PATHFINDER2-SERIES GPS RECEIVER

STEP 01

Turn on the PATHFINDER2-series GPS receiver and the COMPASS HANDHELD GPS CONNECTOR, and keep both devices close together. On your handheld, press and hold the **Menu** button to display the screen shown on the right. Use the **Next** button to navigate, then select **Device Connect**.

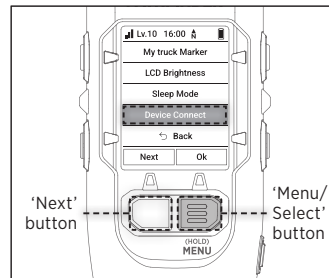

STEP 02

1. Select **Add Receiver** using the **Menu/Select** button to start pairing mode.
2. Press and hold the Power button on the **PATHFINDER2-series GPS receiver** until the LED begins blinking rapidly in green.
3. If pairing does not start, bring the two devices closer together and try again. Ensure both batteries are fully charged.

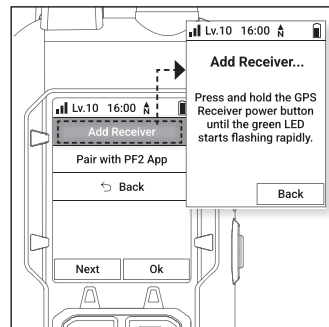

STEP 03

Once pairing is complete, the paired GPS receiver will automatically appear in the device list on both the handheld and the PF2 app.

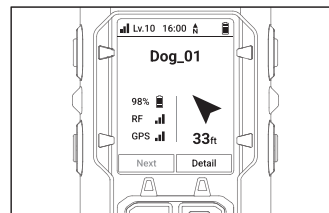

YOU'RE ALMOST READY TO START USING IT!



Turn on the receiver included in the package. It's already paired with the COMPASS HANDHELD GPS CONNECTOR. The receiver is ready to use once the handheld screen displays the image shown on the right, and the receiver's LED begins blinking every two seconds.

WHEN THE GPS SIGNAL IS NOT FIXED

GPS signal strength/status of the **HANDHELD**.

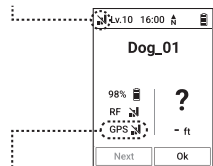

GPS signal strength/status of the **Receiver**.

If a GPS signal is not detected, you'll see the signal status image as shown above. **Take the device(s) outside to an open area and hold them higher, with the antenna facing the sky.** Using the device indoors, near tall buildings, or in areas with heavy vegetation may reduce GPS accuracy and cause this issue.

WHEN THE COMPASS CAN'T FIND ITS DIRECTION

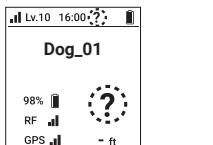

If the compass has trouble finding its direction, **follow the on-screen instructions to move the COMPASS HANDHELD GPS CONNECTOR** around until it recalibrates. Once the compass direction is acquired, the device will automatically return to the main screen.

** To manually access the calibration screen, press and hold the front left button on the handheld.*

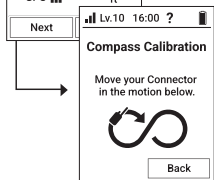

COMPASS HANDHELD GPS CONNECTOR STANDALONE FEATURES WITHOUT PF2 APP (No App Required After Setup)



100-Level Rheostat Dial

Adjustable Low to High stimulation in 100 levels.

Customizable Training Buttons

Define a set of button function configurations applied to the selected dog/receiver, or a dedicated function per dog/device per button

Live Tracking Compass

Multi-GNSS supported with a 3-axis compass for accurate tracking even while in motion.

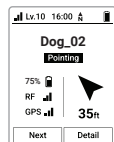

Next Dog View

Press the front left button
*** Available only when two or more dogs are connected.**

Power Button

Press and hold to power off.

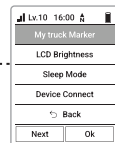

Menu View

Press and hold the front right button.

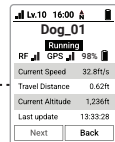

Detail View

Press the front right button briefly.

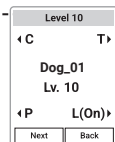

E-Collar View

Tap the power button to view the E-collar View without tracking information

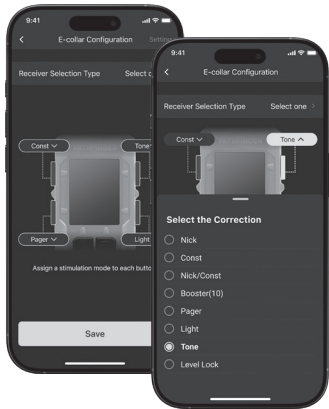

COMPASS HANDHELD GPS CONNECTOR ENHANCED FEATURES WHEN CONNECTED TO PF2 APP

- Multi-device display settings
- Customizable E-collar buttons
- Truck location marking
- Adjustable notifications, screen brightness, and measurement units



PF2 APP — MOBILE-ONLY FEATURES

(Available exclusively through the PF2 App)

- Detailed live map views, including offline maps
- Geo-Fence & Mobile-Fence (notifications only)
- E-Fence (with correction)
- Advanced tools: Timer, Recording, Device Sharing, Channel-Slot Settings

최종X

FCC INSTRUCTIONS

FCC Compliance Statement(Part 15.19 (3))

This device complies with part 15 of the FCC rules. Operation is subject to the following two conditions: (1) This device may not cause harmful interference, and (2) this device must accept any interference received, including interference that may cause undesired operation.

FCC Interference Statement(Part 15.105)

This equipment has been tested and found to comply with the limits for a Class B digital device, pursuant to part 15 of the FCC Rules. These limits are designed to provide reasonable protection against harmful interference in a residential installation. This equipment generates, uses and can radiate radio frequency energy and, if not installed and used in accordance with the instructions, may cause harmful interference to radio communications. However, there is no guarantee that interference will not occur in a particular installation. If this equipment does cause harmful interference to radio or television reception, which can be determined by turning the equipment off and on, the user is encouraged to correct the interference by one of the following measures:

- Reorient or relocate the receiving antenna.
- Increase the separation between the equipment and receiver.
- Connect the equipment into an outlet on a circuit different from which the receiver is connected.
- Consult the dealer or an experienced radio/TV technician for help.

FCC Caution

Any changes or modifications not expressly approved by the party responsible for compliance could void the user's authority to operate this equipment. This transmitter must not be co-located or operating in conjunction with any other antenna or transmitter.

FCC Radiation Exposure Statement (Part 2.1093)

This equipment complies with FCC radiation exposure limits set forth for an uncontrolled environment. **This equipment should be installed and operated with minimum distance 20 cm between the radiator and your body.** This transmitter must not be co-located or operating in conjunction with any other antenna or transmitter.

DOGTRA EXTENDED PRODUCT WARRANTY

EXTENDED LIMITED WARRANTY

For Certain Dogtra Products Purchased from Dogtra Authorized Dealers

1+1 Year Extended Warranty

Except as otherwise provided, Dogtra warrants to the original retail purchaser (“You”) that your Dogtra product shall be free of defects in materials and workmanship for a period of one (1) year from the date of purchase (“Original Warranty”). As a special promotion, Dogtra further warrants that your Dogtra product shall be free of defects in materials and workmanship for an additional one (1) year from the date that your original warranty expires (“Extended Warranty”). The Original and Extended Warranties cover the cost of repair (parts and labor) or replacement (if repair is not feasible) of a defective Dogtra product during said warranty periods. For such repaired or replaced products, the remaining portion of the warranty periods, or ninety (90) days, whichever is longer, shall apply. Dogtra, at its sole discretion, shall determine whether to repair or replace a product covered by the Original Warranty or Extended Warranty.

Warranty Conditions

The Original and Extended Warranties are not transferrable and apply to your Dogtra product only if:

- (1) You are the original retail purchaser of the product,
- (2) You bought the product from a Dogtra Authorized Dealer, and
- (3) You present a receipt or other proof of purchase showing a valid purchase date, the name and address of the Dogtra Authorized Dealer, and the purchased product identified by model and/or serial number.

Warranty Exclusions

The Original and Extended Warranties do not cover damage, loss, or deterioration to your Dogtra product caused: by misuse, neglect, abuse, or other improper handling of the product; by failure to follow use or care instructions; by use of the product for other than its intended purpose; by accident or natural forces such as fire or flooding; or by normal wear and tear such as scratches to the product surface.

The Original and Extended Warranties also do not cover Dogtra products that: are purchased from non-authorized dealers; are purchased outside of the United States or Canada; have been damaged during shipment (even if Dogtra paid or arranged for shipping); have been modified or tampered with in any manner; are opened or repaired by anyone other than Dogtra; or have serial numbers that have been altered or defaced.

Sole Warranties

The Original and Extended Warranties are the only warranties offered by Dogtra for your Dogtra product during said warranty periods. Other than the Original and Extended Warranties, Dogtra makes no other representations or warranties whatsoever regarding its products, whether oral or in any product manual, on any packaging, on any website, or in any other written material. No dealer of Dogtra products, nor any employee or agent of Dogtra, is authorized to make any additions, changes, or extensions to the Original Warranty or Extended Warranty. Dogtra, at its sole discretion and at any time, reserves the right to modify the Original and/or Extended Warranties.

DISCLAIMER OF OTHER WARRANTIES

THE FOREGOING ORIGINAL AND EXTENDED WARRANTIES ARE PROVIDED IN LIEU OF ALL OTHER WARRANTIES, WHETHER EXPRESS OR IMPLIED. DOGTRA DISCLAIMS ANY IMPLIED WARRANTIES INCLUDING, BUT NOT LIMITED TO, THE IMPLIED WARRANTIES OF MERCHANTABILITY AND FITNESS FOR A PARTICULAR PURPOSE.

Limitation of Remedies

Dogtra’s liability is limited to the cost of repair or replacement of the Dogtra product under the Original Warranty or Extended Warranty. Any claim or action to enforce the Original and/or Extended Warranties must be commenced within thirty (30) days of such warranty’s expiration for your product. Dogtra will not be liable for any indirect, incidental, special, consequential, or similar damages based on breach of warranty, breach of contract, negligence, strict tort, or any other legal theory related to Dogtra and its products. Damages that Dogtra will not be responsible for include, but are not limited to: loss of income or profits; loss of revenue or savings; loss of use of the product or associated products; cost of any substitute products or services; inconvenience, downtime, or any other time; loss of goodwill; claims of third parties including customers; and damage to property.

Legal Rights May Vary By State or Jurisdiction

The Original and Extended Warranties give You specific legal rights, and You may also have other rights which vary by state or jurisdiction. Some states or jurisdictions do not allow certain limitations of implied warranties or of incidental or consequential damages or other remedies, so certain of the foregoing limitations may not apply to You.

If any portion of the Original Warranty or Extended Warranty is held by a court to be invalid or unenforceable, the remaining portions of such warranties shall remain in full force and effect and shall in no way be affected or invalidated, and the invalid or unenforceable portion shall be modified so as to most nearly achieve the intent of the Original Warranty or Extended Warranty.

Product Registration

Dogtra recommends that customers register their products as soon as possible after purchase. Product registration will facilitate any future warranty service. You may also receive useful information and updates about your existing and future Dogtra products. To register your product, visit www.dogtra.com/product-registration. If your product is not registered with Dogtra, You will be required to provide a receipt or other proof purchase (as provided above) to qualify for warranty service.

How to Obtain Warranty Service

Should your Dogtra product require warranty service, please contact Customer Service by phone or email for a warranty evaluation (see below for contact information). Upon approval of your warranty work, Dogtra will repair or replace (at Dogtra’s election) your product without charge for labor or parts. You are responsible for shipping, including cost, of your product to Dogtra for warranty service. Dogtra will handle shipping, including cost, of the repaired or replaced product back to customers in the USA. Dogtra will not be responsible for shipping, including cost and/or applicable taxes or fees, for products sent outside the USA. Such costs, taxes, or fees will be borne by the customer.

To register your product, visit www.dogtra.com/product-registration.