

STB BEEPER COLLAR STB HAWK COLLAR

RUN/POINT COLLAR

Owner's Manual

Please read this manual thoroughly before operating the STB BEEPER COLLAR or STB HAWK COLLAR.

Visit GunDogSupply.com
Order an STB Beeper Collar
See Other Dogtra Products

IMPORTANT SAFETY AND PRODUCT INFORMATION

WARNING

Please read all safety and product information below before using your Dogtra product. Failure to follow these safety instructions could result in injury to you, your dog and others, or it could result in damage to your Dogtra product or other property.

PRODUCT SAFETY

Training Methods

Dogtra products may be used with a variety of training methods. However, each dog may have a different reaction to training methods and to Dogtra products. Closely observe your dog when determining the right training method to use with your Dogtra product.

Aggressive Dogs

Do not use Dogtra products with aggressive dogs as such dogs may react adversely and cause injury to people or other dogs. Seek the assistance of a dog-training specialist or veterinarian when dealing with aggressive dogs.

Children

Dogtra products are not toys. Adult supervision and close attention are necessary when Dogtra products are used by or near children.

PRODUCT DAMAGE

Electrical Product

Your Dogtra product contains electrical components and batteries. Do not use or keep your product near heat or flammable sources. Such use or storage may damage your

product and/or cause fire, explosion, injury, or property damage.

Medical Device Interference

Dogtra products contain electrical and magnetic components that emit low level electromagnetic waves and radio frequencies. These electromagnetic waves or radio frequencies may interfere with pacemakers, defibrillators, or other medical devices. Consult your physician or medical device maker before using your medical device with a Dogtra product. If you think that your Dogtra product is interfering with your pacemaker, defibrillator, or other medical device, stop using the Dogtra product.

Inadvertent Activation

The digital microprocessor offers thousands of unique codes to eliminate frequency match-up with other Dogtra e-collars. The Constant button will automatically shut down after being held down for 12 seconds or more as a safety feature.

UNAUTHORIZED USE

Your Dogtra product should be used only in a humane manner to train and educate your dog. Dogtra products are not intended for use in any other manner nor are they intended for use with other animals or with humans.

BATTERY

Your Dogtra product contains batteries. Take care when removing and installing batteries as your fingers may get caught. Dispose of batteries as provided by your local regulations. Do not disassemble, crush, heat, or otherwise alter the battery as it may cause fire, injury or property damage.

CONTENTS

AT A GLANCE	5
MAIN FEATURES	6
OVERVIEW	7
UNDERSTANDING YOUR TRAINING SYSTEM	
1. TURNING THE SYSTEM ON/OFF	8
2. BEEPER FUNCTION	9
3. HAWK FUNCTION	10
4. RECEIVER FITTING	11
5. LED INDICATOR	12
6. CHARGING THE BATTERY	13
MAINTENANCE	15
WARRANTY AND REPAIR INFORMATION	16

AT A GLANCE

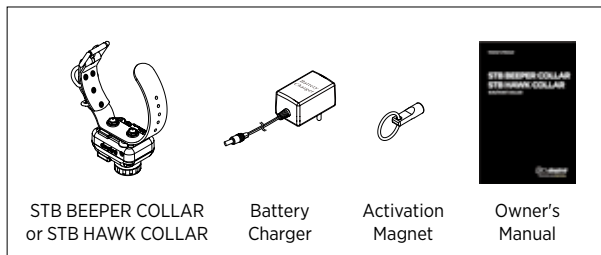

Optional Accessories

Auto Charger

The auto charger for the STB BEEPER COLLAR or STB HAWK COLLAR has an input of 12-volts to 24-volts and has an output of 10-volts 1500mAh.

European Charger

Dogtra's European chargers are designed for use with a 220 volt AC electrical outlet.

To purchase accessories, please visit www.dogtra.com or call customer service at (888) 811-9111.

MAIN FEATURES

*** Sound will depend on the model you have**

- 400-meter audible range for beeper or hawk
- STB BEEPER: Two beeper modes - Run/Point and Point
STB HAWK: Two hawk modes - Run/Point and Point
- STB BEEPER: Low beep sound for Point Mode
STB HAWK: Low hawk sound for Point Mode
- 2-hour rapid charge lithium polymer batteries
- IPX9K waterproof certified
- Piezoelectric sensor
- For dogs as small as 25 lbs.

OVERVIEW

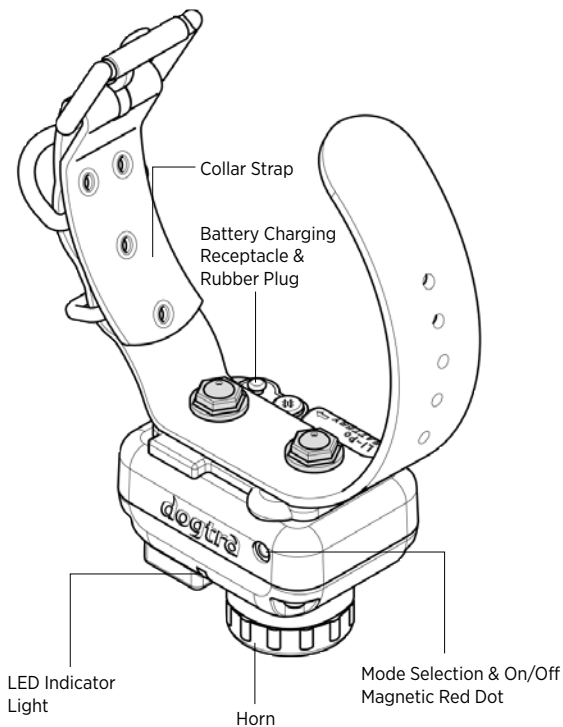

STB BEEPER COLLAR or STB HAWK COLLAR

UNDERSTANDING YOUR TRAINING SYSTEM

1. Turning the System On/Off

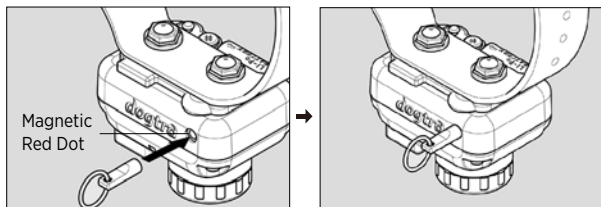

To turn on the STB BEEPER COLLAR or STB HAWK COLLAR, place the activation magnet on the magnetic red dot on the system. Hold them together for a moment until the LED light comes on. The system will play a melody and then beep twice when it is turned on.

To turn off the STB BEEPER COLLAR or STB HAWK COLLAR, place the activation magnet on the magnetic red dot on the system. Hold them together until the LED light turns red. The system will play a melody when it is turned off.

2. Beeper Function

The STB BEEPER COLLAR will always start in the Run/Point Mode. To change to the Point-Only Mode, turn the system on and place the activation magnet to the red dot on the STB BEEPER COLLAR for 1 second and release.

When the Point-Only Mode is selected, the STB BEEPER COLLAR will emit a beep sound. If you want to change to the Run/Point Mode again, repeat the same procedure by turning the system on and placing the activation magnet to the red dot on the STB BEEPER COLLAR for 1 second and release.

In the Run/Point Mode, there will be a double beep every 7 seconds while the dog is running and double beep every 2 seconds when the dog is pointing/stationary.

In the Point-Only Mode, the beeper will remain silent while the dog is running and double beep every 2 seconds when the dog is pointing/stationary.

Mode	Dog Running	Dog Pointing
Run/Point Mode	Double beep every 7 seconds	Double beep every 2 seconds
Point-Only Mode	No Sound	Double beep every 2 seconds

3. Hawk Function

The STB HAWK COLLAR will always start in the Run/Point Mode. To change to the Point-Only Mode, turn the system on and place the activation magnet to the red dot on the STB HAWK COLLAR for 1 second and release.

When the Point-Only Mode is selected, the STB HAWK COLLAR will emit a beep sound. If you want to change to the Run/Point Mode again, repeat the same procedure by turning the system on and placing the activation magnet to the red dot on the STB HAWK COLLAR for 1 second and release.

In the Run/Point Mode, there will be a double beep every 7 seconds while the dog is running and double beep every 2 seconds when the dog is pointing/stationary.

In the Point-Only Mode, the beeper will remain silent while the dog is running and a single hawk sound every 2 seconds when the dog is pointing/stationary.

Mode	Dog Running	Dog Pointing
Run/Point Mode	Double beep every 7 seconds	Double beep every 2 seconds
Point-Only Mode	No Sound	Single hawk sound every 2 seconds

4. Receiver Fitting

Proper Fit

The receiver should be fitted so that it has close contact with your dog's neck to ensure proper usage. You should be able to fit a finger in between the product and your dog's skin. The best location is on either side of the dog's windpipe.

Improper Fit

A loose fit can allow the receiver to move around on the dog's neck, which may rub against the skin and cause irritation. If the receiver is too loose, the contact will not be consistent and cause the corrections to be inconsistent.

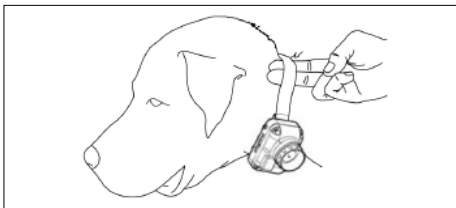

Attention!

Leaving the receiver in the same location on the dog's neck for an extended period of time can cause skin irritation. If the dog is to wear the receiver for long periods, occasionally reposition the receiver every few hours to a different location on the dog's neck and remove the receiver after eight hours of usage. Make sure you check for skin irritation each time you use the unit.

5. LED Indicator

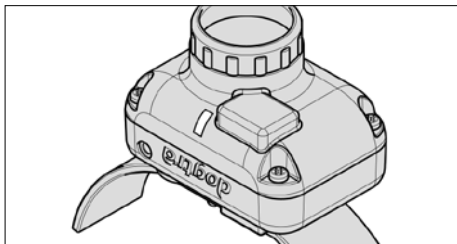

Located on the front of the system, the LED indicator flashes every 4 seconds when the receiver is on and ready for use.

The LED indicator color indicates the battery life level.

Green = Full charge

Amber = Medium charge

Red = Needs charge

If the unit is used while the LED indicator is red, it may shut down automatically.

6. Charging the Battery

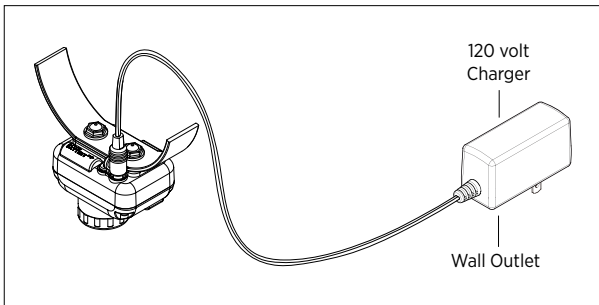

The Dogtra STB BEEPER COLLAR and STB HAWK COLLAR use a lithium polymer battery. Recharge the unit if the indicator light is red or does not come on.

NOTE 1: Only use Dogtra-approved batteries, chargers, and accessories for your Dogtra system. This will prevent any damage that can be incurred from attempting to use a different charger.

NOTE 2: The unit has a partial charge when it leaves the Dogtra facility. Upon receipt of the system, be sure to give it a full 2-hour initial charge before the first use away from any flammable substances.

NOTE 3: When a charger is not in use, disconnect it from the power source. Fully charge the batteries if the unit is to be stored without use for a period of 3 months or more.

Follow the steps below to charge your system:

1. Open the rubber plug on the battery charging receptacle and plug in the charging cable.
2. Plug the charger into a 120-volt wall outlet or, if using the auto charger, plug into a cigarette lighter only for lithium polymer batteries (use a 220 volt European charger for Europe). All indicator lights should glow red when properly plugged in and the unit will automatically shut off during the charging process. You will need to turn the unit on again before use once the unit is fully charged and unplugged from the battery cable.
3. The lithium polymer battery is fully charged within 2 hours. The lights will stay red during the charging process and turn green once the unit is fully charged.
4. After charging, cover the battery charging receptacles with the rubber plugs.

MAINTENANCE

Basic Maintenance

Make sure the rubber charging cap is securely in place when the system is in use. After each training session, carefully inspect the unit for any missing parts or damage to the casing. Damaged or broken casing may affect the waterproof guarantee on the unit. After confirming that there is no damage to the casing, rinse the receiver and clean out any dirt or debris.

Storage Maintenance

The STB BEEPER COLLAR or STB HAWK COLLAR should be fully charged before storing for extended periods. While in storage, the unit should be given a full charge once a month, and before the first use. Store the units in room temperature. Do not keep the units exposed to extreme climates.

Troubleshooting

If the unit is malfunctioning, please refer to the “Troubleshooting Guide” before sending it to Dogtra for service. If you have any questions or concerns, you may email them to info@dogtra.com, or call customer service at (888) 811-9111.

DOGTRA PRODUCT WARRANTY

LIMITED WARRANTY

For Dogtra Products Purchased from Dogtra Authorized Dealers

One-Year Warranty

Except as otherwise provided below, Dogtra warrants to the original retail purchaser (“You”) that its Dogtra products shall be free of defects in materials and workmanship for a period of one (1) year from the date of purchase (“Warranty”). The Warranty covers the cost of repair (parts and labor) or replacement (if repair is not feasible) of a defective Dogtra product during said one-year period. For such repaired or replaced products, the remaining portion of the original warranty period, or ninety (90) days, whichever is longer, shall apply. Dogtra, at its sole discretion, shall determine whether to repair or replace a product covered by the Warranty.

Warranty Conditions

The Warranty is not transferrable and applies to your Dogtra product only if:

- (1) You are the original retail purchaser of the product,
- (2) You bought the product from a Dogtra authorized dealer, and
- (3) You present a receipt or other proof of purchase showing a valid purchase date, the name and address of the authorized dealer, and the purchased product identified by model and/or serial number.

Warranty Exclusions

The Warranty does not cover damage, loss, or deterioration to your Dogtra product caused: by misuse, neglect, abuse, or other improper handling of the product; by failure to follow use or care instructions; by use of the product for other than its intended purpose; by accident or natural forces such as fire or flooding; or by normal wear and tear such as scratches to the product surface.

The Warranty also does not cover Dogtra products that: are purchased from non-authorized dealers; are purchased outside of the United States or Canada; have been damaged during shipment (even if Dogtra paid or arranged for shipping); have been modified or tampered with in any manner; are opened or repaired by anyone other than Dogtra; or have serial numbers that have been altered or defaced.

Sole Warranty

This Warranty is the only warranty offered by Dogtra for its Dogtra products. Other than said Warranty, Dogtra makes no other representations or warranties whatsoever regarding its products, whether oral or in any product manual, on any packaging, on any website, or in any other written material. No dealer of Dogtra products, nor any employee or agent of Dogtra, is authorized to make any additions, changes, or extensions to the Warranty. Dogtra, at its sole discretion and at any time, reserves the right to modify the Warranty.

DISCLAIMER OF OTHER WARRANTIES

THE FOREGOING WARRANTY IS PROVIDED IN LIEU OF ALL OTHER WARRANTIES, WHETHER EXPRESS OR IMPLIED. DOGTRA DISCLAIMS ANY IMPLIED WARRANTIES INCLUDING, BUT NOT LIMITED TO, THE IMPLIED WARRANTIES OF MERCHANTABILITY AND FITNESS FOR A PARTICULAR PURPOSE.

Limitation of Remedies

Dogtra's liability is limited to the cost of repair or replacement of the Dogtra product under Warranty. Any claim or action to enforce the Warranty must be commenced within thirty (30) days of the Warranty's expiration for your product. Dogtra will not be liable for any indirect, incidental, special, consequential, or similar damages based on breach of warranty, breach of contract, negligence, strict tort, or any other legal theory related to Dogtra and its products. Damages that Dogtra will not be responsible for include, but are not limited to: loss of income or profits; loss of revenue or savings; loss of use of the product or associated products; cost of any substitute products or services; inconvenience, downtime, or any other time; loss of goodwill; claims of third parties including customers; and damage to property.

Legal Rights May Vary By State or Jurisdiction

The Warranty gives You specific legal rights, and You may also have other rights which vary by state or jurisdiction. Some states or jurisdictions do not allow certain limitations of implied warranties or of incidental or consequential damages or other remedies, so certain of the foregoing limitations may not apply to You.

If any portion of the Warranty is held by a court to be invalid or unenforceable, the remaining portions of the Warranty shall remain in full force and effect and shall in no way be affected or invalidated, and the invalid or unenforceable portion shall be modified so as to most nearly achieve the intent of the Warranty.

Product Registration

Dogtra recommends that customers register their products as soon as possible after purchase. Product registration will facilitate any future warranty service. You may also receive useful information and updates about your existing and future Dogtra products. To register your product, visit www.dogtra.com/product-registration. If your product is not registered with Dogtra, You will be required to provide a receipt or other proof purchase (as provided above) to qualify for warranty service.

How to Obtain Warranty Service

Should your Dogtra product require warranty service, please contact Customer Service by phone or email for a warranty evaluation (see below for contact information). Upon approval of your warranty work, Dogtra will repair or replace (at Dogtra's election) your product without charge for labor or parts. You are responsible for shipping, including cost, of your product to Dogtra for warranty service. Dogtra will handle shipping, including cost, of the repaired or replaced product back to customers in the USA. Dogtra will not be responsible for shipping, including cost and/or applicable taxes or fees, for products sent to Canada. Such costs, taxes, or fees will be borne by the customer.

To register your product, visit www.dogtra.com/product-registration.

Dogtra Customer Service

12322 Monarch Street, Garden Grove, CA 92841

(888) 811-9111

repair@dogtra.com

Mon – Fri, 8:00 AM to 4:30 PM (PST)

© 2021 Dogtra. All rights reserved.