

PATHFINDER2 MINI COMPASS

PT21U, PM20U

GPS TRACKING & TRAINING SYSTEM

Owner's Manual

Please read this manual thoroughly
before operating the Dogtra PATHFINDER2 MINI COMPASS.

Visit [Gun Dog Supply.com](http://GunDogSupply.com) | Order a Dogtra Pathfinder2 Mini Compass | See other Dogtra products

IMPORTANT SAFETY AND PRODUCT INFORMATION

WARNING

Please read all safety and product information below before using your Dogtra product. Failure to follow these safety instructions could result in injury to you, your dog and others, or it could result in damage to your Dogtra product or other property.

DOG SAFETY

Proper Use

Dogtra products should be used to train, educate, monitor, or track dogs. Each dog may have a different tolerance for and reaction to Dogtra products. Closely observe your dog when determining the right level of stimulation, receiver fit, and other settings of your Dogtra product.

Training Methods

Dogtra products may be used with a variety of training methods that provide clear and consistent messages to your dog.

Fit and Wear

Proper fit and wear of your Dogtra product is important for the comfort of your dog as well as the functioning of your product. Dogtra receivers should fit comfortably and not too tightly, so that the receiver stays in place and does not move around your dog's neck. Do not leave a receiver on your dog for an extended time. Although each dog is different, Dogtra recommends that its receivers be used a maximum of 4 to 6 hours at any one time on your dog.

A receiver that is used for overly long periods or that fits improperly may cause skin irritation or sores on your dog's neck. Regularly check the receiver's contact area on your dog's skin. If your dog exhibits skin irritation or sores, stop using the Dogtra product and consult with a veterinarian.

UNAUTHORIZED USE

Dogtra products should be used only in a safe and responsible manner to train, educate, monitor, or track dogs. Dogtra products are not intended for use in any other manner; they are not intended for use with other animals or with humans; and they are not intended for use in unsafe situations or environments that could lead to death, injury, loss or damage.

BATTERY

Your Dogtra product contains batteries. Do not attempt to replace the battery yourself. Contact Dogtra or your Dogtra retailer to replace your battery. Dispose of batteries as provided by your local regulations. Do not disassemble, crush, heat, or otherwise alter the battery as it may cause fire, explosion, injury and/or property damage.

OWNER SAFETY

Handling and Repair

Dogtra products can be damaged or malfunction if dropped, especially on hard surfaces, or otherwise improperly handled. Do not use a damaged or malfunctioning product as it may cause injury or property damage. If your product is damaged or malfunctions, contact Dogtra to obtain service before using the product.

Electrical Product

Your Dogtra product contains electrical components and batteries. Do not use or keep your product near heat or flammable sources. Such use or storage may damage your product and/or cause fire, explosion, injury, or property damage.

Charging

Only charge your Dogtra product with its accompanying Dogtra charger. Do not attempt to charge your product in any other manner or in temperatures less than 32°F (0°C) or over 113°F (45°C) as it may cause fire, explosion, injury, and/or property damage. If you notice damage to your product, its charger, or battery, obtain service from Dogtra before charging the product. Do not use more than one splitter cable with a single battery charger.

Medical Device Interference

Dogtra products contain electrical and magnetic components that emit low level electromagnetic waves and radio frequencies. These electromagnetic waves or radio frequencies may interfere with pacemakers, defibrillators, or other medical devices. Consult your physician or medical device maker before using your medical device with a Dogtra product. If you think that your Dogtra product is interfering with your pacemaker, defibrillator, or other medical device, stop using the Dogtra product.

Aggressive Dogs

Do not use Dogtra products with aggressive dogs as such dogs may react adversely and cause injury to people or other dogs. Seek the assistance of a dog-training specialist or veterinarian when dealing with aggressive dogs.

Children

Dogtra products are not toys. Adult supervision and close attention are necessary when Dogtra products are used by or near children.

COMPASS & PF2 APP FEATURES OVERVIEW: 3 LEVELS OF GPS TRACKING



COMPASS HANDHELD GPS CONNECTOR
STANDALONE FEATURES WITHOUT PF2 APP
(No App Required After Setup)



100-Level Rheostat Dial

Adjustable medium stimulation in 100 levels.

Customizable Training Buttons

Define a set of button function configurations applied to the selected dog/receiver, or a dedicated function per dog/device per button

Live Tracking Compass

Multi-GNSS supported with a 3-axis compass for accurate tracking even while in motion.

Constant

Pager

Tone

Light



Menu View

Press and hold the front right button.

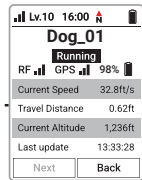

Detail View

Press the front right button briefly.

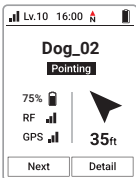

Next Dog View

Press the front left button

** Available only when two or more dogs are connected.*

Power Button

Press and hold to power off.

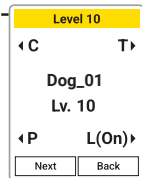

E-Collar View

Tap the power button to view the E-collar View without tracking information.

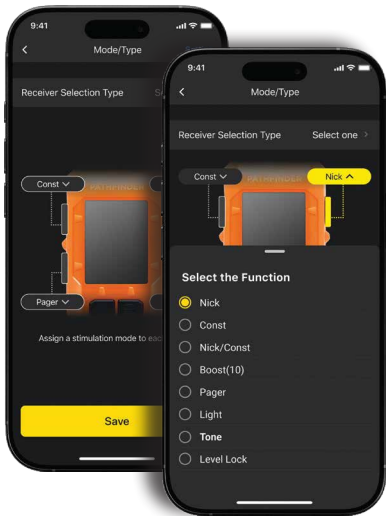

COMPASS HANDHELD GPS CONNECTOR ENHANCED FEATURES WHEN CONNECTED TO PF2 APP

- Multi-device display settings
- Customizable E-collar buttons
- Truck location marking
- Adjustable notifications, screen brightness, and measurement units

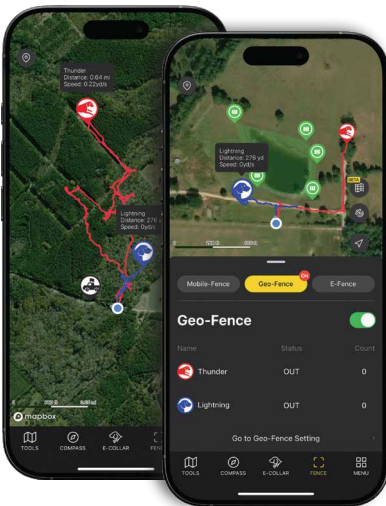

PF2 APP — MOBILE-ONLY FEATURES

(Available exclusively through the PF2 App)

- Detailed live map views, including offline maps
- Geo-Fence & Mobile-Fence (notifications only)
- E-Fence (with correction)
- Advanced tools: Timer, Recording, Device Sharing, Channel-Slot Settings

CONTENTS

PACKAGE CONTENTS	8
MAIN FEATURES	9
OVERVIEW	10
UNDERSTANDING YOUR TRAINING SYSTEM	
1. COMPASS HANDHELD GPS CONNECTOR (PT21U) BUTTON FUNCTION	12
2. GPS RECEIVER (PM20U) BUTTON FUNCTION	13
GETTING STARTED	
1. DOWNLOADING THE PATHFINDER2 APP	14
2. PAIR YOUR HANDHELD WITH THE PF2 APP	14
3. TRACKING DIRECTION AND DISTANCE INFORMATION BETWEEN COMPASS HANDHELD & PF2 APP	16
4. PAIRING PATHFINDER2-SERIES GPS RECEIVER TO THE COMPASS HANDHELD GPS CONNECTOR	17
5. RECEIVER FITTING	18
HANDHELD DEVICE INFORMATION	
1. HANDHELD DEVICE LCD	19
2. E-COLLAR VIEW	20
3. TRUCK MARKER	20
4. LCD BRIGHTNESS	21
5. SYSTEM SLEEP MODE	22
COMPASS HANDHELD GPS CONNECTOR ENHANCED FEATURES WHEN CONNECTED TO PF2 APP	
1. HANDHELD NOTIFICATION SETTING	23
2. HANDHELD LCD SETTINGS	24
3. TRACKER SCREEN	24
4. E-COLLAR CONFIGURATION SET UP	26

KEY FEATURES OF PATHFINDER2 APP

- 1. MAP 30
- 2. TOOLS TAB 33
- 3. COMPASS TAB 34
- 4. E-COLLAR TAB BUTTONS 35
- 5. FENCE TAB 37
- 6. MENU 44
- 7. ACTIVITY MODE 45
- 8. DEVICE ALERTS 46

DEVICE INFORMATION

- 1. FINDING THE RIGHT STIMULATION LEVEL 47
- 2. MAXIMIZING THE DISTANCES 47

PRODUCT MAINTENANCE

- 1. CHARGING THE PATHFINDER2 MINI COMPASS 48
- 2. REPLACING THE ANTENNA 49
- 3. CHANGING THE CONTACT POINT LENGTH 50
- 4. USING THE TEST LIGHT 51
- 5. ATTACHING THE BELT CLIP 51

- BASIC MAINTENANCE 52

- TROUBLESHOOTING GUIDE 53

- FCC WARNING STATEMENT 54

- DOGTRA EXTENDED PRODUCT WARRANTY 55

PACKAGE CONTENTS



**PATHFINDER2 MINI GPS Receiver(PM20U) &
COMPASS HANDHELD GPS CONNECTOR(PT21U)**



Battery Charger



C-Type Charger
Cable



Belt Clip



Test Light



Contact Point
Extension Washer/
Adjustment Tool



Non-Stimulation
Contacts



Lanyard



LCD Protective Film



Quick Start Manual

MAIN FEATURES



4-Mile Range



2-Second GPS Update Rate



Expandable to 21 Dogs



LED Locate Light



Nick, Constant, Audible Tone & Pager Vibration



3-Hour Rapid Charge Batteries



IPX9K Waterproof Certified



Belt Clip



Sleep Mode



Medium Output in 1-100 Stimulation Levels



Enhanced Contact Points



USB-C Charging



Track up to 21 devices, displaying 1 to 4 collars concurrently

App-only features include



Offline Maps



Timer, Recording, Stopwatch



E-Fence, Geo-Fence, Mobile-Fence



Public land information



Tracking Only Mode

OVERVIEW



COMPASS HANDHELD GPS CONNECTOR (PT21U)

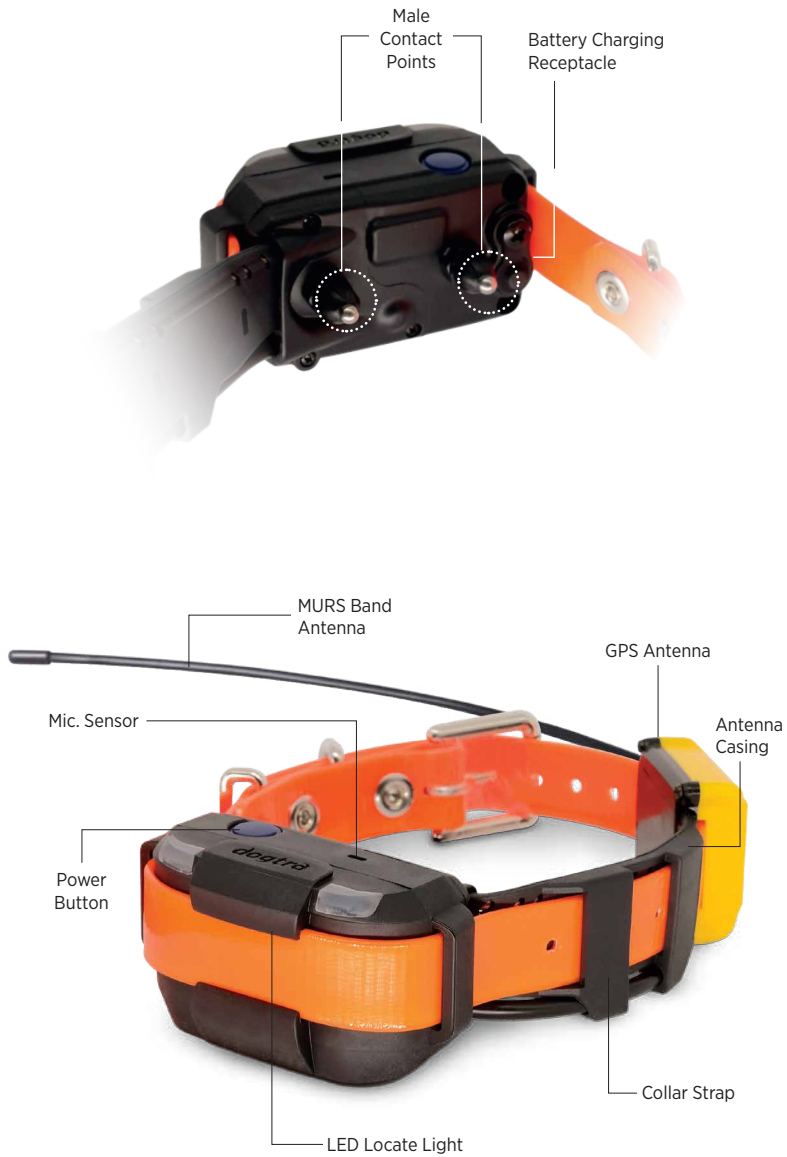

**PATHFINDER2 MINI COMPASS
GPS Receiver (PM20U)**

UNDERSTANDING YOUR TRAINING SYSTEM

1. COMPASS HANDHELD GPS CONNECTOR (PT21U) BUTTON FUNCTION



1 POWER/CONNECT ONLY BUTTON

- **On:** Press button for more than 3 seconds while powered off
- **Off:** Press the button for more than 3 seconds while powered on
- **E-collar only:** With the connector on, press the button for a short time after Receiver is connected to switch to the E-collar exclusive screen (see page 20)

2 E-COLLAR CORRECTION BUTTON

- The E-collar command button will emit the e-collar function selected in the connector when pressed.

PF2 App allows you to specify the desired function for each button (see Page 26)

3 FRONT BUTTON

- **Left Button:** Navigate between pages.
- **Right Button:** Primarily used to load Menu, or Select/Cancel/Enter specific commands. The roles of the two buttons are displayed at the bottom of the screen and may change depending on the function on screen.

4 RHEOSTAT DIAL

- Adjust the stimulation level by turning it in the range of 0 to 100.
*If Level lock set, the level does not change when the dial is turned.

2. GPS RECEIVER (PM20U) BUTTON FUNCTION



1 POWER BUTTON

- **On:** Press the button until a green LED light appears and 3 short beeps emit.
- **Off:** Press the button until a red LED light appears and 1 long beep emits.

2 LED INDICATOR

The LED on the GPS receiver blinks every 2 seconds while turned on. The LED colors represent the battery life:

Green: 50-100% | Orange: 10-49% | Red: 0-9%

The LED on the GPS Receiver will show different colors when the E-Fence or Locate Light function is activated in the PF2 APP. When the E-Fence mode is on, the LED will blink blue in between the battery life indication blinking. When the Locate Light is on, the white LED will blink rapidly every 0.2 seconds without the battery life indication blinking.

GETTING STARTED

1. DOWNLOADING THE PATHFINDER2 APP



To download the app:

Go to the Apple App Store or Google Play Store, search for “Dogtra PATHFINDER2,” and download the app on your device.

Note: Make sure to download the Dogtra PATHFINDER2 app as the previous app version is not compatible.

2. PAIR YOUR HANDHELD WITH THE PF2 APP

Download the app using the QR code, and follow these steps to pair the app with your handheld device:

STEP 01

Turn on the **COMPASS HANDHELD GPS CONNECTOR**. Launch the **PF2 App** on your phone — ensure Bluetooth is turned on and keep both devices close together.



STEP 02

In the app, go to the **Menu** tab and tap “**Connection Failed with GPS CONNECTOR**”



STEP 03

On the pairing screen, select “**PF2 COMPASS HANDHELD**” and press **Next**.



STEP 04

Follow the on-screen instructions to complete the pairing process.



NOTE: The COMPASS HANDHELD GPS CONNECTOR can be used as a standalone device after the initial setup. You can reconnect it to the app anytime to change settings.

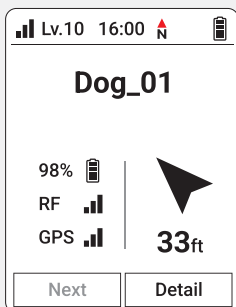

✔ Turn on the receiver and use it!

Turn on the receiver included in the package. It's already paired with the COMPASS HANDHELD GPS CONNECTOR. The receiver is ready to use once the handheld screen displays the image shown on the left, and the receiver's LED begins blinking every two seconds.

CAUTION!

📶 → 📶 When The GPS Is Not Fixed

GPS signal strength/
status of the **HANDHELD**.

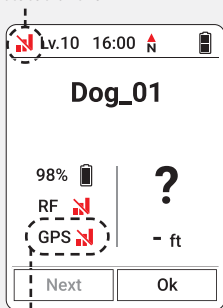

GPS signal strength/
status of the **Receiver**.

If a GPS signal is not detected, you'll see the signal status image as shown above. **Take the device(s) outside to an open area and hold them higher, with the antenna facing the sky.** Using the device indoors, near tall buildings, or in areas with heavy vegetation may reduce GPS accuracy and cause this issue.

⊗ AVOID



📍 → ❓ When The Compass Can't Find Its Direction

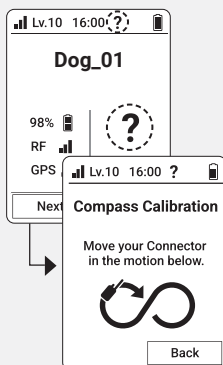

If the compass has trouble finding its direction, **follow the on-screen instructions to move the COMPASS HANDHELD GPS CONNECTOR** around until it recalibrates. Once the compass direction is acquired, the device will automatically return to the main screen.

*** To manually access the calibration screen, press and hold the front left button on the handheld.**

3. Tracking Direction and Distance Information between COMPASS HANDHELD & PF2 App

When connected to the PF2 app, the COMPASS HANDHELD utilizes the GPS data provided by the smartphone through the PF2 app. Consequently, the tracking distance displayed on both the handheld and the app is identical. However, discrepancies in tracking direction may occur due to differences in the physical orientation of the smartphone and the handheld.



Smartphone cases containing metallic or magnetic materials may interfere with the tracking sensors and affect directional accuracy.

4. PAIRING PATHFINDER2-SERIES GPS RECEIVER TO THE COMPASS HANDHELD GPS CONNECTOR.

STEP 01

Turn on the PATHFINDER2-series GPS receiver and the COMPASS HANDHELD GPS CONNECTOR, and keep both devices close together. On your handheld, press and hold the **Menu** button to display the screen shown on the right. Use the **Next** button to navigate, then select **Device Connect**.

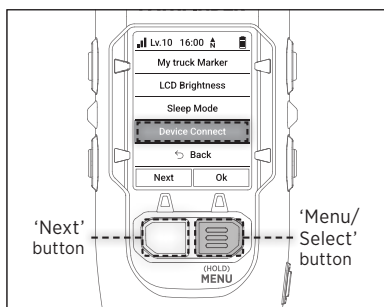

STEP 02

1. Select **Add Receiver** using the **Menu/Select** button to start pairing mode.
2. Press and hold the Power button on the **PATHFINDER2-series GPS receiver** until the LED begins blinking rapidly in green.
3. If pairing does not start, bring the two devices closer together and try again. Ensure both batteries are fully charged.

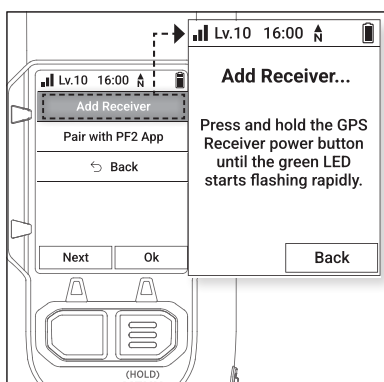

STEP 03

Once pairing is complete, the paired GPS receiver will automatically appear in the device list on both the handheld and the PF2 App.



5. RECEIVER FITTING

Proper Fit

Fit the receiver on either side of the dog's windpipe so that the contact points press firmly against the dog's skin. You should be able to fit two fingers underneath the collar strap.

Improper Fit

A loose fit can allow the receiver to move around on the dog's neck and cause irritation. If the receiver is too loose, the contact will be inconsistent and cause inconsistent correction.

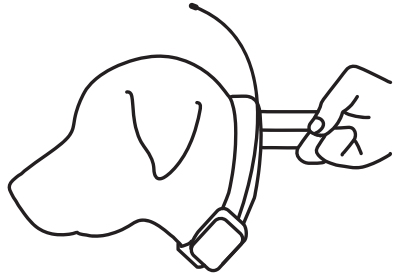

Attention!

While Dogtra uses medical grade stainless steel contact points and anti-microbial plastic to protect the dog's skin, leaving the receiver in the same location for an extended period of time can cause skin irritation due to the sensitivity from the contact points. Reposition the receiver every few hours to move the contact points and remove the receiver after 8 hours of use. Check for skin irritation each time you use the unit.

HANDHELD DEVICE INFORMATION

1. HANDHELD DEVICE LCD

Displays the name, status, direction, and distance of all receivers connected to the PF2 COMPASS. The List View can display up to four receivers concurrently. The Detail View shows detailed status information for each device. Additionally, you can add a Truck Marker on the Menu page to see the distance and direction of your truck from your HANDHELD.

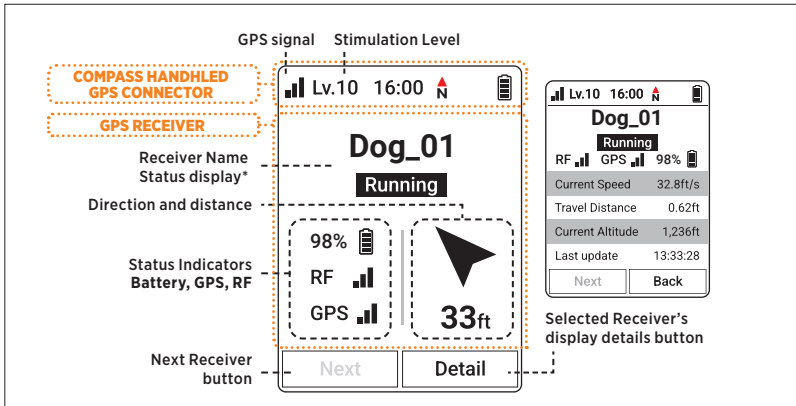

When you press the front right button (Detail) from the Device List, the detailed information of the selected receiver is displayed. As soon as the receiver connects to the HANDHELD, the screen reports the receiver's travel distance, speed, altitude, and update time.

The front left button (Next) is disabled if only a single receiver is connected. However, if multiple receivers are connected, you can press the Next button even while in Detail View to see the next receiver's Detail View.

The current status of the receiver connected to the HANDHELD is displayed, categorized into the following five conditions.

Bark

When the dog is barking.

Pointing

When the dog is not moving and pointing towards game.

Treeing

When the dog has two paws up on the tree to force animals up the tree.

Running

When the dog is moving quickly.

Hog

When multiple dogs bark withing 20 meters of the receiver.

2. E-COLLAR VIEW

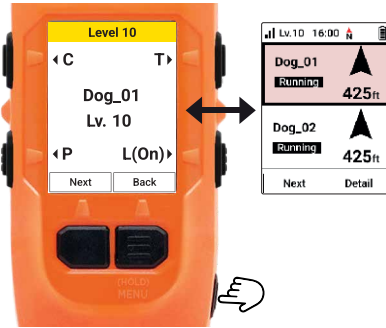

The screen displays the assigned receiver or command type to each side button, allowing you to use the e-collar functions quickly and easily. To switch between screens, briefly tap the power button while the COMPASS HANDHELD GPS CONNECTOR is powered on. This lets you enter or exit the e-collar screen.

E-Collar View mode will not display the Truck and 'Me' location.

3. TRUCK MARKER

You can save the truck's location in order for you to easily return to it after the hunt. You can also add, change, or delete these saved locations on the COMPASS HANDHELD GPS CONNECTOR.

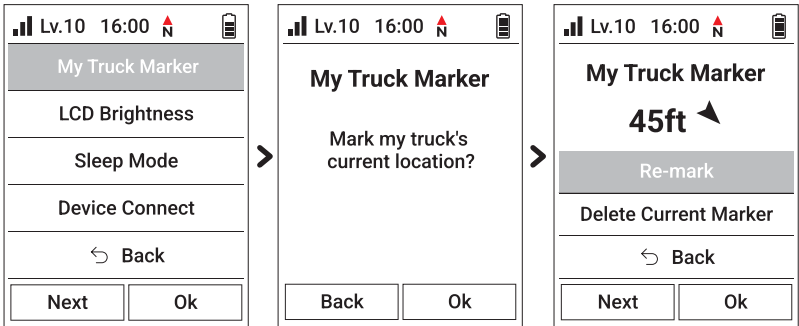

Add Truck Marker: Menu > My Truck Marker > OK

Change Truck Marker: Menu > My Truck Marker > Re-mark

Delete Truck Marker: Menu > My Truck Marker > Delete current marker

4. LCD BRIGHTNESS

The LCD screen brightness of the COMPASS HANDHELD GPS CONNECTOR can be adjusted to 5 levels.

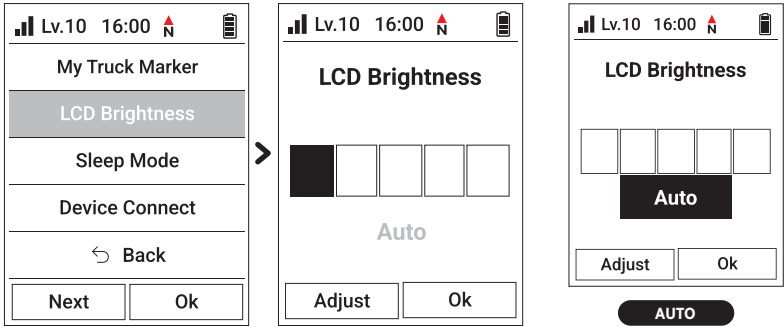

Access the brightness settings by selecting Menu > LCD Brightness. You can adjust the brightness using the front left button (Adjust) on the HANDHELD and then save your selection with the front right button (Ok). Alternatively, when 'Auto' is selected, the brightness will change automatically based on the local sunrise/sunset time

Note: you can also set the LCD screen brightness through the App (see page 24).

5. SYSTEM SLEEP MODE

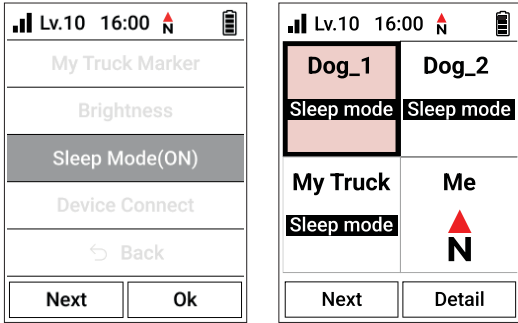

Sleep Mode will pause both the HANDHELD and PATHFINDER2 receivers, temporarily disabling the e-collar function, and halting GPS signal tracking and reception for all connected Receivers to preserve the device's battery life. Therefore, when turning the Sleep Mode on, it is recommended to keep the HANDHELD and the receiver(s) close to each other and within sight. When the sleep mode is active, the HANDHELD screen displays 'Sleep Mode' and the receiver's LED indicator light blinks slowly.

COMPASS HANDHELD GPS CONNECTOR Setting:

- Press and hold the front right button on the HANDHELD to enter the menu.
- Select Sleep Mode
- Press the front right button to activate Sleep Mode

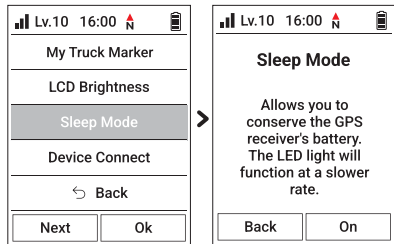

PF2 APP Setting:

Menu tab > Sleep Mode

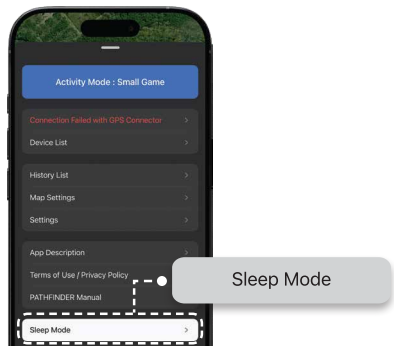

COMPASS HANDHELD GPS CONNECTOR ENHANCED FEATURES WHEN CONNECTED TO PF2 APP

The app connection is only temporarily required to configure detailed HANDHELD settings, such as collar naming and e-collar button settings. Once the set up is complete, the HANDHELD can operate independently without needing a continuous connection to the app – Unless you wish to view the live tracking on the map, which is only available on the PF2 App.

Please pair the PF2 App by referring to page 14.



1. HANDHELD NOTIFICATION SETTING

You can set the type of notification sent by the HANDHELD when the receiver is in a specific status. Notifications are applied identically on both the HANDHELD and the app. The HANDHELD will maintain its notification settings even if the connection to the app is lost.

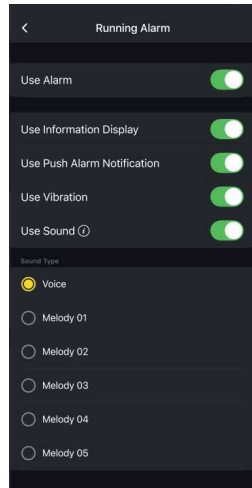
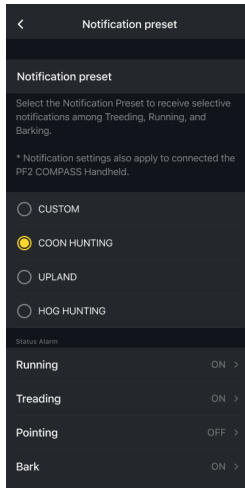
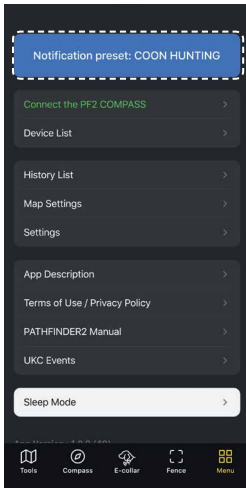

2. HANDHELD LCD SETTINGS

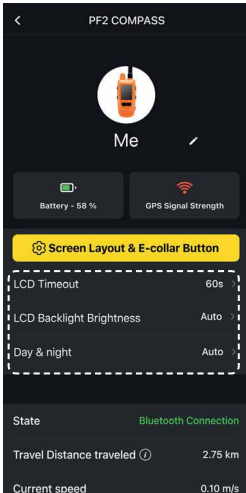

In addition to brightness control, you can also access Theme and Timeout settings when connected to the App.

To access these settings:

Menu > Device List > Select PF2 COMPASS > LCD Brightness, Day & Night (Theme), Timeout

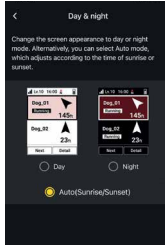

Day & night

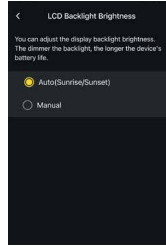

LCD Brightness

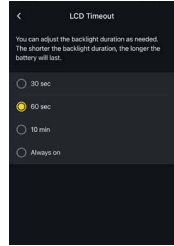

Timeout

3. TRACKER SCREEN

Device List Active & Reorder

You can change the page configuration by modifying the order of devices on the HANDHELD or by hiding/showing them.

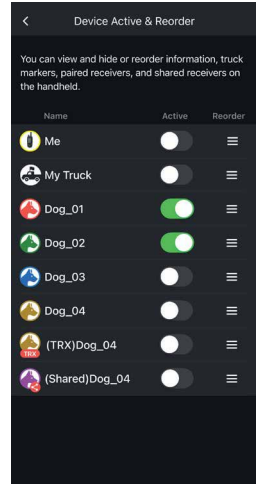
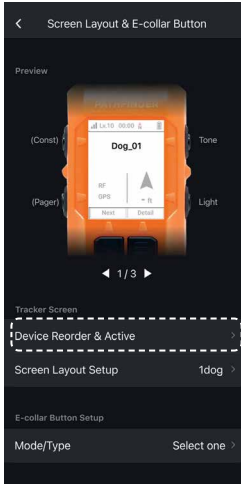
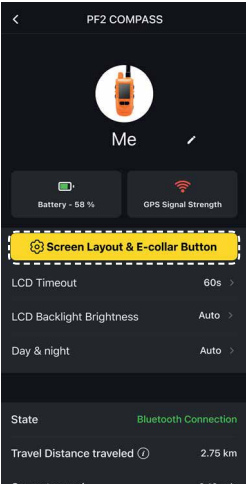

To access these settings:

MENU- Device List > Select PF2 COMPASS > Screen Layout & E-collar Button > Device Active & Reorder

Device List Layout Setup

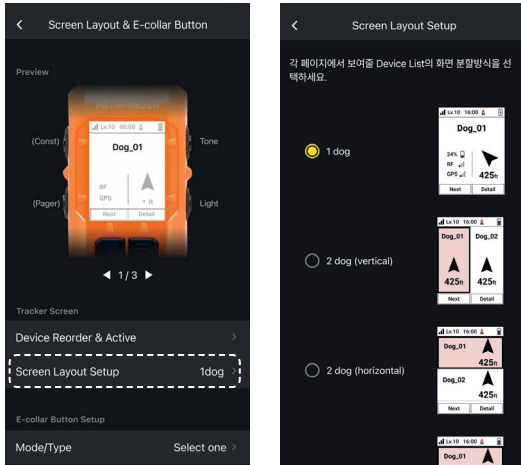

A total of 5 layouts are available, including Single View. You can change the screen layout to see multiple items on one page. This is especially helpful when you have several receivers connected or when you want to check the Truck Marker and your current direction.

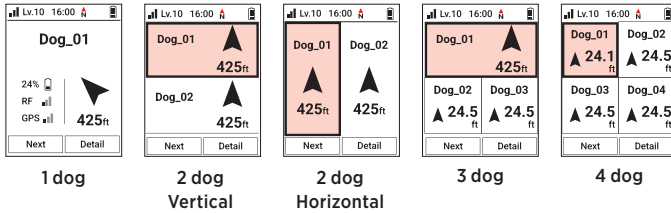

To change the order or hide multiple receivers, adjust them in 'Device Active & Reorder'. (see page 24).

Device List Truck Marker



The added Truck Marker can be configured in the app to appear in the Receiver List (Device List), allowing you to view its information alongside your receivers.

To display it, first designate the Truck Marker on the HANDHELD. Then, if you activate 'My Truck' within 'Device List Active & Reorder', the Truck Marker will be displayed on the device list.



4. E-COLLAR CONFIGURATION SET UP

You can assign the desired stimulation type to each side buttons on the HANDHELD. There are two types of button configuration:

- 1 **Select One:** Assign a function per side button for the selected receiver.
- 2 **Override:** Assign a designated receiver with a function per side button



SELECT ONE

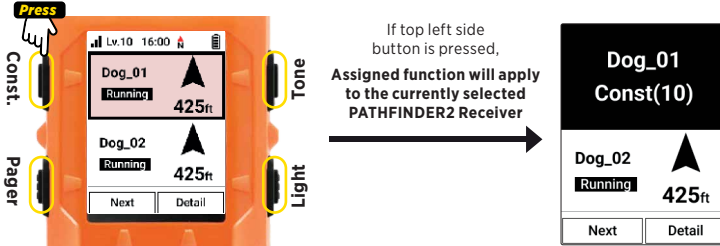

* Default button setting displayed here

Each four side buttons can be assigned with a function of your choice per button that will apply to the selected PATHFINDER2 receiver. You can customize which function to assign per button on the PF2 app. This E-Collar configuration is ideal for users who want to access multiple functions at once for each dog.

How to Assign Functions to Each Side Button

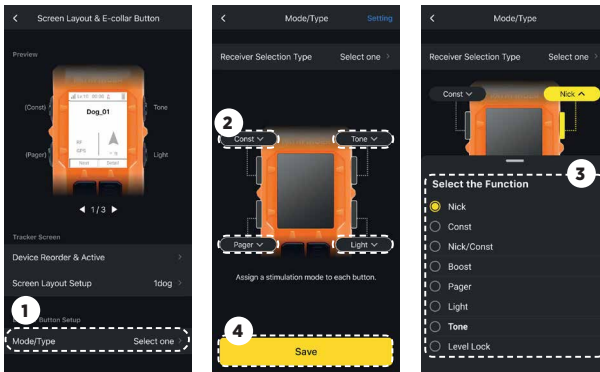

1. Enter Mode/Type page
MENU- DEVICE LIST- PF2 COMPASS SETTING - Screen Layout & E-collar Button – Mode/Type
2. Select Each E-collar Button
3. Select the Function
4. Press Save button

When a TRX collar is selected, the available e-collar function is limited to the light (LED Locate Light). When 'Tracking Only mode' is applied in the PF2 app, all e-collar functions, excluding the light, will be restricted.

Function Type Descriptions

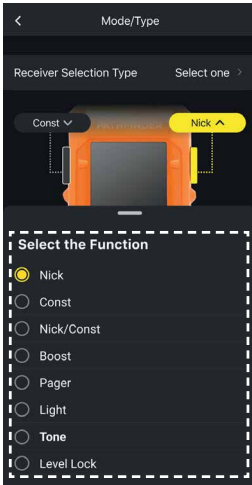

Correction Type:

- **Nick**
Pressing the button briefly will trigger a single stimulus (Nick), and pressing the button for a long duration will maintain a continuous stimulus (Constant) for up to 12 seconds.
- **Constant**
Constant will provide continuous stimulation as long as the button is pressed, up to 12 seconds.
- **Pager**
Press Pager to emit the Pager as long as the button is pressed, up to 12 seconds

Function Type:

- **Light**
Pressing briefly will turn the Visual Light ON, and the LED will blink until it is pressed again to turn it OFF. Pressing and holding will activate the Locate Light, which will blink rapidly for up to 12 seconds.
- **Boost**
A level jump you set in advance. When you press the Boost button, the collar increases the current stimulation by the number of levels you programmed.

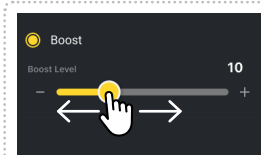

Boost set up

Select the 'Boost' function and set the amount of 'Boost Level' to be added to the current stimulation level. For example, if the 'Boost Level' is set to 10 and the current stimulation level is 20, pressing the 'Boost' function button will deliver stimulation at level 30.

- **Level Lock**

This feature is to prevent unintentional changes to the stimulus level of COMPASS HANDHELD GPS CONNECTOR. Pressing the level lock button will display a lock icon along with current level. Pressing the level lock button once more will unlock it.

OVERRIDE

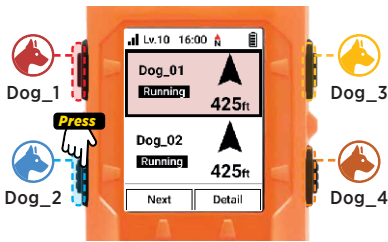

If bottom left side button is pressed, **Regardless of your current selection**, each side button will apply assigned function to a designated **PATHFINDER2 receiver**



Assign each of the four side buttons to any receiver and function. Buttons operate regardless of the selected device on screen. You may assign multiple buttons to the same receiver or distribute across up to four receivers max.

Unassigned receivers will be tracked on the display but cannot be controlled via side buttons.

* All four side buttons are required to be assigned to a receiver and function.
Duplicate receiver assignments across multiple buttons are permitted.

How to assign a designated receiver with a function per side button

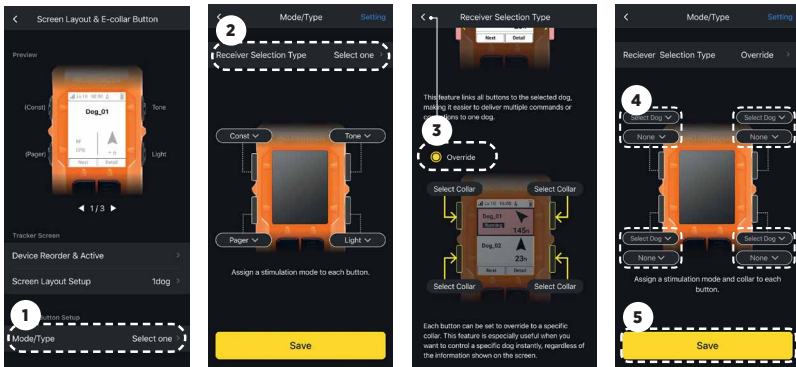

1. Enter Mode/Type page
MENU- DEVICE LIST- PF2 COMPASS SETTING - Screen Layout & E-collar Button - Mode/Type
2. Press Receiver Selection
3. Select Override and back
4. Assign receiver and select correction type per each e-collar button
5. Press Save button

Override mode example in 'E-collar Mode' view

When four designated receivers are assigned per button

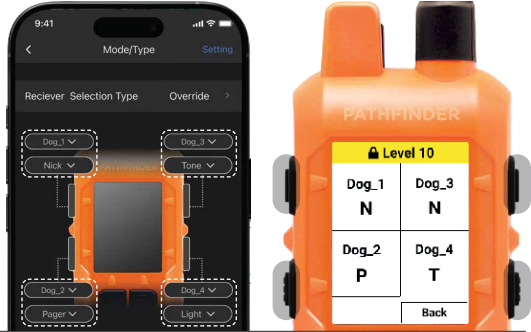

When two designated receivers are assigned per button with different functions

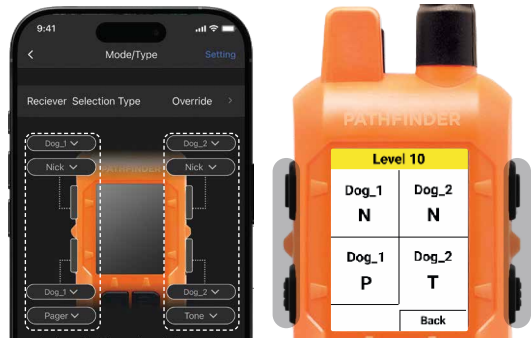

When four designated receivers are assigned while you have 6 paired receivers

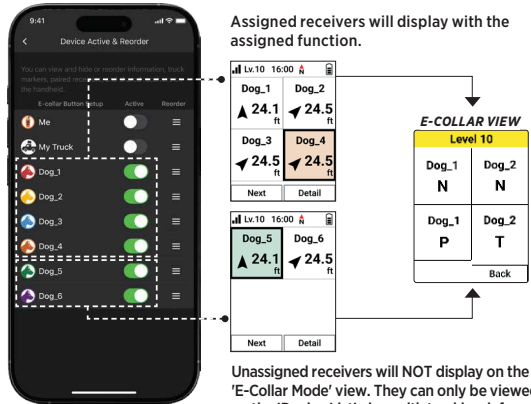

Assigned receivers will display with the assigned function.

Unassigned receivers will NOT display on the 'E-Collar Mode' view. They can only be viewed on the 'Device List' view with tracking-info only, and cannot apply the correction.

How to use two screens on the Override mode:

1. Go to "E-Collar Setup - Mode/Type - Receiver Selection Type - Select Override" to assign all four buttons.
2. Screen Layout & E-collar Button - Device Active & Reorder - Active collars and reorder (same as 1)

"In 'Override' /E-collar-view mode, you cannot display the Truck and 'Me' handheld location.

KEY FEATURES OF PATHFINDER2 APP

1. MAP



Icon	Description
	<p>1 My Position</p> <p>1a: The Blue dot will show your location on the map.</p> <p>1b: Press the My Position button on the bottom right corner to re-center your location on the map and toggle map orientation.</p>
	<p>2 Dog Position</p> <p>The dog icon shows your dog's current action status. It also provides Traveled Distance, Current Speed, Altitude, Battery, Updated Time, and Shared Device.</p>
	<p>3 Create Marker</p> <p>Press the icon to add a marker. You can create markers for 'My Truck' (car location), Truck, Dog, Tree, Favorite, or Note.</p>
	<p>4 Map Selection</p> <p>Select general, satellite, or terrain map.</p>
	<p>5 Map Layers (BETA)</p> <p>View public hunting grounds and restricted access areas information in North America.</p>

1) Map Features

Zoom

- Zoom in once: double tap the map with one finger.
- Zoom out once: single tap the map with two fingers.
- Use two fingers to pinch screen to zoom in and stretch the screen to zoom out.

Scroll

- You can scroll by using one finger to drag the map to the area you want to view.







Tilt







- Tilt the map by using two fingers and dragging the map up or down.

Rotate

- Rotate the map by using two fingers and applying a turning motion.





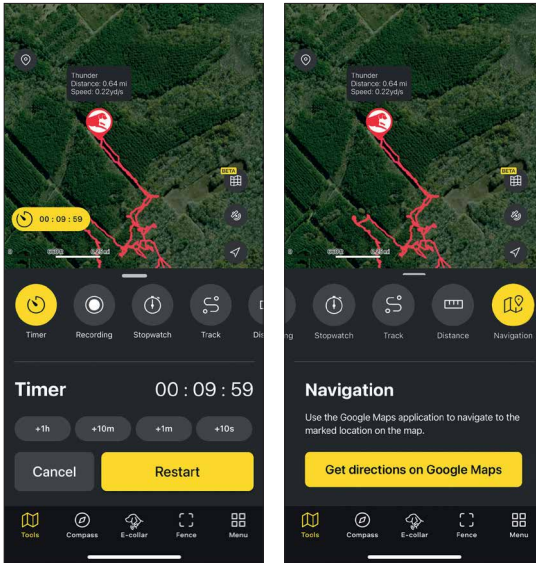

2) Dog Icons

Icon	Description
	Default Status: No motion detected.
	Bark: When the dog is barking.
	Pointing: When the dog is not moving and pointing towards game.
	Treeing: When the dog has two paws up on the tree to force animals up the tree.
	Running: When the dog is moving quickly.
	Hog: When multiple dogs bark within 20 meters of the receiver.
	PATHFINDER2 TRX Receiver: Receiver cannot use e-collar functions.

Icon	Description
	<p>No GPS: Receiver cannot connect to GPS and cannot send location.</p>
	<p>No RF: Devices are far apart. Move the COMPASS HANDHELD GPS CONNECTOR to a higher area to receive signal.</p>
	<p>Recharge Battery: Less than 20% battery life remains.</p>
	 <p>Share: Appears when another user's devices are shared. Cannot use e-collar functions on shared devices.</p>
	<p>E-Fence On: Receiver has been synced with the E-Fence.</p>

2. TOOLS TAB



Icon	Description
	Timer: Set a timer that will alarm at the end of a time interval, which will be visible on the map.
	Recording: Record sessions for location and statuses. Replay sessions from the History List on the menu.
	Stopwatch: Measure the amount of time that has elapsed, which will be visible on the map.
	Track: View track lines on the map for the past 5 hours and reset any track information.
	Distance: Measure the distance between two points on the map.
	Navigation: Use Google Maps to navigate to the marked location. Google Maps must be installed.

3. COMPASS TAB

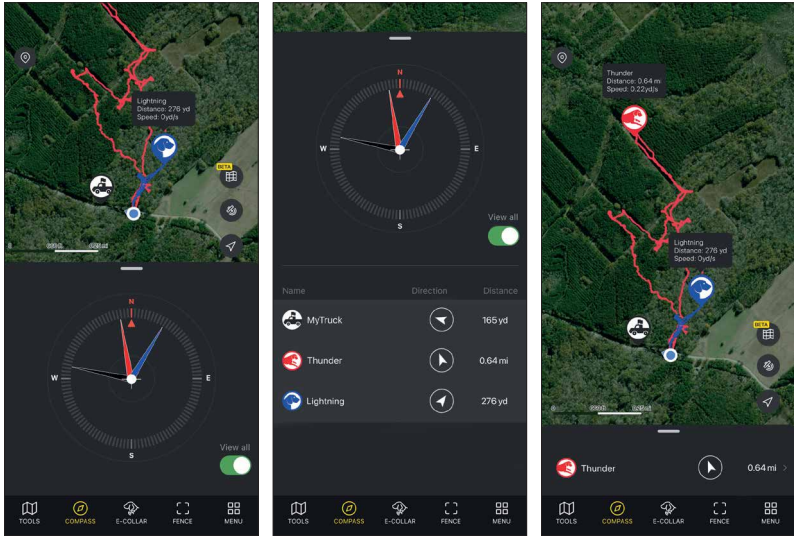

The Compass tab allows you to:

- View the direction and distance of dogs, selected marker, or hunter at a glance by swiping the bottom slider up.
- See each marker by swiping the slider left or right on the smallest slider size.
- Add 'My Truck' marker to view distance and direction.
- Use the 'View All' button to view all dogs and hunters at once. Dogs and hunters are not displayed when hidden or offline.

Notes:

- Metal phone cases or metal objects attached to the phone will interfere with the compass.
- The phone may need to be calibrated for the compass to work properly.

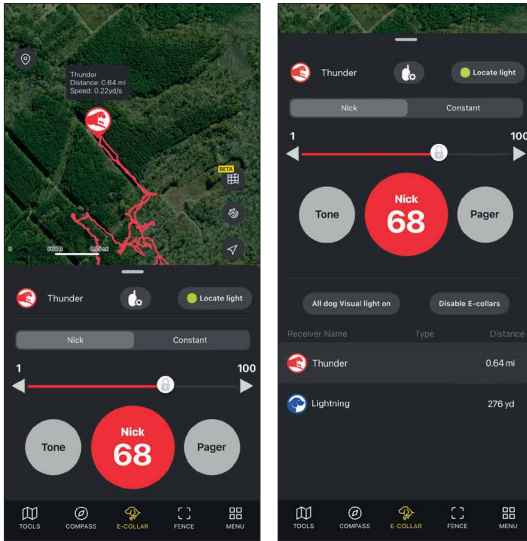

4. E-COLLAR TAB Buttons



Nick/Constant

Nick will emit a single rapid pulse of stimulation. Constant will provide continuous stimulation as long as the button is pressed, up to 12 seconds.

Stimulation Level

Set the stimulation from level 1-100 using the slider. Press and hold the button on the slider to turn the Lock feature on or off.  → 

Pager

Press the 'Pager' button to emit the Pager as long as the button is pressed, up to 12 seconds.

Tone

Press the 'Tone' button to emit a sound as long as the button is pressed, up to 12 seconds.

Locate Light

Press the 'Locate light' button to emit rapid blinking LED light on the receiver collar, which lasts up to 12 seconds. Tap the button to turn on/off the light.

*Slide the top edge of the E-Collar tab window upward to find the **'All Dog(s) Visual Light On'** and **'Disable E-Collar'** buttons.*

All Dog(s) Visual Light On

Pressing the 'All Dog(s) Visual Light On' button will turn on the LED light on every paired receiver collar, blinking every 2 seconds.

Disable E-Collars

Pressing the 'Disable E-Collars' button will disable the e-collar function on all GPS Receivers and Connector. Press the same button again to activate the e-collar function.

Notes: The E-Collar tab is disabled when the Tracking Only Mode is turned on in the Settings menu. Dogs are not displayed when hidden or offline. The PATHFINDER2 TRX receivers and shared receivers will not show on List view.

How to change Locate Light Color

Go to MENU → Device List → Select Receiver → Locate Light Color

COMPASS HANDHELD GPS CONNECTOR's Function Button

Tap the 'Function Button Setting' icon on the 'E-Collar' tab to either assign the e-collar function per button, or choose the e-collar button configuration type. There are two button configuration options to choose: **'Select One'** (default) – Assign one e-collar function to each button for the selected dog/receiver, or **"Override"** – Assign a specific e-collar function to a designated dog/receiver for each button.

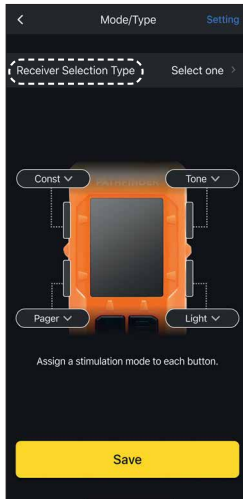
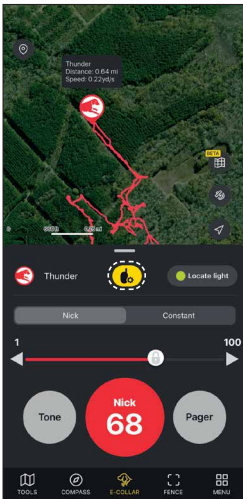

Notes: The arranged stimulation type and/or level from this page will apply to both on the app and COMPASS HANDHELD GPS CONNECTOR. You cannot have two different stimulation types arranged for the PATHFINDER2 app and COMPASS HANDHELD GPS CONNECTOR.

5. FENCE TAB

The PATHFINDER2 offers three types of fences for you to either receive a notification of your dog crossing boundaries or to auto-correct your dog.

The types of fences included are:

1. Mobile-Fence: A fence setup that moves based upon your smartphone location and will send you a notification.
2. Geo-Fence: A static fence setup that will send you a notification.
3. E-Fence: A static fence setup that will send your dog an auto-correction and send you a notification.

1) Mobile-Fence (Notification Only)

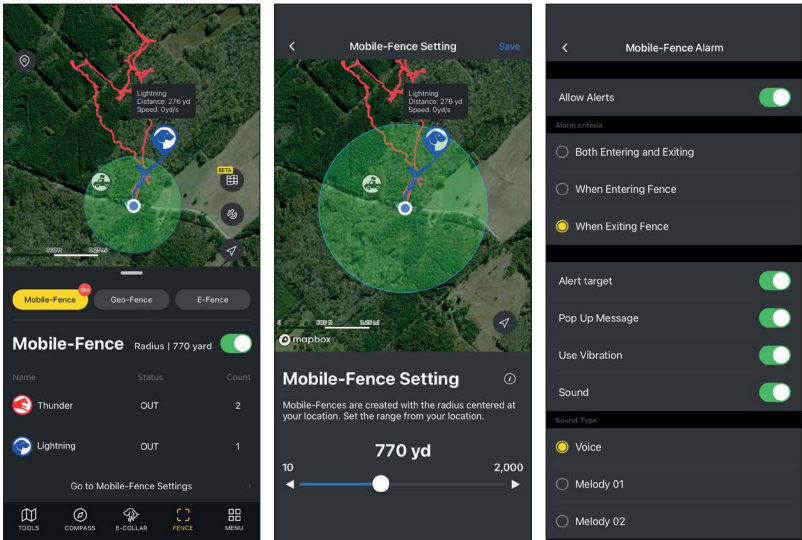

- Mobile-Fence is created with a radius centered around your smartphone (the blue point on the map).
- Status: Indication of receiver in or out of the fence.
- Count: Number of times the receiver has crossed the fence.
- Set the radius from 10 to 2,000 yards.
- Set the Mobile-Fence Alarm settings by going to MENU → SETTING → MOBILE-FENCE.

Notes:

- The Mobile-Fence gives a notification on the smartphone, but does not auto-correct the e-collar.
- The automatic e-collar correction will only work on the E-Fence.

2) Geo-Fence (Notification Only)

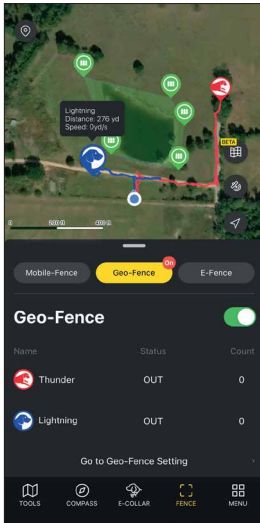

- Create Geo-Fences for specific areas to get alerts on your device.
- Status: Indication of receiver in or out of the fence.
- Count: Number of times the receiver has crossed the fence.
- Set the Geo-Fence Alarm Setting by going to MENU → SETTING → GEO-FENCE.

Notes:

- The Geo-Fence gives a notification on the smartphone, but does not auto-correct the e-collar.
- The automatic e-collar correction will only work on the E-Fence.

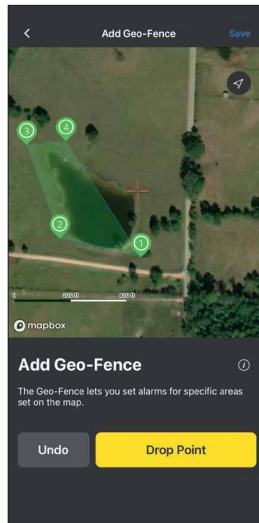

Setting up a Geo-Fence

1. Press the + button.
2. Move the map and place the + on the desired area.
3. Click 'Drop Point' to create a point for the fence boundary.
4. Press Undo to delete the last point.
5. Click the save button on the top right.

- You can create up to 15 Drop Points and up to 15 Geo-Fences.
- Edit and delete file names and fence locations in the Fence List.

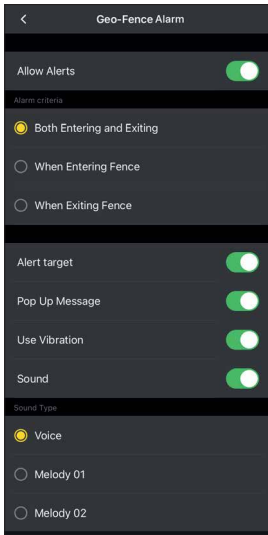

Geo-Fence Alarm Setting

- You can create an alarm for both exiting and entering the Geo-Fence.
- You can select different alarm types.

3) E-Fence (Auto-Correction)

Set up the static E-Fence boundary to auto-correct your dog and get notifications on your phone. When using the E-Fence, keep in mind:

- This device is GPS operated and cannot be used indoors.
- Do not use this as a permanent fence solution as your dog can still cross the Outer Fence. Previous retriever training is needed to train your dog to come back over the Outer Fence.
- The receiver will not emit stimulation when bringing your dog back over the Outer Fence to the IN area.
- Make sure that Bluetooth is on to sync your receiver to the E-Fence boundary.
- Make sure that when the E-Fence boundary is updated, the receiver is synced again.
- A smartphone or GPS connection is not needed to operate, but the track information and application notification will not be received.

About the E-Fence

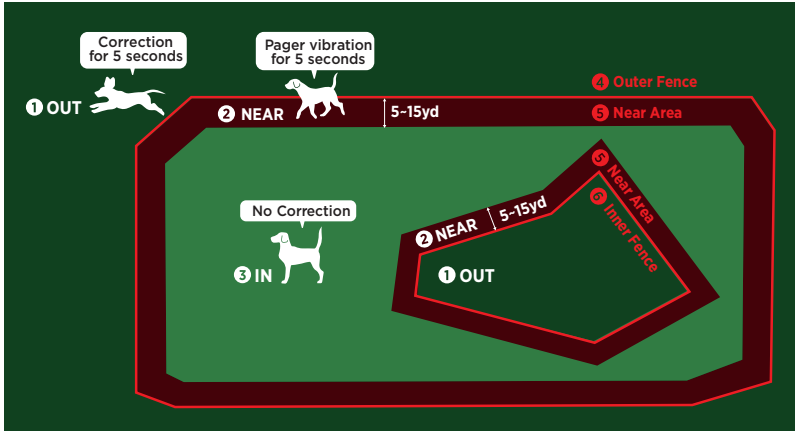

- 1 **OUT:** When moving out of the boundaries, the e-collar emits Constant correction for 5 seconds.
- 2 **NEAR:** The receiver emits a Pager vibration for 5 seconds when within Near Area.
- 3 **IN:** Safe area with no correction.
- 4 **Outer Fence:** One large fence on the outskirts.
- 5 **Near Area:** You can set the desired value between 5-15 yards (meters) of the Inner and Outer Fence.
- 6 **Inner Fence:** Up to 3 Inner Fences can be created within the Outer Fence.

Notes: For the dog's safety, the stimulation will only last 5 seconds if the dog goes out of the boundaries. Make sure your dog comes back in the boundary after 5 seconds.

Restrictions:

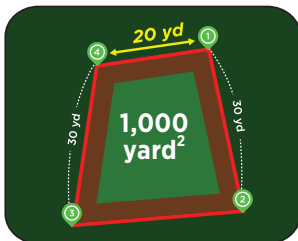

- Boundary design requires the following:
- Minimum 1,000 yard² area
(If adding the Inner Fence, you will need a minimum 2,000 yard area).
 - Minimum distance of 20 yards between each Drop Point

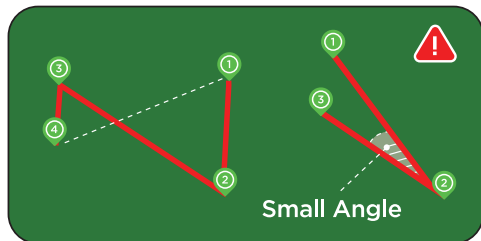

The fence boundary design cannot cross over.

The fence boundary design cannot have sharp pointed areas with small angles.

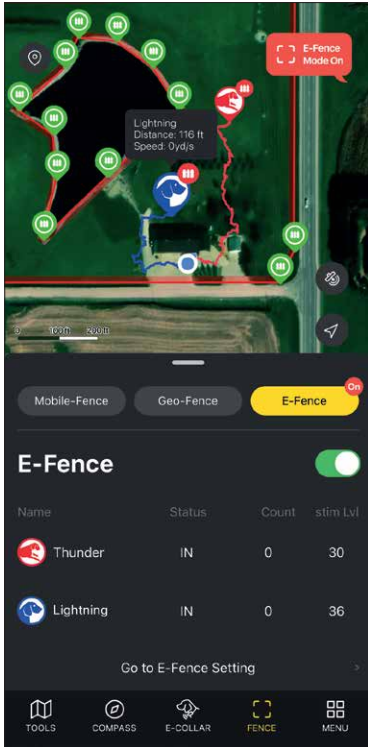

- ON/OFF: The E-Fence can be turned on/off by toggling the button. When turned on, the E-Fence Outer Fence shows up and a blue light on the receiver turns on.



: E-Fence On Mark

- Status: Current receiver status of IN, NEAR, or OUT. 'Need to update' will show up if you need to update the latest E-Fence boundary information.

- Count: The number of times the receiver crossed the boundary.

- Stim Lvl: Displays the correction level when activated. If it is not activated, it will show OFF and you will need to go to E-Fence Settings to activate the stimulation setting.

Notes:

When the E-Fence feature is turned on, the receiver synced with the latest E-Fence boundary will have a blue LED. If there is no blue LED, sync the receiver to the boundary by referring to "Syncing E-Fence Boundary to the Receiver" on page 43.

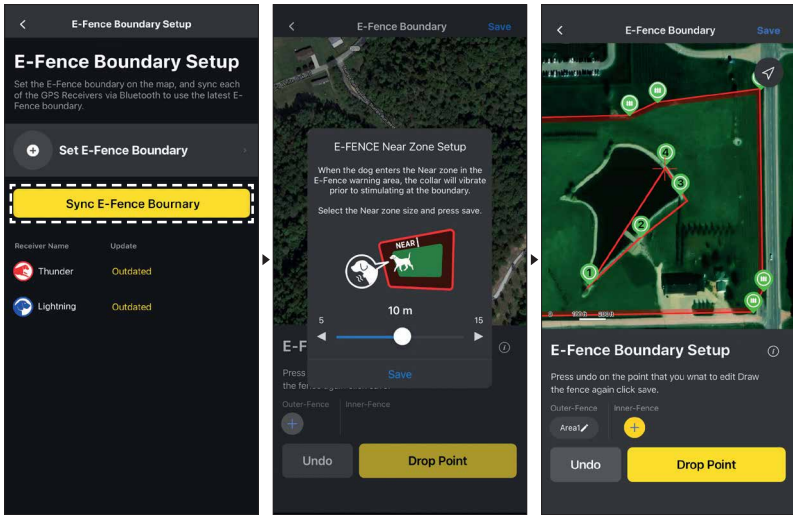

Creating the E-Fence

Click the “Set E-Fence Boundary” button to start setting up the GPS E-Fence.

The GPS collar will vibrate when it enters the “Near zone” prior to stimulating at the boundary. You can set the desired value between 5-15 yards (meters) and click ‘Save’.

Setting up Outer Fence

- 1) Press the **+** button for the Outer Fence.
- 2) Move the map and place the **+** on the desired area.
- 3) Click ‘Drop Point’ to create a point for the fence boundary.
- 4) Repeat the process above to complete the boundary. Create the fence so it goes in one direction.
- 5) Click the save button on the top right. Only one can be saved.

Setting up Inner Fence

- 1) The Outer Fence must be created first to create the Inner Fence.
 - 2) Press the **+** button for the Inner-Fence.
 - 3) Drag the area of the map you want to create the fence to the center with the **+**.
 - 4) Click ‘Drop Point’ to create a point for the fence boundary.
 - 5) Repeat the process above to complete the boundary. Create the fence so it goes in one direction.
 - 6) Click the save button on the top right. Up to three can be saved.
- You can create 1 Outer-Fence and 3 Inner-Fences. All fences can use up to 15 points.

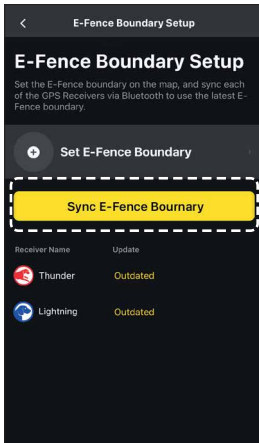

Syncing E-Fence Boundary to the Receiver

In order to operate the E-Fence, the receiver must be synced.

- 1) Turn the receiver on near the smartphone.
- 2) Press the Sync E-Fence Boundary button.
- 3) Look at the list to make sure the receiver is synced.

Notes:

- **After changing the E-Fence boundary, you must sync it again.**
- Each receiver must be synced individually in order for the E-Fence to operate.

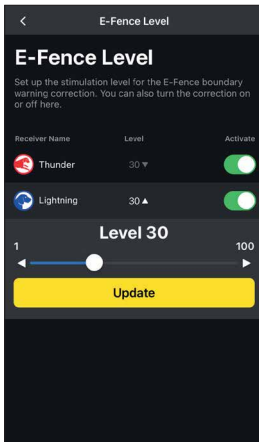

Applying Stimulation on the Receiver

- 1) Press the ▼ button for the receiver on the menu.
- 2) Set the stimulation level.
- 3) Press update.

Notes:

Go to E-Fence Settings to press the Activate button to turn the E-Fence operation on or off for each receiver.

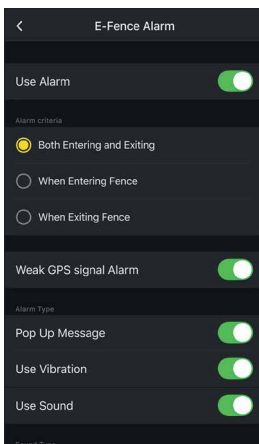

E-Fence Alarm Setting

- Set the E-Fence Alarm Setting by going to MENU → SETTING → E-FENCE.
- You can create an alarm for both exiting and entering the E-Fence.
- You can create an Alarm when the receiver's GPS signal is weak.
- You can select different alarm types.

6. MENU

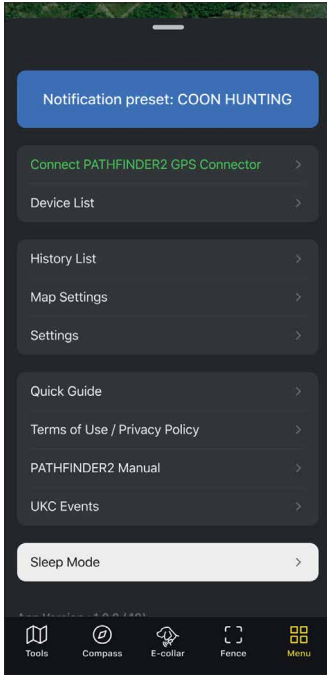

Bluetooth Connection:

View the smartphone and COMPASS HANDHELD GPS CONNECTOR Bluetooth connection. If the devices are not paired, turn both the COMPASS HANDHELD GPS CONNECTOR and smartphone's Bluetooth off and then back on.

Device List:

Find detailed device information and set individual settings.

History List:

Play recorded history files. Convert files to GFX and KML files to share.

Map Settings:

Manage Offline Maps and select the size and information of the marker.

Settings:

Manage settings for different map features.

Quick Guide:

Describes basic contents.

1. Initial setup describes COMPASS HANDHELD GPS CONNECTOR and receiver pairing.
2. Main function will describe each tab.

Terms of Use/Privacy Policy:

Check Terms of Use and Privacy Policy before use.

Manual:

Quickly browse the manual.

Sleep Mode:

Put the receiver to sleep to preserve battery life. In sleep mode, the GPS signal for the receiver is turned off and will reset when turned back on.

7. ACTIVITY MODE

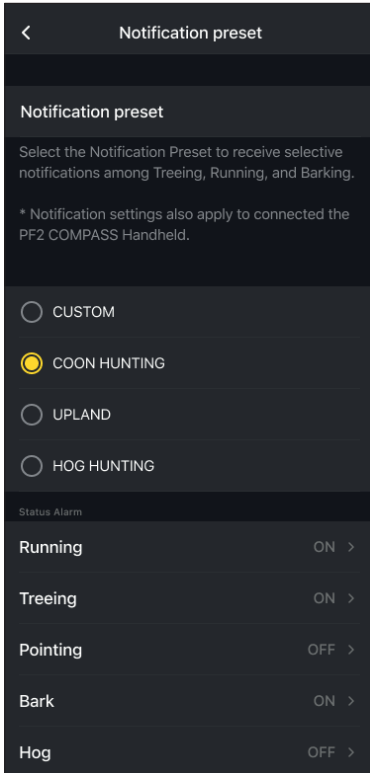

Activity mode: select the hunting type for your activity mode to change the settings to receive device status notifications.

Select the Activity Mode for Small Game, Upland, Hog Hunting, or Custom. The status alarm settings for Running, Treeing, Pointing, Bark, and Hog will change for each mode selected. You can select the alarm you want in Custom Mode.

8. DEVICE ALERTS

- Select the device's alarms based on your specific needs.
- You can set each device's alarms by going to: Menu → Device List → Select Device → Alarm Setting.
- Refer to the table below for possible settings.

Category	Type of Alarm	Setting Up Alarm
Dog Status	Running, Treeing, Barking, Pointing, Hog Barking.	Menu → Setting → Activity Mode
Mobile-Fence	Exiting fence, entering fence, or both.	Menu → Setting → Mobile-Fence → Mobile-Fence Alarm
Geo-Fence	Exiting fence, entering fence, or both.	Menu → Setting → Geo-Fence → Geo-Fence Alarm
E-Fence	Exiting fence, entering fence, or both.	Menu → Setting → E-Fence → E-Fence Alarm
E-Collar	Using e-collar commands.	Automatic
Battery Life	20%, 15%, 10%, 5%	Automatic
Device Connection	RF connection with the receiver and if the receiver is working.	Automatic
Bluetooth Connection	Connect or disconnect status.	Automatic

DEVICE INFORMATION

1. FINDING THE RIGHT STIMULATION LEVEL

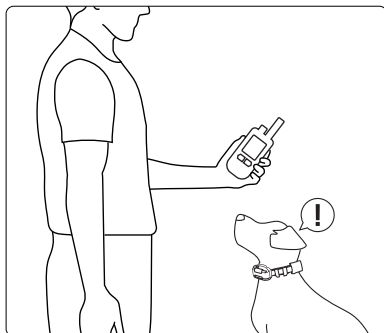

The PATHFINDER2 MINI COMPASS has a rheostat dial on the top of the transmitter. Always start at the lowest level and work your way up. You will find the right level when your dog responds to the stimulus with a mild response. You may also need to adjust intensity levels as your dog's demeanor changes, especially during times of increased excitement or distraction.

2. MAXIMIZING THE DISTANCE

- The line of sight range for the PATHFINDER2 MINI COMPASS is up to 4 miles.
- To get the greatest range, hold the COMPASS HANDHELD GPS CONNECTOR away from your body and avoid touching the antenna.
- Keep your unit properly charged for maximum signal strength.
- The COMPASS HANDHELD GPS CONNECTOR device must be near your phone for proper operation, preferably less than 33 feet.

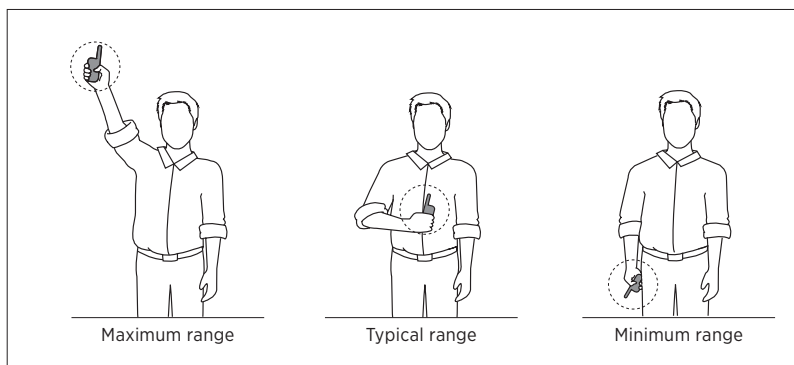

Caution!

Operating the PATHFINDER2 MINI COMPASS near tall buildings and other steel structures will reduce the range of the GPS signal. Not acquiring a GPS signal for prolonged periods of time while outside may indicate issues with the unit.

PRODUCT MAINTENANCE

1. CHARGING THE PATHFINDER2 MINI COMPASS



Fully charge the COMPASS HANDHELD GPS CONNECTOR and Receiver before the first use. The PATHFINDER2 MINI COMPASS uses lithium polymer batteries.

- **Only use official Dogtra chargers with the PATHFINDER2 MINI COMPASS devices.**
- **Do not charge the PATHFINDER2 MINI COMPASS devices near flammable substances.**
- **Fully charge the PATHFINDER2 MINI COMPASS devices if storing for 1 month or longer.**

When to Charge

- When the PF2 app indicates a low battery for the COMPASS HANDHELD GPS CONNECTOR or PATHFINDER2 MINI receiver
- When the LED on the COMPASS HANDHELD GPS CONNECTOR or PATHFINDER2 MINI receiver does not turn on.

How to Charge

1. The COMPASS HANDHELD GPS CONNECTOR charges with a USB-C cable, and the PATHFINDER2 MINI receiver charges with a 5.5 mm cable. Connect each device to its corresponding charging port.
2. Plug the charger into a 120-volt outlet.
3. The COMPASS HANDHELD GPS CONNECTOR will display “Charging” and “Charging Complete” on the LCD screen, and the PATHFINDER2 MINI receiver’s LED will turn from red to green when fully charged.
4. Once fully charged, disconnect the cables and close the rubber caps on the charging ports of both the COMPASS HANDHELD GPS CONNECTOR and the PATHFINDER2 MINI receiver.
5. It takes approximately 3.5 hours to fully charge a completely drained battery.

Charger Info

Manufacturer: E-SUN | Manufacturing country: CHINA

Model name: MKC-0502500VT

INPUT: 100-240V-50/60Hz 0.4A | OUTPUT: 5V 2500mA

2. REPLACING THE ANTENNA

For the COMPASS HANDLED GPS CONNECTOR

1. Twist the antenna counter-clockwise to remove.
2. Place the new antenna on the bolt and turn clockwise to tighten the antenna.



For the Receiver



Open the antenna enclosure by removing the 3 screws and the contact points. Remove the screw holding the antenna in place to replace the antenna.

3. CHANGING THE CONTACT POINT LENGTH

The Dogtra PATHFINDER2 MINI COMPASS comes with 5/8" male contact points that can be extended to 3/4" for dogs with longer coats.

To increase the length:

- 1) Use the included adjustment tool side marked 5/8" to unscrew the contact points counter-clockwise.
- 2) Place the extension over the exposed threads, flat side down.
- 3) Place the contact points over the extensions and tighten clockwise using the adjustment tool side marked 3/4".

Caution!

Tighten until firmly in place. Be careful not to over tighten.

To shorten the length back to 5/8", use the adjustment tool marked 3/4" to remove the extensions and then tighten the contact points clockwise using the side marked 5/8".

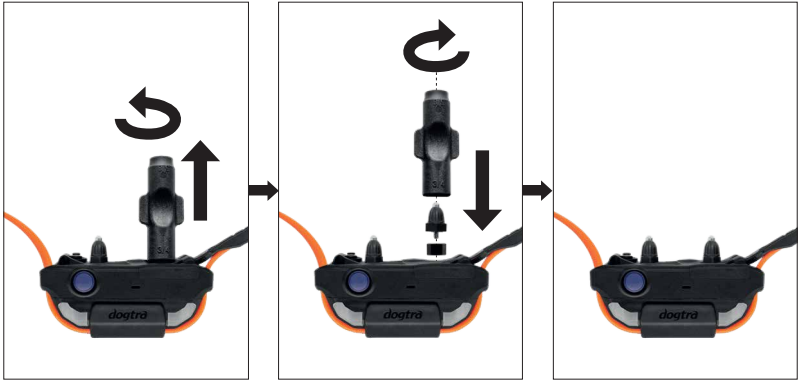

4. USING THE TEST LIGHT



- 1) Turn on the receiver and place the test light over the contact points.
- 2) Press the Nick button in the PATHFINDER2 app and the test light will light up momentarily.
- 3) Press the Constant button in the PATHFINDER2 app and the test light will light up as long as the button is pressed, for up to 12 seconds.
- 4) The test light will glow brighter at higher levels of stimulation and dimmer with lower levels.

Note: The test light may not be visible if the intensity level is set below level ten.

5. ATTACHING THE BELT CLIP



Follow the instructions below to attach the included belt clip to the COMPASS HANDHELD GPS CONNECTOR.

- 1) Align the belt clip to the grooves on the back of the COMPASS HANDHELD GPS CONNECTOR.
- 2) With a firm grip, screw on the belt clip's Phillips head screws with a screwdriver.

Caution!

Tighten until firmly in place. Be careful not to over tighten.

BASIC MAINTENANCE

- Make sure the rubber charging cap is securely in place on the COMPASS HANDHELD GPS CONNECTOR or receiver when in use.
- Carefully inspect the unit for any missing parts or damage to the casing after use. Damaged or broken casing may affect the waterproof guarantee on the unit.
- The antenna must be securely in place for maximum range.
- For an ideal lithium-polymer battery life and performance, try to maintain the minimum 40%-60% charge level at all times.
- Charge the unit fully once a month while in storage or before use.
- Do not keep the unit exposed to extreme climates.
- Dogtra may include updates and improvements to the PATHFINDER2 app which can be downloaded through the App Store and Google Play.

TROUBLESHOOTING GUIDE

1. The dog does not respond to the stimulation.

- Make sure the system is on and the strap is tight enough so that both contact points are touching your dog's skin.
- If the contact points are too short, you can either purchase longer contact points or trim the hair near your dog's neck.
- Increase the level until your dog responds with a subtle head or neck movement.

2. The LED indicator light comes on, but I do not feel any stimulation.

- Testing the system at various levels using the test light is the best way to test your system. Your tolerance may be higher than the level you are testing on yourself.
- The battery may be low. Check the LED indicator lights or the app for battery life.

3. The PATHFINDER2 MINI COMPASS has no range or the stimulation is weaker when my dog is farther away.

- Keep objects away from touching the COMPASS HANDHELD GPS CONNECTOR's antenna as the range may decrease substantially.
- The range indicated is for line-of-sight flat terrain. Heavy brush, trees, hills, buildings, and/or moisture will affect the range of your unit. For the best range, hold the COMPASS HANDHELD GPS CONNECTOR vertically above your head, and/or try moving to higher ground.
- Any electrical conductors will affect the range, such as cars, chain-link dog runs, metal structures, and radio towers. For the best results, operate away from these structures.

4. The COMPASS HANDHELD GPS CONNECTOR or receiver is not holding a charge.

- The charging pin may be damaged. A metal pin inside the charging port should stand straight up and firm in the center. If the pin is wobbly, broken or missing, you will need to send the unit in for repair.
- The charging port must be clean prior to charging, clean out any dirt with a cotton swab and some rubbing alcohol. If your dog was in salt-water, be sure to rinse the GPS receiver and charging port with clean water.
- For Dogtra units over two years old from the purchase date, the batteries may need to be replaced. You can replace them yourself by contacting Dogtra for a replacement battery. Damages incurred to the unit due to improper battery installations are not covered under the warranty. Dogtra strongly recommends sending the unit in for inspection and repair.

5. My dog has skin irritation.

- This may be due to an improper fit or from wearing the receiver too long. If your dog exhibits signs of skin irritation, consult with a veterinarian. Once your dog's skin returns to a normal condition, continue to use the receiver and check your dog's neck each time you use the unit.

FCC WARNING STATEMENT

FCC Compliance Statement (Part 15.19)

This device complies with part 15 of the FCC rules. Operation is subject to the following two conditions: (1) This device may not cause harmful interference, and (2) this device must accept any interference received, including interference that may cause undesired operation.

FCC Interference Statement (Part 15.105)

This equipment has been tested and found to comply with the limits for a Class B digital device, pursuant to part 15 of the FCC Rules. These limits are designed to provide reasonable protection against harmful interference in a residential installation. This equipment generates, uses and can radiate radio frequency energy and, if not installed and used in accordance with the instructions, may cause harmful interference to radio communications. However, there is no guarantee that interference will not occur in a particular installation. If this equipment does cause harmful interference to radio or television reception, which can be determined by turning the equipment off and on, the user is encouraged to correct the interference by one of the following measures:

- Reorient or relocate the receiving antenna.
- Increase the separation between the equipment and receiver.
- Connect the equipment into an outlet on a circuit different from which the receiver is connected.
- Consult the dealer or an experienced radio/TV technician for help.

FCC Caution

Any changes or modifications not expressly approved by the party responsible for compliance could void the user's authority to operate this equipment. This transmitter must not be co-located or operating in conjunction with any other antenna or transmitter.

FCC Radiation Exposure Statement (Part 2.1093) for PT21U

This equipment complies with FCC radiation exposure limits set forth for an uncontrolled environment. This transmitter has been evaluated for compliance with FCC RF exposure limits for portable use conditions (used within 20 cm of the human body). To maintain compliance with these RF exposure requirements, a minimum separation distance of 2.5 cm (1 inch) must be maintained between the antenna and the user's face during normal operation. Use only the supplied or approved antenna. This transmitter must not be co-located or operated in conjunction with any other antenna or transmitter

FCC Radiation Exposure Statement (Part 2.1093) for PM20U

To comply with FCC RF exposure compliance requirements, a separation distance of at least 24cm must be maintained between the antenna of this device and all persons. This device must not be co-located or operation in conjunction with any other antenna or transmitter. Any changes or modifications (including the antenna) made to this device that are not expressly approved by the manufacturer may void the user's authority to operate the equipment.

DOGTRA EXTENDED PRODUCT WARRANTY

EXTENDED LIMITED WARRANTY

For Certain Dogtra Products Purchased from Dogtra Authorized Dealers

1+1 Year Extended Warranty

Except as otherwise provided, Dogtra warrants to the original retail purchaser (“You”) that your Dogtra product shall be free of defects in materials and workmanship for a period of one (1) year from the date of purchase (“Original Warranty”). As a special promotion, Dogtra further warrants that your Dogtra product shall be free of defects in materials and workmanship for an additional one (1) year from the date that your original warranty expires (“Extended Warranty”). The Original and Extended Warranties cover the cost of repair (parts and labor) or replacement (if repair is not feasible) of a defective Dogtra product during said warranty periods. For such repaired or replaced products, the remaining portion of the warranty periods, or ninety (90) days, whichever is longer, shall apply. Dogtra, at its sole discretion, shall determine whether to repair or replace a product covered by the Original Warranty or Extended Warranty.

Warranty Conditions

The Original and Extended Warranties are not transferrable and apply to your Dogtra product only if:

- (1) You are the original retail purchaser of the product,
- (2) You bought the product from a Dogtra Authorized Dealer, and
- (3) You present a receipt or other proof of purchase showing a valid purchase date, the name and address of the Dogtra Authorized Dealer, and the purchased product identified by model and/or serial number.

Warranty Exclusions

The Original and Extended Warranties do not cover damage, loss, or deterioration to your Dogtra product caused: by misuse, neglect, abuse, or other improper handling of the product; by failure to follow use or care instructions; by use of the product for other than its intended purpose; by accident or natural forces such as fire or flooding; or by normal wear and tear such as scratches to the product surface.

The Original and Extended Warranties also do not cover Dogtra products that: are purchased from non-authorized dealers; are purchased outside of the United States or Canada; have been damaged during shipment (even if Dogtra paid or arranged for shipping); have been modified or tampered with in any manner; are opened or repaired by anyone other than Dogtra; or have serial numbers that have been altered or defaced.

Sole Warranties

The Original and Extended Warranties are the only warranties offered by Dogtra for your Dogtra product during said warranty periods. Other than the Original and Extended Warranties, Dogtra makes no other representations or warranties whatsoever regarding its products, whether oral or in any product manual, on any packaging, on any website, or in any other written material. No dealer of Dogtra products, nor any employee or agent of Dogtra, is authorized to make any additions, changes, or extensions to the Original Warranty or Extended Warranty. Dogtra, at its sole discretion and at any time, reserves the right to modify the Original and/or Extended Warranties.

DISCLAIMER OF OTHER WARRANTIES

THE FOREGOING ORIGINAL AND EXTENDED WARRANTIES ARE PROVIDED IN LIEU OF ALL OTHER WARRANTIES, WHETHER EXPRESS OR IMPLIED. DOGTRA DISCLAIMS ANY IMPLIED WARRANTIES INCLUDING, BUT NOT LIMITED TO, THE IMPLIED WARRANTIES OF MERCHANTABILITY AND FITNESS FOR A PARTICULAR PURPOSE.

Limitation of Remedies

Dogtra's liability is limited to the cost of repair or replacement of the Dogtra product under the Original Warranty or Extended Warranty. Any claim or action to enforce the Original and/or Extended Warranties must be commenced within thirty (30) days of such warranty's expiration for your product. Dogtra will not be liable for any indirect, incidental, special, consequential, or similar damages based on breach of warranty, breach of contract, negligence, strict tort, or any other legal theory related to Dogtra and its products. Damages that Dogtra will not be responsible for include, but are not limited to: loss of income or profits; loss of revenue or savings; loss of use of the product or associated products; cost of any substitute products or services; inconvenience, downtime, or any other time; loss of goodwill; claims of third parties including customers; and damage to property.

Legal Rights May Vary By State or Jurisdiction

The Original and Extended Warranties give You specific legal rights, and You may also have other rights which vary by state or jurisdiction. Some states or jurisdictions do not allow certain limitations of implied warranties or of incidental or consequential damages or other remedies, so certain of the foregoing limitations may not apply to You.

If any portion of the Original Warranty or Extended Warranty is held by a court to be invalid or unenforceable, the remaining portions of such warranties shall remain in full force and effect and shall in no way be affected or invalidated, and the invalid or unenforceable portion shall be modified so as to most nearly achieve the intent of the Original Warranty or Extended Warranty.

Product Registration

Dogtra recommends that customers register their products as soon as possible after purchase. Product registration will facilitate any future warranty service. You may also receive useful information and updates about your existing and future Dogtra products. To register your product, visit www.dogtra.com/product-registration. If your product is not registered with Dogtra, You will be required to provide a receipt or other proof purchase (as provided above) to qualify for warranty service.

How to Obtain Warranty Service

Should your Dogtra product require warranty service, please contact Customer Service by phone or email for a warranty evaluation (see below for contact information). Upon approval of your warranty work, Dogtra will repair or replace (at Dogtra's election) your product without charge for labor or parts. You are responsible for shipping, including cost, of your product to Dogtra for warranty service. Dogtra will handle shipping, including cost, of the repaired or replaced product back to customers in the USA. Dogtra will not be responsible for shipping, including cost and/or applicable taxes or fees, for products sent outside the USA. Such costs, taxes, or fees will be borne by the customer.

Dogtra Customer Service

12322 Monarch Street, Garden Grove, CA 92841

(888) 811-9111 | repair@dogtra.com | Mon - Fri, 8:00 AM to 4:30 PM (PST)

© 2025 Dogtra. All rights reserved.