



UPLAND
HUNTER®

SD-
1875

VISIT GUN DOG SUPPLY.COM
ORDER A SPORTDOG SD-1875 SYSTEM
SEE OTHER SPORTDOG PRODUCTS

OPERATING GUIDE
PLEASE READ THIS ENTIRE GUIDE BEFORE BEGINNING

IMPORTANT SAFETY INFORMATION

Explanation of Attention Words and Symbols used in this guide



This is the safety alert symbol. It is used to alert you to potential personal injury hazards. Obey all safety messages that follow this symbol to avoid possible injury or death.

⚠ WARNING

WARNING indicates a hazardous situation which, if not avoided, could result in death or serious injury.

CAUTION

CAUTION, used without the safety alert symbol, indicates a hazardous situation which, if not avoided, could result in harm to your dog.

⚠ WARNING

- Not for use with aggressive dogs. Do not use this product if your dog is aggressive, or if your dog is prone to aggressive behavior. Aggressive dogs can cause severe injury and even death to their owner and others. If you are unsure whether this product is appropriate for your dog, please consult your veterinarian or a certified trainer.
- This device contains Lithium-Ion (Li-Ion) batteries; never incinerate, puncture, deform, short-circuit, or charge with an inappropriate charger. Fire, explosion, property damage, or bodily harm may occur if this warning is not followed.
- Risk of explosion if battery is replaced by an incorrect type. Dispose of used batteries according to the instructions.

CAUTION Please read and follow the instructions in this manual. Proper fit of the collar is important. A collar worn for too long, or made too tight on the dog's neck may cause skin damage. This is called bed sores; it is also called decubitus ulcers or pressure necrosis.

- Avoid leaving the collar on the dog for more than 12 hours per day.
- When possible, reposition the collar on the dog's neck every 1 to 2 hours.
- Check the fit to prevent excessive pressure; follow the instructions in this manual.
- Never connect a lead to the electronic collar; it will cause excessive pressure on the contacts.
- When using a separate collar for a lead, don't put pressure on the electronic collar.
- Wash the dog's neck area and the contacts of the collar weekly with a damp cloth.
- Examine the contact area daily for signs of a rash or a sore.
- If a rash or sore is found, discontinue use of the collar until the skin has healed.
- If the condition persists beyond 48 hours, see your veterinarian.

For additional information on bed sores and pressure necrosis, please visit the FAQ section for remote trainers at www.sportdog.com.

These steps will help keep your dog safe and comfortable. Millions of dogs are comfortable while they wear stainless steel contacts. Some dogs are sensitive to contact pressure. You may find after some time that your dog is very tolerant of the collar. If so, you may relax some of these precautions. It is important to continue daily checks of the contact area. If redness or sores are found, discontinue use until the skin has fully healed.

- You may need to trim the hair in the area of the contact points or switch to the longer contact points to ensure consistent contact. Never shave the dog's neck; this may lead to a rash or infection.
- You should not make the collar any tighter than is required for good contact. A collar that is too tight will increase the risk of pressure necrosis in the contact area.

Thank you for choosing SportDOG Brand.® Used properly, this product will help you track/train your dog efficiently and safely. To ensure your satisfaction, please review this owner's manual thoroughly. If you have questions regarding this product's operation, please see this manual's Frequently Asked Questions or Troubleshooting section, contact our Customer Care Center at 1-800-732-0144, or visit our website at www.sportdog.com.

To get the most protection out of your warranty, please register your product within 30 days at www.sportdog.com. By registering, and keeping your receipt you will enjoy the product's full warranty and should you ever need to call the Customer Care Center, we will be able to help you faster. Most importantly, SportDOG™ will never give or sell your valuable information to anyone. Complete warranty information is available online at www.sportdog.com.

TABLE OF CONTENTS

COMPONENTS	5
HOW THE SYSTEM WORKS	5
KEY DEFINITIONS	6
PREPARE THE REMOTE TRANSMITTER	8
PREPARE THE COLLAR RECEIVER	9
PREPARE THE REMOTE BEEPER	11
FIT THE UPLANDHUNTER® 1875	12
FIND THE BEST INTENSITY LEVEL FOR YOUR DOG	13
CHANGE STIMULATION RANGES	14
GENERAL TRAINING TIPS	14
PROGRAM THE REMOTE TRANSMITTER	15
MATCH THE COLLAR RECEIVER, REMOTE BEEPER AND REMOTE TRANSMITTER	18
PROGRAM THE REMOTE BEEPER	18-19
CHANGE TONES	
CHANGE RUN MODE	
PROGRAM THE SYSTEM FOR TWO-DOG OPERATION	20
PROGRAM THE SYSTEM FOR THREE-DOG OPERATION	20
CHANGE ID CODES	21
ACCESSORIES	22
FREQUENTLY ASKED QUESTIONS	23
TROUBLESHOOTING	25
TEST LIGHT INSTRUCTIONS	26
TERMS OF USE AND LIMITATION OF LIABILITY	26
FCC COMPLIANCE	27
BATTERY DISPOSAL	28
SPORTDOG™ ADD-A-DOG® RECEIVER/REMOTE BEEPER	32

COMPONENTS



HOW THE SYSTEM WORKS

The SportDOG™ UplandHunter® 1875 has been proven safe, comfortable and effective for all dogs over 8 pounds. Consistent, correct use of this product allows you to reinforce commands and correct misbehavior from one mile. The Remote Beeper feature provides a tone that can be heard up to 500 yards, which allows you to keep track of your dog's position, even when you can't see him. The Remote Transmitter controls both of these functions, providing unmatched convenience and versatility. The Remote Transmitter sends a signal, activating the Collar Receiver to deliver a harmless stimulation. With proper training, a dog will learn to associate this signal with a command. Like all SportDOG products, this model features adjustable stimulation levels so you can tailor the stimulation level to your dog's temperament, eliminating the risk of over-correction.

IMPORTANT: THE UPLANDHUNTER 1875 HAS A RANGE OF ONE MILE. DEPENDING ON THE WAY YOU HOLD THE REMOTE TRANSMITTER, THE MAXIMUM RANGE MAY VARY. FOR CONSISTENT RESULTS AT LONGER RANGES, HOLD THE REMOTE TRANSMITTER IN A VERTICAL POSITION AWAY FROM YOUR BODY AND ABOVE YOUR HEAD. TERRAIN, WEATHER, VEGETATION, TRANSMISSION FROM OTHER RADIO DEVICES, AND OTHER FACTORS WILL AFFECT THE MAXIMUM RANGE.



⚠ WARNING Do not use this product if your dog is aggressive, or if your dog is prone to aggressive behavior. Aggressive dogs can cause severe injury and even death to their owner and others. If you are unsure whether this product is appropriate for your dog, please consult your veterinarian or a certified trainer.

KEY DEFINITIONS

REMOTE TRANSMITTER

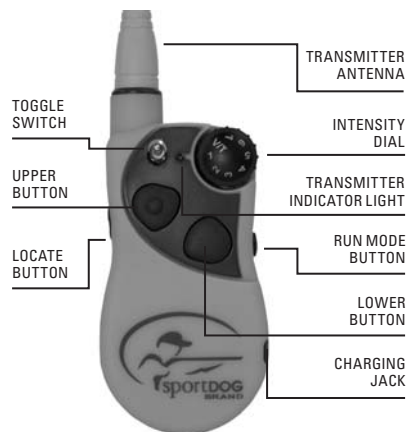

REMOTE TRANSMITTER: Transmits the radio signal to the Collar Receiver and Remote Beeper. It is waterproof and can be submerged in water to a depth of 25 feet.

INTENSITY DIAL: Provides multiple levels/types of stimulation so you can match the correction to your dog's temperament.

TRANSMITTER INDICATOR LIGHT: Indicates that a button is pressed and also serves as a low-battery indicator.

TOGGLE SWITCH: This switch is factory-set so that the Remote Transmitter can control two Collar Receivers and two Remote Beepers.

UPPER BUTTON: This button is factory-set to deliver continuous stimulation.

LOWER BUTTON: This button is factory-set to deliver momentary stimulation, or a "Nick."

LOCATE BUTTON: Pressing and releasing this button produces a single beep from the Remote Beeper and disables the Remote Beeper's Run Mode.

RUN MODE BUTTON: Pressing and holding this button changes the Remote Beeper's run mode, which is indicated on the back of the Remote Transmitter. Pressing and releasing this button activates the Remote Beeper's Run Mode after it has been disabled by the Locate Button.

CHARGING JACK: For connecting the charger. Although the Remote Transmitter is waterproof without it, keep the cover in place when not charging to keep debris out of the opening.

RUN MODE INDICATORS: When the Run Mode Button is held, an indicator light will rotate through the Remote Beeper's three Run Mode options (see page 19):

1. Silent – No beep when dog is running/Beeps once per second when dog is on point.
2. 5 Second – Beeps every 5 seconds when dog is running/Beeps once per second when dog is on point.
3. 10 Second – Beeps every 10 seconds when dog is running/Beeps once per second when dog is on point

MODE BUTTON: Depressing and releasing this button allows you the ability to change the mode of your Remote Transmitter (see page 15).

COLLAR RECEIVER

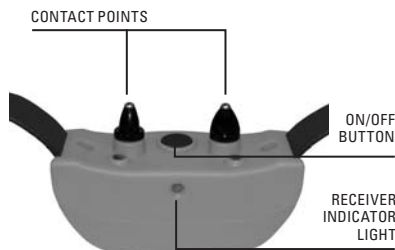

COLLAR RECEIVER: Receives the radio signal from the Remote Transmitter and delivers the stimulation, vibration and/or a tone for correcting or cueing your dog. It is waterproof and can be submerged in water to a depth of 25 feet.

RECEIVER INDICATOR LIGHT: Indicates when the Collar Receiver has been turned on or off, serves as a low-battery indicator and also indicates when a continuous or momentary (nick) stimulation button is pressed.

CONTACT POINTS: The contacts through which the Collar Receiver delivers stimulation.

ON/OFF BUTTON: Momentarily pressing and releasing this button turns the Collar Receiver on and off.

THE COLLAR RECEIVER IS CAPABLE OF DELIVERING FOUR TYPES OF STIMULATION:

CONTINUOUS: You control both when and how long stimulation is delivered, up to a maximum of 10 seconds. After 10 seconds, the stimulation will “time out” and the Remote Transmitter button needs to be released and then pressed again before additional stimulation can be delivered.

MOMENTARY (NICK): Stimulation is delivered for 1/10 of a second, regardless of how long the button is pressed.

TONE: The Collar Receiver will make a rapid beeping noise when a Tone button is pressed, up to a maximum of 10 seconds.

VIBRATION: The Collar Receiver will vibrate when a Vibration button is pressed, up to a maximum of 10 seconds.

REMOTE BEEPER

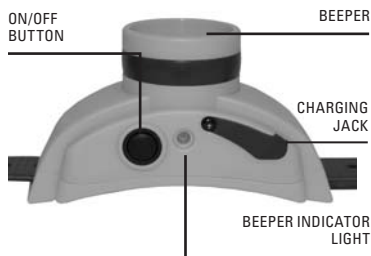

REMOTE BEEPER: Receives the radio signal from the Remote Transmitter and beeps with a tone and frequency set by the user. It is waterproof and can be submerged in water to a depth of 25 feet.

ON/OFF BUTTON: Turns the beeper on and off. The Remote Beeper's functions can be disabled from the Remote Transmitter, but the Remote Beeper should be turned off using this button when not in use to conserve battery life.

INDICATOR LIGHT: Indicates when the Remote Beeper has been turned on or off and also serves as a low-battery indicator.

BEEPER: The point at which the sound is produced.

CHARGING JACK: For connecting the charger. Although the Remote Beeper is waterproof without it, keep the cover in place when not charging to keep debris out of the opening.

PREPARE THE REMOTE TRANSMITTER

CHARGE THE REMOTE TRANSMITTER

1. Lift the rubber cover protecting the Charging Jack.
2. Connect one of the charger connectors to the Charging Jack.
3. Plug the charger into a standard 120/240-volt AC wall outlet.
4. Charge the Remote Transmitter for 2 hours for the first charge and every charge thereafter.

Using Li-Ion technology, the Remote Transmitter only requires a 2 hour charge. It is not harmful to let the unit charge for more than 2 hours.

5. When charging is complete, replace the rubber cover.



CHARGER
CONNECTOR PLACED
IN THE REMOTE
TRANSMITTER
CHARGING JACK

NOTE: Approximate battery life between charges is 40 to 60 hours, depending on frequency of use.

TRANSMITTER INDICATOR LIGHT

OPERATIONAL MODE	LIGHT COLOR	BATTERY STATUS	LIGHT FUNCTION
Continuous stimulation, tone, vibrate, locate or run mode button pressed	Green	Good	Light is solid in color while button is pressed
Continuous stimulation, tone, vibrate, locate or run mode button pressed	Red	Low	Light is solid in color while button is pressed
Momentary stimulation button pressed	Green	Good	Light flashes once and turns off
Momentary stimulation button pressed	Red	Low	Light flashes once and turns off
Unit is charging	Red	Low	Light is solid in color while on the charger
Unit is fully charged (charger still connected)	Green	Good	Light flashes once per second once the battery is completely charged

PREPARE THE COLLAR RECEIVER

CHARGE THE COLLAR RECEIVER

1. Place Collar Receiver in Charging Cradle as shown.
2. Place the charger connector into the back of the Charging Cradle.
3. Plug the charger into a standard 120/240-volt AC wall outlet.
4. Charge the Collar Receiver for 2 hours for the first charge and every charge thereafter.

Using Li-Ion technology, the Collar Receiver only requires a 2 hour charge. It is not harmful to let the unit charge for more than 2 hours.



NOTE: Approximate battery life between charges is 40 to 60 hours, depending on frequency of use.

CHARGE CRADLE INDICATOR LIGHT

OPERATIONAL MODE	LIGHT COLOR	LIGHT FUNCTION
No Collar Receiver on the Charging Cradle but charger is connected	Green	Light is solid in color
Unit is charging	Red	Light is solid in color while charging
Unit is fully charged (Collar Receiver on Charging Cradle)	Green	Light flashes once per second once the battery is completely charged

TO TURN THE COLLAR RECEIVER ON

Press and release the On/Off Button. The Receiver Indicator Light comes on and the Collar Receiver will beep 1 to 3 times depending on what stimulation range is chosen. The default is 2 or medium.

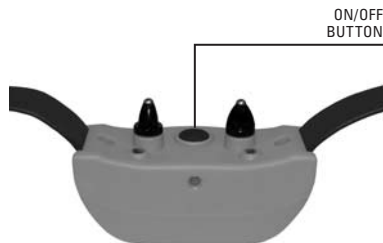

TO TURN THE COLLAR RECEIVER OFF

Press and release the On/Off Button. The Receiver Indicator Light comes on solid (red) and the Collar Receiver beeps continuously for 2 seconds.

To extend the life between charging cycles, turn the Collar Receiver off when it is not in use.

RECEIVER INDICATOR LIGHT

OPERATIONAL MODE	LIGHT COLOR	LIGHT FUNCTION	BATTERY STATUS	SPEAKER FUNCTION	VIBRATION
Unit is turned on via On/Off Button	Green	Light is solid in color during beep sequence	Good	Beeps 1-3 times depending on stimulation range setting (2 is the default setting). See page 14.	N/A
Unit is turned on via On/Off Button	Red	Light is solid in color during beep sequence	Low		
Unit is turned off via On/Off Button	Red	Light is solid in color during beep sequence	N/A	Beeps continuously for 2 seconds	N/A
Unit is on	Green	Light flashes every 3 seconds	Good	N/A	N/A
Unit is on	Red	Light flashes every 3 seconds	Low	N/A	N/A
Unit is delivering continuous stimulation	Red	Light is solid in color for as long as button is pressed	N/A	N/A	N/A
Unit is delivering momentary stimulation	Red	Light will quickly flash once no matter how long button is pressed	N/A	N/A	N/A
Unit is delivering tone	Off	N/A	N/A	Unit will beep for as long as button is pressed	N/A
Unit is delivering vibration	Off	N/A	N/A	N/A	Unit will vibrate for as long as button is pressed

RECHARGEABLE BATTERIES

⚠ WARNING

- This device contains Lithium-Ion (Li-Ion) batteries; never incinerate, puncture, deform, short-circuit, or charge with an inappropriate charger. Fire, explosion, property damage, or bodily harm may occur if this warning is not followed.
- Risk of explosion if battery is replaced by an incorrect type. Dispose of used batteries according to the instructions (see page 28).
- Batteries should never be removed from the battery compartment for charging.
- Risk of explosion if batteries are charged in areas with high temperature (100° F+).
- The rechargeable Lithium Ion (Li-Ion) batteries are not memory sensitive, do not require depletion before charging and cannot be over charged.
- The batteries come partially charged from the factory, but will require a full charge before the first use.

STEP :: 03

- When storing the unit for long periods, remember to regularly give batteries a full charge. This should be done once every 3 to 4 months.
- You should expect hundreds of recharge cycles from your batteries. However, all rechargeable batteries lose capacity over time relative to the number of recharge cycles they experience. This is normal. If your operating time drops to half of the original life, contact the Customer Care Center to purchase a new battery.
- The batteries should last for a period of 3-5 years. When a battery needs replacement, you can order a new pack by calling our Customer Care Center at 1-800-732-0144. Please do not open the Collar Receiver, Remote Transmitter or Remote Beeper until you have received the replacement.

PREPARE THE REMOTE BEEPER

CHARGE THE REMOTE BEEPER

1. Lift the rubber cover protecting the Charging Jack.
2. Connect accessory cable to cradle and Remote Beeper.
3. Plug the charger into a standard 120/240-volt AC wall outlet.
4. Charge the Remote Beeper for 2 hours for the first charge and every charge thereafter.



Using Li-Ion technology, the Remote Beeper only requires a 2 hour charge. It is not harmful to let the unit charge for more than 2 hours.

5. When charging is complete, replace the rubber cover.

NOTE: Approximate battery life between charges is 60-80 hours, depending on frequency of use.

TURN THE REMOTE BEEPER ON

Press and release the On/Off Button. The Remote Beeper Indicator Light will come on and the Remote Beeper will beep 1 time.

TURN THE REMOTE BEEPER OFF

Press and release the On/Off Button. The Remote Beeper Indicator Light will come on solid (red) and the Remote Beeper will beep for 1 second.

REMOTE BEEPER INDICATOR LIGHT

REMOTE BEEPER FUNCTION	LIGHT COLOR	LIGHT FUNCTION	BATTERY STATUS
Unit is on	Green	Light flashes every 3 seconds	Good
Unit is on	Red	Light flashes every 3 seconds	Low
Unit is turned on via On/Off Button	Green	Light is solid in color during beep sequence	N/A
Unit is turned off via On/Off Button	Red	Light is solid in color during beep sequence	N/A

FIT THE UPLANDHUNTER® 1875

IMPORTANT: The proper fit and placement of the Collar Receiver is important for effective training. The Contact Points must have direct contact with your dog's skin.

CAUTION Please read and follow the instructions in this manual. Proper fit of the collar is important. A collar worn for too long, or made too tight on the dog's neck may cause skin damage. This is called bed sores; it is also called decubitus ulcers or pressure necrosis.

- Avoid leaving the collar on the dog for more than 12 hours per day.
- When possible reposition the collar on the dog's neck every 1 to 2 hours.
- Check the fit to prevent excessive pressure; follow the instructions in this manual.
- Never connect a lead to the electronic collar; it will cause excessive pressure on the contacts.
- When using a separate collar for a lead, don't put pressure on the electronic collar.
- Wash the dog's neck area and the contacts of the collar weekly with a damp cloth.
- Examine the contact area daily for signs of a rash or a sore.
- If a rash or sore is found, discontinue use of the collar until the skin has healed.
- If the condition persists beyond 48 hours, see your veterinarian.

For additional information on bed sores and pressure necrosis, please visit the FAQ section for remote trainers at www.sportdog.com.

These steps will help keep your dog safe and comfortable. Millions of dogs are comfortable while they wear stainless steel contacts. Some dogs are sensitive to contact pressure. You may find after some time that your dog is very tolerant of the collar. If so, you may relax some of these precautions. It is important to continue daily checks of the contact area. If redness or sores are found, discontinue use until the skin has fully healed.

This system is designed so you can add or remove the Remote Beeper to or from the Collar Receiver strap as needed. The Remote Beeper can also be used on the collar strap without the Collar Receiver.

To ensure a proper fit, follow these steps:

1. Thread the end of the collar strap through the slot in the Remote Beeper and then through the slot on the opposite side of the Remote Beeper. Slide the Remote Beeper a few more inches up the collar strap.
2. With your dog standing (4A), center the Collar Receiver so the Contact Points are underneath your dog's neck, touching the skin (4B) and the Remote Beeper is centered behind the dog's head. If your dog has a long or thick coat, you have two options to ensure consistent contact: either trim the hair around the Contact Points or switch to the longer Contact Points included with your system.

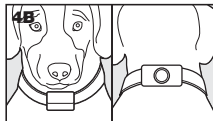
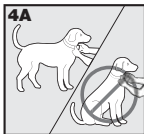

CAUTION

- You may need to trim the hair in the area of the Contact Points. Never shave the dog's neck; this may lead to a rash or infection.
- You should not make the collar any tighter than is required for good contact. A collar that is too tight will increase the risk of pressure necrosis in the contact area.

3. The Collar Receiver should fit snugly, yet loose enough to allow one finger to fit between the strap and your dog's neck (4C).
4. Allow your dog to wear the collar for several minutes, and then recheck the fit. Check the fit again as your dog becomes more comfortable wearing the Collar Receiver.

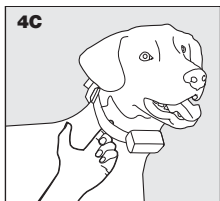

STEP :: 05

FIND THE BEST INTENSITY LEVEL FOR YOUR DOG

The UplandHunter® 1875 has multiple intensity levels. This allows you to choose the stimulation that is best for your dog.

NOTE: Always start at the lowest level and work your way up.

For training efficiency, it is important to find the right intensity level for your dog. This is called the Recognition Level, at which your dog looks around in curiosity, or flicks his ears.

FINDING YOUR DOG'S RECOGNITION LEVEL

NOTE: Every dog is different and you cannot predict where your dog's Recognition Level will be. Watch closely for any slight change in behavior that tells you your dog is feeling the stimulation.

1. With the Collar Receiver turned on and properly fitted to your dog, set the Remote Transmitter's Intensity Dial at Level 1 and press the Continuous Stimulation Button for 1 to 2 seconds.
2. If your dog shows no reaction to Level 1, go to Level 2 and repeat the process.
3. **YOUR DOG SHOULD NOT VOCALIZE OR PANIC WHEN RECEIVING STIMULATION. IF THIS HAPPENS, THE STIMULATION LEVEL IS TOO HIGH AND YOU NEED TO GO BACK TO THE PREVIOUS LEVEL AND REPEAT THE PROCESS.**
4. Once you find your dog's Recognition Level, this is the level you should use when you begin a training exercise.
5. If you have progressed to Level 7 while searching for your dog's Recognition Level and your dog continues to show no response, check to see if Collar Receiver is snug against your dog's neck. Then go back to Intensity Level 1 and repeat the process. If your dog still does not indicate he is feeling the stimulation, you have three options: you may have to trim the hair beneath the Contact Points, switch to the longer Contact Points included in your system or change the stimulation range (see page 14).

If after completing all of these steps your dog still does not indicate he is feeling the stimulation, please contact Customer Care Center at 1-800-732-0144.

CHANGE STIMULATION RANGES

The UplandHunter® 1875 Collar Receiver comes with 3 stimulation ranges (low, medium and high). There are 7 stimulation levels within each range, with 1 being the lowest and 7 being the highest. The default range setting is 2 or medium.

To change the range of stimulation, follow these steps:

1. Make sure the Collar Receiver is off.
2. Then turn the unit on by pressing and releasing the on/off button.
3. After the Indicator Light turns off and within 5 seconds, press and hold the on/off button for 3 seconds.
4. The Collar Receiver will then beep once and the Indicator Light will flash orange. This indicates **Low** stimulation range. If **Medium** or **High** are desired, continue to hold the button until the number of beeps/orange flashes equals the desired stimulation range shown in the chart below.
5. Release the button once the desired range is selected; the Collar Receiver will turn off.
6. Turn the unit back on. It will then beep according to the stimulation range selected in step 4.

	STIMULATION RANGE	DOG TEMPERAMENT
1 beep	Low	Mild
2 beeps	Medium	Moderate
3 beeps	High	Stubborn

GENERAL TRAINING TIPS

BEFORE TRAINING YOUR DOG WITH THIS PRODUCT

You will have the most success using this remote trainer if you always remember to teach a command before trying to reinforce the command with a remote trainer. We recommend that you read the enclosed Training Guide and watch the enclosed DVD before training with this remote trainer. Your training will be easier and proceed faster if you follow the guidelines in these teaching assistants. In addition, always keep the following training tips in mind:

- Eliminate one misbehavior or teach one obedience command at a time. If you move too fast with the training, your dog may become confused.
- Be consistent. Give your dog a tone, vibration and/or stimulation with each misbehavior.
- Do not overcorrect your dog. Use as few stimulations as possible to train your dog.
- Restrict your dog from situations in which he has a history of misbehaving unless you can supervise him and use the UplandHunter® 1875 for applying tone, stimulation or vibration.
- If you notice one situation in which your dog misbehaves repeatedly, set up this situation as a training session. This will dramatically increase your chances of success.
- If your dog has a timid reaction to the tone, stimulation or vibration (especially the first couple of times), do not be alarmed. Redirect his attention to a simple and appropriate behavior (i.e. a known command, such as "Sit").
- Never use the UplandHunter 1875 to correct or eliminate any form of aggressive behavior. If your dog exhibits such behavior, contact a professional trainer. Aggression in dogs is the result of many factors – it may be a learned behavior or it may be brought on as a result of fear. Another factor contributing to aggression in dogs is social dominance. Every dog is different.

At this point, your remote trainer is ready to use. The transmitter is factory set to mode 1, but you may wish to change the mode to fit your situation. See Step 6, for an explanation of mode options.

PROGRAM THE REMOTE TRANSMITTER

The UplandHunter® 1875 has 12 operational modes to allow you to select the best match for your type or style of training. The Remote Transmitter comes factory set to mode 1. There are also two programming modes: Mode 7 (Change Tones) on page 18 and Mode V/T (Change ID Codes) on page 21.

TO CHANGE THE MODE:

1. Refer to the following tables for desired modes.
2. For modes 1 – 6, in the Toggle Switch **up** position, select the desired mode on the Intensity Dial. Or for modes 1 – 6, in the Toggle Switch **down** position, select the desired mode on the Intensity Dial. For example, if mode 5 is desired, in either the Toggle Switch **up** or Toggle Switch **down** position, set the Intensity Dial to level 5.
3. Turn the Remote Transmitter over.
4. Using a pen or the tine of a buckle, depress and release the Mode Button. When pressed, the Transmitter Indicator Light will be solid in color. When it is released, the Indicator Light will flash the number of times for the mode selected. For example, mode 5 would flash 5 times.



NOTE: For two-dog operation setup refer to Step 9 on page 20. For three-dog operation setup refer to Step 10 on page 20.

*Mode 3, in both the Toggle Switch **up** and **down** position, provides more “increments” to choose from – a total of 14 levels of stimulation. For example, in mode 3 with the Intensity Dial set at 2, the lower button provides level 3 of 14 and the upper button provides level 4 of 14.*

TOGGLE SWITCH IN THE UP POSITION

MODE	UPPER BUTTON FUNCTION	LOWER BUTTON FUNCTION	LEFT-SIDE BUTTON FUNCTION	RIGHT-SIDE BUTTON FUNCTION	TOGGLE SWITCH FUNCTION	V/T FUNCTION
1	HIGH Continuous stimulation*	HIGH Momentary (nick) stimulation*	Call/Locate Mode – single tone**	Run Mode	Up: Dog 1 Down: Dog 2	Tone
2	HIGH Continuous stimulation*	Tone	Call/Locate Mode – single tone**	Run Mode	Up: Dog 1 Down: Dog 2	Vibration
3	MEDIUM Continuous stimulation*	LOW Continuous stimulation*	Call/Locate Mode – single tone**	Run Mode	Up: Dog 1 Down: Dog 2	Tone
4	HIGH Continuous stimulation*	No function	Call/Locate Mode – single tone**	Run Mode	Up: Dog 1 Down: Dog 2	Tone
5	Dog 1	Dog 2	Dog 3	No function	Up: Continuous* Down: Call/ Locate**/Run Mode***	Tone
6	HIGH Continuous stimulation*	HIGH +2 Intensity Continuous stimulation*	Call/Locate Mode – single tone**	Run Mode	Up: Dog 1 Down: Dog 2	Tone
7 (Change tones)	Dog 1 See step 8	Dog 2 See step 8	Dog 3 See step 8	No function	Up position	No function
V/T (ID CODE)	No function	No function	See step 11	No function	Up position	No function

TOGGLE SWITCH IN THE DOWN POSITION

MODE	UPPER BUTTON FUNCTION	LOWER BUTTON FUNCTION	LEFT-SIDE BUTTON FUNCTION	RIGHT-SIDE BUTTON FUNCTION	TOGGLE SWITCH FUNCTION	V/T FUNCTION
1	HIGH Continuous stimulation*	HIGH Momentary (nick) stimulation*	Call/Locate Mode – single tone**	Run Mode	Up: Dog 1 Down: Dog 2	Vibration
2	HIGH Continuous stimulation*	Vibration	Call/Locate Mode – single tone**	Run Mode	Up: Dog 1 Down: Dog 2	Tone
3	MEDIUM Continuous stimulation*	LOW Continuous stimulation*	Call/Locate Mode – single tone**	Run Mode	Up: Dog 1 Down: Dog 2	Vibration
4	HIGH Continuous stimulation*	No function	Call/Locate Mode – single tone**	Run Mode	Up: Dog 1 Down: Dog 2	Vibration
5	Dog 1	Dog 2	Dog 3	No function	Up: Continuous* Down: Call/ Locate**/Run Mode***	Vibration
6	HIGH Continuous stimulation*	HIGH +2 Intensity Continuous stimulation*	Call/Locate Mode – single tone**	Run Mode	Up: Dog 1 Down: Dog 2	Vibration

*Stimulation levels set by intensity dial

**Call/Locate Mode turns off Run Mode

***To enable Run Mode, press and hold the corresponding Locate Button for 3 seconds

MATCH THE COLLAR RECEIVER, REMOTE BEEPER AND REMOTE TRANSMITTER

To reset the Collar Receiver/Remote Beeper to work with a new Remote Transmitter or to reprogram a new Collar Receiver/Remote Beeper to work with your existing Remote Transmitter:

- Turn the Collar Receiver/Remote Beeper off.
- Press and hold the On/Off Button for each. The Collar Receiver/Remote Beeper Indicator Lights will come on, then turn off after 4-5 seconds. If the On/Off Button is released too early, the Collar Receiver/Remote Beeper Indicator Lights will begin flashing as normal. If this occurs, start over from **A**.
- After the Collar Receiver/Remote Beeper Indicator Lights have turned off, release the On/Off Button.
- Press and hold the Upper Button on the Remote Transmitter until the Collar Receiver/Remote Beeper Indicator Lights flash 5 times. Once the Collar Receiver/Remote Beeper Indicator Lights have flashed 5 times, the Collar Receiver/Remote Beeper have been matched and will begin flashing as normal. If the Collar Receiver/Remote Beeper Indicator Lights do not flash 5 times, start over from **A**.

PROGRAM THE REMOTE BEEPER

CHANGE TONES

The UplandHunter® 1875 Comes with nine tones. The default tone is High Volume Beep. **The Remote Beeper must be matched to the Remote Transmitter to change the tone settings remotely.** See Step 7 above.

MODE	TONE
1	High Volume Beep
2	Double High Beep
3	High Falling To Low Volume Beep
4	Double High Falling To Low Volume Beep
5	Low Volume Hawk
6	High Volume Hawk
7	Bob White Quail Call
8	Triple Beep
9	Low Volume Beep

TO CHANGE THE TONE:

- While the Remote Beeper is still on, set the Intensity Dial on the Remote Transmitter to position 7 with the toggle switch in the **up** position.
- Press the mode button on the back of the Remote Transmitter. The LED will illuminate green.
- Press the Upper Button on the Remote Transmitter for Dog 1. The Remote Beeper will start cycling through the tones by playing them one at a time.
- Once you have heard the tone you want, press the Upper Button for Dog 1 again on the Remote Transmitter to select that tone. The Remote Beeper will emit 3 beeps to confirm that you selected a tone.

5. You do have the ability to select a different tone for each dog. For Dog 2, follow the previous steps using the Lower Button in place of the Upper Button. For Dog 3, follow the previous steps using the Locate Button in place of the Upper Button.
6. Turn the Intensity Dial one position. The Remote Transmitter's Indicator Light will turn off.
7. Press the corresponding button for each dog (with the toggle switch in the **up** position) and the selected tone will play.

CHANGE RUN MODE

The Run Mode is changed using the Run Mode button on the Remote Transmitter. You have three choices of how often the beeper sounds off when your dog is moving: Never (Silent Mode), every 5 seconds (5 Second Mode) or every 10 seconds (10 Second Mode). In all modes, the Remote Beeper beeps once per second when the dog stops moving.

1. Press and hold the Run Mode button while viewing the back of the Remote Transmitter.
2. After 2 to 3 seconds, an indicator light next to the current run mode will light up.
3. Continue holding the Run Mode button until the indicator light for the desired mode lights up.
4. Release the Run Mode button. The Indicator Light next to the corresponding mode will flash several times indicating the new run mode is set.

NOTE: If you would like different run modes for each dog in 3-Dog operation, follow the instructions below to manually configure each of their Remote Beeper's.

LOCATING YOUR DOG IN THE FIELD

Anytime your dog is within one mile, you can make the Remote Beeper beep by pressing the Locate Button on the Remote Transmitter. The Remote Beeper will beep once each time you press the button. Pressing the Locate Button disables the Remote Beeper's run mode, but it is still on. To reactivate the run mode, press and release the Remote Transmitter's Run Mode button. The Remote Beeper will emit 3 beeps to confirm run mode has been activated and will continue operating in the last run mode in which it was set.

MANUALLY CONFIGURE REMOTE BEEPER

While the Remote Beeper can be remotely programmed from the Remote Transmitter, you can also set tone and run mode from the beeper itself.

1. Turn the Remote Beeper off.
2. Press and release the On/Off button to turn on the Remote Beeper.
3. Within 5 seconds press and hold the On/Off button. The Remote Beeper will begin to cycle through available tones.
4. When the desired tone is heard, release the button before the next tone starts. Tone is now set.
5. Press and hold the button immediately following tone selection completion until the number of beeps matches the desired run mode as shown in the chart below.

1 Beep (Silent)	No beep when dog is running/Beeps once per second when dog is on point
2 Beeps (5 second)	Beeps every 5 seconds when dog is running/Beeps once per second when dog is on point
3 Beeps (10 second)	Beeps every 10 seconds when dog is running/Beeps once per second when dog is on point

6. Release the button after the corresponding number of beeps matches your desired run mode.

STEP :: 09

PROGRAM THE SYSTEM FOR TWO-DOG OPERATION

SportDOG™ Collar Receivers/Remote Beepers can be set to respond to either the **up** or **down** toggle switch position. A SportDOG Add-A-Dog® Collar Receiver/Remote Beeper must be purchased to train/locate a second dog in two-dog mode. **Please refer to back cover for the compatible Add-A-Dog Collar Receiver/Remote Beeper for this system.**

1. Program the Remote Transmitter to modes 1 – 6 in either the Toggle Switch **up** or Toggle Switch **down** position (see pages 16-17).
2. Flip the toggle switch to the **up** position to program the first Collar Receiver/Remote Beeper.
 - A. Turn the Collar Receiver/Remote Beeper off.
 - B. Press and hold the On/Off Button for each. The Collar Receiver/Remote Beeper Indicator Lights will come on, then turn off in 4-5 seconds. If the On/Off Button is released too early, the Collar Receiver/Remote Beeper Indicator Lights will begin their normal flashing. If this occurs, start over from **A**.
 - C. After the Collar Receiver/Remote Beeper Indicator Lights have turned off, release the On/Off Button.
 - D. Press and hold the Upper Button on the Remote Transmitter until the Collar Receiver/Remote Beeper Indicator Lights flash 5 times. If the Collar Receiver/Remote Beeper Indicator Lights do not flash 5 times, start over from **A**.
3. Program the second Collar Receiver/Remote Beeper the same way using **A** through **D** above, but with the toggle switch in the **down** position.

TOGGLE SET TO UP FOR DOG
1 OR TOGGLE SET TO DOWN
FOR DOG 2



STEP :: 10

PROGRAM THE SYSTEM FOR THREE-DOG OPERATION

SportDOG™ Add-A-Dog® Collar Receivers/Remote Beepers must be purchased to train/locate additional dogs. **Please refer to back cover for the compatible Add-A-Dog Collar Receiver/Remote Beeper for this system.**

1. Program the Remote Transmitter to mode 5 in either the Toggle Switch **up** or the Toggle Switch **down** position (see pages 16-17).
2. Flip the toggle switch to the **up** position.
3. Program the first Collar Receiver/Remote Beeper:
 - A. Turn the Collar Receiver/Remote Beeper off.
 - B. Press and hold the On/Off Button for each. The Collar Receiver/Remote Beeper Indicator Lights will come on, then turn off in 4-5 seconds. If the On/Off Button is released too early, the Collar Receiver/Remote Beeper Indicator Lights will begin their normal flashing. If this occurs, start over from **A**.
 - C. After the Collar Receiver/Remote Beeper Indicator Lights have turned off, release the On/Off Button.
 - D. Press and hold the **Upper Button** on the Remote Transmitter until the Collar Receiver/Remote Beeper Indicator Lights flash 5 times. If the Collar Receiver/Remote Beeper Indicator Lights do not flash 5 times, start over from **A**.
4. Program the second Collar Receiver/Remote Beeper using **A** through **D** above, but using the **Lower Button** in place of the Upper Button.
5. Program the third Collar Receiver/Remote Beeper using **A** through **D** above, but using the **Left-Side Button** in place of the Upper Button.

CHANGE ID CODES

An ID Code is the signal identification between the Remote Transmitter and Collar Receiver. Each is programmed in 1 of 2,000 ID Codes from the factory. The UplandHunter® 1875 has the flexibility to program two or more Remote Transmitter's to the same ID Code allowing them to control one Collar Receiver. There are 64 programmable ID Codes available.

TO MANUALLY PROGRAM A REMOTE TRANSMITTER'S ID CODE FOLLOW THESE STEPS:

1. Turn the intensity dial to V/T, flip the toggle switch up, and then press and release the mode button on the back of your Remote Transmitter. This does not change the mode, so the current mode will still be active after the ID change is complete.
2. Once the mode button is released, the green indicator light will illuminate and stay on for 15 seconds.
3. While the green light is on, turn the intensity dial to select the 1st digit of the ID and then press and release the left-side button. The green light will flash rapidly confirming selection.
4. Again, while the green light is on, turn the intensity dial to select the 2nd digit of the ID and then press and release the left-side button. The green light will flash rapidly confirming selection. The 2nd digit is optional, and if not desired, just wait until the green light turns off and refrain from pressing the side button.
5. At the end of 15 seconds, or after the second press of the left-side button, the green light will turn off and the ID of the unit will be updated. At this point, the unit will be in the same mode it was in prior to setting the ID.
6. Upon changing the ID Code, you will need to match the Collar Receiver and Remote Beeper to the Remote Transmitter (see Step 7 on page 18).

NOTE: If you press the left-side button only once (skipping Step 4) the ID is still a two digit ID. The left digit is defaulted to 1. For example, if you selected 6 in Step 3 and pressed the button only once, the ID you get will be 16.

TO RETURN THE UNIT TO THE FACTORY ID FOLLOW THESE STEPS:

1. Turn the intensity dial to V/T, flip the toggle switch up, and then press and release the mode button on the back of your Remote Transmitter. This does not change the mode, so the current mode will still be active after the ID change is complete.
2. Do not press any buttons and wait until the green indicator light turns off.
3. You will now need to match the Collar Receiver and Remote Beeper to the Remote Transmitter (see Step 7 on page 18).

ACCESSORIES

To purchase additional accessories for your SportDOG Brand® UplandHunter® 1875, contact the Customer Care Center at 1-800-732-0144 or visit our website at www.sportdog.com to locate a retailer near you.

Component	Part Number
¾" Grey Collar Strap	SAC00-13864
¾" Blaze Orange Collar Strap	SAC00-10815
¾" Black Collar Strap	SAC00-10816
Remote Transmitter Only	SDT00-13819
Remote Transmitter Accessory Kit (includes belt clip, lanyard, antenna)	SDT00-13836
Remote Beeper (does not include collar strap)	SDT00-13820
Collar Receiver (does not include collar strap)	SDT00-13821
SD-1875 Charging Cradle	SAC00-13862
Adaptor	SDT00-12272
Charging Cable (Remote Beeper)	SAC00-13822
Antenna	SAC00-13824
Contact Points (Short)	SAC00-12571
Contact Points (Long)	SAC00-12570
Battery Kit (Collar Receiver)	SAC00-12544
Battery Kit (Remote Transmitter)	SAC00-12542
Battery Kit (Remote Beeper)	SAC00-13794
SD-1875 Accessory Kit (includes belt clip, lanyard, power plug covers for Remote Transmitter and Remote Beeper, rubber band for Remote Beeper)	SAC00-13823

FREQUENTLY ASKED QUESTIONS

Is the stimulation safe for my dog?	While Continuous and/or Momentary stimulation may be unpleasant, it is harmless to your dog. Electronic training devices require interaction and training from the owner to achieve desired results.
How old does a dog have to be before using the UplandHunter® 1875?	Your dog should be able to learn basic obedience commands such as "Sit" or "Stay." The Collar Receiver may be too large for dogs under 8 pounds.
Once my dog is trained and has been obeying my commands, will my dog have to continue to wear the Collar Receiver?	Your dog may need to wear the Collar Receiver from time to time for reinforcement. Also, many hunters keep the Collar Receiver on their dogs while hunting for maximum control.
Is the Collar Receiver waterproof?	Yes. If the rechargeable battery pack ever needs to be replaced, make sure the o-ring and o-ring groove are free from dirt and debris.
Can my Collar Receiver be used around salt water?	If the Collar Receiver is used in or around salt water, the Collar Receiver should be rinsed with fresh water following each use.
Can I use the UplandHunter 1875 with more than one dog?	Yes, the UplandHunter 1875 is expandable to a maximum of 3 dogs. SportDOG™ Add-A-Dog® Collar Receivers must be purchased. Please refer to back cover for a list of compatible Collar Receivers.
Can I use the UplandHunter 1875 on aggressive dogs?	We do not recommend any of our products to be used on aggressive dogs. We recommend you contact your local veterinarian or professional trainer to determine if your dog might be aggressive.
Will I get exactly one mile of range with the UplandHunter 1875?	The range you get with your UplandHunter 1875 will vary according to terrain, weather, vegetation, as well as, transmission from other radio devices. To get the maximum amount of range, please refer to "How the System Works" section of this guide.
How long can I continuously deliver stimulation to my dog?	The maximum amount of time you can press the Continuous Stimulation Button and deliver stimulation to your dog continuously is 10 seconds. After 10 seconds, the Remote Transmitter will "time-out," and the Continuous Stimulation Button must be released and pressed again.
What do I do if my dog's neck becomes red and irritated?	This condition is due to the Contact Points irritating the skin. Discontinue use of the Collar Receiver for a few days. If the condition persists beyond 48 hours, see your veterinarian. Once the skin returns to normal, resume use, and monitor the skin condition closely.
The Intensity Dial seems difficult to rotate. Is this normal?	Yes. This prevents accidental changes in intensity and encourages an optimal waterproof seal. The knob will "break in" and be slightly easier to turn as you use it.
Can I attach a leash to the UplandHunter 1875?	DO NOT attach a leash to the UplandHunter 1875. You may put a separate non-metallic collar on your dog's neck and attach a leash. Be sure the extra collar does not interfere with the Contact Points.
Can I program my UplandHunter 1875 to work with my other SportDOG Brand® systems?	The UplandHunter 1875 will work with SD-1825, SD-1825CAMO and SD-2525 systems.

Can I use the Remote Beeper by itself?	Yes, the Remote Beeper can be used independently without the Collar Receiver. However, it is recommended to have a counter weight, like the Collar Receiver, in order to keep the Remote Beeper on top of the dog's neck.
How do I get back into Run Mode if I have pressed the Locate Button on my Remote Transmitter?	Simply press the Remote Transmitter's Run Mode button. The Remote Beeper will continue operating in the last mode in which it was set.
My Remote Transmitter is sending a signal to more than one Collar Receiver unintentionally, what should I do?	In the rare event this occurs, you can change your Remote Transmitter's ID Code (see Change ID Codes on page 21) to solve this.

TROUBLESHOOTING

The answers to these questions should help you solve any problem you have with this system. If they do not, please contact the Customer Care Center at 1-800-732-0144 or visit our website at www.sportdog.com.

<p>My dog is not responding when I press a button.</p>	<ul style="list-style-type: none"> • Check to see if the Remote Beeper has been turned on and the Indicator Light is flashing. • If your range has reduced from the first time you have used it, please check to see if the battery is low in either the Remote Beeper, Remote Transmitter or Collar Receiver. • Many factors can impact the range you have with the UplandHunter® 1875. For a list of these factors, please refer to "How the System Works". • You can verify the Collar Receiver is delivering stimulation to your dog by placing the test light, enclosed in your kit, on the Collar Receiver. Please refer to the "Test Light Instructions" section for details. • Increase the Intensity Dial. Refer to "Find the Best Intensity Level for Your Dog" for more information. • Increase the Stimulation Range. Refer to "Change Stimulation Ranges" for more information. • Make sure the Collar Receiver's Contact Points are placed snugly against your dog's skin. Refer to "Fit the UplandHunter 1875" for more information. • You may need to switch to the longer Contact Points included with your system or trim the hair beneath the Contact Points. • If you notice your operating time is significantly reduced from the original time, your Collar Receiver or Remote Beeper battery needs to be replaced. Contact the Customer Care Center to purchase a new one.
<p>The Collar Receiver will not turn on.</p>	<ul style="list-style-type: none"> • Make sure the Collar Receiver has been charged. The Collar Receiver will charge in 2 hours.
<p>The Collar Receiver is not responding to the Remote Transmitter.</p>	<ul style="list-style-type: none"> • Verify the Collar Receiver has been turned on and the Indicator Light is flashing. Refer to "Turning the Collar Receiver On and Off". • Refer to "Match the Collar Receiver."
<p>My Remote Beeper does not beep when the dog is moving or when he is on point.</p>	<ul style="list-style-type: none"> • Check to see if the Remote Beeper has been turned on and the Indicator Light is flashing. • If the Locate button was pressed, then this will disable Remote Beeper's Run Mode. • To enable the Remote Beeper's Run Mode, press the Remote Transmitter's Run Mode button. The Remote Beeper will emit 3 beeps to confirm run mode has been reactivated.
<p>The Remote Beeper is not responding to the Remote Transmitter.</p>	<ul style="list-style-type: none"> • Verify the Remote Beeper has been turned on and the Indicator Light is flashing. Refer to "Turning the Remote Beeper On and Off". • Refer to "Match the Remote Beeper."

My Remote Beeper cannot be reset.

- Verify the Remote Beeper has been turned on and the Indicator Light is flashing. Refer to "Turning the Remote Beeper On and Off".
- Refer to "Match the Remote Beeper."
Note: Only the Locate button can program/reset the Remote Beeper.

TEST LIGHT INSTRUCTIONS

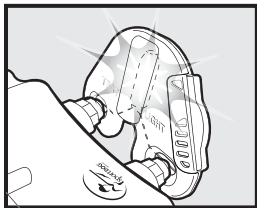

1. Turn the Collar Receiver on.
2. Hold the Test Light Contacts to the Contact Points.
3. Press a Stimulation Button on the Remote Transmitter.
4. The Test Light will flash.
NOTE: At higher Stimulation Levels, the Test Light will flash brighter.
5. Turn the Collar Receiver off.

Save the Test Light for future testing.

NOTE: If the Test Light does not flash, recharge the battery and re-test. If the Test Light still does not flash, contact the Customer Care Center at 1-800-732-0144.

TERMS OF USE AND LIMITATION OF LIABILITY

1. TERMS OF USE

This Product is offered to you conditioned upon your acceptance without modification of the terms, conditions and notices contained herein. Usage of this Product implies acceptance of all such terms, conditions, and notices.

2. PROPER USE

This Product is designed for use with dogs where tracking/training is desired. The specific temperament of your dog may not work with this Product. We recommend that you not use this Product if your dog is less than 8 pounds or if your dog is aggressive. If you are unsure whether this is appropriate for your dog, please consult your veterinarian, certified trainer or contact our Customer Care Center at 1-800-732-0144.

Proper use includes reviewing the entire Operating and Training Guide provided with your Product and any specific Caution statements.

3. NO UNLAWFUL OR PROHIBITED USE

This Product is designed for use with dogs only. This dog training device is not intended to harm, injure, or provoke. Using this Product in a way that is not intended could result in violation of Federal, State or local laws.

4. LIMITATION OF LIABILITY

In no event shall Radio Systems® Corporation be liable for any direct, indirect, punitive, incidental, special or consequential damages, or any damages whatsoever arising out of or connected with the use or misuse of this Product. Buyer assumes all risks and liability from the use of this Product.

5. MODIFICATION OF TERMS AND CONDITIONS

Radio Systems Corporation reserves the right to change the terms, conditions and notices under which this Product is offered.

FCC COMPLIANCE

This device complies with part 15 of the FCC Rules. Operation is subject to the following two conditions: (1) This device may not cause harmful interference, and (2) this device must accept any interference received, including interference that may cause undesired operation.

This equipment has been tested and found to comply with the limits for a Class B digital device, pursuant to part 15 of the FCC Rules. These limits are designed to provide reasonable protection against harmful interference in a residential installation. This equipment generates, uses and can radiate radio frequency energy and, if not installed and used in accordance with the instructions, may cause harmful interference to radio communications. However, there is no guarantee that interference will not occur in a specific installation. If interference does occur to radio or television reception, which can be determined by turning the equipment off and on, the user is encouraged to try to correct the interference by one or more of the following measures:

- Reorient or relocate the receiving antenna.
- Increase the separation between the equipment and the receiver.
- Connect the equipment to an outlet on a circuit different from that to which the receiver is connected.
- Contact customer service or an experienced radio/TV technician for assistance.

Caution: Unauthorized changes or modifications to the equipment may violate FCC regulations and could void the user's authority to operate the equipment.

IC - CANADA

This device complies with Industry Canada licence-exempt RSS standard(s). Operation is subject to the following two conditions: (1) this device may not cause interference, and (2) this device must accept any interference, including interference that may cause undesired operation of the device.

Le présent appareil est conforme aux CNR d'Industrie Canada applicables aux appareils radio exempts de licence. L'exploitation est autorisée aux deux conditions suivantes : (1) l'appareil ne doit pas produire de brouillage, et (2) l'utilisateur de l'appareil doit accepter tout brouillage radioélectrique subi, même si le brouillage est susceptible d'en compromettre le fonctionnement.

Customer Care Center / Service clientèle

800-732-2677

Monday - Friday / Lundi - Vendredi

8 am - 8 pm / 8h00 - 20h00

Saturday / Samedi

9 am - 5 pm / 9h00 - 17h00



BATTERY DISPOSAL

⚠ WARNING See important safety information on page 2 related to the battery.

This system operates on three Li-Ion battery packs (240mAh capacity for the Collar Receiver, 550mAh capacity for the Remote Transmitter and 400mAh for the Remote Beeper). Only replace with battery received from calling the Customer Care Center at 1-800-732-0144.

Separate collection of spent batteries is required in many regions; check the regulations in your area before discarding spent batteries. Please see below for instructions on how to remove the battery from the product for separate disposal. If you wish to ship us your spent batteries for disposal, contact the Customer Care Center.

AT END OF PRODUCT LIFE, USE THESE BATTERY REMOVAL INSTRUCTIONS FOR FINAL DISPOSAL (DO NOT OPEN THE COLLAR RECEIVER, REMOTE BEEPER OR REMOTE TRANSMITTER UNTIL YOU HAVE RECEIVED THE REPLACEMENT):

- Using a #1 Phillips screwdriver for your Remote Beeper/Remote Transmitter and/or a 3/32 Allen wrench for your Collar Receiver, remove the case screws.
- Remove the case back or cover.
- Remove the old battery pack. *NOTE: When removing the old battery pack, care must be taken when gripping the connector firmly to avoid damaging the wires. Shorting the battery wires may cause fire or explosion.*

NOTE: These instructions are not valid for repair or battery replacement. Replacing the battery with a battery not specifically approved by Radio Systems® Corporation may cause fire or explosion. Please call the Customer Care Center at 1-800-732-0144 to avoid invalidating your warranty.

This product is protected by the following patents:

U.S. Patent Numbers: 6,901,883; 7,017,524; 7,420,136; D573,764; 6,184,790; 6,459,378; 7,814,865; 7,647,545.



**GEAR THE WAY
YOU'D DESIGN IT®**

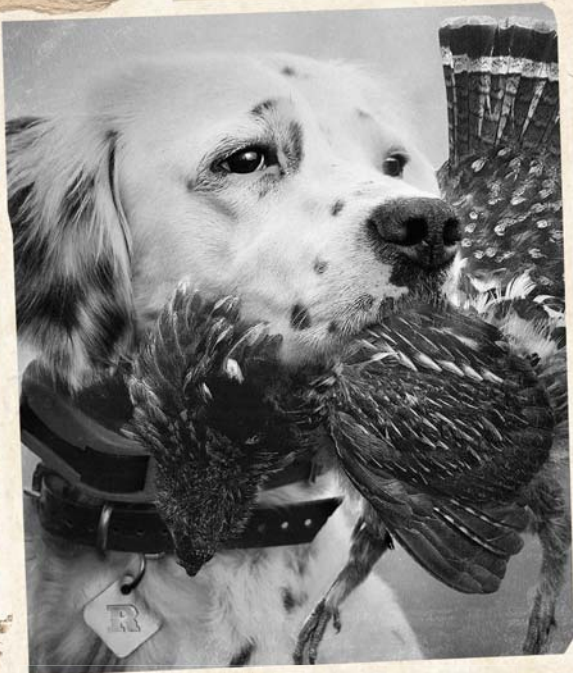

SPORTDOG.COM

SPORTDOG / ADD-A-DOG®

Collar Receiver/Remote Beeper



UPLANDHUNTER®
SD::BEEP REMOTE BEEPER

UPLANDHUNTER®
SDR::AB ADD-A-DOG®



NOTE: SDR-FS, SDR-FH, SDR, SDR-CH, SDR-FC, SDR-BEEP AND SDR-H ADD-A-DOG COLLARS ARE NOT COMPATIBLE WITH THIS SYSTEM.
SDR-A, SDR-AW AND SDR-AH ADD-A-DOG COLLARS ARE COMPATIBLE WITH THIS SYSTEM.

©2012 RADIO SYSTEMS CORPORATION

Radio Systems® Corporation • 10427 PetSafe Way • Knoxville, TN 37932 • 1-800-732-0144
J400-1270