

Step 1. Leg Installation

Place back panel good side down on a clean surface.

Align the pins in the legs with the pre-drilled holes in the back and lower into place. Tighten the connectors clockwise with a #2 Phillips screw driver.

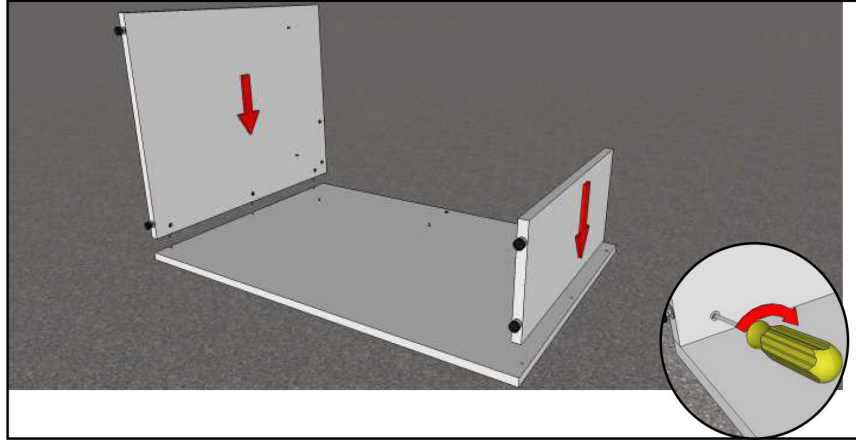

Step 2. Desk Top installation

Bring the leg and back assembly to the upright position. Lower top into place and tighten the connectors clockwise with a #2 Phillips screw driver.

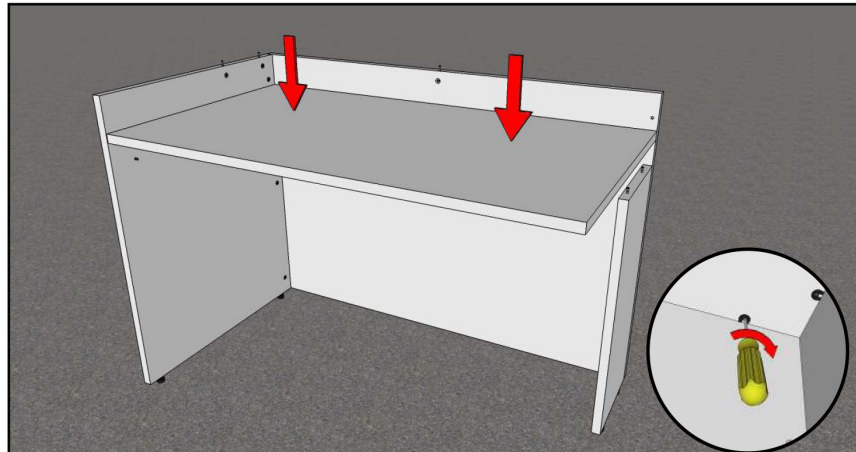

Step 3. Upright installation

Align the pins in the upright with the pre-drilled holes in the back and slide into position. Tighten the connectors clockwise with a #2 Phillips screw driver.

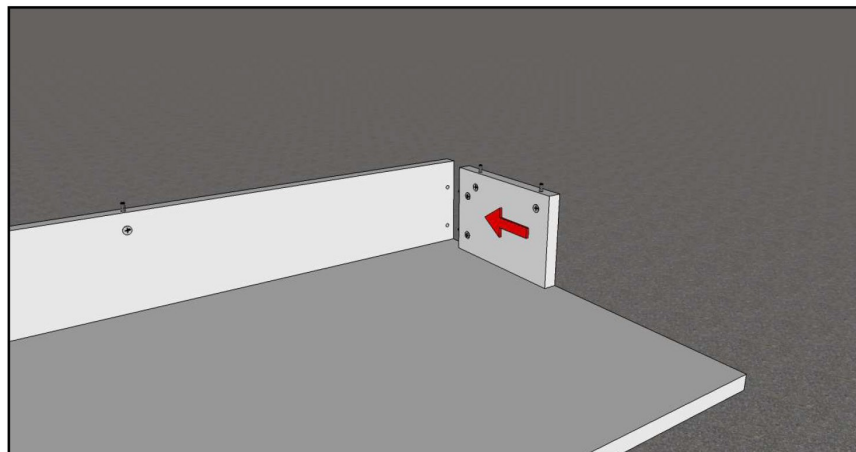
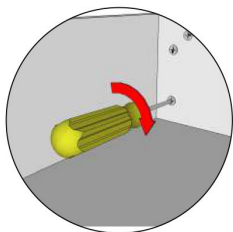

Step 4. Reception Top installation

Lower top into place and tighten the connectors clockwise with a #2 Phillips screw driver.

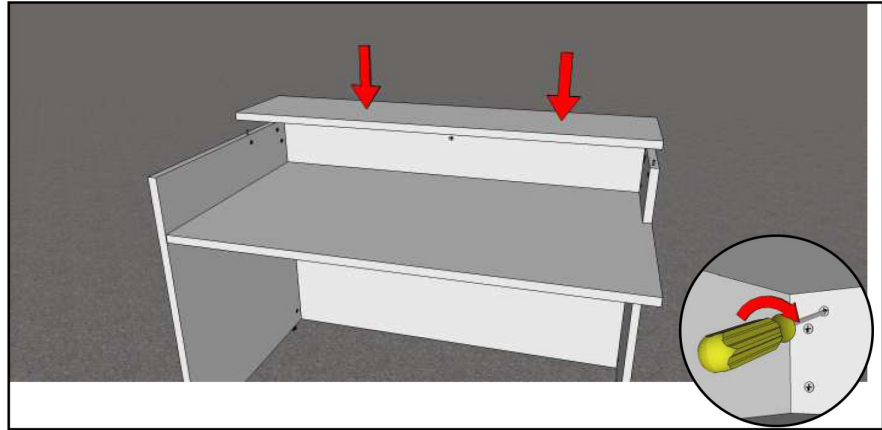

Step 1. Upright Installation

Place back panel good side down on a clean surface.

Align the pins in the uprights with the pre-drilled holes in the back and lower into place. Tighten all the connectors clockwise with a #2 Phillips screw driver.

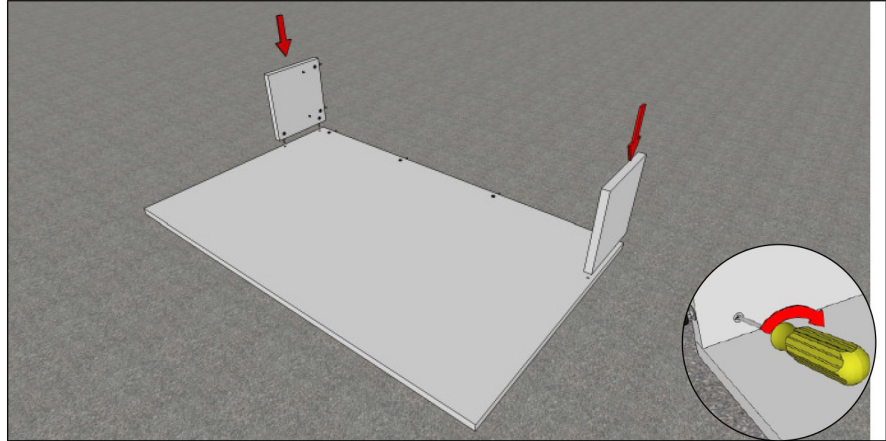
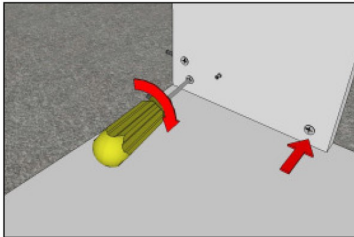

Step 2. Top installation

Align the top with the upright and back assembly and slide into place. Tighten all connectors clockwise with a #2 Phillips screw driver.

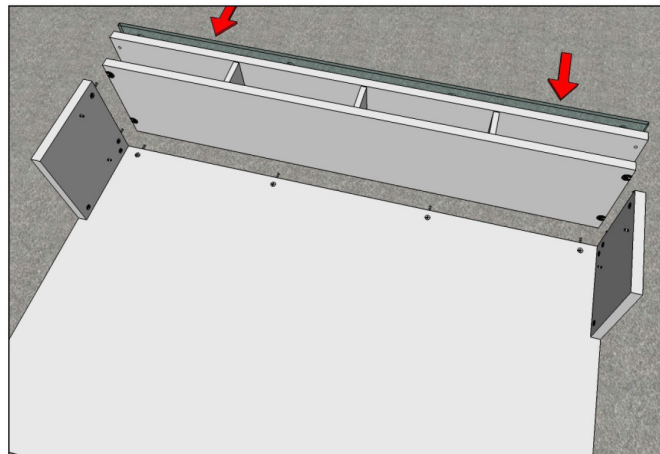
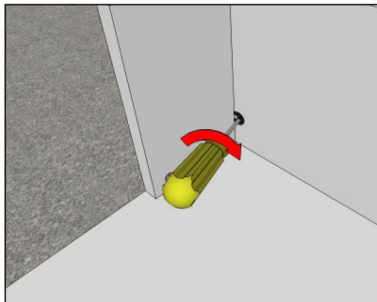

Step 3. Cap to desk assembly

Place the spacer blocks on edge against the desk. Carefully lower the reception cap onto the desk surface. Align the holes in the modesty and fasten with the bolts provided.

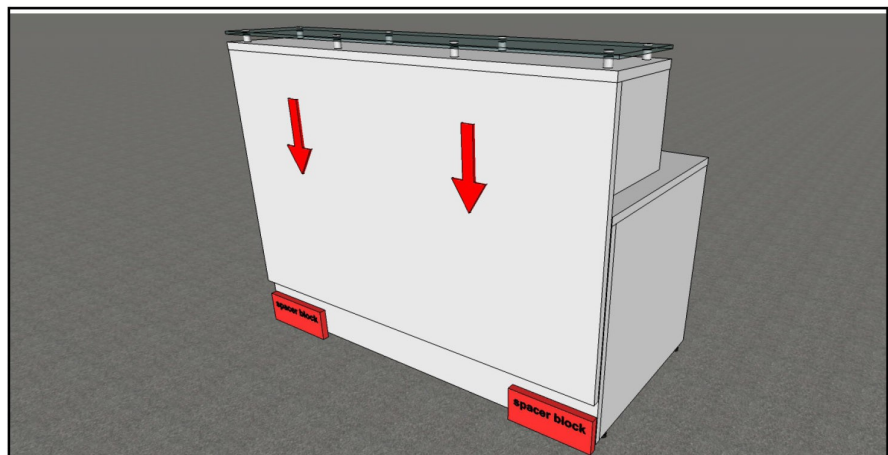
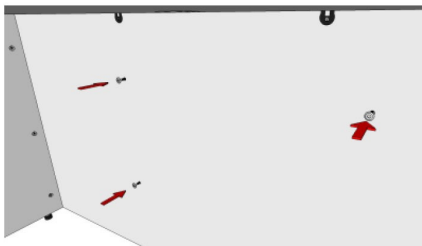

Level desk

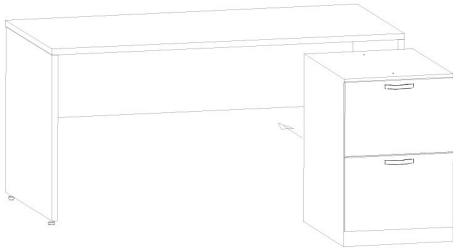

Step 1: Slide pedestal under desk until drawer fronts are flush with desk legs.

Step 2: Access levelers through holes in pedestal bottom. Use supplied Allen key to adjust levelers until pedestal top is tight to bottom of desk top. See below for instructions on removing drawers.

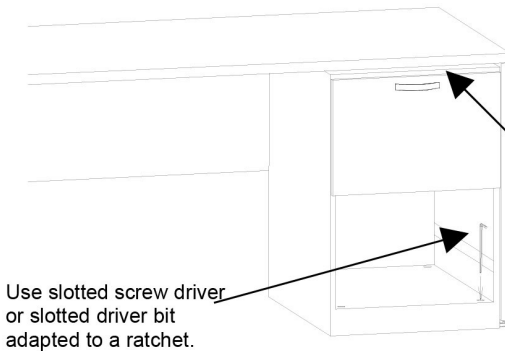

Drawer front flush with desk leg.

Adjust levelers to remove gap between pedestal top and desk.

Use slotted screw driver or slotted driver bit adapted to a ratchet.

Step 3: Remove upper drawers as necessary and install supplied #8 x 1 1/4" pan head screws (holes are pre drilled in pedestal top) to secure pedestal to desk.

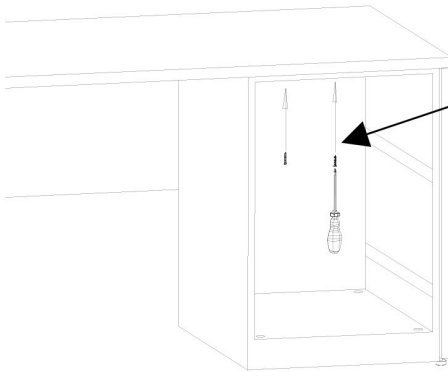

Step 4: Re-install drawers in their original location.

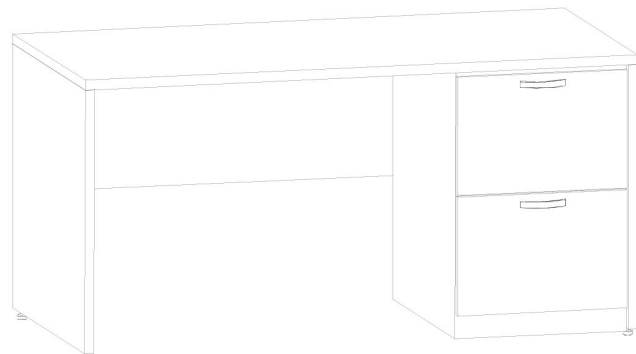

*To remove drawers, fully extend the drawer.

The slide lock lever is located **in** the slide track attached to the drawer sides. Depending on the drawer size this lever is located either at the back or near the middle of the fully extended slide (one on each side). Once you have located the slide lock levers, simultaneously push the right side lever down and the left side lever up and pull the drawer out. To re-install, push in any part of the slide mechanism that extends past the cabinet, align the slide tracks on the drawer sides with the tracks in the cabinet and push the drawer to its fully closed position to automatically lock the slides.

