

Y12699 & Y12700 - Plastic Shell 4-Leg Stacking Chair & Stool Assembly Instructions

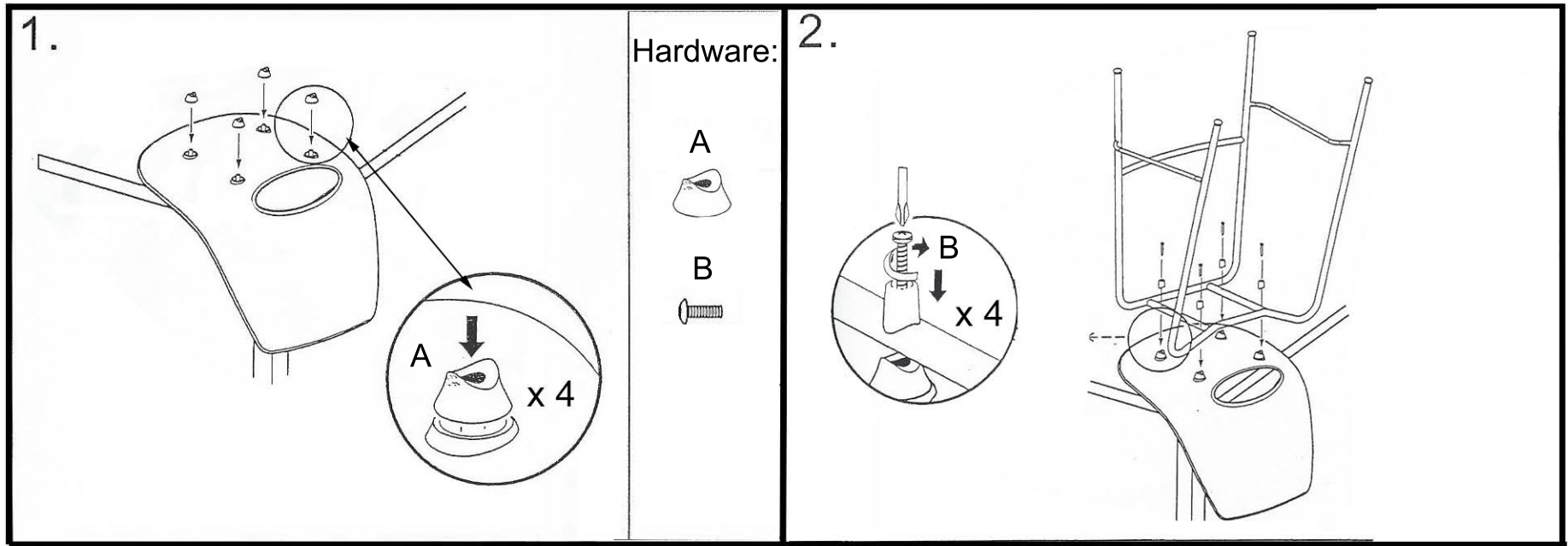

Tools Needed: Phillips Screwdriver

Chair & Stool assemble with the same steps below:

- 1.) Rest the shell upside down on a table for support during assembly. Insert the 4 (A) Spacers as shown.
- 2.) Line up the metal chair/stool frame and attach using 4 (B) screws.

Questions? Please call 1-800-443-5117.

Customer Service available 8:30 - 5:00 Central Time, Monday - Friday