

Modular Boat Shaped Table Assembly Instructions

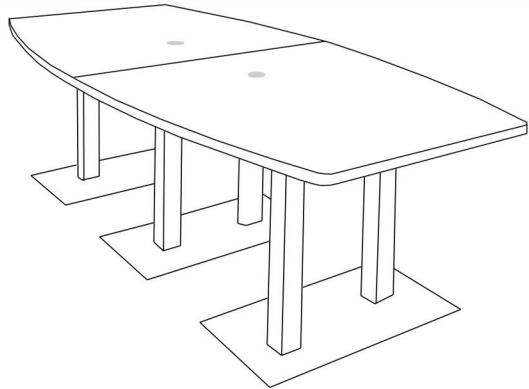

Step 1) Assembling The Bases. Start by attaching the A Plates to the B Columns. Then, turn that assembly upside down to attach the C bases. This will help align the holes easier. Finally, once the bases are fully assembled, carefully turn them over so that C bases are on the ground.

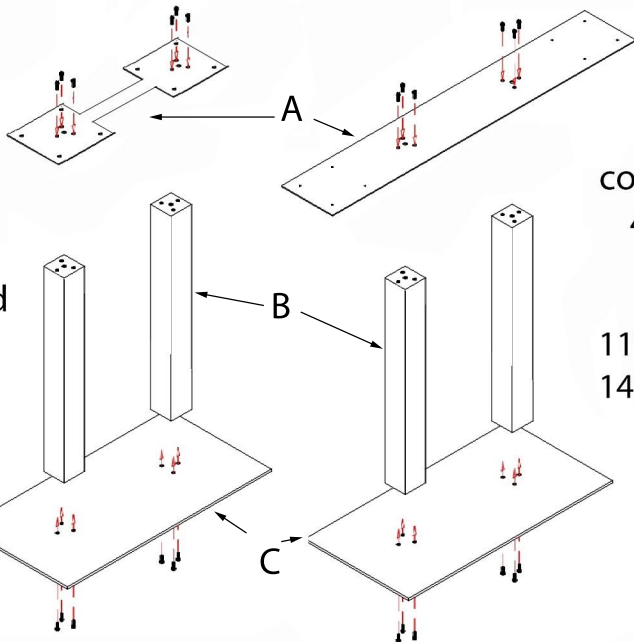
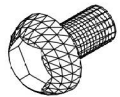

Use 4' Plate for base(s) connecting two 4' wide tops

8' - Qty 1
11' & 12' - Qty 2
14' & 16' - Qty 3
20' - Qty 4

Boat-Shaped Table End Bases Qty 2

Step 2: Arrange Assembled Bases. With a helper, set the tops on the bases to line up the holes on the tops to the bases. Assemble right side up (shown upside down for reference only)

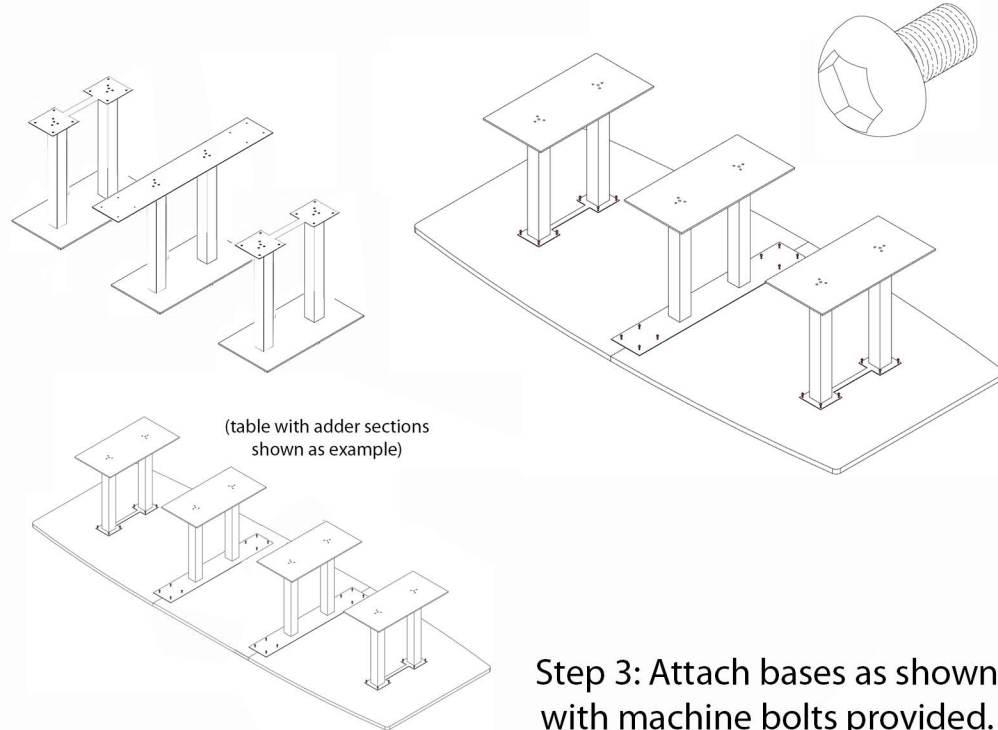

Step 3: Attach bases as shown with machine bolts provided.

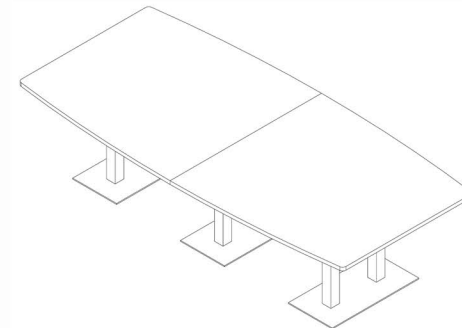

Questions? Please call 1-800-443-5117.
Customer Service available 8:30 - 5:00 Central Time, Monday - Friday