

INSTRUCTION MANUAL

MODEL #PD10088

MODEL #PW10088

**10 GALLON HEPA
VACUUM**



-----WARNING-----

All Nikro Industries Inc. products that have rated efficiencies of 99.97% @ 0.3 microns and 99.99% @ 0.3 microns, have H.E.P.A. filters that have been individually tested to meet these minimum efficiencies.

Although all the filters have been pre-tested, the possibility of leaks or filter failure due to handling, transportation, punctures, loaded filters, moisture, wear and tear, etc., does exist.

Therefore, when using this equipment in highly sensitive areas or where any release of particles above and beyond the minimum efficiencies would be detrimental and harmful to humans, plants or property; it is strongly recommended that the units be individually tested prior to their use.

This is to assure that they are maintaining the efficiency levels, which they were designed to filter out.

**FAILURE TO DO SO COULD RESULT IN SERIOUS HARM TO HUMAN LIFE, PLANT LIFE
AND/OR PROPERTY.**

OPERATING INSTRUCTIONS

Inspection

Thoroughly inspect your machine for any shipping damage. Your machine has already been thoroughly tested at the Nikro Industries manufacturing plant prior to shipping.

Electrical Specification

This machine is designed to operate on a 15 amp. 115V., 60 hz., AC circuit. A deviance of this could cause serious damage to the unit.

Grounding Instructions

This machine is equipped with a grounding type cord and three prong plug. Make sure that the plug is connected to an outlet with three receptacles designed for use with the three prong plug. (See Illustration) Never use an adapter with machine.

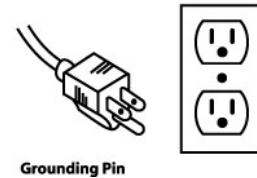

Maintenance

Lubrication of this motor is not required as it is equipped with sealed bearings.

Always keep the air cooling intake screen free, not allowing any restriction of airflow. Airflow restriction will overheat and damage the motor.

To prolong the life of the H.E.P.A. filter, empty, clean, and replace bags and filters regularly as described in the following sections.

SAFETY INSTRUCTIONS

Read all safety instructions before using!

1. Electrical shock could occur if used outdoors or on wet surfaces.
2. Always store machine indoors in a dry area. If machine is dropped in water or left in rain, it should be serviced by an authorized service technician prior to plugging the unit in.
3. Prior to plugging in machine, always inspect cord for cuts and exposed wires. If these problems are found, return the machine to an authorized service technician..
4. Never use the cord as a handle, or pull the machine by using the cord.
5. Never unplug this machine or any other electrical appliance by pulling on the cord.
6. Do not wrap the cord around the dome. Wrapping the cord around the dome will restrict the motor from exhausting properly and will result in overheating and damaging the motor.
7. Keep hair, fingers, and other objects away from all moving parts and openings on this machine.
8. This vacuum cleaner should never be used in explosion-hazardous areas or to pick up combustible or flammable liquids such as gasoline, etc.
9. Never leave the machine unattended when plugged in or running.
10. Always have the switch in the OFF position before unplugging the unit.
11. Do not operate this machine with any of the openings blocked; always keep these areas free of lint and dust or any other particles that could reduce the airflow.
12. Never operate or plug in this machine or any other electrical appliance with wet hands or when standing in water.
13. This machine should never be operated without the proper filters installed in the manner described in the following pages of this manual.
14. This machine should never be serviced by anyone other than an authorized technician.
15. Use only original NIKRO replacement parts and attachments.

TANK AND FILTER PREPARATION

1. Place the paper collection bag into the bottom of the tank. Pull the cardboard / rubber collar over the down tube, pulling it just above the rib on the down tube. Then gently pull apart the accordion-like pleats so that the bag is open. .
2. Open the filter protector bag and push it down into the tank. Take the elastic band and pull it over the top of the tank. The elastic band should rest on the outside of the tank below the rim.
3. Make sure the impaction prefilter is in proper placement (See instructions on changing impaction prefilter in the following sections.)
4. Take the non-clinging dacron bag and pull the elastic band up over the filter protector cage and the HEPA filter, and let the elastic band rest securely on the motor port of the lid assembly, above the HEPA filter flange. (See illustration)
5. Place the lid assembly onto the tank and snap the latches into place.

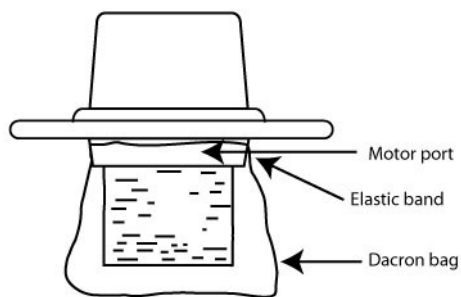

FILTER MAINTENANCE AND REPLACEMENT INSTRUCTIONS

Warning: When a loss of vacuum power is detected, the vacuum should be turned off immediately. Continued use of the machine could result in severe damage to the motor and/or HEPA filter. This loss of vacuum power could be caused by one of the following:

- A. The paper collection bag may be full and needs to be replaced.
- B. The tank may be full and needs to be emptied.
- C. The wand, hose, or down tube may be clogged and needs to be cleared.
- D. The impaction prefilter may be clogged and needs to be replaced. (Never try to clean the impaction prefilter, it should be discarded.) See section on changing the impaction prefilter.
- E. The Dacron bag may be clogged and needs to be cleaned or replaced.
- F. The HEPA filter may be clogged and needs to be replaced.

To prolong the life of the HEPA filter and motor, the paper collection bag should be changed when it is 1/2 full. The filter protector and impaction prefilter should be changed at least every other time that the collection bag is changed.

PROCEDURES FOR REMOVING CONTAMINATED FILTERS .

Caution:

When removing contaminated filters or using this machine, you should always wear gloves, clothing and a respirator approved for the particular contaminant which you are working with.

FILTER REMOVAL PROCEDURES

1. Turn off and unplug machine
2. Slowly and carefully lift one side of the lid assembly from the tank. Holding the lid with one hand, reach under the lid and gently tap all around the dacron filter bag, allowing any loose dust particles to drop into the tank.
3. Carefully lift the lid assembly off the tank. With a damp rag, wipe underside of the lid assembly. Set it aside and dispose of rag properly. (Never set the lid assembly down on the HEPA filter).
4. Remove the impaction prefilter. (Refer to the following section "Procedure on changing the impaction filter").
5. Carefully pull the paper filter protector bag over the rim of the tank and push it down into the tank.

Caution: Be careful not to create any airborne dust by snapping the elastic bag

6. Take the collar of the paper collection bag and carefully slide it down and off the down tube and remove the collection bag from the tank.
7. Take a damp rag and wipe down the inside of the tank. Dispose of contaminated rag properly.
8. All hazardous waste must be disposed of properly. Never put contaminated debris in a regular trash container. All debris must be placed in a bag or container labeled "Hazardous Materials", and should be removed by a licensed waste hauler.

CONSULT PROPER AUTHORITIES FOR REGULATIONS REGARDING DISPOSAL

PROCEDURE ON CHANGING THE IMPACTION FILTER

1. The precautionary steps described in this manual should be used when changing the impaction prefilter.
2. The impaction prefilter should be changed when any of the following occur.
 - A. Whenever a tear is found in any of the filters preceding the impaction filter.
 - B. At least every other time the collection bag is changed.
3. To change the impaction prefilter, follow the first three procedures in the section on "Filter Removal Procedures" and then proceed.
4. Carefully slide the non-clinging dacron bag off the HEPA filter and set aside.
5. Remove the impaction prefilter from the HEPA filter. (Never use any type of tool or object to remove this filter, to insure that you do not puncture the HEPA filter). This filter cannot be cleaned or reused and should be disposed of properly.

PROCEDURE FOR CHANGING THE HEPA FILTER

- (1) The precautionary steps described in this manual should be used when changing the HEPA filter.
- (2) NOTE: You must follow Local and or Federal guide lines when working with contaminated filters.
- (3) Remove the eight (8) bolts holding the HEPA filter to the filter mounting plate, using a Phillips screw driver and a 11/32" wrench.
- (4) Carefully remove the HEPA filter from the filter mounting plate, being careful not to create any airborne dust.
- (5) This filter cannot be cleaned, and should be disposed of in an appropriate manner.
- (6) Re-install the new HEPA filter using #8 screws, nuts, lock washers, and flat washers.
- (7) Replace the impaction filter, on the HEPA filter.
- (8) Re-connect the filter protector cage.

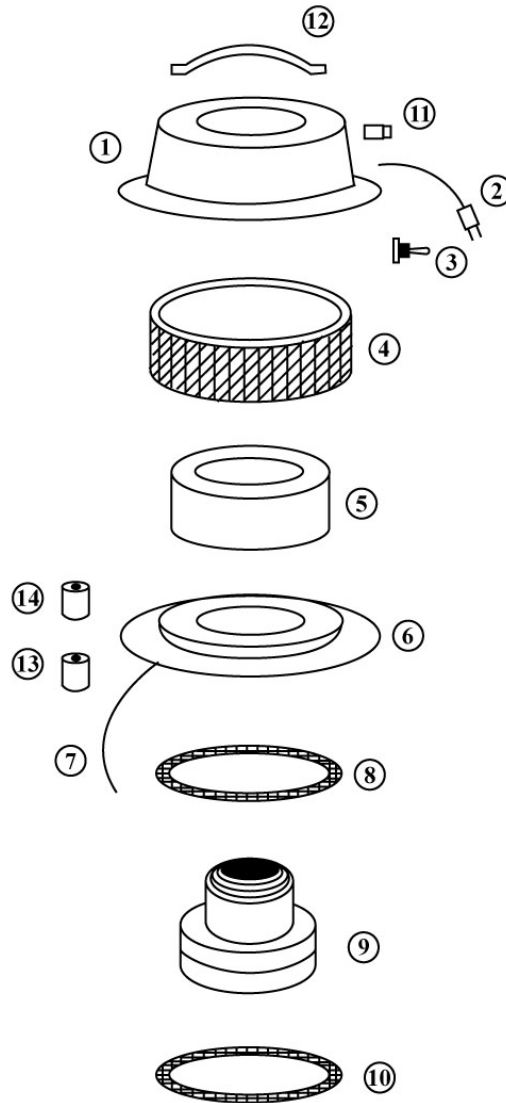

REFERENCE	PART NO.	DESCRIPTION	QTY. REQ.
1	520001	MOTOR DOME	1
2	520010	POWER CORD	1
3	520015	TOGGLE SWITCH	1
4	520004	DOME FELT	1
5	520016	FOAM RING	1
6	520002	MOTOR HOLD DOWN	1
7	520323	GROUND WIRE ASSEMBLY	1
8	520329	UPPER MOTOR GASKET	1
9	861313	MOTOR	1
10	520327	LOWER MOTOR GASKET	1
11	520013	STRAIN RELIEF	1
12	520222	DOME HANDLE	1
13	520215	SMALL SPACER	4
14	520214	LARGE SPACER	4

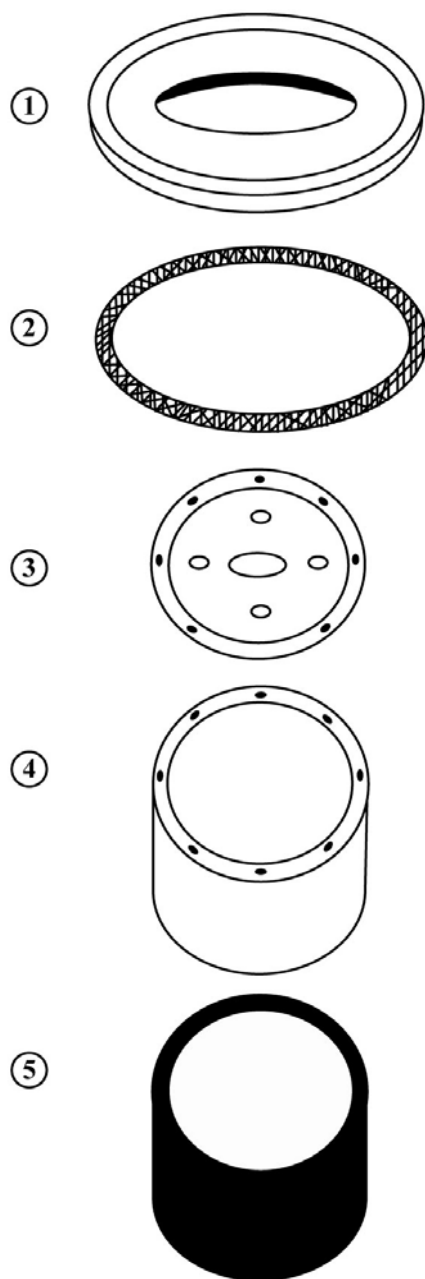

REFERENCE	PART NO.	DESCRIPTION	QTY. REQ.
1	520302	LID (ONLY)	1
2	520018	LID GASKET	1
3	520009	FILTER MOUNTING PLATE	1
4	861969	HEPA FILTER	1
5	862006P	IMPACTION FILTER	1

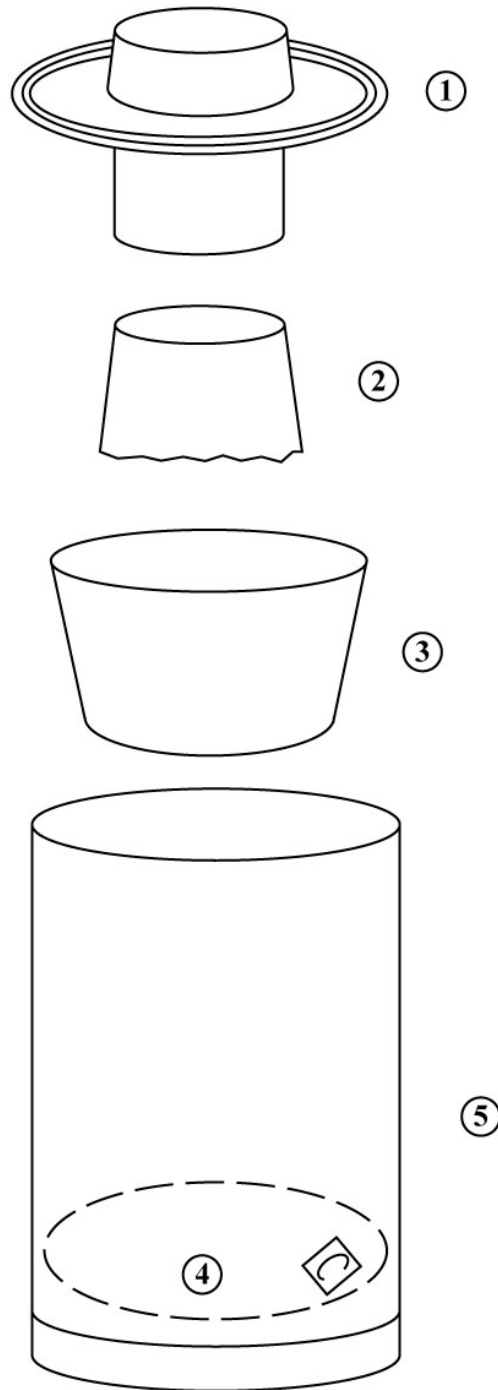

REFERENCE	PART NO.	DESCRIPTION	QTY. REQ.
1	520026	MOTOR AND LID ASSY.	1
2	520037	DACRON FILTER BAG	1
3	520035P	FILTER PROTECTOR	1
4	520033P	COLLECTION BAG	1
5	861127	10 GALLON POLY TANK	1

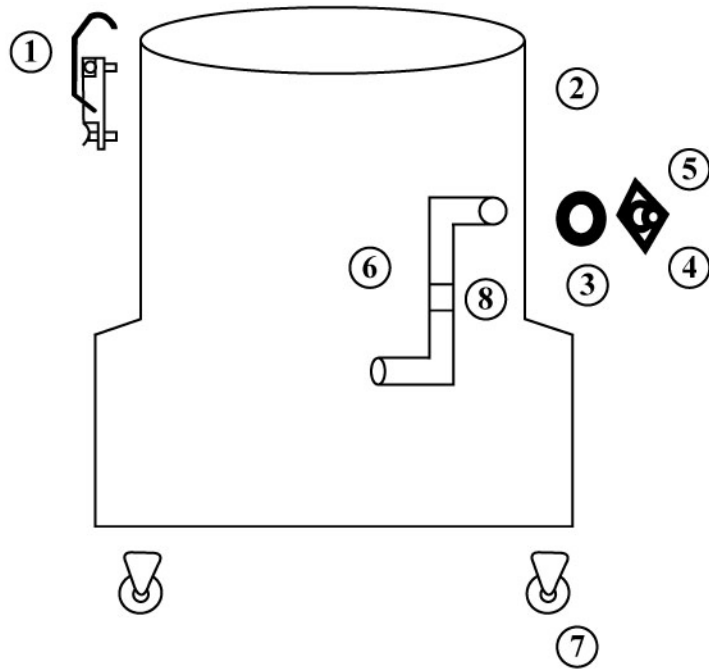

REFERENCE	PART NO.	DESCRIPTION	QTY. REQ.
1	860803	LID LATCH	2
2	861127	10 GALLON POLY TANK	1
3	520216	INTAKE GASKET	1
4	520220	INTAKE	1
5	520217	INTAKE KNOB	1
6	540001	DOWN TUBE ELBOW	1
7	861128	CASTER	4
8	860468	DOWN TUBE COUPLER	1
	861101	DOWN TUBE ASSY. COMPLETE	1

**WET PICK UP CONVERSION KIT -#861160 (STAINLESS STEEL)
#861119 (PAINTED)**

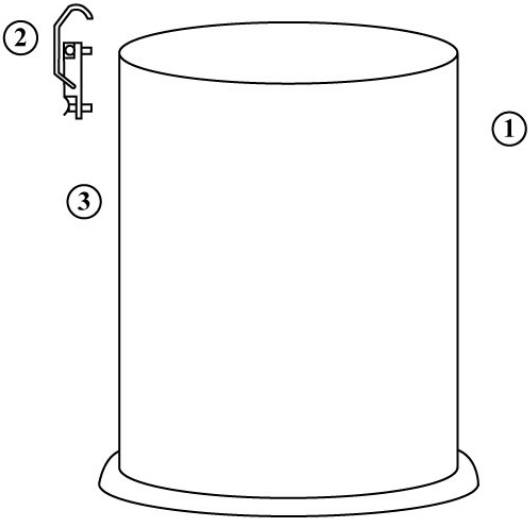

INCLUDES THE FOLLOWING:

REF.	PART NO.	DESCRIPTION	QTY. REQ.
1	861129	WATER PICK UP ADAPTOR (PTD)	1
1A	520223	WATER PICK UP ADAPTOR (S.S.)	1
2	860803	LID LATCH	2
3	520214	LATCH SPACER	4
4	860174	GASKET	1
5	520370	WATER SHUT OFF PLATE	1
6	520309	FLOAT CAGE	1
7	520310	FLOAT	1
8		VACUUM TANK	

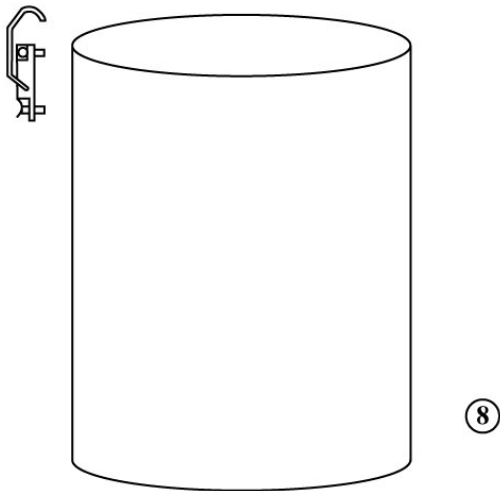
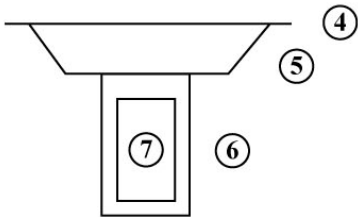

**WET PICK-UP
CONVERSION**

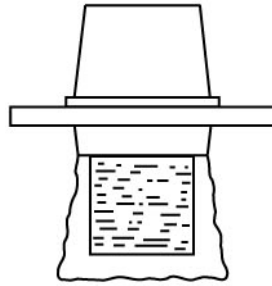

LID ASSEMBLY

520037
DACRON FILTER BAG

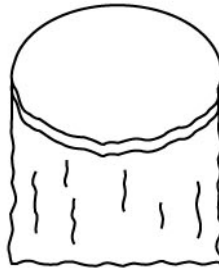

520035P
FILTER PROTECTOR

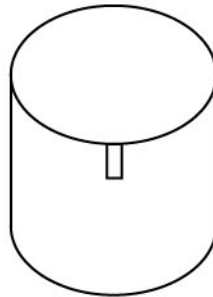

861129
WATER PICK-UP ASSY

WARNING:
FOR SAFE AND PROPER
WATER PICK-UP, THE
CONVERSION ASSY. MUST
BE ASSEMBLED EXACTLY
AS SHOWN

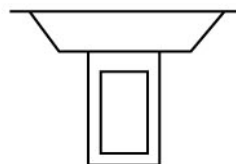

540006
WATER SHUT-OFF ASSY

IMPORTANT:
WHEN CONVERTING FOR
WET PICK-UP, THE UPPER
CLAMP ON THE DOWN TUBE
COUPLER (LOCATED IN THE
TANK ASSY.) MUST BE
LOOSENED AND BOTTOM
HALF OF THE TUBE
REMOVED; THIS WILL PREVENT
WATER FROM SPLASHING UP
ON THE HEPA FILTER.

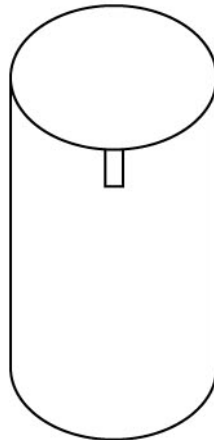

**TOOL KIT AND REPLACEMENT PARTS FOR PD10088 & PW10088
HEPA VACUUM**

<u>PART NO.</u>	<u>DESCRIPTION</u>	<u>QTY. REQ.</u>
520332	1 ½" X 10' HOSE ASSEMBLY	1
520454	2 PC. DOUBLE BEND WAND	1
520112	3" ROUND DUST BRUSH	1
520649	GULPER TOOL	1
520455	11" CREVICE TOOL	1
520340	SQUEEGEE (PW10088 ONLY)	1
520523	3" REPLACEMENT BRISTLE FOR #520112 DUST BRUSH	

WARRANTY

Nikro equipment is warranted for 2 years from the date delivered to the original purchaser. Parts, which become defective due to faulty workmanship or materials during normal use in these years will be repaired or exchanged at no charge if returned and approved by an authorized Nikro service center. The freight shall be at the expense of the customer.

This warranty does not apply to normal wear and tear, neglect, misuse, or incorrect installation. If any other replacement parts, filters or attachments are used other than original Nikro parts, this warranty will become void.

This warranty does not apply to hoses, switches, lights, sensors, or breaks in cords. All motors are subject to manufacturer's warranty. Contact Nikro Industries for assistance with these items.

Nikro disclaims responsibility for loss of production, profits, or any other costs that may indirectly occur due to the failure of this product.

NIKRO
INDUSTRIES, INC.