



***SecurView SV-6800 High Resolution Color Hanging Reverse Cam  
Installation Guide***

**FEATURES:**

- High resolution Color CCD camera.
- Waterproof
- Mounts to virtually any surface
- 130 degree wide viewing angle
- Mirror imaging built-in
- Low light capability
- Includes installation bracket, sunshade, set screws, & 50 feet of installation cable
- High-gloss Black housing (can be painted to match vehicle color)
- Ideal for delivery vans & trucks, minivans, SUV's.

**SPECIFICATIONS:**

1/3 CCD

Size: 1.7 x 1.7 x 1.9"

(44 x 44 x 48mm)

Weight 5.1 Oz. (146 G)

Pixels: 512 (H) x 492 (V)

Resolution: Up to 250,000 pixels

More than 330 TV lines

Minimum Illumination: 1 LUX / F 1.2

Lens Type: Wide Angle

Horizontal Angle: 130

Vertical Angle: 75

Video Output: 1.0 V P-P composite (75 Ohm load)

Supply Voltage: +12VDC

Power Consumption: 180mA typ.

Auto Electronic Shutter: 1/60 s – 1/100000s

White Balance: Automatic

Gamma Correction: 0.45

S/N Ratio: More than 48dB

Operating Temp: -13 to 185 F (-25 to 85 C)

Gain Control: Automatic

Digital Signal Processor w/10 Bit A/D Converter

# SV-6800 CAMERA ASSEMBLY DIAGRAM

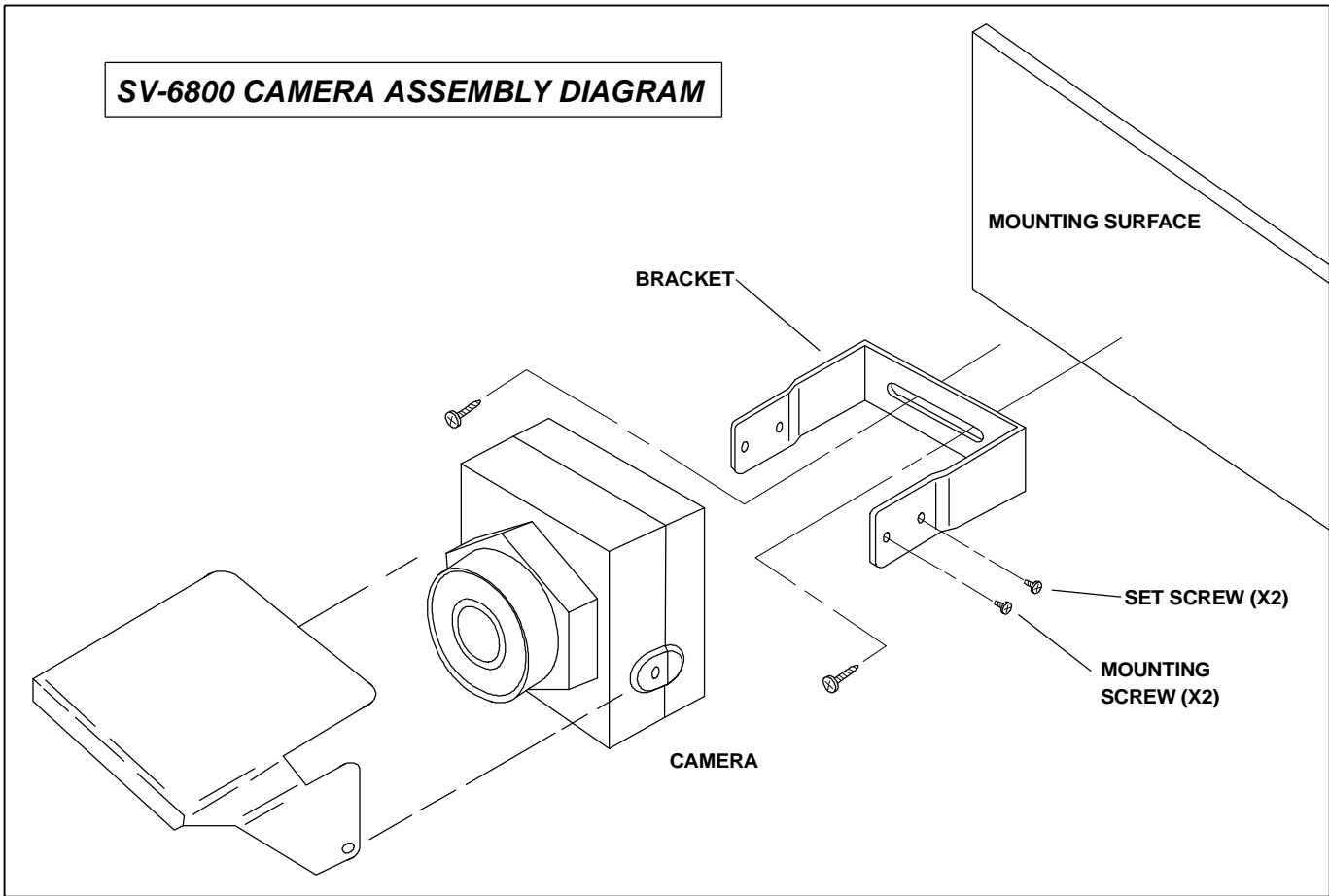

## CONNECTIONS:

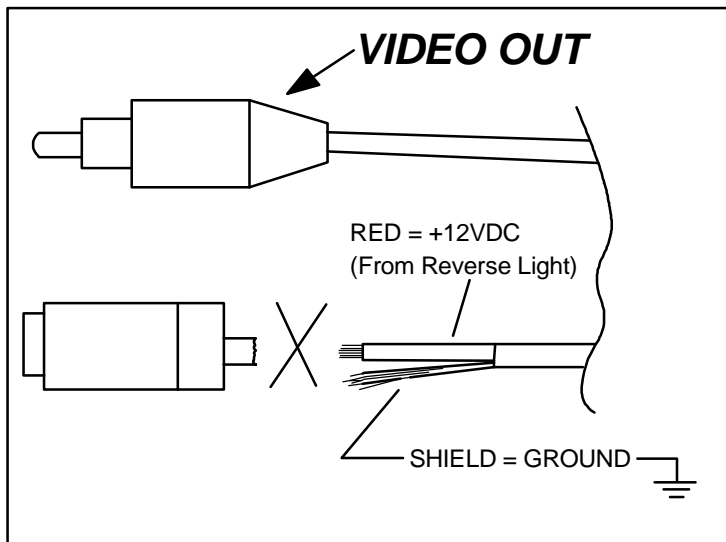

## CAMERA

