

CARE AND USE INSTRUCTIONS

SunMaster®

Premium Commercial
Tanning Equipment

2008 - 2009

Important!

Read this manual before installing, operating or servicing this product.

1-800-274-1744

Unit Specifications

Model	SM-24M	SM-28K All Models	SM-32K All Models	SM-32M All Models
Length	80.5"	80.5"	80.5"	89"
Width	38.5"	38.5"	38.5"	44"
Lamps	24	28	32	32
Voltage	240vac 60 Hz	240vac 60 Hz	240vac 60 Hz	240vac 60 Hz
Amps	14.6	23	26.6	26.6
Circuit Requirements	one 30 AMP	one 30 AMP	one 30 AMP	one 30 AMP
Weight Limit	300 lbs.	300 lbs.	300 lbs.	300 lbs.

RECOMMENDED TANNING SCHEDULE		SKIN TYPE		MAXIMUM EXPOSURE TIME IN MINUTES					The following lamps (or compatible) have been certified for use in this equipment: SunMaster Cleartech 120R FR71T12 - 100W This product is in conformity with performance standards for sun lamp products under 21 CFR 1040.20
				Week 1	Week 2	Week 3	Maximum		
I	Sensitive Skin Burns easily & severely Does not tan	Tanning Not Advised							
II	Light Skin Burns easily & severely Tans minimally	2	3	5	8				
III	Normal Skin Burns moderately Tans moderately	3	5	7	9				
IV	Dark Skin Burns minimally Tans well / above average	5	7	9	12				
CERTIFIED LAMPS									

DANGER. Ultraviolet radiation. Follow instructions. Avoid overexposure. As with natural sunlight, overexposure can cause eye and skin injury and allergic reactions. Repeated exposure may cause premature aging of the skin and skin cancer. **WEAR PROTECTIVE EYEWEAR; FAILURE TO DO SO MAY RESULT IN SEVERE BURNS OR LONG-TERM INJURY TO THE EYES.**

WARNING: Receive proper operation instructions from the proprietor. When using a machine with bench and canopy, pull the canopy down until it will move no further. Recommended distance of the body from the canopy of this machine should be 6 inches or 15 cm. Operation of any tanning bed closer to the body than the recommended minimum distance for use may result in overexposure.

Medications or Cosmetics: Some may increase your sensitivity to the ultraviolet radiation. Consult a physician before using sunlamps if you are using medications, have a history of skin problems, or believe yourself especially sensitive to sunlight. If you do not tan in the sun, you are unlikely to tan from the use of this product. Tanning may appear after one application provided that your skin is capable of developing a suntan. Allow 48 hours between sessions to obtain a base tan, and once or twice per week to maintain appearance.

Recommended eyewear: Provided eye shields, such as Intrexco Nr. 563511s, or equivalent eyewear as defined under 21 CFR 1040.20, 2 (b) (6). One pair of protective eyewear is furnished with this equipment. Eyewear should be worn by all persons in the room when the lamps are on. **INSURE THAT THE TANNING BED USED CONTAINS COMPATIBLE LAMP TYPES AS THOSE LISTED THEREON. ALL EQUIPMENT MUST HAVE LABEL STATING COMPLIANCE WITH PERFORMANCE STANDARDS FOR SUN LAMP PRODUCTS UNDER 21 CFR PART 1040.20.**

RECOMMENDED TANNING SCHEDULE

SKIN TYPE		MAXIMUM EXPOSURE TIME IN MINUTES				The following lamps (or compatible) have been certified for use in this equipment: SUNMASTER CLEARTECH 20 F-71 RIO-BRONZE-R 71" REFLEX BRONZER F-71 100w-R This product is in conformity with performance standards for sun lamp products under 21 CFR 1040.20
		Week 1	Week 2	Week 3	Maximum	
I	Sensitive Skin Burns easily & severely Does not tan	Tanning Not Advised				
II	Light Skin Burns easily & severely Tans minimally	5	9	12	15	
III	Normal Skin Burns moderately Tans moderately	7	11	15	15	
IV	Dark Skin Burns minimally Tans well / above average	9	15	15	15	

CERTIFIED LAMPS

DANGER. Ultraviolet radiation. Follow instructions. Avoid overexposure. As with natural sunlight, overexposure can cause eye and skin injury and allergic reactions. Repeated exposure may cause premature aging of the skin and skin cancer. **WEAR PROTECTIVE EYEWEAR; FAILURE TO DO SO MAY RESULT IN SEVERE BURNS OR LONG-TERM INJURY TO THE EYES.**

WARNING: Receive proper operation instructions from the proprietor. When using a machine with bench and canopy, pull the canopy down until it will move no further. Recommended distance of the body from the canopy of this machine should be 6 inches or 15 cm. Operation of any tanning bed closer to the body than the recommended minimum distance for use may result in overexposure.

Medications or Cosmetics: Some may increase your sensitivity to the ultraviolet radiation. Consult a physician before using sunlamps if you are using medications, have a history of skin problems, or believe yourself especially sensitive to sunlight. If you do not tan in the sun, you are unlikely to tan from the use of this product. Tanning may appear after one application provided that your skin is capable of developing a suntan. Allow 48 hours between sessions to obtain a base tan, and once or twice per week to maintain appearance.

Recommended eyewear: Provided eye shields, such as Intrexco Nr. 563511s, or equivalent eyewear as defined under 21 CFR 1040.20, 2 (b) (6). One pair of protective eyewear is furnished with this equipment. Eyewear should be worn by all persons in the room when the lamps are on. **INSURE THAT THE TANNING BED USED CONTAINS COMPATIBLE LAMP TYPES AS THOSE LISTED THEREON. ALL EQUIPMENT MUST HAVE LABEL STATING COMPLIANCE WITH PERFORMANCE STANDARDS FOR SUN LAMP PRODUCTS UNDER 21 CFR PART 1040.20.**

RECOMMENDED TANNING SCHEDULE		MAXIMUM EXPOSURE TIME IN MINUTES				The following lamps (or compatible) have been certified for use in this equipment:
SKIN TYPE		Week 1	Week 2	Week 3	Maximum	
I	Sensitive Skin Burns easily & severely Does not tan	Tanning Not Advised				SunMaster Custom Bronzer F-71 100W
II	Light Skin Burns easily & severely Tans minimally					SunMaster Custom Face F71 100W
III	Normal Skin Burns moderately Tans moderately	7	11	16	20	SunMaster Custom Body F71 100W
IV	Dark Skin Burns minimally Tans well / above average	10	15	20	20	Brilliance 5.0 F-71 100W
		12	20	20	20	Dual Sun F-71 100W
						Dual Sun XL F-71 100W
						Philips Professional "S" F-71 100W
						Golden Sun-HO-71 F-71 100W
This product is in conformity with performance standards for sun lamp products under 21 CFR 1040.20						

CERTIFIED LAMPS

DANGER. Ultraviolet radiation. Follow instructions. Avoid overexposure. As with natural sunlight, overexposure can cause eye and skin injury and allergic reactions. Repeated exposure may cause premature aging of the skin and skin cancer. **WEAR PROTECTIVE EYEWEAR; FAILURE TO DO SO MAY RESULT IN SEVERE BURNS OR LONG-TERM INJURY TO THE EYES.**

WARNING: Receive proper operation instructions from the proprietor. When using a machine with bench and canopy, pull the canopy down until it will move no further. Recommended distance of the body from the canopy of this machine should be 6 inches or 15 cm. Operation of any tanning bed closer to the body than the recommended minimum distance for use may result in overexposure.

Medications or Cosmetics: Some may increase your sensitivity to the ultraviolet radiation. Consult a physician before using sunlamps if you are using medications, have a history of skin problems, or believe yourself especially sensitive to sunlight. If you do not tan in the sun, you are unlikely to tan from the use of this product. Tanning may appear after one application provided that your skin is capable of developing a suntan. Allow 48 hours between sessions to obtain a base tan, and once or twice per week to maintain appearance.

Recommended eyewear: Provided eye shields, such as Intrexco Nr. 563511s, or equivalent eyewear as defined under 21 CFR 1040.20, 2 (b) (6). One pair of protective eyewear is furnished with this equipment. Eyewear should be worn by all persons in the room when the lamps are on. **INSURE THAT THE TANNING BED USED CONTAINS COMPATIBLE LAMP TYPES AS THOSE LISTED THEREON. ALL EQUIPMENT MUST HAVE LABEL STATING COMPLIANCE WITH PERFORMANCE STANDARDS FOR SUN LAMP PRODUCTS UNDER 21 CFR PART 1040.20.**

OPERATING YOUR COMMERCIAL TANNING BED

CAUTION: **BEFORE** Initial Use, Cycle Timer One Complete Session To Insure Proper Operation.

The SunMaster commercial unit is equipped with an onboard timer (excluding SM-32MCX). This timer is used to pre-select the actual tanning time. Make sure shorting plug is connected to the timer port in the back of the unit. After timer is set, lie on the acrylic surface of the lounge and switch the ON/OFF power switch on the airbar to the ON position, and lower the canopy.

NOTE: The switch on the airbar may be used to interrupt the tanning session at any time by pushing it to the OFF position.

WARNING

- ❖ Do not cover the ventilation holes on the unit.
- ❖ Do not look directly at the lamps, even if wearing protective eyewear.
- ❖ Sunglasses are not suitable. Always wear the proper eye protection goggles.
- ❖ Do not reset the timer beyond the recommended exposure schedule.
- ❖ Do not tan more than once within a 24-hour period.
- ❖ Do not use tanning bed in any place that is likely to come in contact with water.
- ❖ Do not use this unit without first consulting your physician if you are taking any medications (especially photo sensitive drugs), are pregnant, or believe yourself to be particularly sensitive to the sun.
- ❖ Consult you physician before using your tanning bed if you are diabetic, epileptic, prone to fainting or very sensitive to sunlight.
- ❖ Keep children away from tanning unit.
- ❖ Use only lamps specified for your tanning system.
- ❖ Do not use excessive amounts of water, any abrasive cleaners, or any spray cleaner that is not specifically designed for use with acrylic surfaces.

The SunMaster Series is in conformity with performance standards for sunlamp products Title 21 CFR, Part 1010 and 1040.20 only if all replacement lamps, protective eyewear and all electrical parts will be replaced with the same as initially installed by the manufacturer or an approved equivalent.

CARE AND CLEANING

CAUTION: The tanning bed should be disconnected from the power supply before cleaning or disinfecting the inside of the acrylic. Avoid water or solution entering the lamp compartment.

Failure To Clean Acrylics, Fans, And The Inside Of Your Tanning Bed Could Void The Warranty.

After each session is completed, spray the acrylic surface with the specially formulated UVT (Ultraviolet Transmitting) acrylic cleaner according to the instructions. **Do not use alcohol or ammonia.** Wipe the surface of the acrylic with a clean cloth. The acrylic should never be wiped with a dry cloth, as this will generate a slight charge that will attract dust.

For maximum efficiency of your tanning bed, periodic cleaning of lamps, reflectors, acrylics, fans and the inside of the unit is required.

WARNING:

If you have been diagnosed by a physician as being allergic to the sun or are currently taking photosensitive medications consult your physician before using this product.

Certain drugs – particularly those designed to enhance photosensitivity – may cause individuals under their influence to experience adverse effects. These people should avoid exposure to UV sources of all kinds. Doctors will advise persons taking these drugs of possible adverse effects.

It is recommended that only one person at a time tan in the tanning bed. Protective eyewear is provided with each tanning bed. Use protective eyewear when using this equipment.

Occasionally, persons using the tanning system will experience a slight reddening of the skin – usually in small patches – after the second or third session. This redness is often accompanied by an itching sensation. This is usually nothing more than a heat ‘rash’ caused by heat from the lamps within the system. It is generally very limited and caused by constant contact of the skin with the acrylic surface. It should go away within 24 hours and should not reappear. This rash can be lessened or prevented by turning over occasionally during tanning sessions, and by applying moisturizing lotion to the affected area after the tanning session is completed.

CAUTION

WHILE THERE IS NO IMMEDIATE CLINICAL EVIDENCE REGARDING UVA EXPOSURE AND ITS EFFECTS UPON EXPECTANT MOTHERS, IT IS STRONGLY ADVISED THAT EXPECTANT MOTHERS BE DISCOURAGED FROM USING THE TANNING BED.

EXPOSURE TIMES AND FREQUENCIES

Melanin, the brownish pigment produced by special cells in the base layer of the skin, determines the individual's ability to tan. As the skin is exposed to ultraviolet rays, the melanin is activated and combines with protein cells that rise to the skin's surface, thus producing a tan. The amount of melanin in your body determines how quickly and darkly you tan.

THE TAN PRODUCED BY THE TANNING BED IS A DEEP, RICH “COSMETIC” TAN. HOWEVER, REGARDLESS OF HOW MUCH AN INDIVIDUAL MAY TAN WITH THIS UNIT, IT WILL NOT PROVIDE ADEQUATE PROTECTION AGAINST OVEREXPOSURE TO NATURAL SUNLIGHT OR UVB TANNING SYSTEMS.

SKIN TYPE II-	USUALLY BURNS EASILY AND SEVERELY, TANS MINIMALLY OR LIGHTLY AND PEELS.
SKIN TYPE III-	OFTEN REFERRED TO AS “AVERAGE” COMPLEXION, BURNS MODERATELY AND TANS ABOUT AVERAGE.
SKIN TYPE IV-	BURNS MINIMALLY, TANS EASILY AND ABOVE AVERAGE WITH EACH EXPOSURE.
SKIN TYPE V-	RARELY BURNS, TANS EASILY.

ACRYLIC REMOVAL/RE-LAMPING INSTRUCTIONS

CAUTION: REPLACE ONLY WITH THE LAMP SPECIFIED ON THE WARNING LABEL (located on the tanning unit), OR RECOGNIZED EQUIVALENT.

1. Disconnect unit from power supply.
2. Remove acrylic from unit by removing the screws on the front acrylic retaining strip. Back strip remains in place – do not remove screws.
3. For bench, carefully lift acrylic upward and out. For canopy, pull downward and out.
4. Clean acrylic shield. (Refer: CARE AND CLEANING.) Clean both sides of acrylic shield. Novus Products recommended.
5. To remove lamps, twist ½ turn until pins in the lamp line up with the slots in the lamp holder.
6. To install lamp, align pins on lamp with slots. Twist ½ turn to lock in place. For reflector lamps, the label on the lamp **MUST** be fully visible.
7. Insert acrylic into back retaining strip channel. Reinstall front strip with screws. Reconnect unit to power supply.

SHOCKS (Gas Springs) INSTALLATION

The shocks **MUST** be installed with the thick barrel **UP** and the thin shaft (plunger) **DOWN**. If they are installed incorrectly, this will cause the seals in the barrel to fail and **void** the warranty.

TROUBLESHOOTING

PROBLEM

Unit fails to turn on.

SOLUTION

1. Make sure unit is connected to power source and turned on.
2. Check source of power. Reset breaker or replace fuse.
3. Make sure cords between canopy/lounge and airbar are properly connected.
4. Make sure timer dial is turned past the 0 (zero) setting.

One or more lamps fail to light.

1. Check that lamp is installed properly.
2. Switch unlit lamp with lamp that lights. If the new lamp lights and the old still does not, replace old lamp.
3. Contact your service representative.

Canopy fails to stay up.

1. Check to make sure that shocks are installed properly. (See shock installation.)
2. Contact your service representative.

Unit does not stay on.

1. Check source of power. Reset breaker or replace fuse.
2. Check timer shorting plug.
3. Contact your service representative.

Leg Installation

Place lounge face down, on blanket or carpet.
Remove hardware from 5/16" bolts extended from frame.
Place center hole of leg over the center 5/16" bolt in frame.
Replace hardware.
Do not tighten until all hardware is in place on one leg.
Flex the end of leg and fit over end bolts; add hardware.
Tighten all hardware securely; repeat for other end.
(Hardware= flat washer, lock washer, and 5/16" nut)

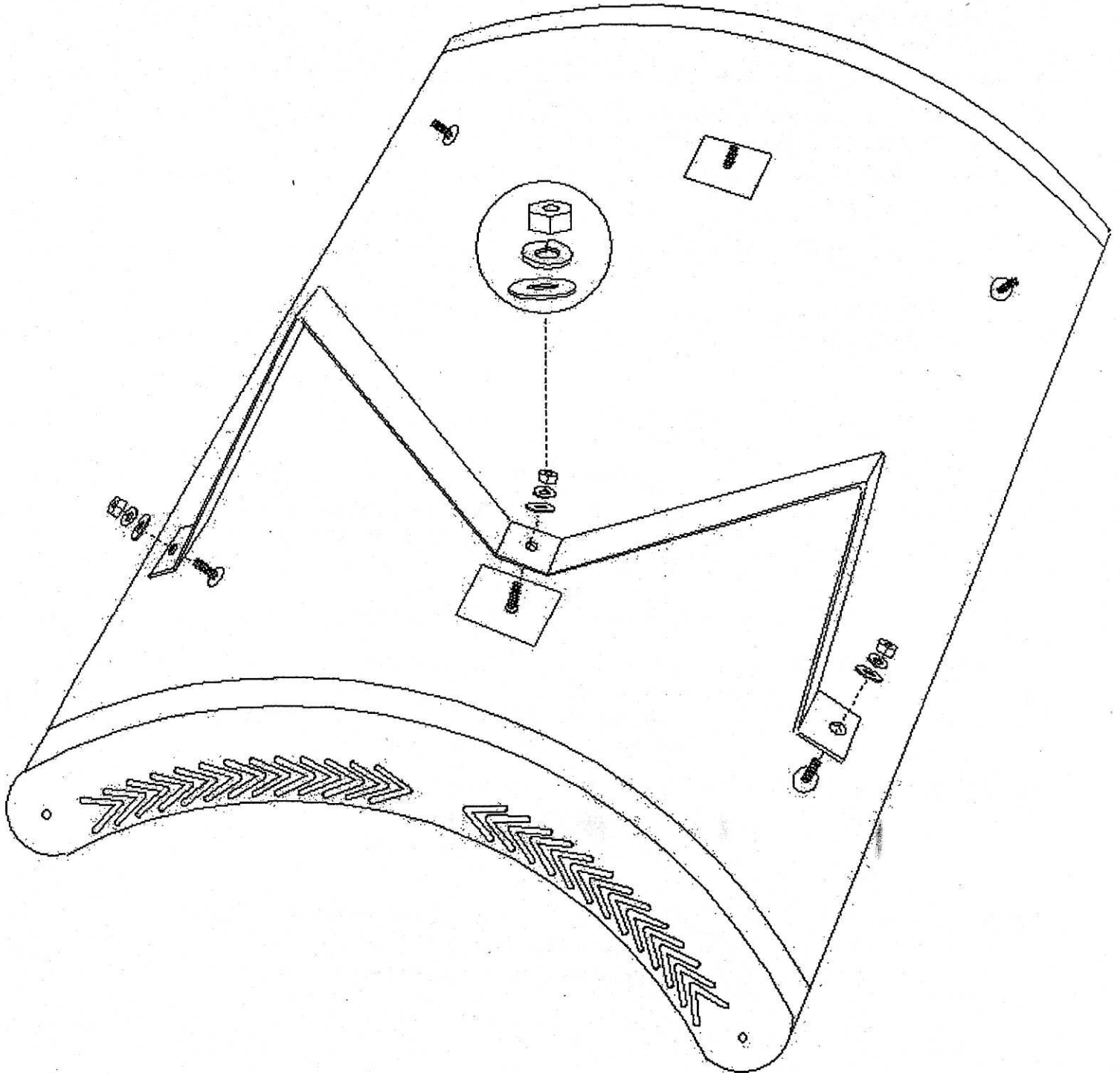

Hinge Installation

Remove hardware from mounting bracket in bed frame.
Attach hinges as shown in drawing below.
DO NOT tighten bolts at this time.

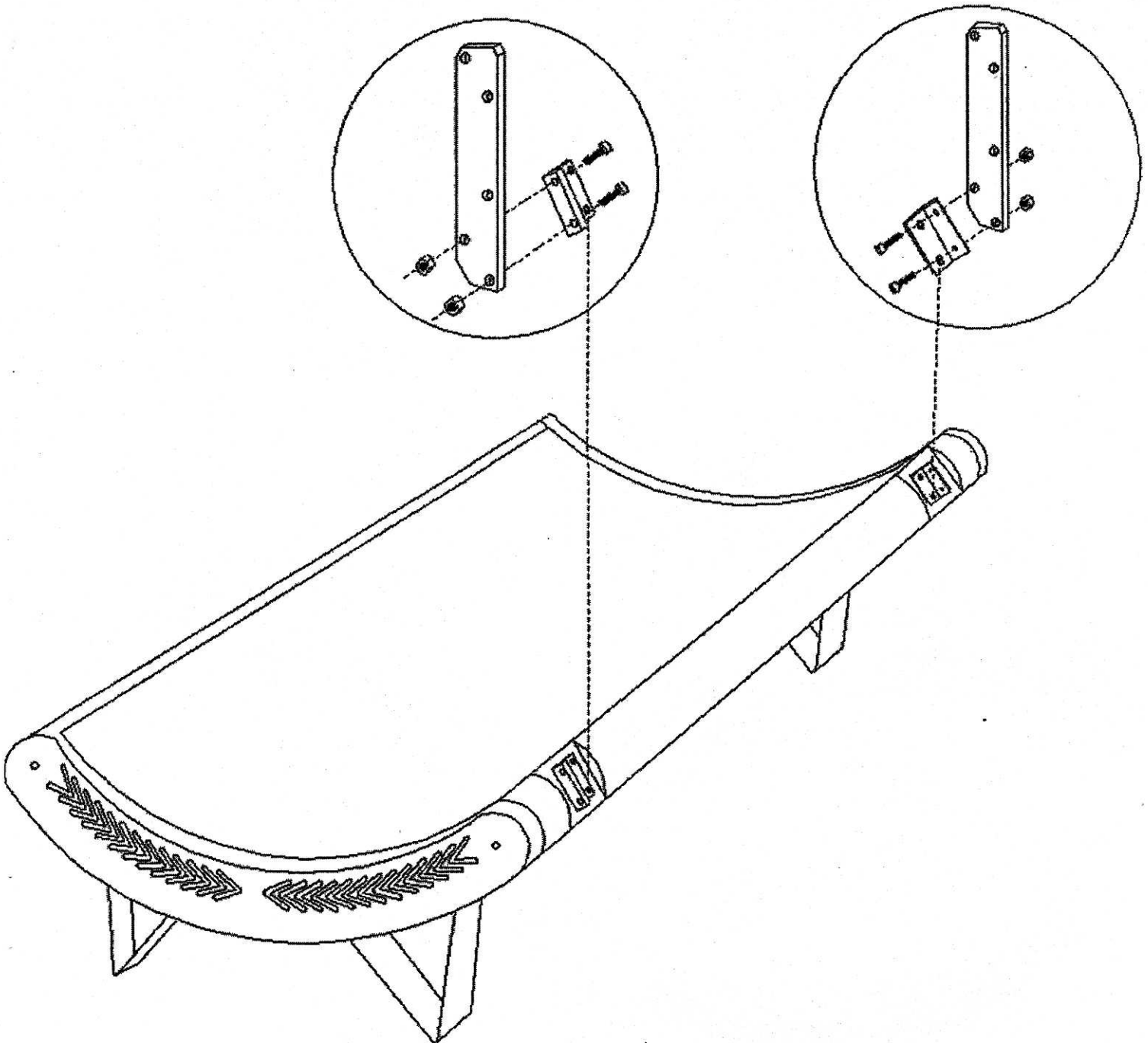

Canopy Installation

Move canopy into the position shown (will require two (2) persons).
Mounting brackets on canopy fit inside hinge bars.
Insert pins through bracket first then through hinge.
Secure pin by inserting pin clip through small hole in pin.
Repeat on other end.
Tighten bolts securing hinges to bed, and then tighten bolts in ends of air bar.

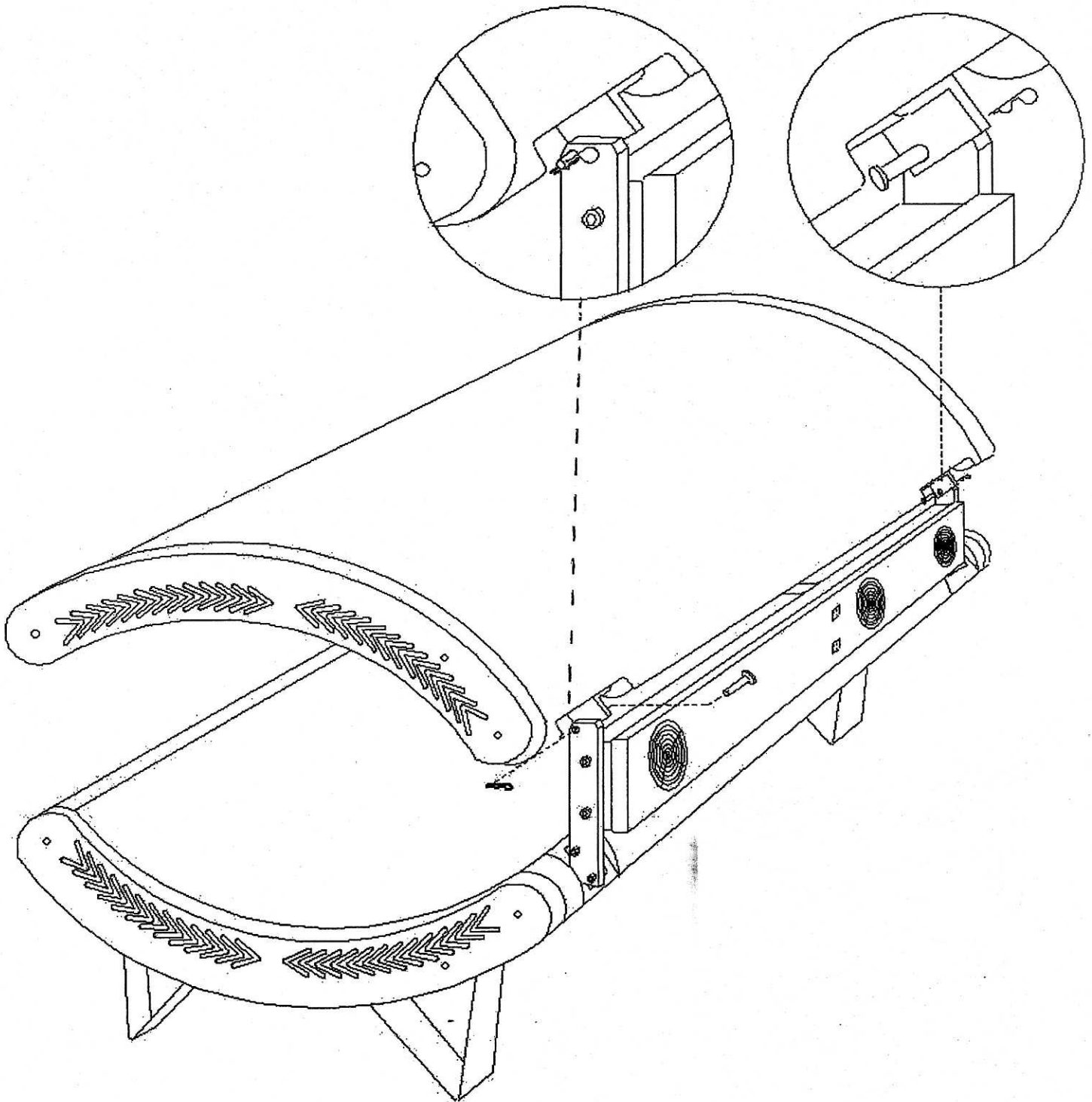

Shock Installation

CAUTION

Remove retaining pins from ends of shocks (shown below).
Lifting from center, raise canopy until shocks fit.
Install shocks with small shaft DOWN, or damage will result.
Install end of shock over ball stud, in end of bed.
Insert pins back into shock ends, rotating to lock.

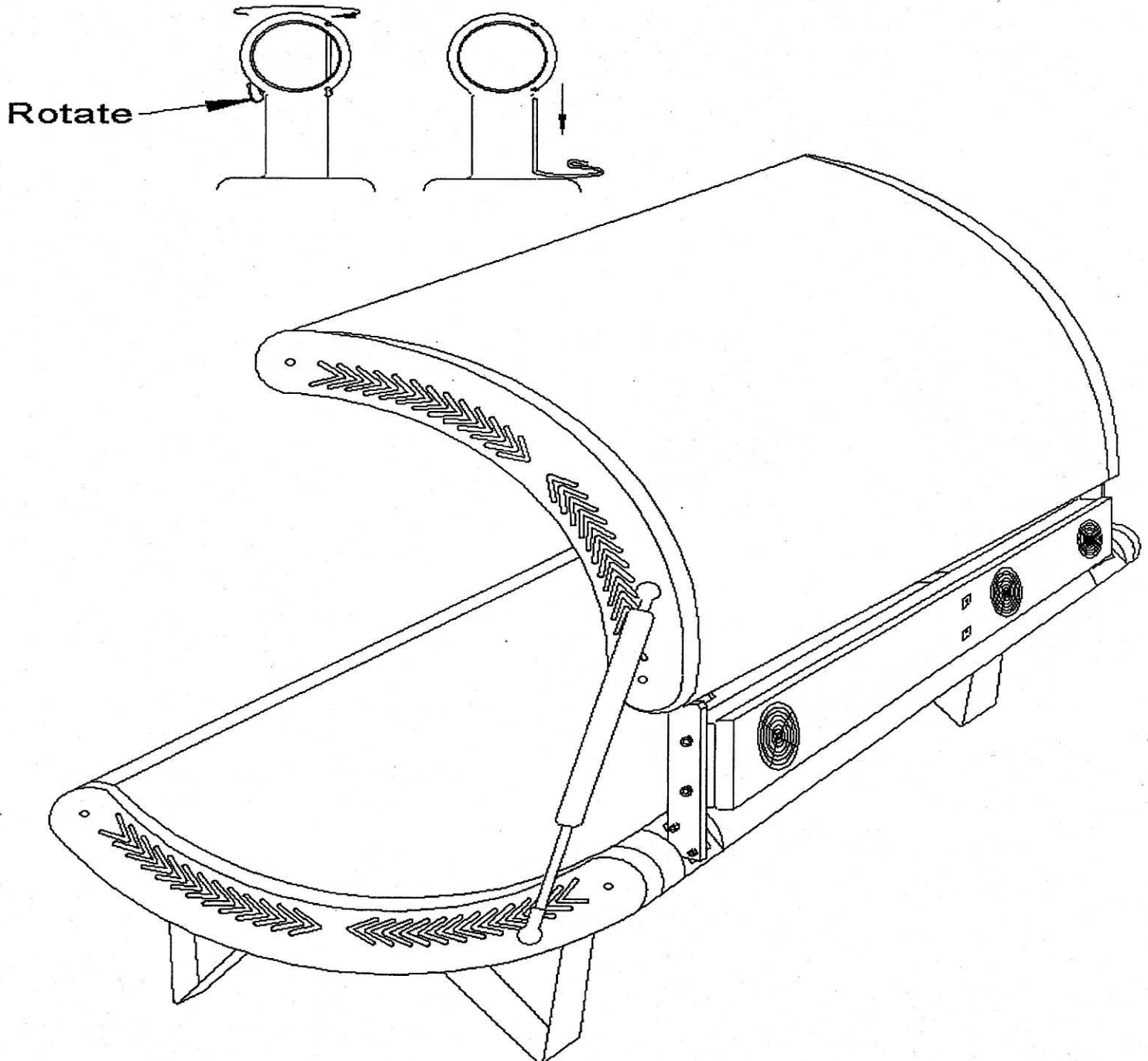

Skirt Kit Installation

Slide in end cover (A) until flange is under tip of leg.

Repeat for other end.

Move front skirt (B) bottom in under leg, then push top in behind locking rib on bed.

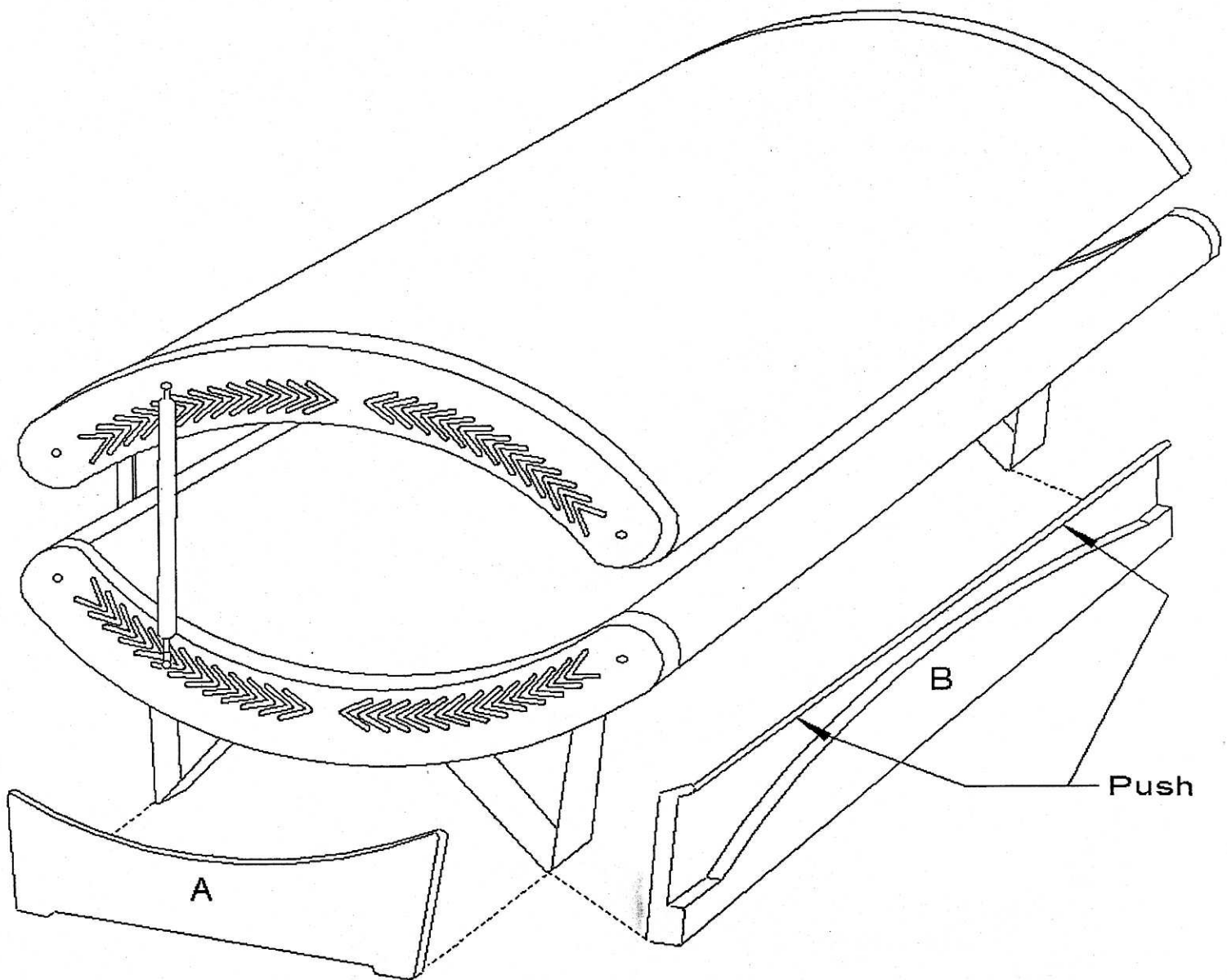

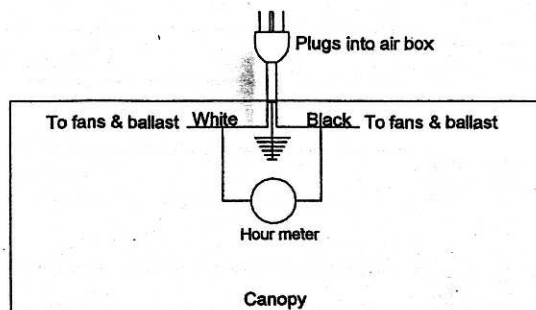
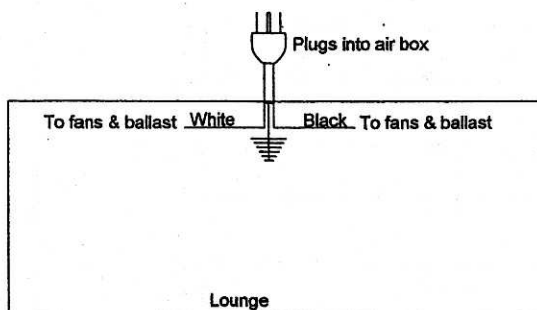
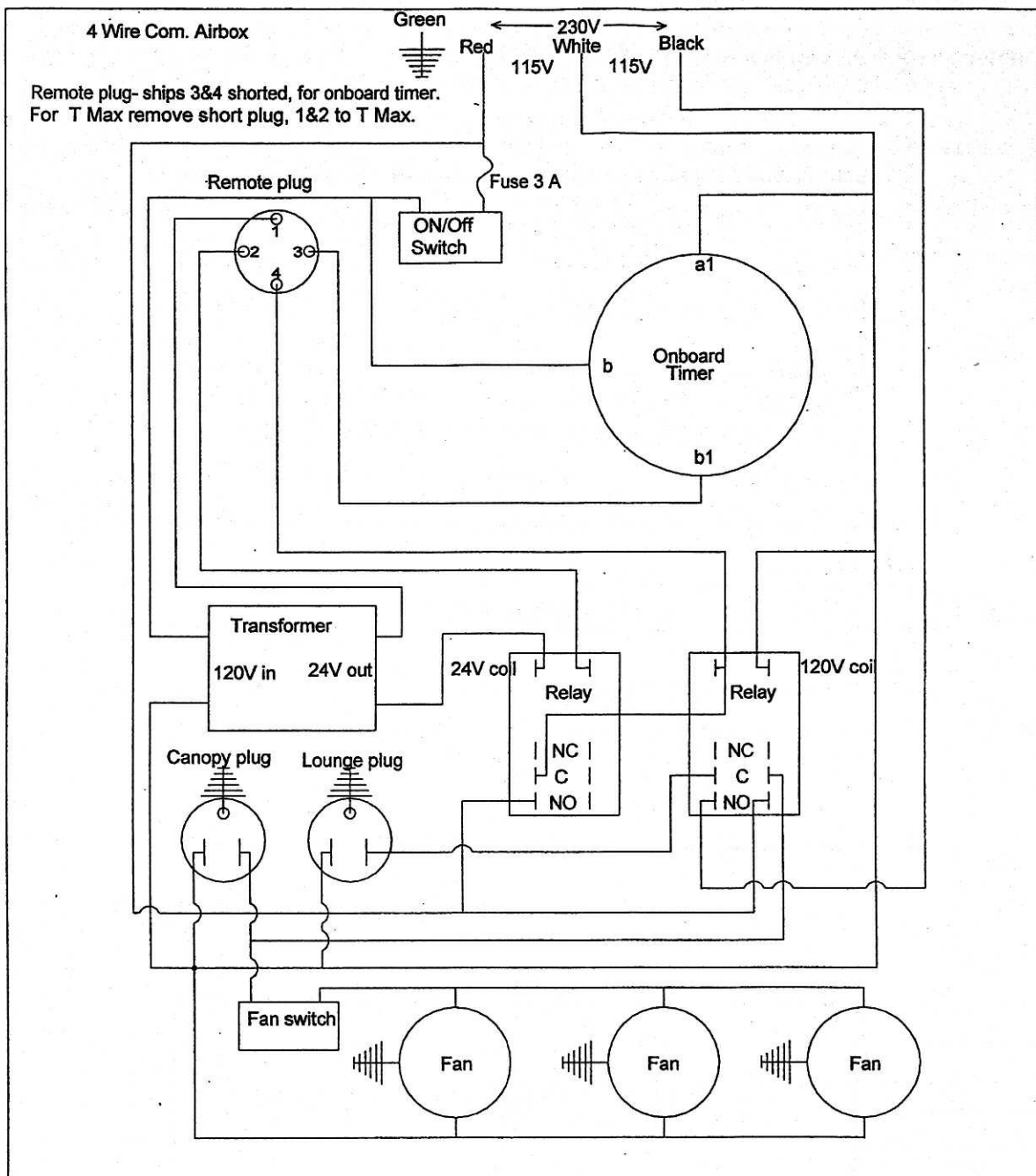

Wiring diagrams for ballasts. Your tanning bed may have one or both types.

Note: In 230V versions, both the black and white are HOT. Green or ballast case is ground.

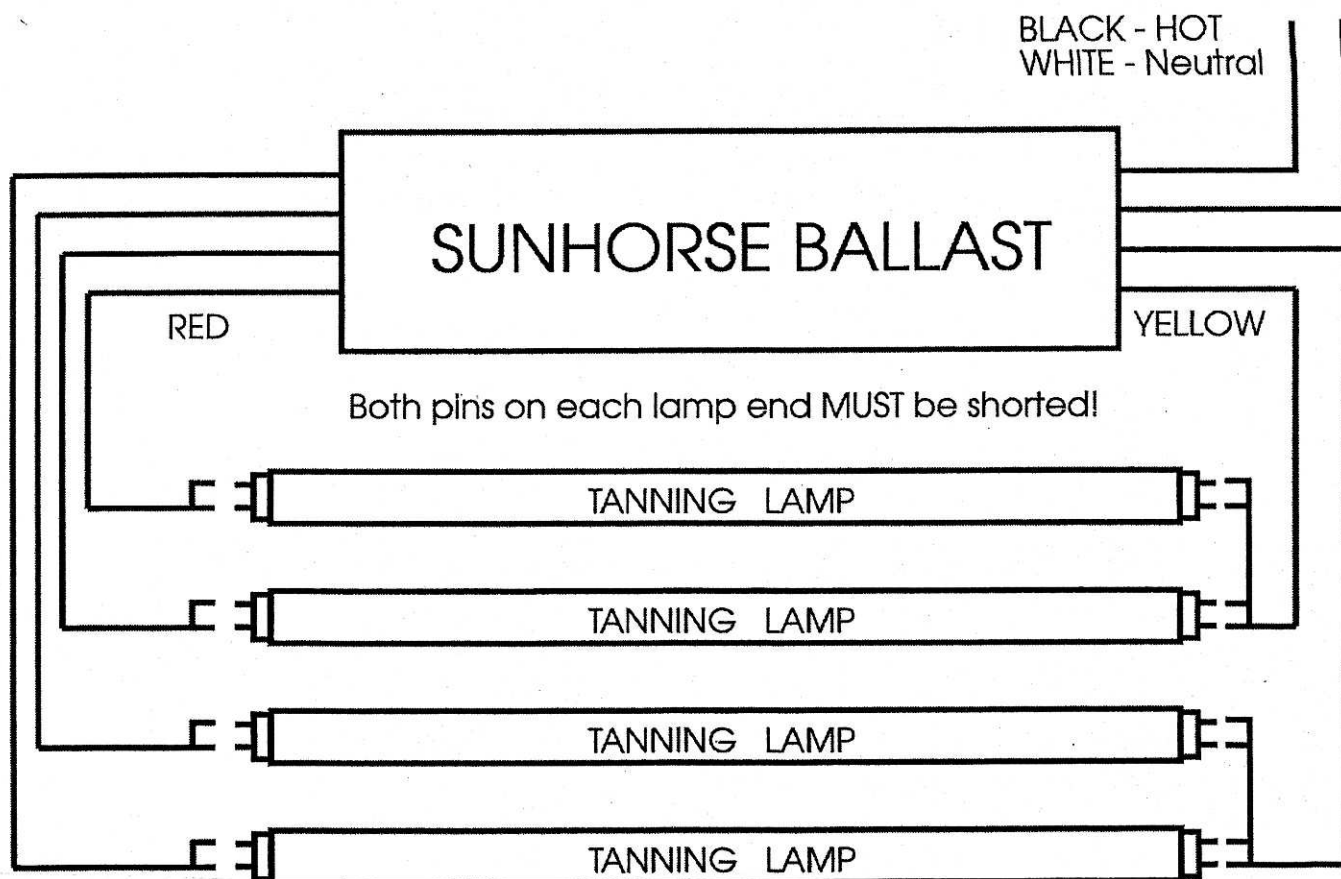
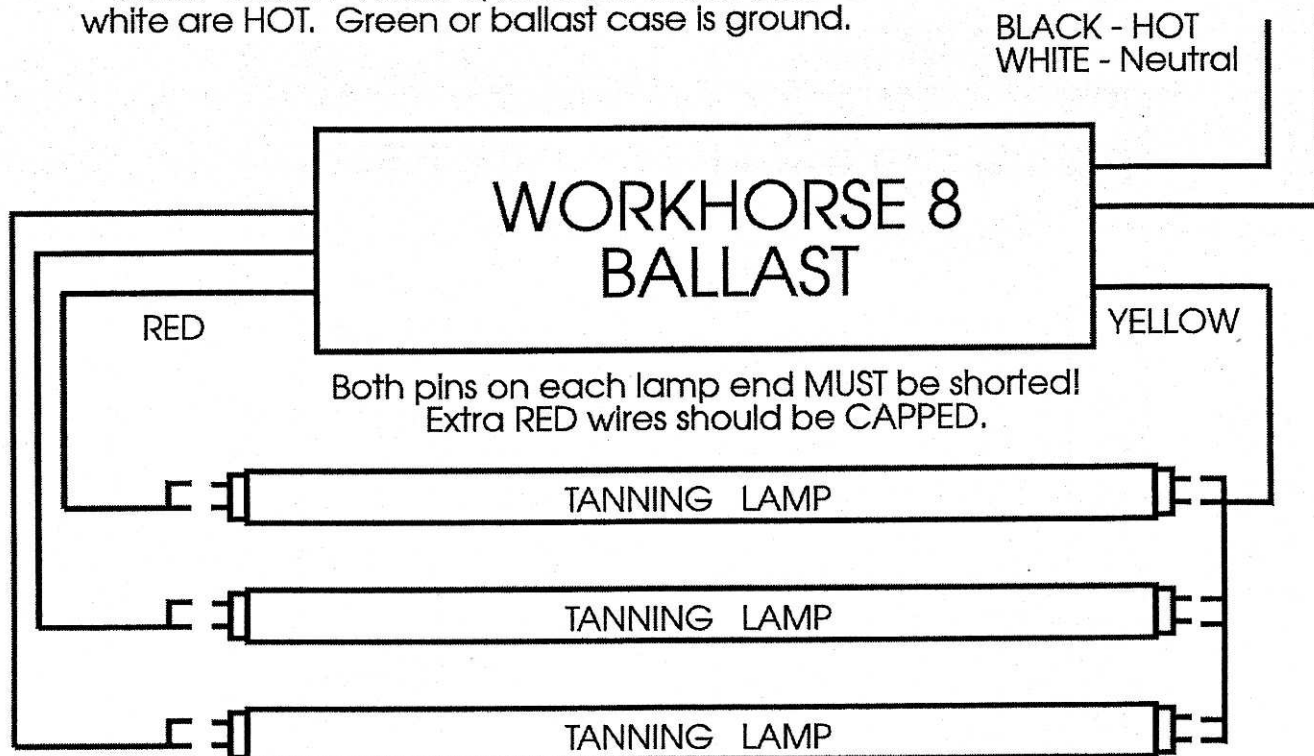

WARNING

From Canopy

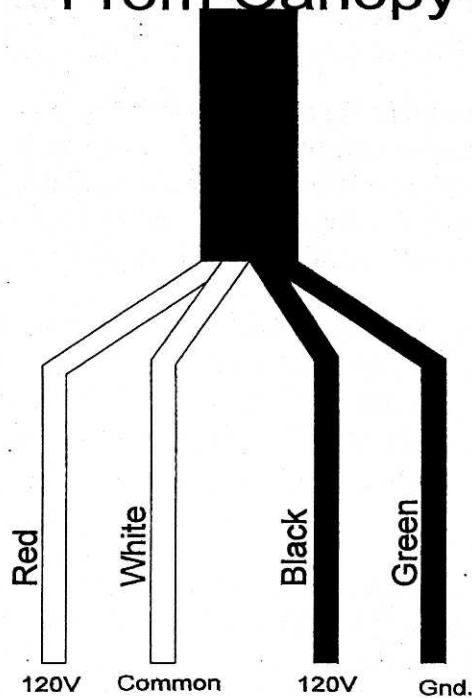

Current must be 220 Volt single phase 4 wire hook up.

Before applying power to bed (CHECK) with volt meter!

Voltage between white and black- 120 V

Voltage between white and red- 120 V

Voltage between red and black- 240 V

Voltage between white and green- 0

4 Conductor 10ga. wire min.

Wiring in any other way (WILL) damage bed.

Damage due to improper wiring, (WILL NOT) be covered by WARRANTY

SUNMASTER LIMITED WARRANTY

Every SunMaster tanning bed purchased directly or from an authorized SunMaster dealer is covered by our exclusive Three-Year Parts Warranty against manufacturer's defects. For a period of three years from the date of purchase, SunMaster will provide replacement parts for parts that are shown to be defective.

The acrylics on your new SunMaster tanning bed are covered by a pro-rated One-Year Warranty against manufacturer's defects. The manufacturer covers lamps for a period of 30 days. The authorized SunMaster distributor covers Labor for a period of 30 days from the date of purchase. This Warranty does not cover: abuse, misuse, unauthorized repairs or modifications, transportation, damage during transit or installation, or normal wear.

SunMaster, UVA SunSystems, Inc., Precision Plastics, Inc., or their authorized distributors SHALL NOT BE LIABLE FOR LOSS OF USE, LOSS OF TIME, RENTAL OR SUBSTITUTE PRODUCTS, LOSS OF INCOME, LOSS OF BUSINESS, INCONVENIENCE, OR ANY OTHER INCIDENTAL OR CONSEQUENTIAL DAMAGES. IN ANY AND ALL CASES, ANY LIABILITY SHALL BE CONFINED TO THE REPLACEMENT OF DEFECTIVE AND NON-CONFORMING PARTS.

Some states do not allow exclusion or limitation of incidental or consequential damages, so the above limitations and/or exclusions may not apply to you. This warranty gives you specific legal rights. You may have other rights that vary from state to state.

No one may modify this warranty in any way. Warranty claims should be made by calling 1-800-274-1744 Monday through Friday, 9 a.m. to 5 p.m. EST, or by writing to: UVA Sun Systems, Inc., Warranty Claims Dept., 6208 Technology Dr., Browns Summit, NC 27214.

Governing law: This Limited Warranty shall be governed by, interpreted and enforced in accordance with the substantive and procedural as of the State of North Carolina and the United States of America, conflict of law rules notwithstanding. This Limited Warranty, and all claims, disputes or actions arising hereunder, shall be subject to and conducted in the courts where the defendant in such claims, disputes or actions is domiciled.

Notice

TO VALIDATE THIS WARRANTY, THE FOLLOWING WARRANTY CARD MUST BE MAILED TO UVA SUN PRODUCTS WITHIN 30 DAYS OF PURCHASE. YOU MUST BE ABLE TO PROVIDE A COPY OF THE ORIGINAL PROOF OF PURCHASE UPON REQUEST OR WARRANTY WILL BE VOID.