



**INSTALLATION INSTRUCTIONS  
POLARIS RANGER XP900  
FULL MULTIVENTS WINDSHIELD  
PART # 77-9525**

**IMPORTANT NOTICES**

**READ AND UNDERSTAND THESE INSTRUCTIONS COMPLETELY BEFORE INSTALLATION TO  
AVOID INJURY TO YOURSELF, DAMAGE TO THE VEHICLE OR ACCESSORY.**

- For proper installation, **TWO** people are required.
- Torque specifications must be followed when tightening bolts. Over-tightening any and/or all screws will cause cracks around mounting holes which is not covered by any warranty.
  - As specified on carton label, once protective film on shields is removed, product cannot be returned.
- As specified on carton label, damage caused by packaging staples is not covered by warranty. All staples must be removed prior to removing product from carton.
- Failure to follow these installation instructions completely may void any warrantable components and result in product damage or personal injury.
- Do not use Loctite or any other similar fastener adhesive. These types of products react to plastics and cause cracking. Not covered by any warranty.
- Our windshields are made from the highest quality material providing optimum transparency and clarity. Blurriness and/or extrusion marks may or may not appear when looking through windshield from a wide, side-angle. This is normal for all extruded clear plastic materials.
- The application of improper cleaners, abrasive and/or dirty cleaning towels can severely damage the product. Failure to follow cleaning recommendation (provided herewith) may void any warrantable components.

**DEALER**

**These instructions contain important information for future reference and must be given to the customer at time of purchase or upon completion of installation.**

**Parts List** (parts available with kit only and not available separately)

ITEM	PART NAME	DESCRIPTION	QTY
A	Windshield	CNC windshield cut-out made of 1/4" thick GE MR10 polycarbonate or equivalent	1
B	Co-extruded bulb seal	Includes: 162" Co-extruded bulb seal <b>[end user to cut to exact length]</b>	1
C	Upper vent grill	CNC vent grill cut-out made of 3/16" tinted polycarbonate	2
D	Lower vent grill	CNC vent grill cut-out made of 3/16" black polyethylene	1
INSTRUCTION BAG	E	Vent hardware Includes: 7 carriage bolts M6 x 30, 7 thin plastic washers, 14 plastic washers M6, 7 rubber washers M6 and 7 female thread knobs M6	1
	F	Windshield Hardware Includes: 4 metal plate hooks, 4 washers M6 x 25 and , 4 knobs M6 x 16	1

**1. Installation**

- a) Find a clean flat area where you can lay down the windshield (Item A). Partially remove the protective film on both sides and apply the co-extruded bulb seal starting at bottom center of the windshield (as shown on page 2) using manual pressure to ensure good adhesion.

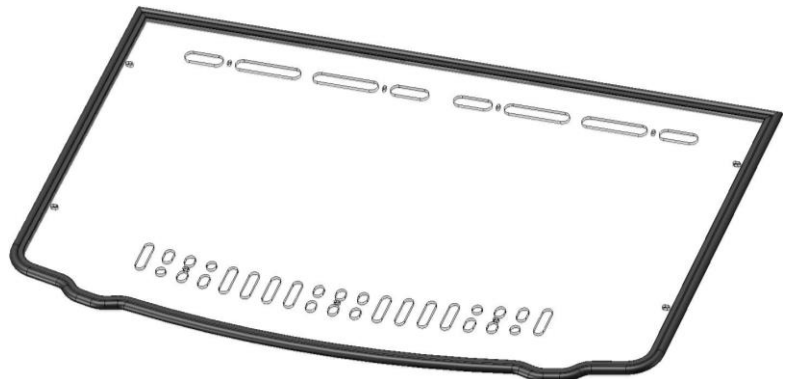

- Special cuts are required on each upper corner. For proper installation, follow instructions of images below (the seal has an internal steel structure, a steel cutter is required). At the start/finish of the bulb seal, cut an extra 1/4" more than required. This will ensure a tight fit between the start and finish of the bulb seal.

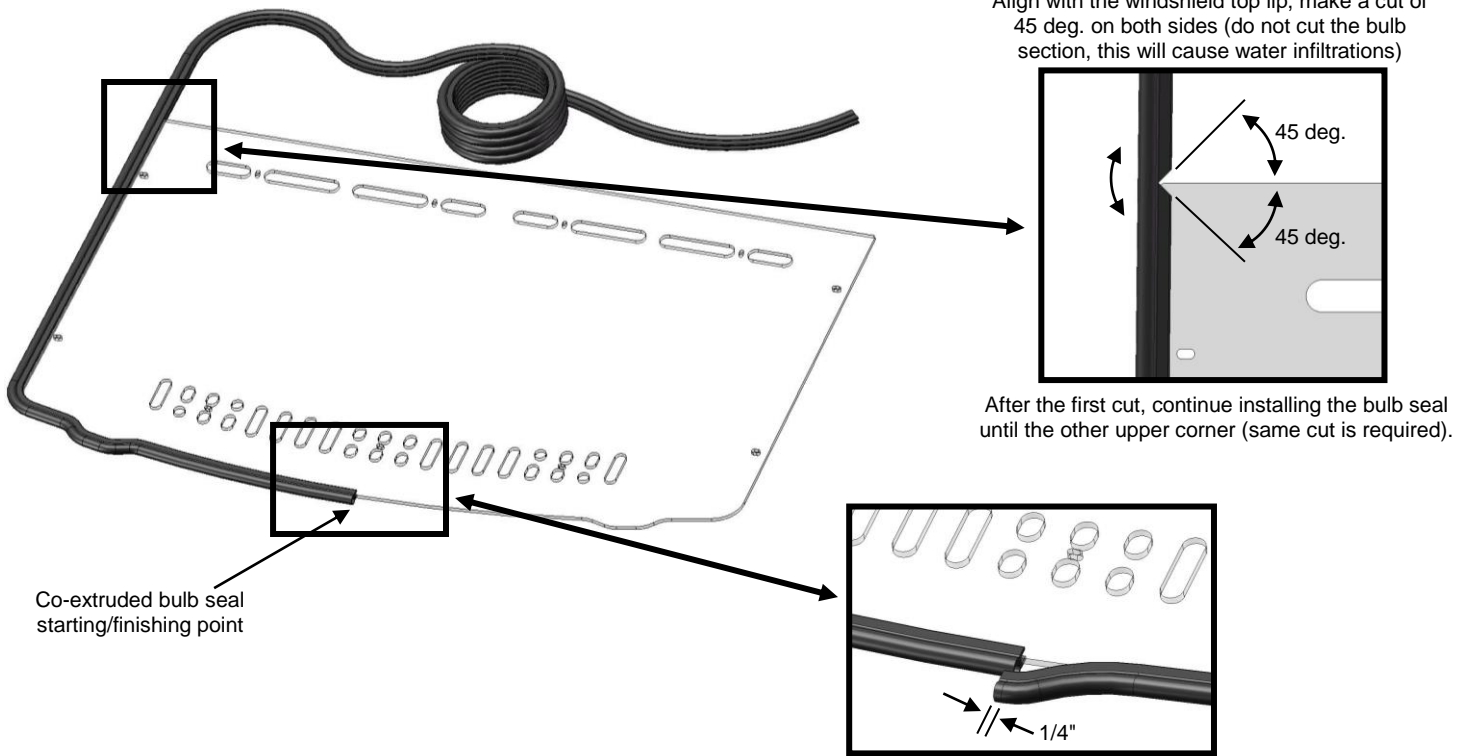

- b) As per drawing, install the vent grills (Item C & D) to windshield using supplied hardware (Item E).

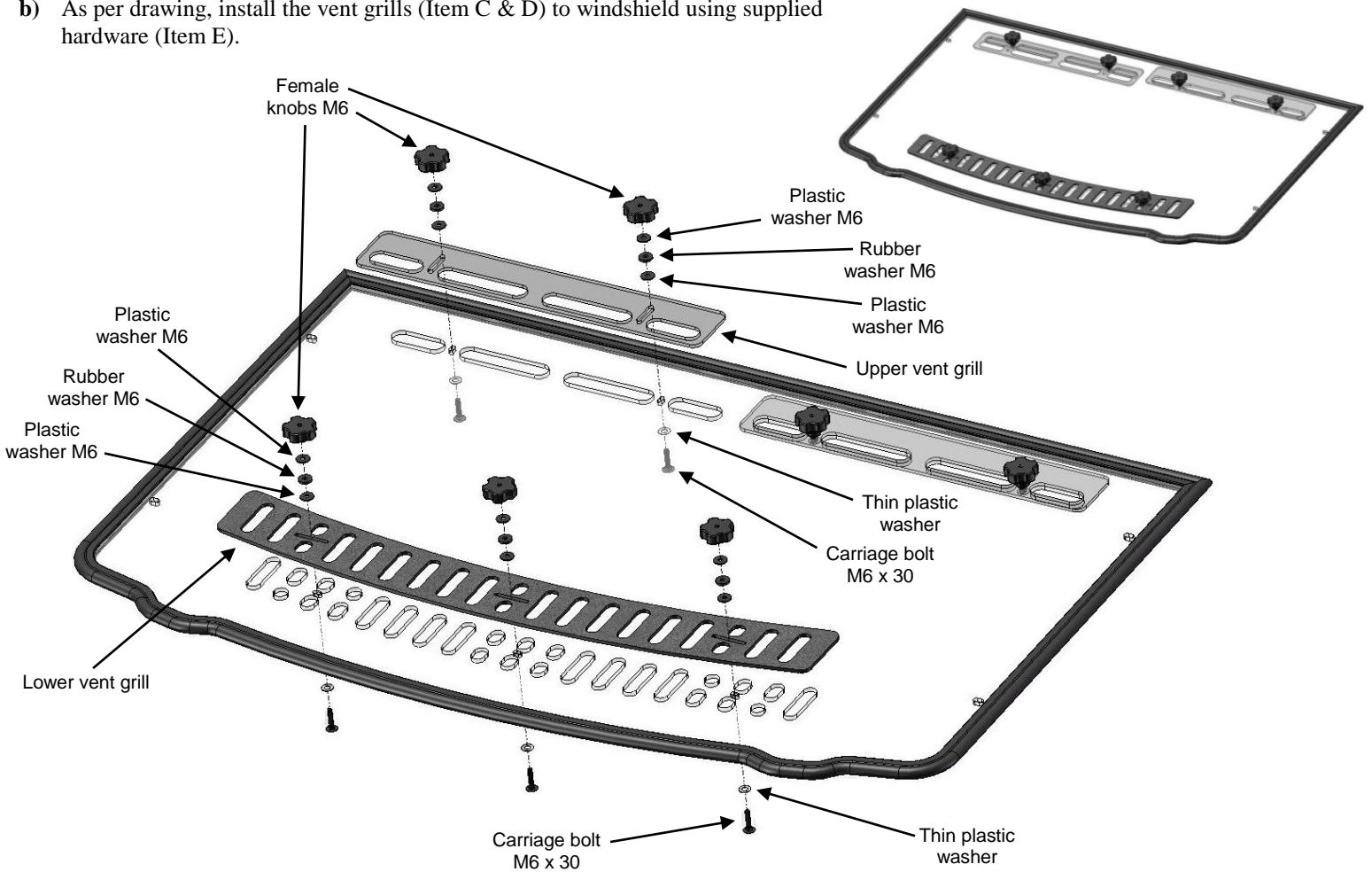

## IMPORTANT NOTICES

Over-tightening any and/or all screws will cause cracks around mounting holes which is not covered by any warranty.

- c) Install the windshield to the vehicle using supplied hardware (Item F). Adjust the position of the windshield and tighten.  
**Caution: over tightening any hardware could cause irreversible damage to the windshield.**

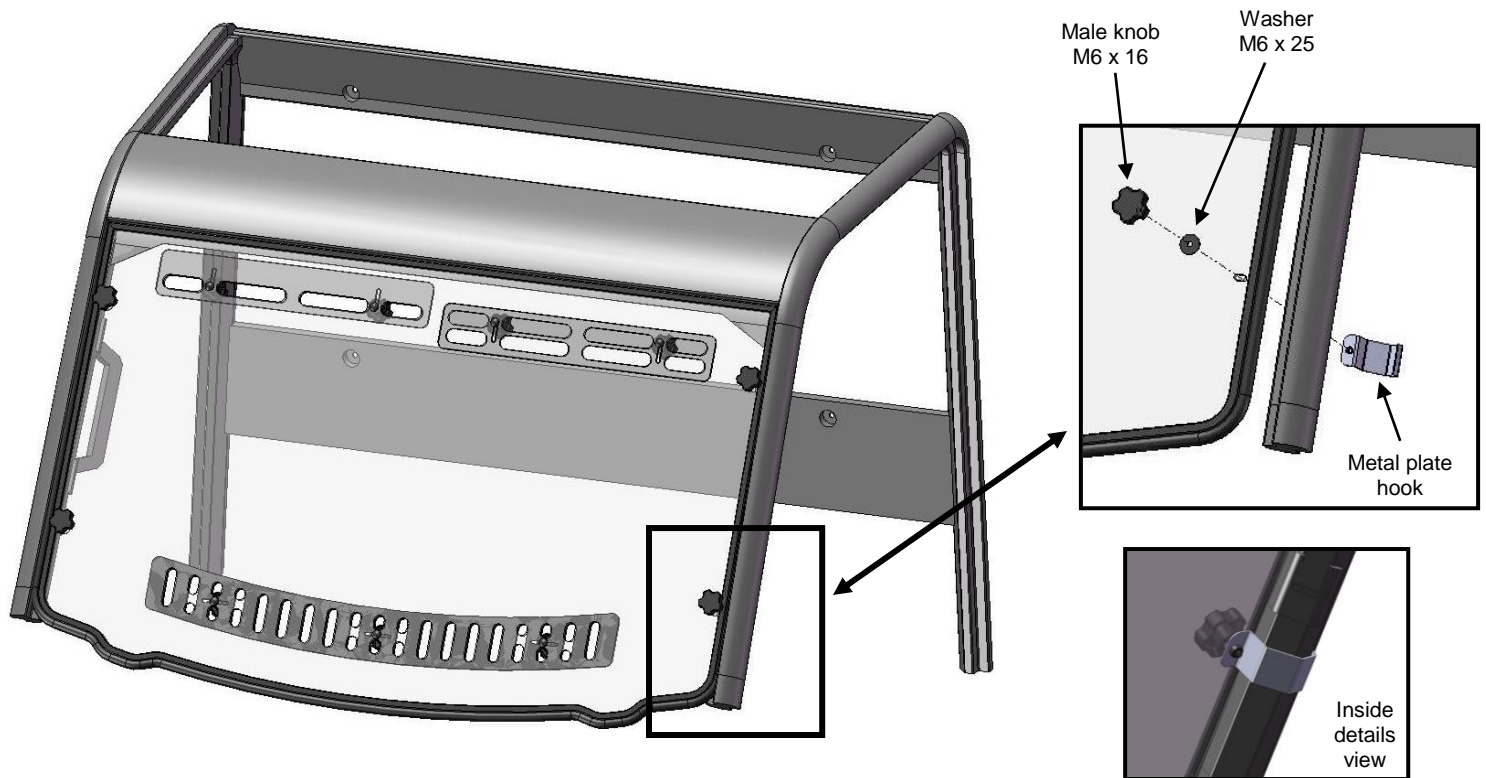

## 2. Maintenance and Care

Tighten all hardware after first use and periodically thereafter.

### CLEANING:

- Rinse with lukewarm water; wash gently with mild soap or detergent and lukewarm water, using a soft cloth or sponge. **DO NOT SCRUB** or use brushes or squeegees.
  - Rinse again. Dry with soft cloth or moist cellulose sponge to prevent water spotting.
- To remove wet paint, glazing compound or grease, rub lightly with a good grade of VM&P naphtha or isopropyl alcohol, then wash and rinse. **DO NOT USE GASOLINE.**

**NOTICE:** Abusive cleaning procedures by hand washing or automated washing equipment will eventually result in visual hazing, loss of light transmission and coating delamination.

#### Compatible Cleaning Agents

- Aqueous Solution of Soaps and Detergents

Fantastik | Joy | Formula 409 | Mr. Clean | Top Job | VM&P grade Naphtha | Hexcel, F.O. 554 | Neleco-Placer