

USER MANUAL

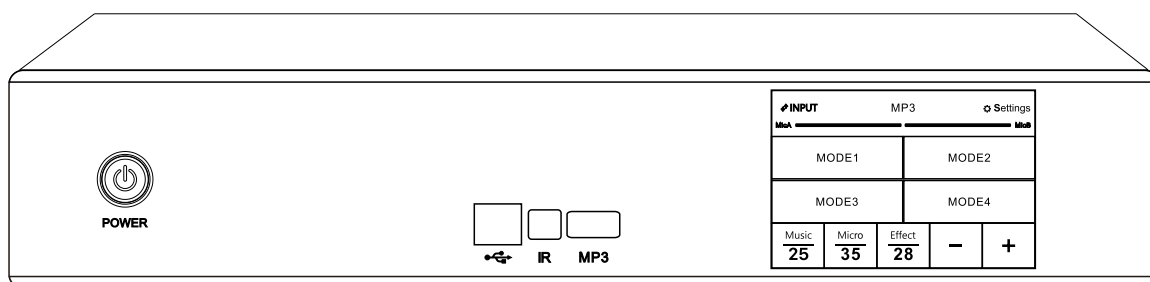

Preface

Thank you for purchasing our products. Before operating this machine, please read this instruction manual thoroughly so that you can understand how to use this equipment correctly. After you have read this manual, please keep it in a safe place for future reference.

Important Safety Instruction

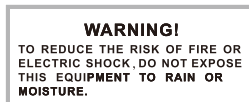

During thunderstorms or if you do not plan to use the device for a long time, unplug the device from the power source to prevent any damage. Do not place the device where it is vulnerable to dripping or spraying. For example, do not place containers containing liquids on the device to prevent the device from getting wet. If the equipment experiences water infiltration, disconnect the power immediately and take the equipment to the dealer or the manufacturer for maintenance. In order to ensure the equipment functions normally, do not block the heat dissipation holes and fan holes of the machine. Do not install the device near heat sources such as radiators, electric heaters, stoves or other devices (including amplifiers) that generate heat. If the device fails, contact your dealer or manufacturer.

Simple Fault and Overhaul

Note:

In order to avoid unnecessary losses to you during transportation, when the machine fails, it might not be a fault with the machine. Therefore, please check the following methods before you submit for repair. After the fault is determined, you may pack the machine and return it to our company. We will do our best to provide you with the most enthusiastic repair services!

Phenomenon	Cause	Solution
No sound output and the display is off.	The power socket has no power supply.	Check the power supply system.
	The socket is not well plugged.	Please connect the power socket well and maintain good contact.
	The AC voltage fuse is burnt.	Unplug the power socket and replace the fuse of the same specification.
No sound output but the display is on.	The output acoustics has no good signal connection.	Reconnect and maintain good contact.
	The main sound volume is set to the minimum.	Reset as the setting means in the Instruction Manual.
	The machine is set as mute.	Cancel mute.
	The signal source has no signal output.	Check the signal source.
Have only one channel for sound output.	The speaker output signal cable on one side is not well connected.	Reconnect and ensure good contact.
	One input signal is wrongly connected or not connected.	Reconnect and ensure good contact.
	Damaged signal cable.	Replace and reconnect, ensure good contact.

Front Panel Instruction

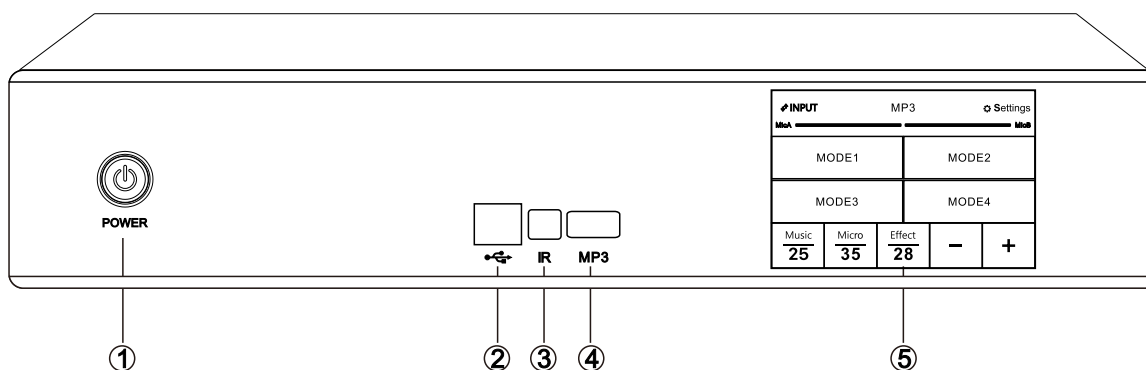

1. Power Switch

After pressing the power switch, the screen will display “loading...” about 3 seconds, “soft start” is completed when the “main menu” appears on the screen.

2. USB interface, for “in-house Mixing Software” via CPU 3. IR Port

4. USB interface, for MP3 playback

5. Touch screen display panel

Functions of the Touch Screen

When the machine is in operation, the display panel will show the parameters below:

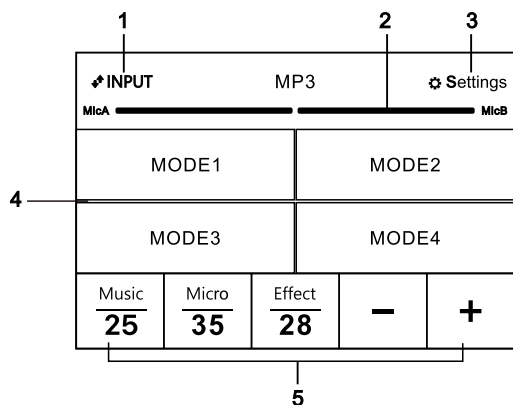

1. INPUT: when “INPUT” is selected, the following sources will be available for selection, “SONG SYSTEM”, “BLUETOOTH”, “DVD”, “VOD”, “OPT”, “MP3”. The selected source signal will be displayed in the top middle part of the display panel.

2. Wireless microphone signal indication:

The bar will be highlighted when the microphone turned on is synchronized to the right frequency channel.



The bar will not be highlighted when the microphone is off or is not synchronized to the right frequency channel.



3. Settings : When “Settings” is selected, these parameters will be accessible:

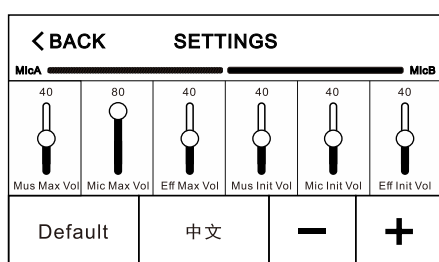

1) Music MAX volume: 0-80

2) Mic MAX volume: 0-80

3) Effect MAX volume: 0-80

4) Music Initial volume: 0-80

5) Mic Initial volume: 0-80

6) Effect Initial volume: 0-80

7) Default: Restore to factory setting

8) English / Chinese System Language selection

9) Volume setting: “-” Reduce / “+” Increase

3.MODE1, MODE2, MODE3, MODE4, 4 preset mode option: The selected mode will be highlighted.

MODE1	MODE2
MODE3	MODE4

4.Music, microphone and effect volume display. Press the corresponding area, when the background turn to orange, then press “-” or “+” to adjust the volume accordingly; Hold down the area for about 3 seconds, the value of the number will turn to red, now the corresponding function is mute, Hold down for about 3 seconds again, mute will then be dismissed .

Music 25	Micro 35	Effect 28	-	+
--------------------	--------------------	---------------------	---	---

Back Panel Instruction

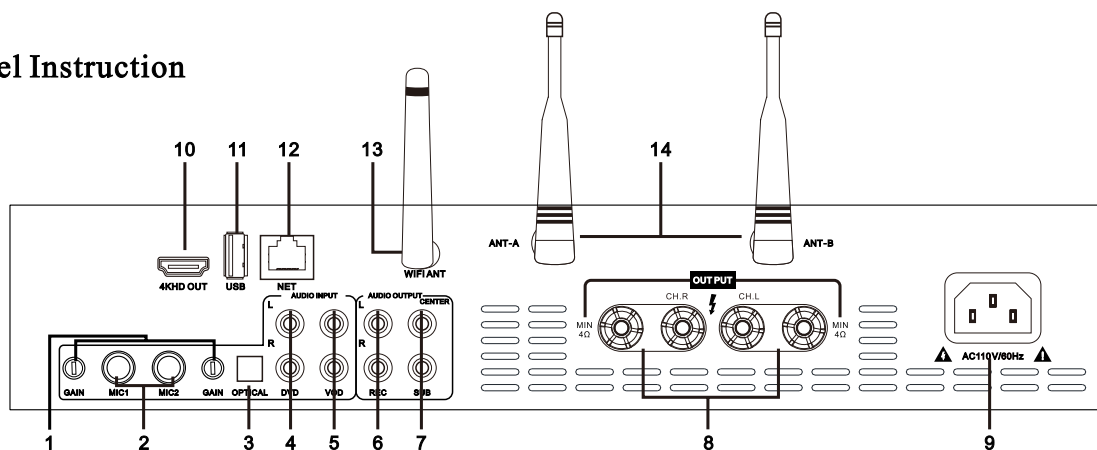

- 1.MIC1/MIC2 gain controller
- 2.MIC1/MIC2 input interface
- 3.OPTICAL audio input interface
- 4.DVD audio input interface L/R
- 5.VOD audio input interface L/R
- 6.Recording audio output interface L/R
- 7.CENTER / SUB output interface
- 8.Professional Binding Post terminal output interface
Connection method: red is “+”, black is “-”
- 9.Power input interface
- 10.HDMI output interface
- 11.USB interface
- 12.Network port
- 13.WIFI antenna interface
- 14.Microphone antenna interface

Controller Instruction

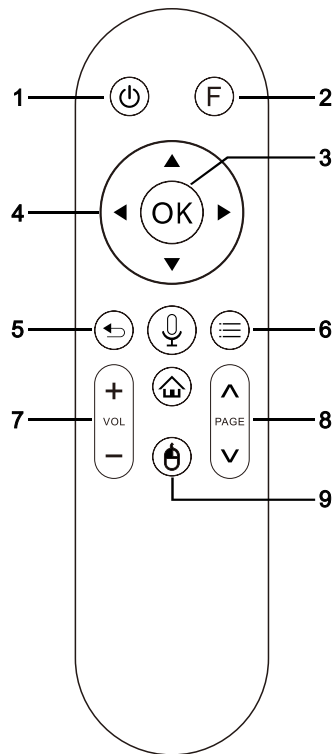

- | | |
|---------------|--|
| 1. Power | Turn on / off TV power |
| 2. Mute | Turn on / off sound |
| 3. Confirm | confirm the selection |
| 4. Navigation | focus navigated controlled |
| 5. Return | Return to last group /Exit the application |
| 6. Menu | MV page and KTV home page switch |
| 7. Volume | Volume increase / decrease |
| 8. Page | Page selection |
| 9. Mouse | Mouse on / off |
| Home | Home page hot key |
| Voice | voice key for smart dialogue |

Main Functions & instruction

1. Android Applications

System had been install "Youtube", "Google play", "Netflix"...etc Android apps. System also support user to download App via internet or via usb hard disk

2. Language

System support user to change system language : SET > Language

3. Internet

System support Net cable connect or WiFi connect.

WiFi connect : Set > Network

4. Bluetooth

Bluetooth connect : Set > Bluetooth

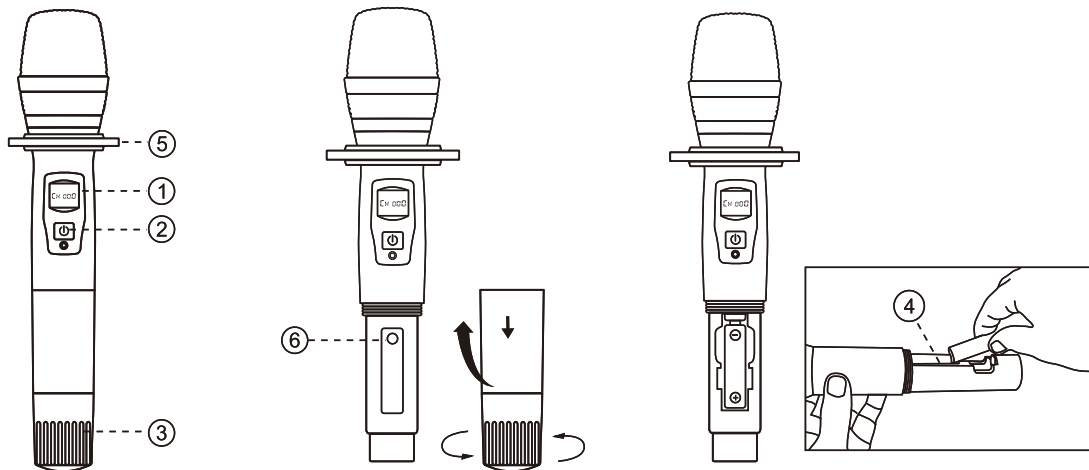

1. Structure of the Microphone

- ① Mic Display Panel ② Power ③ Tail ④ Battery cabin ⑤ Stop ring ⑥ Digital frequency alignment button

2. Digital frequency alignment

To synchronise the digital frequency of the handheld wireless mic to the amplifier, turn on the handheld mic by pressing the microphone's power switch once. Remove the tail piece of the handheld mic by twisting the tail piece anti clockwise. Once the tail piece is removed, the digital frequency alignment button will be visible. Press the digital frequency alignment button once (mic should be turned on), and the mic display panel should flash for 2 seconds. Quickly press the power switch of the handheld mic once (within the first 2 seconds), and the mic should display "SYNC" (for another 2 seconds). When the mic display panel is displaying "SYNC", quickly face the mic display panel towards the amplifier's IR sensor (to be done within the second 2 seconds) so the amplifier can capture and synchronise the frequency channel of the handheld mic. Once the "grey bar" in the top of the amplifier's display panel turns to "blue bar", the digital frequency alignment is successful.

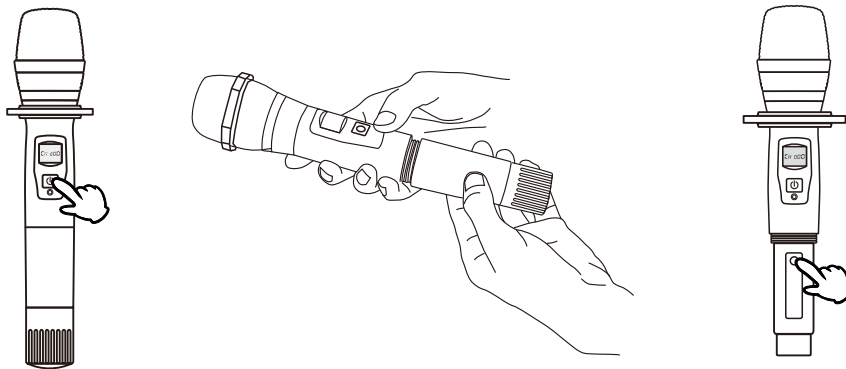

3. Turn on and turn off

Press the power switch down for about 2 seconds, the microphone display will light up and the mic display panel will display related working information, including the operating frequency (channel), battery power and other information. Every time you turn on the microphone, you must pay attention to the battery power display status, and choose whether to replace the battery according to the actual time to be used. Under normal circumstances, a pair of ordinary AA batteries can be used normally for 8 hours. When the battery power is down to 1 bar, the display will prompt "LOW BAT", indicating that the battery power is about to run out, please replace the batteries. In addition, the backlight of the display screen will automatically turn off in a few seconds after the microphone is turned on to enter the energy saving mode. If you need to view the display information during usage, you can press the power switch once. Press and hold the power switch for about 3 seconds, the display will show "OFF", and the microphone will be turned off. If the microphone will not be use for a long time, please remove the battery to prevent battery leakage from corroding the circuit board and damaging the microphone.

