

versatile™ 4C Mailbox 4CADD-09

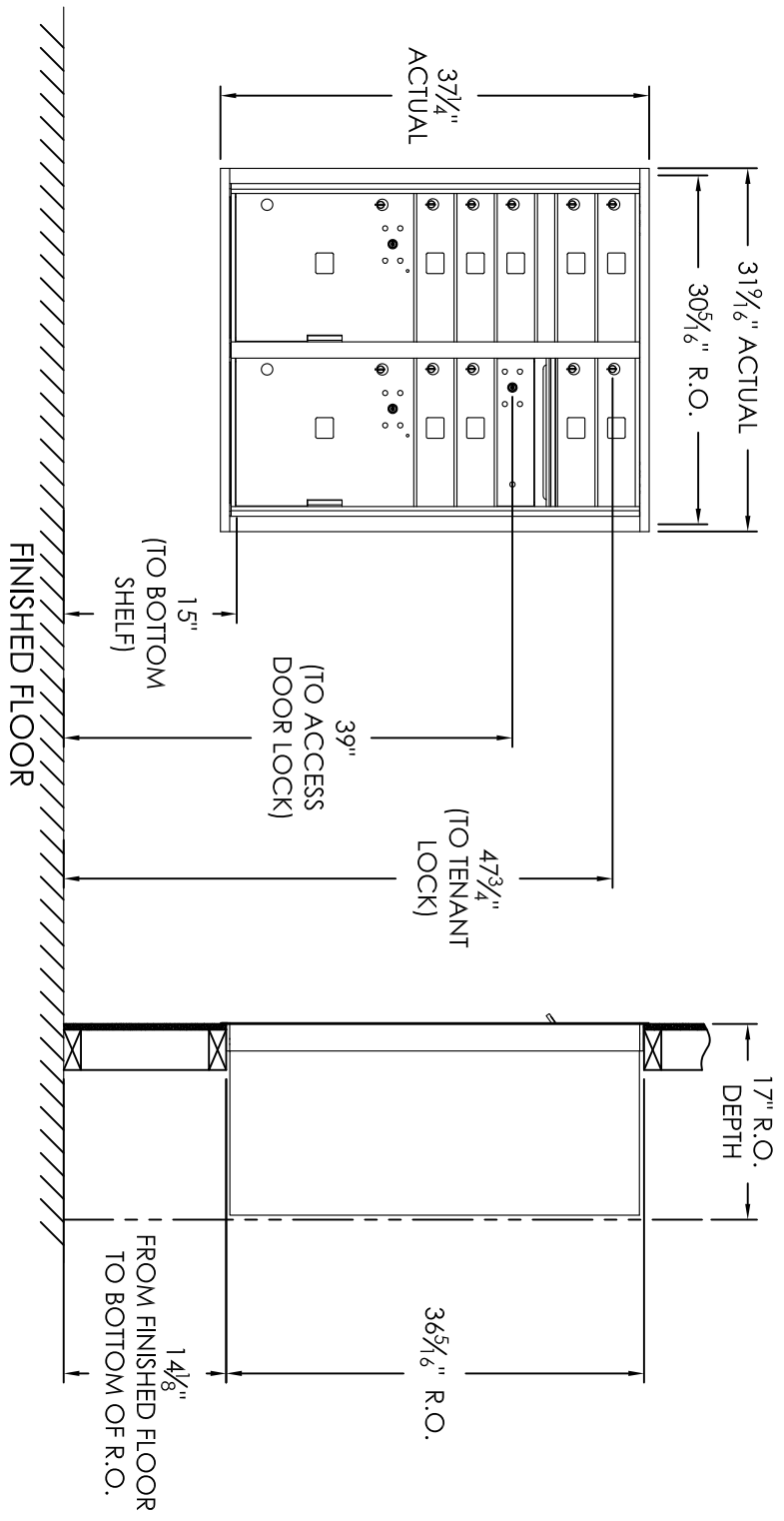

COMPARTMENT CHART

DESCRIPTION	COMPARTMENT	COMPARTMENT SIZE	QTY.
MAILBOX	MB1	3" H x 12" W x 15" D	9
OUTGOING MAIL	OM1	3" H x 12" W x 15" D	1
PARCEL	PLUS	15" H x 12" W x 15" D	2

PRODUCT SERIES: **VERSATILE™ 4C FRONT LOAD MAILBOX**

- Notes:**
1. This module meets the USPS STD-4C requirements for installation defined below when the mailbox is installed per the dimensions provided on this drawing.
 - a. At least one customer compartment shall be positioned less than 48" above finished floor (AFF).
 - b. No parcel locker (interior bottom shelf) shall be positioned less than 15" AFF.
 - c. No patron (tenant) lock shall be positioned more than 67" AFF.
 - d. No customer compartment (interior bottom shelf) shall be positioned less than 28" AFF.
 - e. The USPS Arrow lock shall be positioned 36"-48" AFF.
 2. This 4C mailbox can also be used for private applications.
 3. The rough opening width for multi-unit 4C installations = (the sum of all actual unit widths) - 1 7/8".

MODEL 4CADD-09	REV B
SCALE NONE	LAST REV DATE 5/15/2014
DRAWING NUMBER 4CADD-09CS	DRAWN BY SDH