

## Confirm Accessories in Kit

2 Lithium Ion  
Pendant batteries



Telephone Cord



Lanyard



AC Adapter



4 Rechargeable AA  
Batteries



\*Wriststrap

\*Beltclip

\*The holster is the same for both Wriststrap and Beltclip. Simply unscrew the strap and replace with the clip or vice-versa

## Base Back View

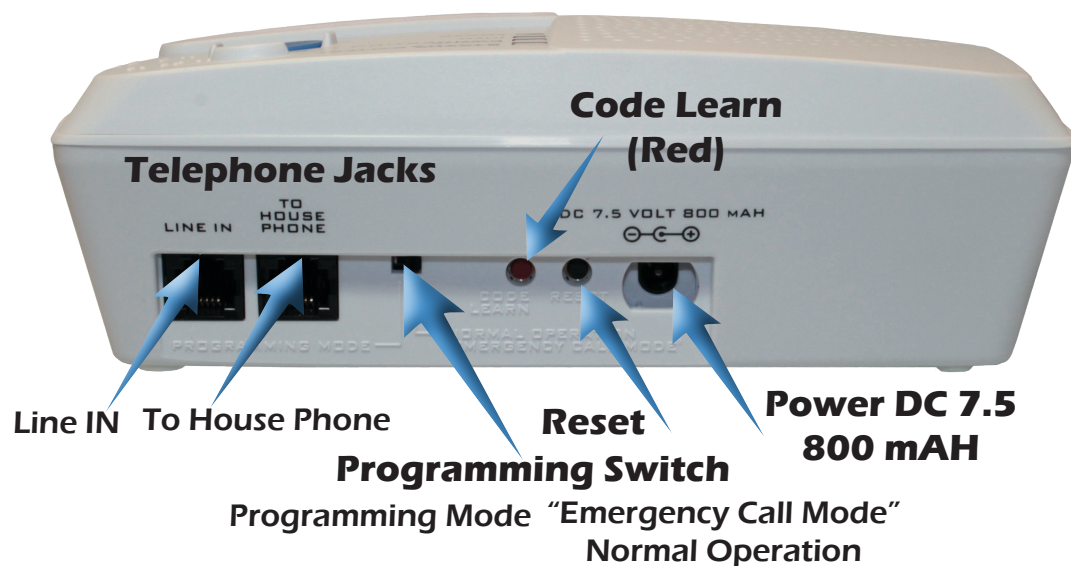

## Base Side View



### LogicMark Disclaimers and Limited Warranty

The Manufacturer's Warranty period is one year from the time of purchase.

**COMMUNICATION AND RESPONSE LIMITATIONS:** Purchaser acknowledges that signals which are transmitted over telephone lines, or other modes of communication pass through communication networks wholly beyond the control of LogicMark LLC and are not maintained by LogicMark LLC, and, therefore, LogicMark LLC shall not be responsible for any equipment or communication failure which prevents transmission signals from reaching your contact list including emergency 911 operators or damages arising therefrom. Purchaser acknowledges that LogicMark LLC provides no response to the System's equipment. The equipment is designed to communicate with the a central station of your choice and LogicMark LLC is not and shall not be responsible for ambulance, police or other emergency response time or that any response will be provided by the central monitoring station.

**TESTING AND SERVICE OF THIS EQUIPMENT:** The equipment, once installed, are in the exclusive possession and control of the Purchaser, and it is Purchaser's sole responsibility to test the operation of equipment and request warranty service if the equipment is under warranty.

**PURCHASER'S EXCLUSIVE REMEDY:** Purchaser's exclusive remedy for LogicMark LLC's default hereunder is to require LogicMark LLC to repair or replace, at LogicMark LLC's option, any equipment or part of the personal emergency alert system which is non-operational during LogicMark LLC's warranty period.

**LIMITATION OF LIABILITY:** This equipment is not designed or guaranteed to prevent any loss or injury. This Limited Warranty and Disclaimer of Liability constitutes the terms of sale and use of the equipment, and if there should arise any liability on the part of LogicMark LLC as a result of any cause whatsoever, regardless of whether or not such loss, damage, or personal injury was caused by or contributed to by LogicMark LLC's negligence to any degree or failure to perform any obligation or strict products liability, such liability will be limited to an amount paid by the Purchaser to LogicMark LLC for the product, or to the sum of \$350.00, whichever is greater.

For warranty information, see your dealer for details.

© LogicMark, LLC v6.1  
Part# 4106-EN-DECT

# CARETAKERSENTRY with two-way voice pendant Quick Install Guide

Instructions for Installing Your New Personal Emergency Response System

## Base Top View Part #40914



## Pendant Part #41915

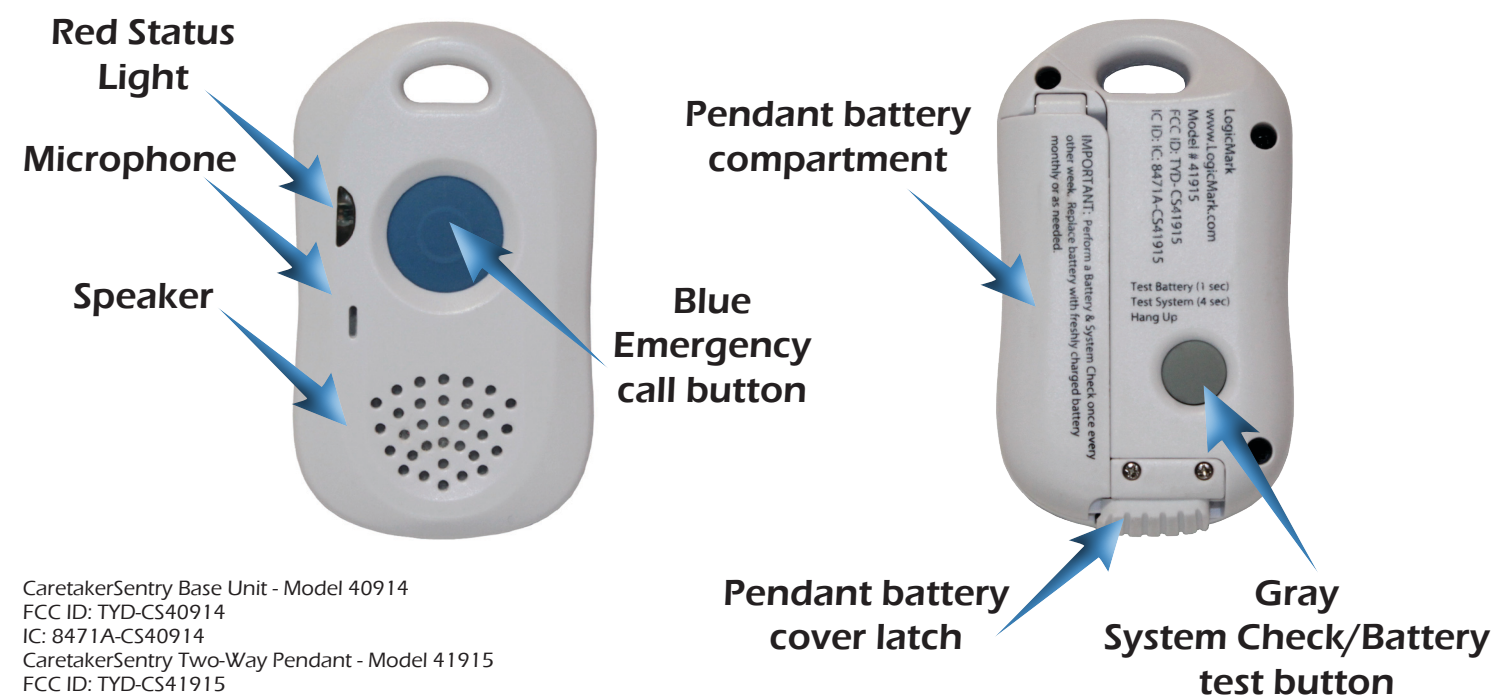

CaretakerSentry Base Unit - Model 40914  
FCC ID: TYD-CS40914  
IC: 8471A-CS40914  
CaretakerSentry Two-Way Pendant - Model 41915  
FCC ID: TYD-CS41915  
IC: 8471A-CS41915  
REN 3.7



### 1

## Install Your Batteries

1A. Place the Green AA Rechargeable Batteries in the compartment on the bottom of the base unit. Check the picture for correct orientation.

1B. Turn ON/OFF switch to ON. You will hear the announcement "Running on Battery Power." Unit will do so until the AC Adapter power supply is plugged in.

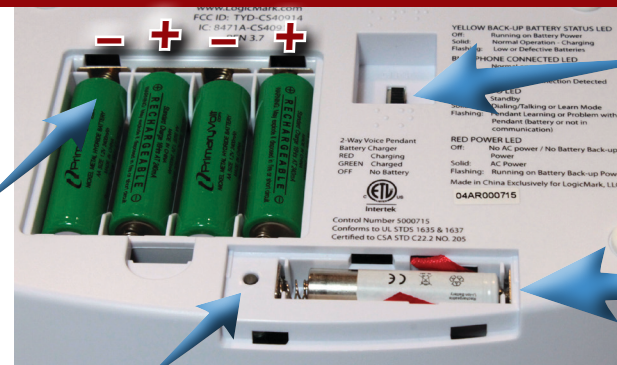

Master  
ON/OFF  
Switch

RED Light = Charging  
GREEN Light = Battery Charged  
No Light = Defective battery or no battery installed

1C. The battery door can be opened by sliding the latch at the bottom of the pendant all the way to the right. Pull open the hinged door and place the battery with the silver end facing up. Next, close the door and slide the latch back to the left. If installed properly, the pendant will make an announcement that the battery is ok.

1D. If this is the first two-way voice pendant you are adding to your CaretakerSentry, you will need to add your replacement battery to the base station's charging port. To add the replacement battery, slide open the battery door and place the battery in with the silver end facing left.



### 2

## Plug Telephone Line and Power Cord into Wall Jacks



2A. Plug the AC Adapter power cord into the power jack and twist 1/4 turn clockwise to lock.

Next, plug the AC Adapter into an electrical socket.



2C. (OPTIONAL) Plug the telephone into the "To House Phone" jack.

2B. Plug the telephone cord into the wall phone jack.

### 3

## Test the Unit

### Perform a System Test

3A. Push the GRAY test button on back of pendant for **4 seconds**

3B. Listen for voice prompt from base unit:

- If the system is correctly installed, "All Systems are OK – Battery is OK" is heard.
- If any other voice prompt is heard, the unit will describe the problem.

**3C. We recommend that you perform this System Test weekly.**



### Place call to Emergency Operator:

3D. Push the BLUE EMERGENCY button for 2 seconds on Pendant. (The RED Light on the pendant should turn ON.)

3E. You should hear a dial tone, dialing, and then communication tones between the CaretakerSentry and central station. Several seconds later the operator should answer the call.

3F. Talk normally into the pendant– just like into a speaker phone.

3G. At the end of the conversation, the CaretakerSentry should automatically hang up. If it does not hang up, push the CANCEL button for 1 second (either on back of pendant or on base unit.)

