



## Factory reset an ADC-VC736 to its default settings

It is recommended that the device be powered on for at least two minutes before trying to factory reset it.

**Important:** If the factory reset is attempted immediately after power up it will not work as the device will still be rebooting. After performing a factory reset, it is strongly recommended to leave the device alone and plugged into power for two minutes.

### Reset Procedure

### ADC-VC736 image

1. Disconnect the camera from the power supply.
2. Use a Phillips-head screwdriver to remove the water-tight door (see diagram).
3. Press and hold the Reset button while reconnecting power. Continue to hold the Reset button for 10 seconds.

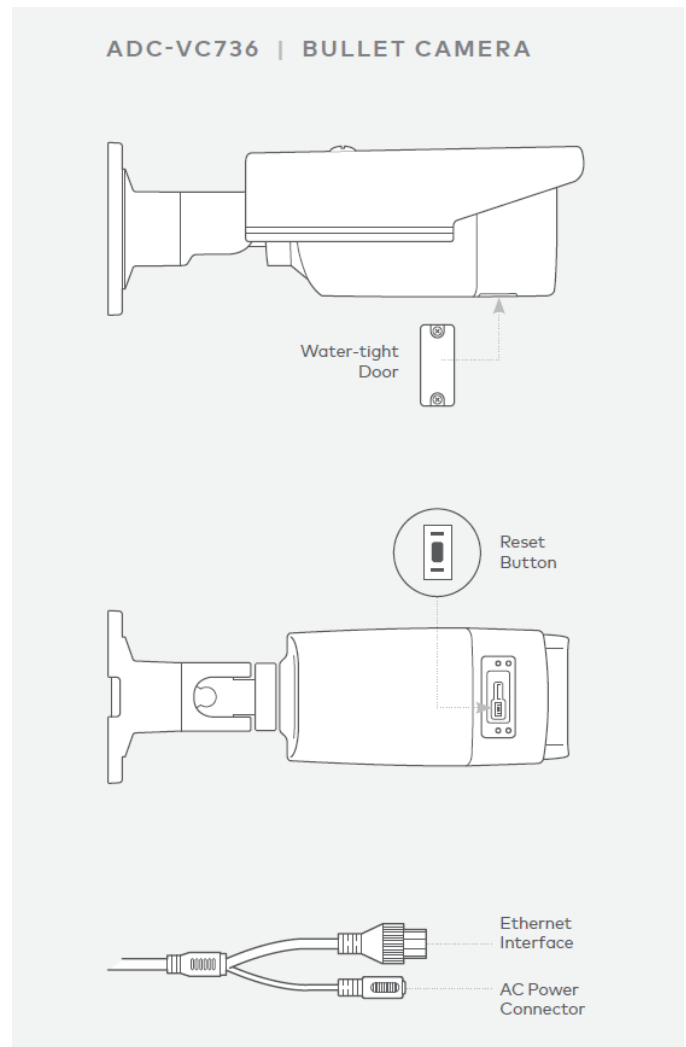

**Important:** If the camera was previously installed on an Alarm.com account, it will need to be deleted before it can be installed again.

