

INSTRUCTIONS for TG-KIT LTE

Conversion of TG-7 Series to Telguard TG-7 LTE

The Telguard® TG-KIT LTE can be used to convert an older TG-7 series device (2G, 3G/4G, or CDMA) to a comparable TG-7 LTE model.

Pre-Installation checklist:

- Four (4) standoffs.
- Four (4) mounting screws.
- One (1) washer.
- One (1) metal plate
- NEW TG-7 LTE circuit board
- Terminal Blocks
- Labels

Conversion Procedure:

Note: Prior to beginning the hardware conversion, identify the type of enclosure you are dealing with. If the P/N of the original unit ends in 001, you have a "Legacy" unit.

- A. Disconnect all power to the Telguard unit. This includes both AC power transformer and battery.

If the unit is a Legacy device, then a metal plate (included) is needed to convert the dual board chassis to a single board chassis.

- B. Remove the TG7 circuit card(s) from chassis by doing the following steps:
1. Disconnect the wires from terminal block.
 2. Disconnect the antenna (or antenna cable if dealing with a TG-7A).
 3. Remove the antenna TNC connector's retaining nut and washer. Set these aside for later use. (Figure 1)

If the unit is a Legacy 2G device, the daughter cards are secured with small brackets. Unscrew these brackets to remove these cards.

4. Remove all the screws securing the current circuit board.

If the unit is a Legacy 2G device, you will have four mounting screws and a green grounding screw (Figure 2).

For other models there are only three mounting screws in addition to the grounding screw.

5. Set aside these mounting screws for future use and remove old circuit board.

For Legacy 2G devices, you may need to first remove the Modem card. If so, set Modem Card and bracket screws aside for later use. (Figure 2)

6. If you have a Legacy 2G TG-7A you must remove the antenna bracket. (Figure 3)

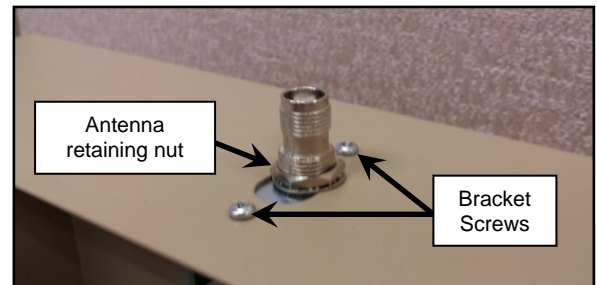

Figure 1.

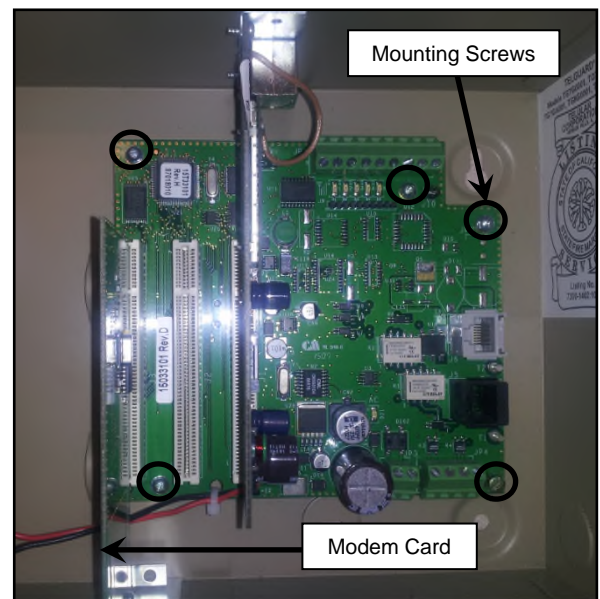

Figure 2.

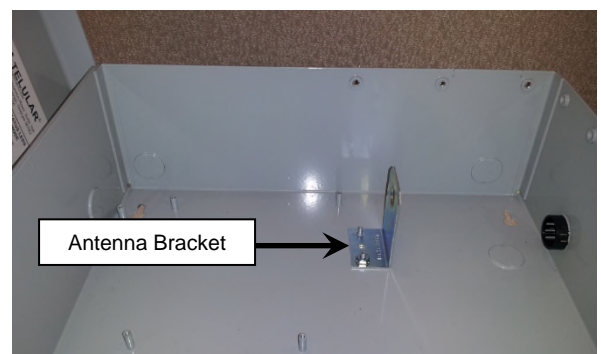

Figure 3.

- C. If you have a Legacy 2G unit, you must first install the metal plate:

1. Remove the metal plate and hardware from the shipping box.

If you have a Legacy 2G TG-7A, skip steps 2 and 3. Simply line up the holes using the notch on the plate and the antenna bracket screws as a reference.

2. Install the 4 standoffs in the holes that originally held the board.
3. Line up the notch on the plate to where the TNC chassis opening is.
4. Using the old board's mounting screws, install the metal plate. (Figure 4)

Once the metal plate is installed, line up the NEW board with the 4 standoffs on the metal plate. Using the provided screws secure the board to the metal plate. (Figure 5)

- D. If your device is NOT a Legacy 2G unit, install the NEW circuit board into the chassis using the provided screws. Use any of the provided mounting screws to ground the unit.
- E. Place the large washer from the kit over the protruding TNC connector and secure the TNC connector by installing the original retaining washer and nut. (Figure 6)
- F. If your Legacy 2G TG-7 had a Modem Card, make sure to cover the hole left by its mounting bracket.
1. Remove the Modem Card from the bracket by removing the two screws that hold them together. (Figure 7A)
 2. Once you have the bracket separated from the Modem card, remount it onto the chassis using the same bracket screws from step B. (Figure 7B)
- G. Wire the terminal blocks using the new door label wiring guides
- H. Install new door and Serial Number labels over existing labels for future reference.

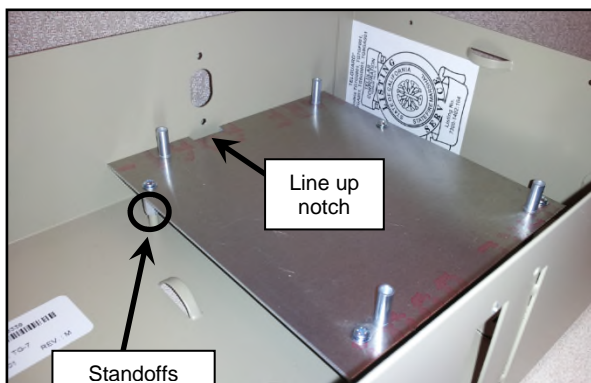

Figure 4.



Figure 5.

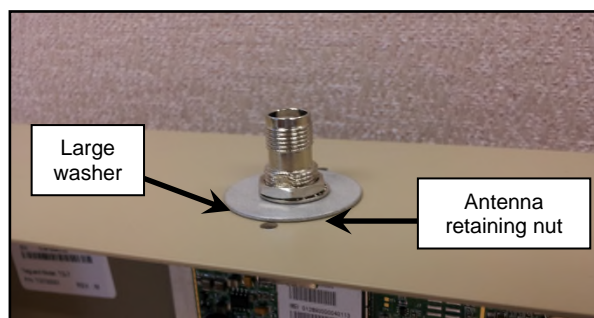

Figure 6.

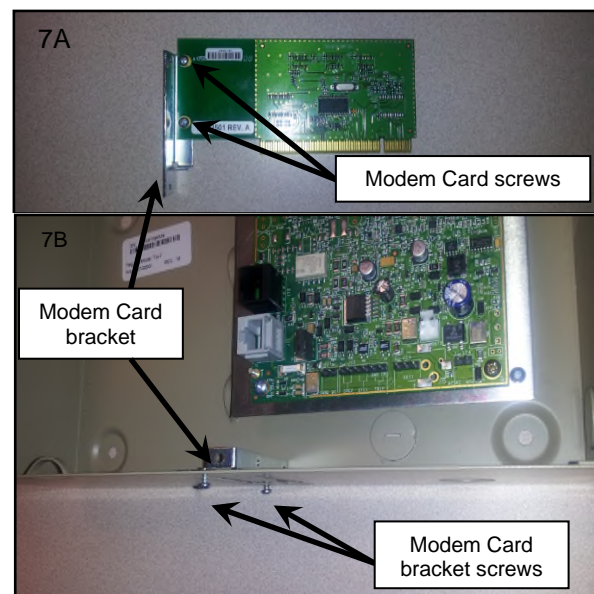

Figure 7.

Refer to Installation & Operating Instructions Manual for the Telguard conversion kit for any additional information required.