

**Lock Kit Includes:**

**1 Lock Body with Lock Post**

**1 Clip**

**2 Keys**

**Lock Wire and Lock Bracket**  
**not included in this lock kit.**

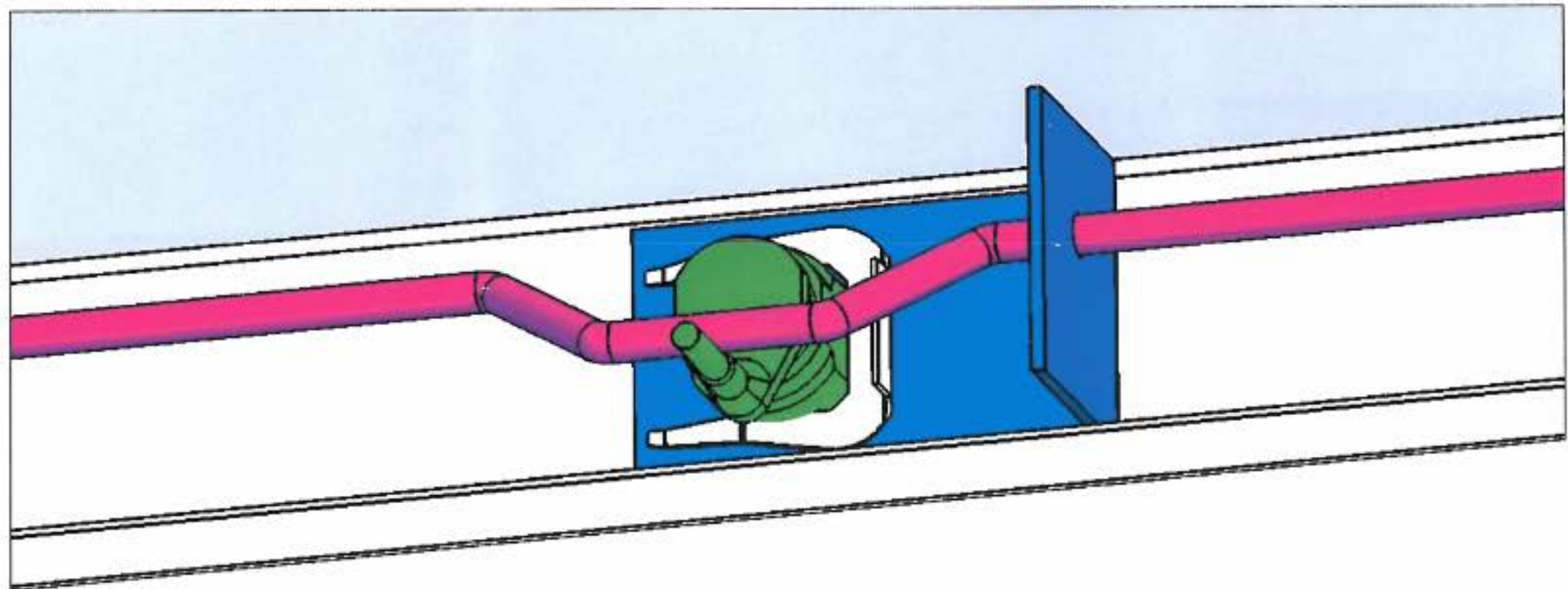
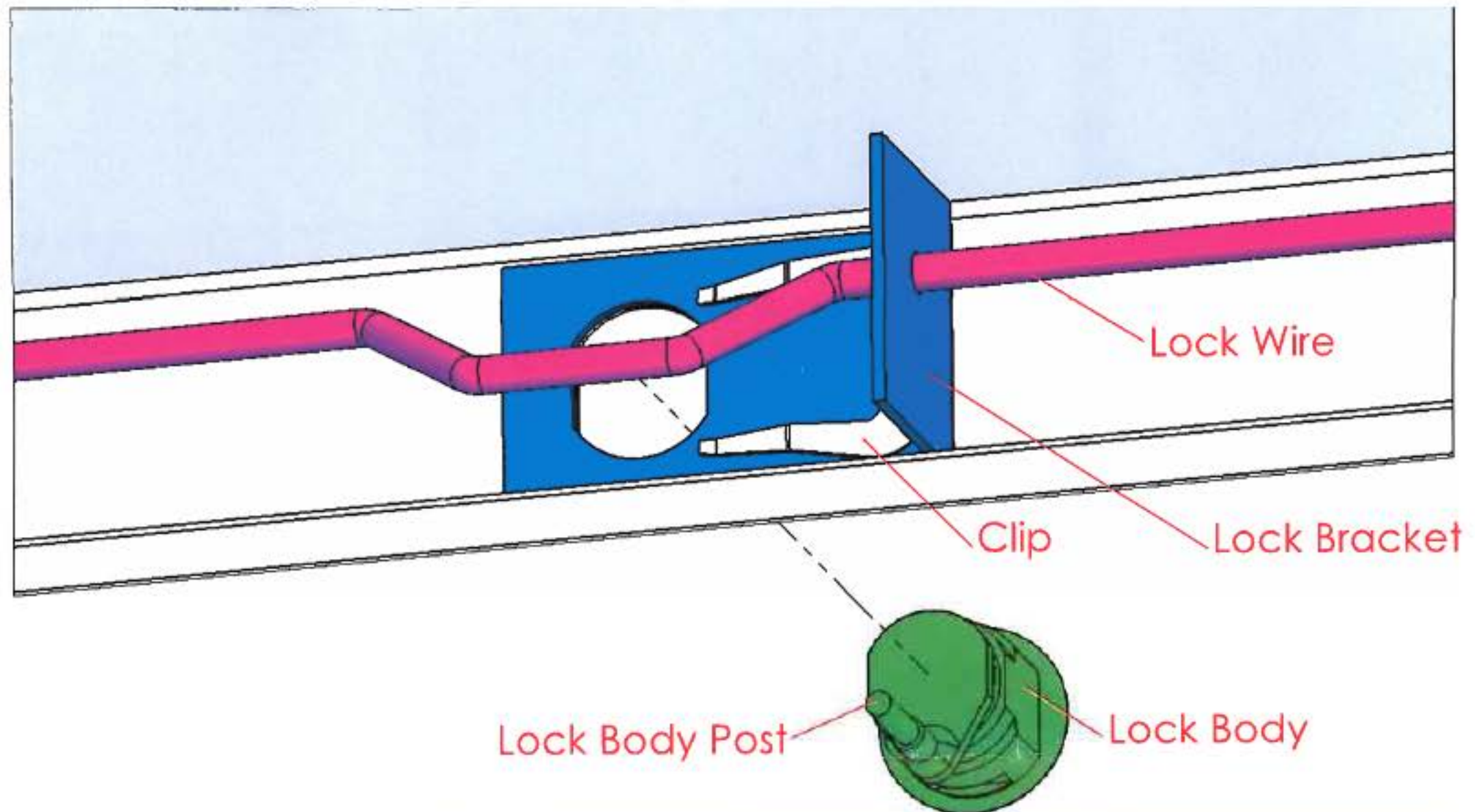

**Lock Installation Instructions**

1. Position the Lock Bracket as shown in the figures above lining up the hole in the Top Panel and Bracket.
2. Insert the Lock Wire into the Lock Bracket as shown in the figures above.
3. Make sure the lock is in the Unlocked position (Key turned fully clockwise) and insert it through the hole in the Top Panel and Bracket so that the Lock Wire rests on top of the Lock Body Post.
4. With the Lock Body fully inserted into the cabinet, slide the clip into the channel on the Lock Body until the inside face of the clip touches the lock body. **Note: The clip may be difficult to install by hand, it is advisable to start it by hand and use a pair of pliers to complete installation. Be careful of sheet metal corners which may be sharp.**